

ROUTE NO.	SECTION	COUNTY	TOTAL SHEETS	SHEET NO.
FAS 788 (C.H. 24/ C.H. 16)	03-00075- 00-BR, WASH. 03-00082- 00-BR, CLIN.	WASHINGTON CLINTON	22	4

04DET952L.DGN FEB. 21, 2006

LEGEND

T POST MOUNTED SIGN

ALL ITEMS OF WORK INVOLVED WITH THE ROAD CLOSURE WILL BE PAID FOR AT THE CONTRACT UNIT PRICE PER LUMP SUM FOR TRAFFIC CONTROL AND PROTECTION.

☀ ALL ROAD CONSTRUCTION AHEAD SIGNS AND ROAD CLOSED AHEAD SIGNS SHALL HAVE FLASHING LIGHTS.

NOTES:

ENGINEER MAY MODIFY SIGN PLACEMENT TO MEET FIELD CONDITIONS.

DETOUR SIGNING ASSEMBLY SHALL MAINTAIN THE HEIGHT TO THE BOTTOM OF THE LOWEST SIGN NO LESS THAN 5 FEET ABOVE THE EDGE OF PAVEMENT.

* 200' TYPICAL TO FIRST SIGN OR TO MEET FIELD CONDITIONS.

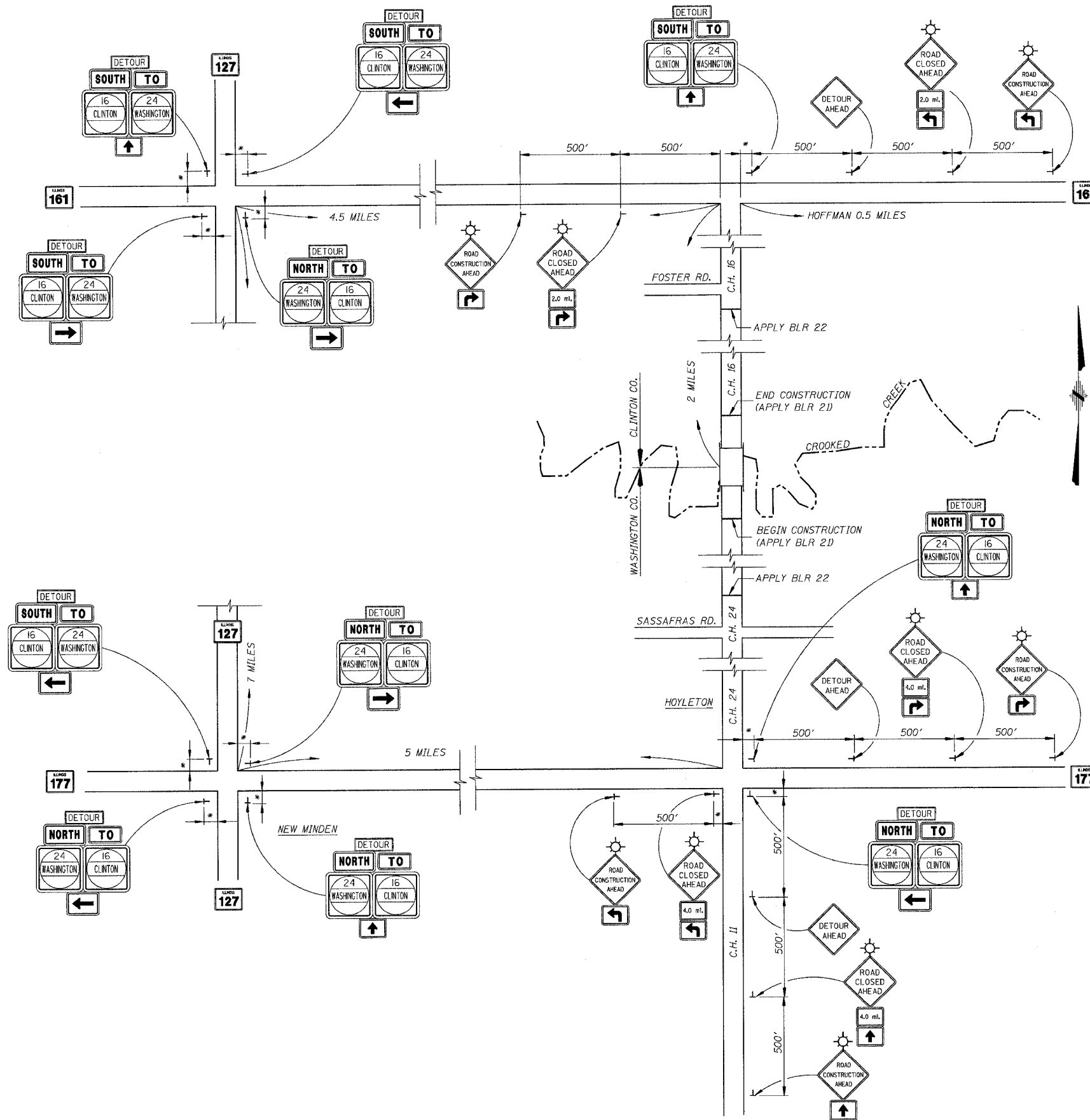

DESIGNED:	L.D.G.
CHECKED:	B.G.H.
DRAWN:	K.H.L.
CHECKED:	L.D.G.

DETOUR MAP WITH SIGNING
F.A.S. 788 (C.H. 24/C.H. 16)
OVER CROOKED CREEK
SECTION 03-00075-00-BR
WASHINGTON COUNTY
SECTION 03-00082-00-BR
CLINTON COUNTY