

ROUTE NO.	SECTION	COUNTY	SHEET NO.	TOTAL SHEETS
TR 373	*	VERMILION	19	6
FED. ROAD DIST. NO. 7	ILLINOIS	FED. AID PROJECT	* 02-04130-00-BR	

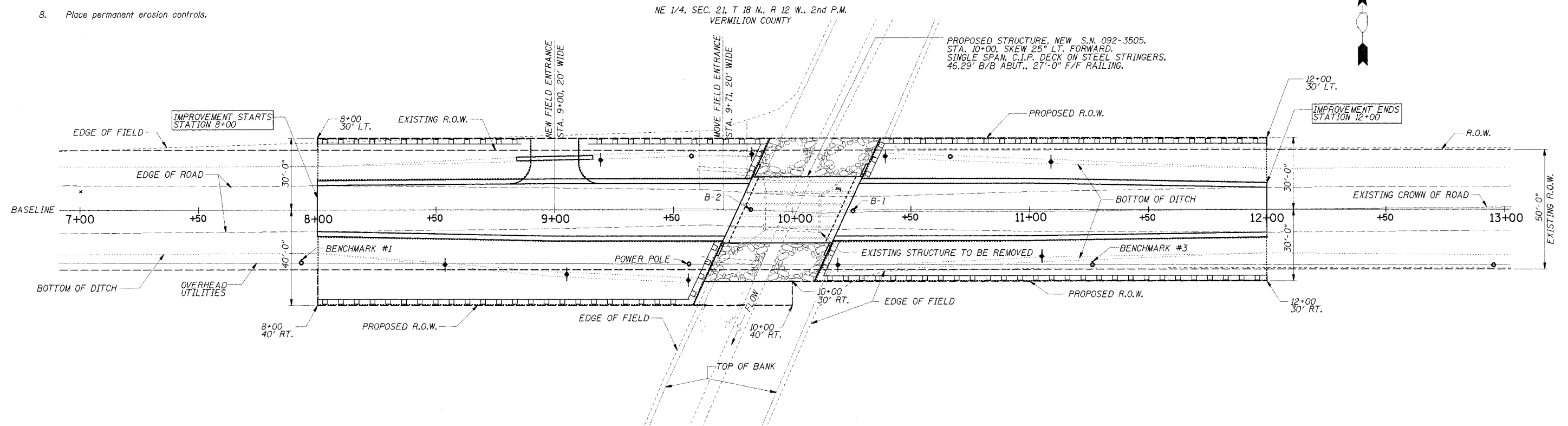

INTENDED SEQUENCE

1. Place of the perimeter erosion control barrier prior to the commencement of any work. See Standard 280001.
2. Remove the existing structure.
3. Construct new substructure.
4. Construct new superstructure.
5. Place and maintain temporary erosion controls.
6. Grade and shape, including the placing aggregate base course and bituminous surface course, A3 special.
7. Remove and properly clean up temporary erosion controls.
8. Place permanent erosion controls.



PERMANENT EROSION CONTROL

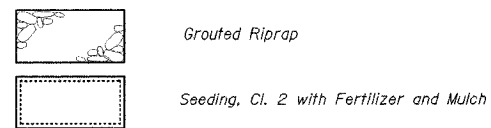

TEMPORARY EROSION CONTROL

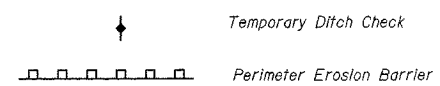

PERIMETER EROSION BARRIER

STA	OFFSET	TO STA	OFFSET	LENGTH
8+00	30' LT	8+86	30' LT	86 FT
9+14	30' LT	9+91	30' LT	77 FT
9+83	13' LT	9+91	30' LT	20 FT
8+00	40' RT	9+59	40' RT	158 FT
9+58	40' RT	9+71	13' RT	30 FT
10+29	13' LT	10+31	30' LT	19 FT
10+30	30' LT	12+00	30' LT	170 FT
10+09	30' RT	10+17	13' RT	19 FT
10+09	30' RT	12+00	30' RT	191 FT
TOTAL				770 FT

TEMPORARY DITCH CHECKS

STA	OFFSET	QUANTITY
8+50	RT	1 EACH
9+05	RT	1 EACH
9+20	LT	1 EACH
9+50	RT	1 EACH
9+80	LT	1 EACH
10+20	RT	1 EACH
10+40	LT	1 EACH
11+05	RT	1 EACH
11+10	LT	1 EACH
TOTAL		9 EACH

TEMPORARY EROSION CONTROL		
Bill of Materials		
Item	Unit	Quantity
Temporary Erosion Control Seeding	Pound	375
Temporary Ditch Checks	Each	9
Perimeter Erosion Barrier	Foot	770