

F.A. RTE.	SECTION	COUNTY	TOTAL SHEETS	SHEET NO.
595	1 - 1	ROCK ISLAND	239	234
STA. 75+60.93		TO STA. 116+00.00		
FED. ROAD DIST. NO.	ILLINOIS	FED. AID PROJECT		
		CONTRACT # 84986		

FINAL SURVEY	DATE
NO. 1: BLOCK	
NO. 2: BLOCK	
NO. 3: BLOCK	
NO. 4: BLOCK	
NO. 5: BLOCK	
NO. 6: BLOCK	
NO. 7: BLOCK	
NO. 8: BLOCK	
NO. 9: BLOCK	
NO. 10: BLOCK	

PREPARED BY	DATE
NO. 1: BLOCK	
NO. 2: BLOCK	
NO. 3: BLOCK	
NO. 4: BLOCK	
NO. 5: BLOCK	
NO. 6: BLOCK	
NO. 7: BLOCK	
NO. 8: BLOCK	
NO. 9: BLOCK	
NO. 10: BLOCK	

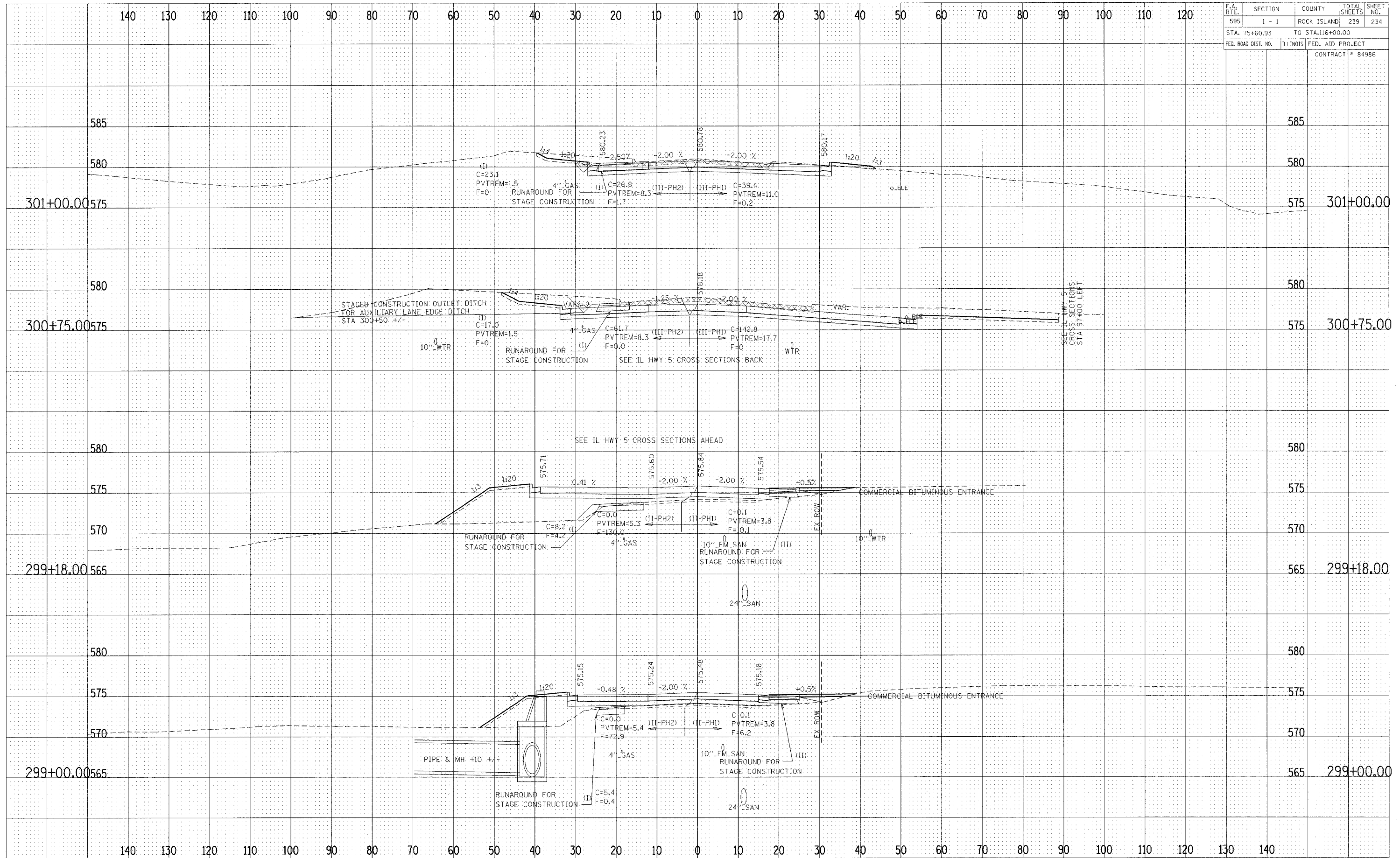

CROSS SECTIONS - 30th STREET