

DATE	BY
DESIGNED	CHECKED
DRAWN	APPROVED
NOTED	DATE
NO.	

DATE	BY
DESIGNED	CHECKED
DRAWN	APPROVED
NOTED	DATE
NO.	

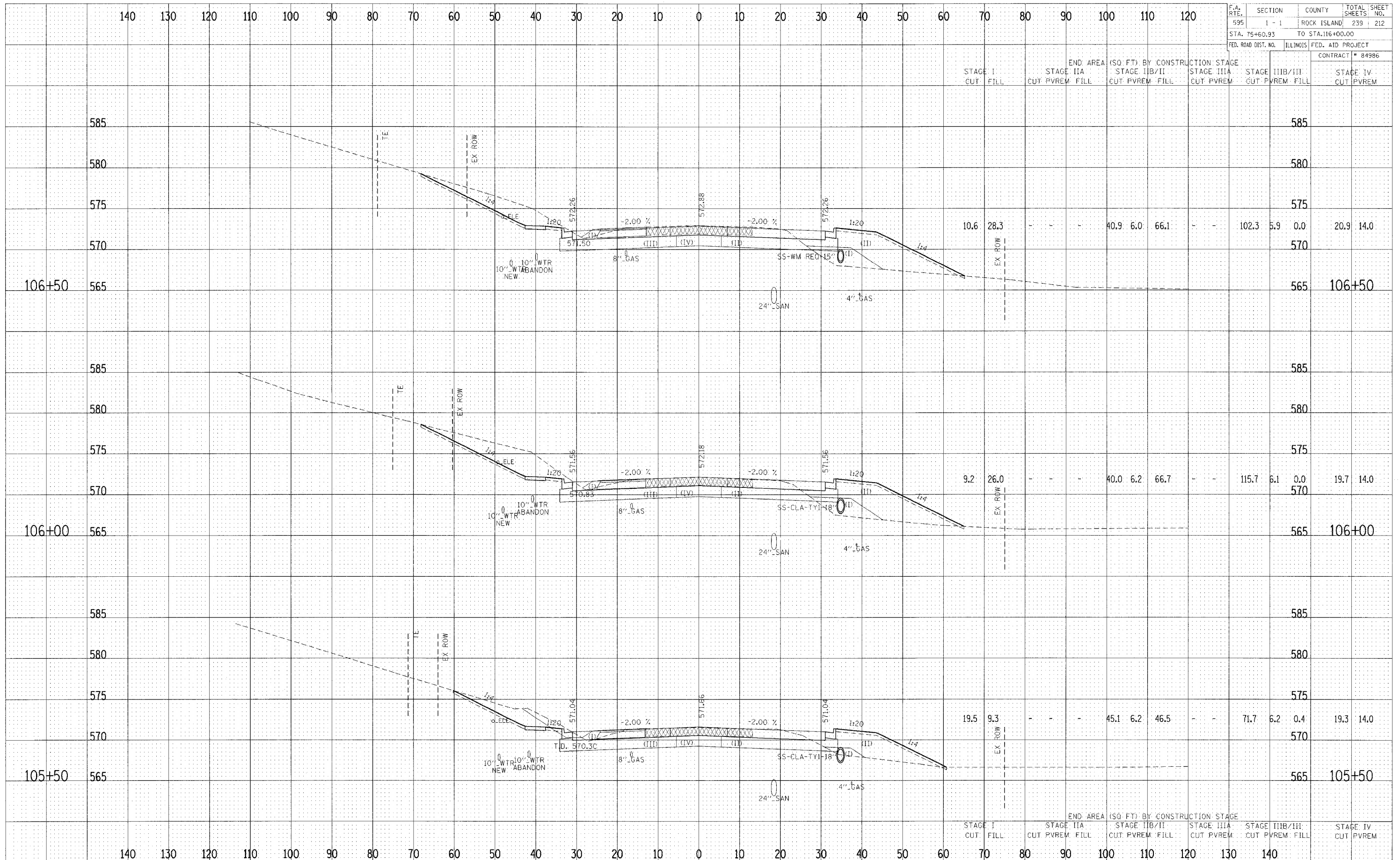

F.A. RTE.	SECTION	COUNTY	TOTAL SHEETS
595	1 - 1	ROCK ISLAND	239 212
STA. 75+60.93		TO STA. 116+00.00	
FED. ROAD DIST. NO.	ILLINOIS	FED. AID PROJECT	CONTRACT # 84986

STAGE I		STAGE II		STAGE III		STAGE IV	
CUT	FILL	CUT	FILL	CUT	FILL	CUT	FILL

END AREA (SQ. FT.) BY CONSTRUCTION STAGE		STAGE IIB/II		STAGE IIIA		STAGE IIIIB/IIII		STAGE IV	
CUT	FILL	CUT	FILL	CUT	FILL	CUT	FILL	CUT	FILL
10.6	28.3	-	-	40.9	6.0	66.1	-	102.3	5.9
0.0	0.0	0.0	0.0	0.0	0.0	0.0	0.0	20.9	14.0

END AREA (SQ. FT.) BY CONSTRUCTION STAGE		STAGE IIB/II		STAGE IIIA		STAGE IIIIB/IIII		STAGE IV	
CUT	FILL	CUT	FILL	CUT	FILL	CUT	FILL	CUT	FILL
9.2	26.0	-	-	40.0	6.2	66.7	-	115.7	6.1
0.0	0.0	0.0	0.0	0.0	0.0	0.0	0.0	19.7	14.0

END AREA (SQ. FT.) BY CONSTRUCTION STAGE		STAGE IIB/II		STAGE IIIA		STAGE IIIIB/IIII		STAGE IV	
CUT	FILL	CUT	FILL	CUT	FILL	CUT	FILL	CUT	FILL
19.5	9.3	-	-	45.1	6.2	46.5	-	71.7	6.2
0.4	0.4	0.0	0.0	0.0	0.0	0.0	0.0	19.3	14.0

CROSS SECTIONS - F.A. 595 (IL RTE 5)