

STATE OF ILLINOIS  
DEPARTMENT OF TRANSPORTATION

ROUTE NO.	DISTRICT	COUNTY	SECTION	SHEET	SHEET NO. 2
595	1-1	ROCK ISLAND	239	146	13 SHEETS
FED. ROAD DIST. NO. 2		MILEAGE		FED. AID PROJECT	
Contract No. 84986					

**GENERAL NOTES**

- 1) Contractor shall be responsible for design of timber lagging (per special provisions). Lagging design shall be submitted to Engineer for approval. Quantity shown in Bill of Materials is an estimate for bidding purposes only.
- 2) Reinforcement bars shall conform to the requirements of AASHTO M31 or M322 Grade 60.
- 3) All exposed edges of the concrete caps shall be chamfered  $\frac{3}{4}$ " unless noted otherwise.
- 4) All soldier piles shall be AASHTO M 270 Grade 50.
- 5) For drainage details (inlets, storm sewers, pipe drains, etc), see roadway plan and profile sheets and drainage and utility sheets.
- 6) Apply protective coat to all exposed concrete surfaces of the wall facing plus one foot below finished grade along the front of wall and one foot below top of wall along the back of wall.
- 7) All construction joints shall be bonded.

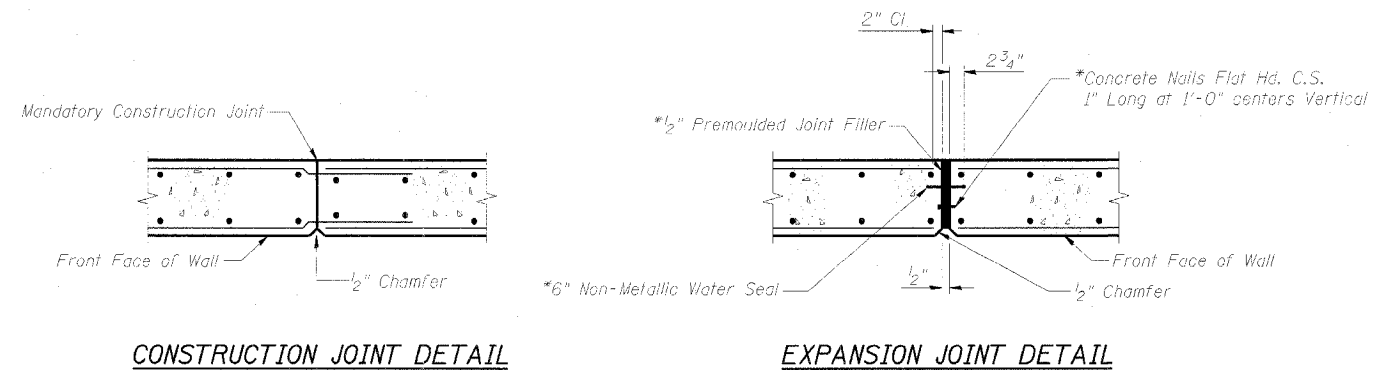

**CONSTRUCTION JOINT DETAIL**

**EXPANSION JOINT DETAIL**

**RETAINING WALL JOINT DETAILS**

**TOTAL BILL OF MATERIAL**

ITEM	UNIT	TOTAL
Porous Granular Backfill	Cu Yd	11.9
Structural Excavation	Cu Yd	247.2
Rock Excavation for Structures	Cu Yd	17.5
Protective Coat	Sq Yd	129.8
Concrete Structures	Cu Ft	111.9
Stud Shear Connectors	Each	254
Untreated Timber Lagging	Sq Ft	2,390
Furnishing Soldier Piles (W Section)	Foot	1217.3
Reinforcement Bars, Epoxy Coated	Pound	16,070
Pedestrian Rolling	Foot	117.2
Geocomposite Wall Drain	Sq Yd	265.6
Concrete Gutter, Type B	Foot	404.5
Drilling and Setting Soldiers Piles in Soil	Cu Ft	5,194
Drilling and Setting Soldiers Piles in Rock	Cu Ft	1,720
Pipe Underdrain for Structures 4"	Foot	418

**SUGGESTED SEQUENCE OF CONSTRUCTION**

- 1) Drill holes for soldier piles. Do not excavate near these holes at this stage.
- 2) Set Soldier Piles.
- 3) Fill hole with concrete to specified elevation.
- 4) Fill remainder of hole with controlled low strength material.
- 5) Begin earth excavation. Remove only earth and controlled low strength material as necessary to install timber lagging.
- 6) Install geocomposite wall drain and pipe underdrain.
- 7) Install stud shear connectors.
- 8) Construct concrete wall facing.
- 9) Install Pedestrian Rolling.

**INDEX OF DRAWINGS**

Sheet No.	Title
1	General Plan and Elevation
2	General Notes and Total Bill of Materials
3	Typical Section and Detail
4	Soldier Pile Schedule
5	Wall Plan and Elevation
6	Wall Plan and Elevation
7	Wall Plan and Elevation
8	Wall Plan and Elevation
9	Wall Plan and Elevation
10	Pedestrian Rolling
11	Soil Boring Logs B-1 and B-1a
12	Soil Boring Logs B-2a and B-3a
13	Soil Boring and Rock Core Log B-9

DESIGNED	NLV
CHECKED	DSE
DRAWN	RTT
CHECKED	DSE
DATE	JAN 31, 2006

Illinois Firm Registration No. 04-006533



**Stanley Consultants INC.**  
850 West Higgins Road, Suite 730, Chicago, Illinois 60631-2801  
www.stanleygroup.com

**GENERAL NOTES AND TOTAL BILL OF MATERIALS  
RETAINING WALL F ALONG  
INDIAN HILL ROAD  
FA 595 (IL ROUTE 5) SECTION 1-1  
ROCK ISLAND COUNTY  
STA 80+86.37 TO STA 13+73.25**