

STATE OF ILLINOIS
DEPARTMENT OF TRANSPORTATION

ROUTE NO.	SECTION	COUNTY	TOTAL SHEETS	SHEET NO.
595	1-1	ROCK ISLAND	239	134
FED. ROAD DIST. NO.		ILLINOIS	FED. AID PROJECT	
				Contract No. 84986

SHEET NO. 2
12 SHEETS

GENERAL NOTES

- Contractor shall be responsible for design of timber lagging (per special provisions). Lagging design shall be submitted to Engineer for approval. Quantity shown in Bill of Materials is an estimate for bidding purposes only.
- Reinforcement bars shall conform to the requirements of AASHTO M31 or M322 Grade 60.
- All exposed edges of the concrete caps shall be chamfered $\frac{3}{4}$ " unless noted otherwise.
- All soldier piles shall be AASHTO M 270 Grade 50.
- For drainage details (inlets, storm sewers, pipe drains, etc. See roadway plan and profile sheets and drainage and utility sheets.
- Apply protective coat to all exposed concrete surfaces of the wall facing plus one foot below finished grade along the front of wall and one foot below top of wall along the back of wall.
- All construction joints shall bonded.

SUGGESTED SEQUENCE OF CONSTRUCTION

- Drill holes for soldier piles. Do not excavate near these holes at this stage.
- Set Soldier Piles.
- Fill hole with concrete to specified elevation.
- Fill remainder of hole with controlled low strength material.
- Begin earth excavation. Remove only earth and controlled low strength material as necessary to install timber lagging.
- Install geocomposite wall drain and pipe underdrain.
- Install stud shear connectors.
- Construct concrete wall facing.
- Install Pedestrian Railing.

RETAINING WALL "E"

Soldier Pile Schedule									
Pile No.	Pile Size	Station	Offset	Pile Tip Elevation	Approximate Top of Rock Elevation	Top of Pile Elevation	Length (ft)	Approximate Top of Concrete Encasement	No. of Studs Per Pile
1	W18x71	302+52.03	38.63	573.45	581.33	596.44	23.0	595.70	1
2	W18x71	302+59.53	38.63	574.25	582.54	598.70	24.5	596.50	2
3	W18x71	302+67.09	38.49	574.95	583.75	600.95	26.0	597.20	3
4	W18x71	302+74.59	38.21	575.75	584.97	603.20	27.5	598.00	4
5	W18x71	302+82.08	37.94	576.45	586.18	605.45	29.0	598.70	5
6	W18x71	302+89.57	37.66	577.25	587.39	607.71	30.5	599.50	6
7	W24x103	303+02.42	36.75	572.10	588.03	609.33	37.2	600.10	7
8	W24x103	303+08.39	36.08	572.70	588.08	610.34	37.6	600.70	7
9	W24x103	303+14.35	35.41	573.30	588.13	611.34	38.0	601.30	8
10	W24x103	303+20.31	34.75	573.90	588.18	612.34	38.4	601.90	8
11	W24x103	303+26.35	33.95	574.50	588.23	613.35	38.9	602.50	8
12	W24x103	303+32.27	32.97	575.00	588.23	614.35	39.4	603.00	8
13	W24x103	303+38.20	32.02	575.60	588.18	615.34	39.7	603.60	9
14	W24x103	303+44.12	31.07	576.20	588.13	616.34	40.1	604.20	9
15	W24x103	303+50.05	30.12	576.70	588.08	617.31	40.6	604.70	9
16	W24x103	303+55.84	29.42	577.30	588.03	618.33	41.0	605.30	10
17	W24x103	303+61.82	28.94	577.80	587.97	618.98	41.2	605.80	10
18	W24x103	303+67.80	28.47	578.30	587.92	619.29	41.0	606.30	9
19	W24x103	303+73.78	27.99	578.80	587.87	619.59	40.8	606.80	9
20	W24x103	303+79.76	27.51	579.30	587.82	619.90	40.6	607.30	9
21	W24x103	303+85.59	27.16	579.80	587.77	620.20	40.4	607.80	9
22	W24x103	303+91.59	26.92	580.30	587.67	620.47	40.2	608.30	9
23	W24x103	303+97.58	26.69	580.80	587.61	620.80	40.0	608.80	9
24	W24x103	304+02.50	26.59	581.20	587.53	621.11	39.9	609.20	9
25	W24x103	304+08.33	26.59	581.70	587.37	621.28	39.6	609.70	9
26	W24x103	304+08.33	26.59	582.30	587.08	621.40	39.1	610.30	8
27	W18x71	304+09.23	31.58	598.85	587.00	622.60	23.8	621.10	2

TOTAL BILL OF MATERIAL

ITEM	UNIT	TOTAL
Structure Excavation	Cu Yd	106.4
Protective Coat	Sq Yd	75.8
Concrete Structures	Cu Yd	69.5
Stud Shear Connectors	Each	196
Untreated Timber Lagging	Sq Ft	1,594
Furnishing Soldier Piles (W Section)	Foot	978.0
Reinforcement Bars, Epoxy Coated	Pound	9,990
Pedestrian Railing	Foot	172.7
Temporary Sheet Piling	Sq Ft	104
Geocomposite Wall Drain	Sq Yd	177.1
Concrete Gutter, Type B	Foot	163.5
Drilling and Setting Soldiers Piles in Soil	Cu Ft	2954
Drilling and Setting Soldiers Piles in Rock	Cu Ft	1298
Pipe Underdrain for Structures 4"	Foot	163.5

INDEX OF DRAWINGS

Sheet No.	Title
1	General Plan and Elevation
2	General Notes and Total Bill of Material
3	Typical Section and Detail
4	Wall Plan and Elevation
5	Wall Plan and Elevation
6	Wall Plan and Elevation
7	Pedestrian Railing
8	Soil Boring Logs B-1 and B-2
9	Rock Core B-2 and Soil Boring Log B-3
10	Soil Boring Logs B-4 and B-5
11	Soil Boring Logs B-6 and B-7
12	Soil Boring Log B-7

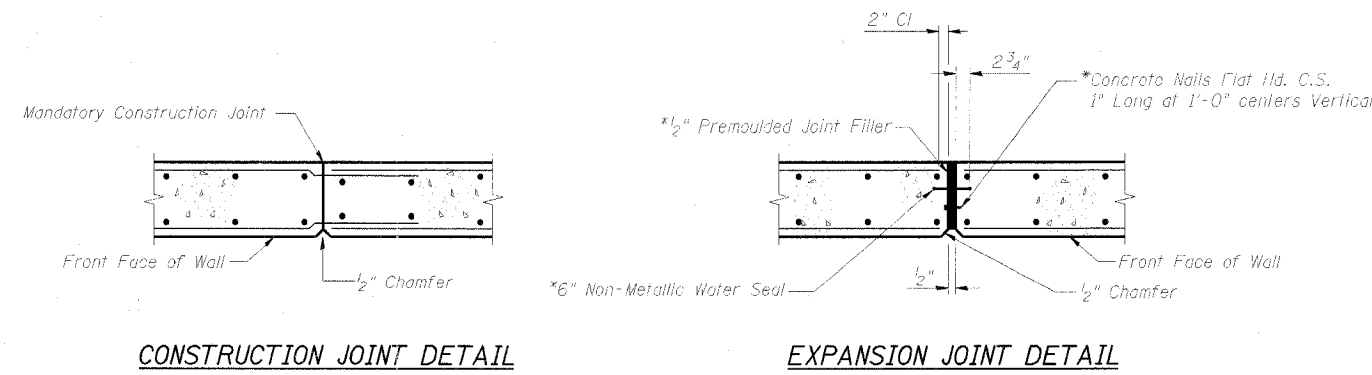

RETAINING WALL JOINT DETAILS

DESIGNED	-	NDR
CHECKED	-	DSE
DRAWN	-	RTT
CHECKED	-	DSE
DATE		JAN 31, 2006

Illinois Firm Registration No. 04-00533

850 West Higgins Road, Suite 730, Chicago, Illinois 60631-2808
www.stanleygroup.com

GENERAL NOTES AND TOTAL BILL OF MATERIAL
RETAINING WALL E ALONG
30TH STREET
FA 595 (IL ROUTE 5) SECTION 1-1
ROCK ISLAND COUNTY
STA 302+50.00 TO STA 304+10.00
STRUCTURE NO. 081-W007