

FED. AID RT. NO.	SECTION	COUNTY	TOTAL SHEETS	SHEET NO.
F.A.P. 595	1-1	ROCK ISLAND	229	102

FED. ROAD DIST. NO. 7 ILLINOIS PROJECT
SHEET 3 OF 15.

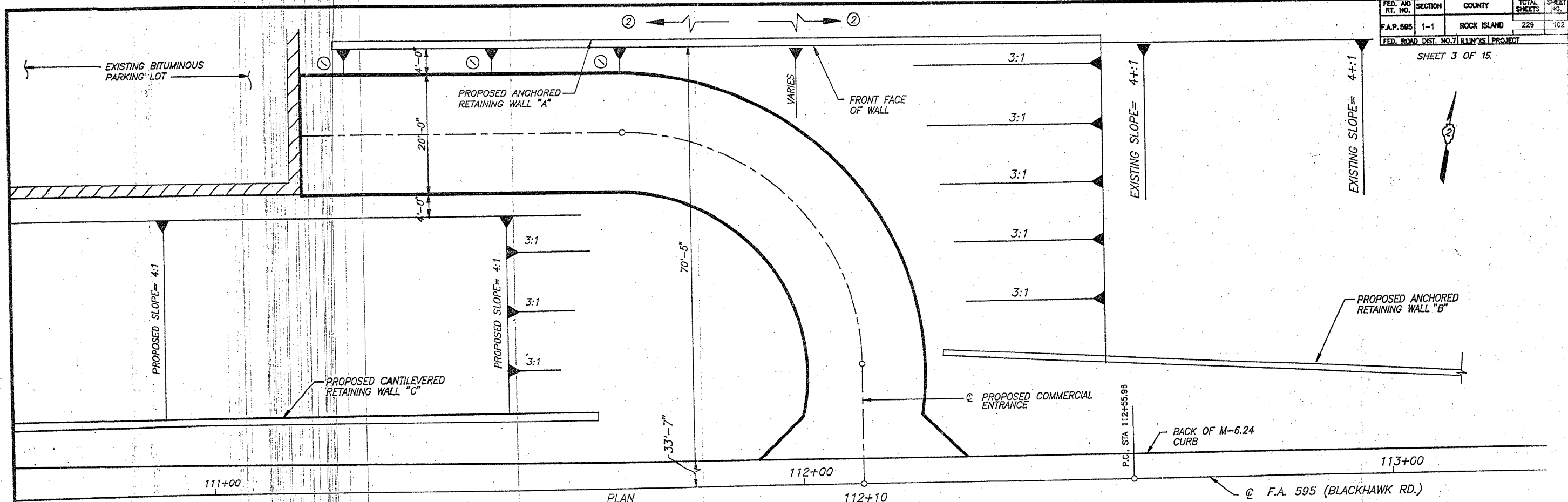

- PLAN**
- ① SLOPE = 1/2" / FT.
 - ② PROVIDE 132' OF PAVED DITCH BEHIND WALL "A"

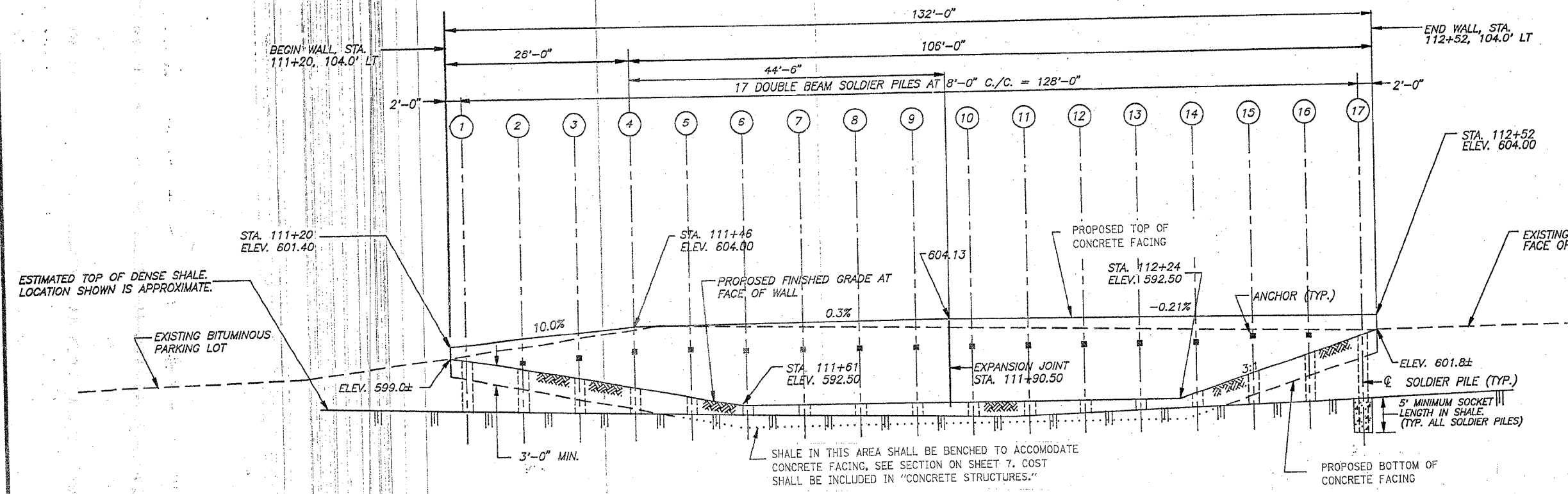

NOTE: FOR TYPICAL WALL SECTIONS AND DETAILS, SEE SHEETS #6, #7, AND #8.

ELEVATION

WALL PLAN AND ELEVATION
RETAINING WALL "A"
F.A. RTE. 595 SECTION 1-1
ROCK ISLAND COUNTY