

F.A. RTE.	SECTION	COUNTY	TOTAL SHEETS	SHEET NO.
595	1 - 1	ROCK ISLAND	239	57
STA. 76+50.00		TO STA. 116+00.00		
FED. ROAD DIST. NO.		ILLINOIS FED. AID PROJECT		
CONTRACT # 84986				

SHEET LEGEND

- ➔ INDICATES DIRECTION OF ONE LANE OF TRAFFIC
- BARRICADE OR DRUM WITH MONODIRECTIONAL STEADY BURN LIGHT
- H VERTICAL BARRICADE
- I TYPE III BARRICADE

⚠ DAYTIME LANE CLOSURE WITH FLAGGERS AS PER STD 701501 MAY BE USED FOR STORM SEWER CONSTRUCTION. THE BACKFILL AND PAVEMENT RESTORATION WITHIN THE TRAFFIC LANE MUST BE COMPLETED PRIOR TO EVENING SHUTDOWN.

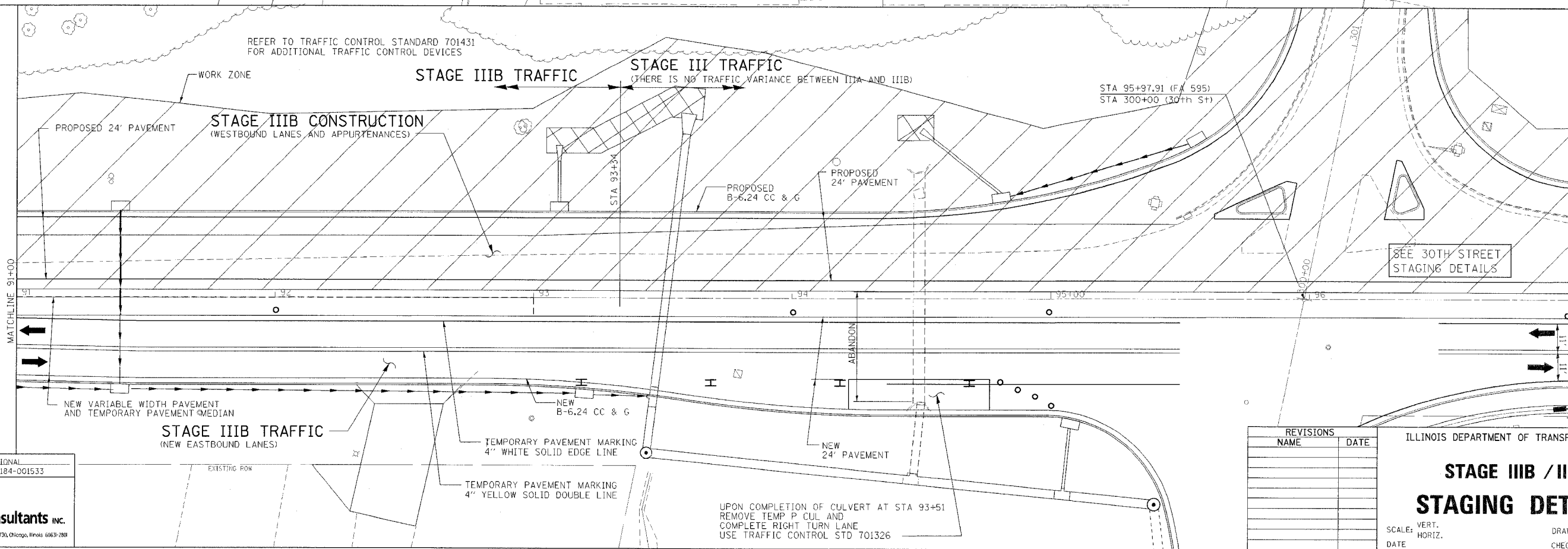
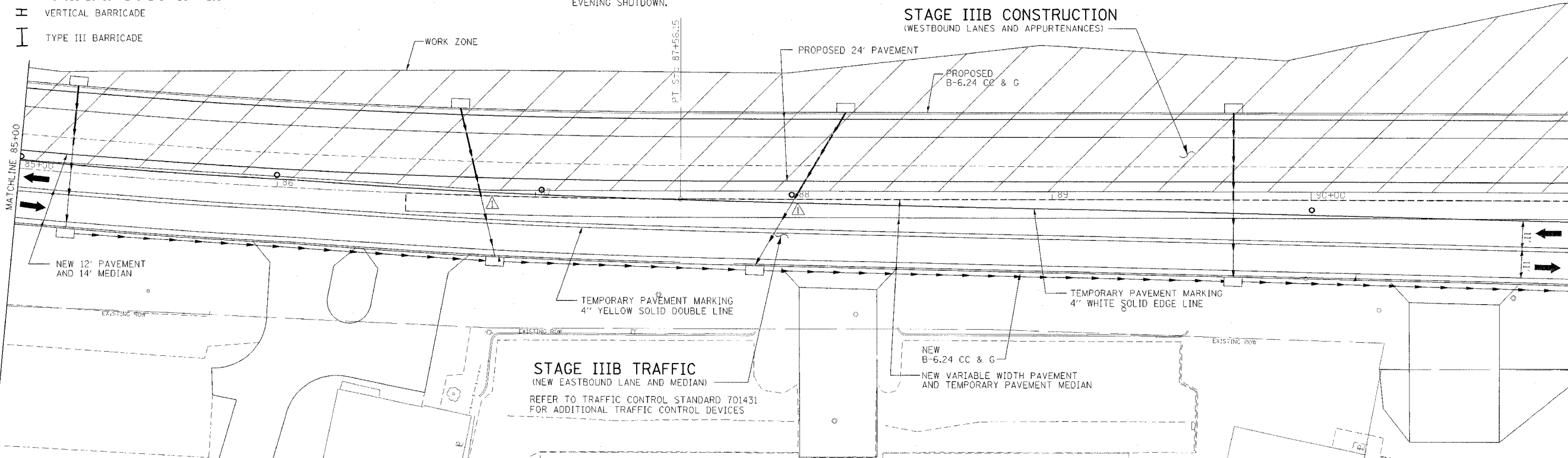

ILLINOIS PROFESSIONAL DESIGN FIRM NO. 184-001533

150 West Higgins Road, Suite 130, Chicago, Illinois 60639-2801
www.stanleygroup.com

REVISIONS	
NAME	DATE

ILLINOIS DEPARTMENT OF TRANSPORTATION

STAGE IIIB / III STAGING DETAILS

SCALE: VERT. _____
HORIZ. _____

DATE _____

DRAWN BY _____
CHECKED BY _____

UPON COMPLETION OF CULVERT AT STA 93+51 REMOVE TEMP P CUL AND COMPLETE RIGHT TURN LANE USE TRAFFIC CONTROL STD 701326