

F.A. RTE.	SECTION	COUNTY	TOTAL SHEETS	SHEET NO.
595	1 - 1	ROCK ISLAND	239	56
STA. 76+50.00		TO STA. 116+00.00		
FED. ROAD DIST. NO.	ILLINOIS	FED. AID PROJECT		
CONTRACT # 84986				

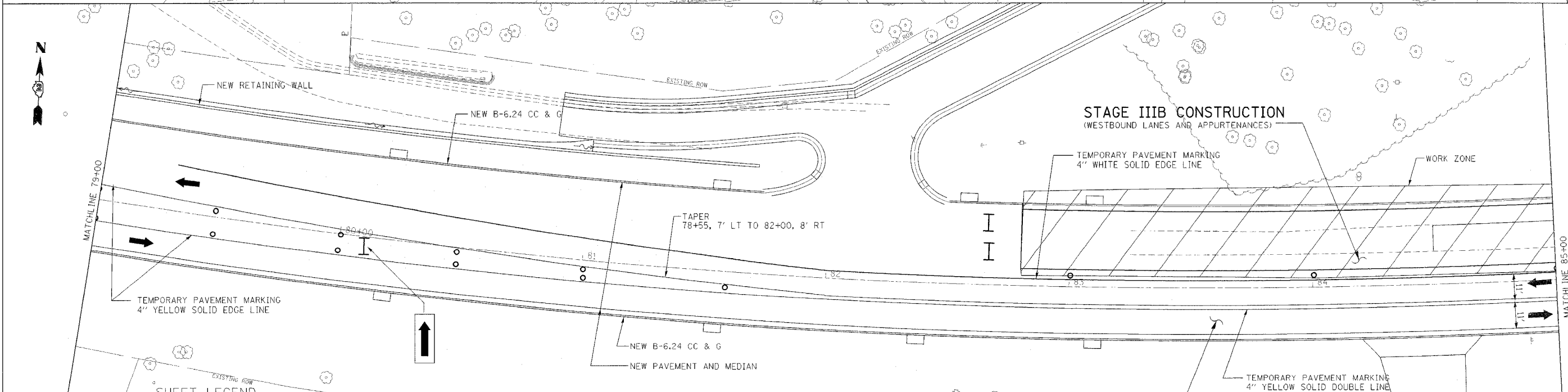
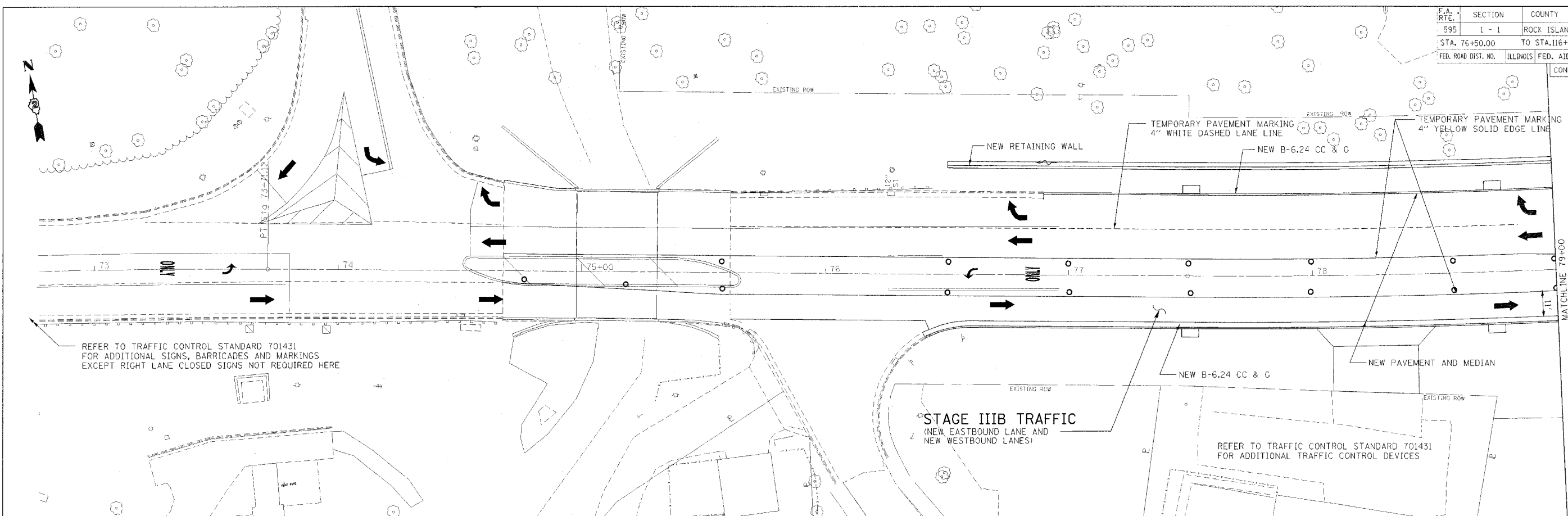

- SHEET LEGEND**
- ➔ INDICATES DIRECTION OF ONE LANE OF TRAFFIC
  - BARRICADE OR DRUM WITH MONODIRECTIONAL STEADY BURN LIGHT
  - ⌚ VERTICAL BARRICADE
  - ⌚ TYPE III BARRICADE
  - ➔ DIRECTION INDICATOR BARRICADE WITH STEADY BURN MONODIRECTIONAL LIGHT

ILLINOIS PROFESSIONAL DESIGN FIRM NO. 184-001533

**Stanley Consultants INC.**

850 West Higgins Road, Suite 730, Chicago, Illinois 60637-2801  
www.stanleygroup.com

**STAGE IIIB TRAFFIC**  
(NEW EASTBOUND LANE AND MEDIAN)

REFER TO TRAFFIC CONTROL STANDARD 701431 FOR ADDITIONAL TRAFFIC CONTROL DEVICES

REVISIONS	
NAME	DATE

ILLINOIS DEPARTMENT OF TRANSPORTATION

**STAGE IIIB STAGING DETAILS**

SCALE: VERT. \_\_\_\_\_  
HORIZ. \_\_\_\_\_

DRAWN BY \_\_\_\_\_  
CHECKED BY \_\_\_\_\_