

F.A. RTE.	SECTION	COUNTY	TOTAL SHEETS	SHEET NO.
595	1 - 1	ROCK ISLAND	239	46
STA. 76+50.00		TO STA. 116+00.00		
FED. ROAD DIST. NO.	ILLINOIS	FED. AID PROJECT		
CONTRACT # 84986				

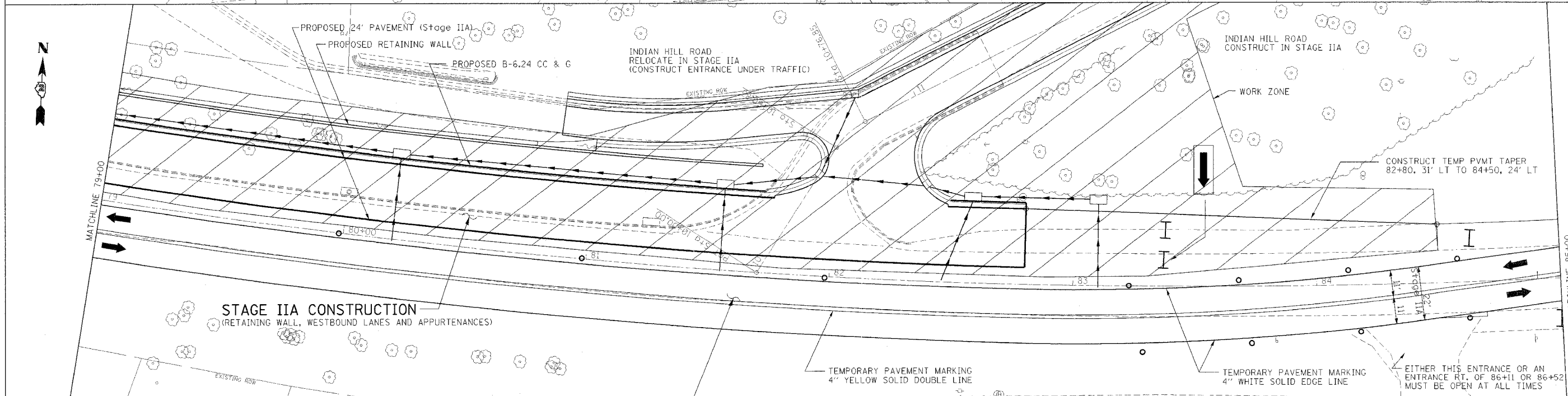
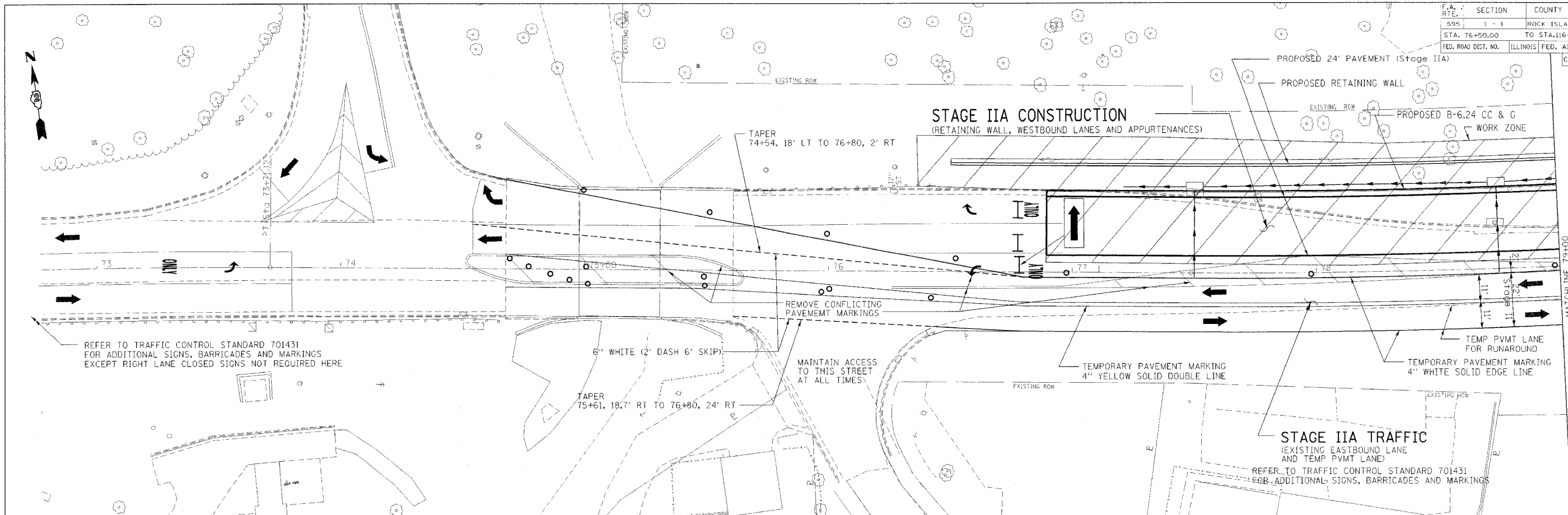

- SHEET LEGEND**
- ➔ INDICATES DIRECTION OF ONE LANE OF TRAFFIC
  - BARRICADE OR DRUM WITH MONODIRECTIONAL STEADY BURN LIGHT
  - ⊥ VERTICAL BARRICADE
  - ⊥ TYPE III BARRICADE

ILLINOIS PROFESSIONAL DESIGN FIRM NO. 184-001533

**Stanley Consultants INC.**  
850 West Higgins Road, Suite 750, Chicago, Illinois 60631-2801  
www.stanleygrp.com

REVISIONS	
NAME	DATE

ILLINOIS DEPARTMENT OF TRANSPORTATION

**STAGE IIA STAGING DETAILS**

SCALE: VERT. \_\_\_\_\_  
HORIZ. \_\_\_\_\_

DATE \_\_\_\_\_

DRAWN BY \_\_\_\_\_  
CHECKED BY \_\_\_\_\_