

FAP NO.	SECTION	COUNTY	TOTAL SHEETS	SHEET NO.
330	(102 & 102X) LS	COOK	14	10
STA.	0+00	TO STA.	16+00	
FED. ROAD DIST. NO.	1	ILLINOIS	FED. AID PROJECT	

D-91-227-05

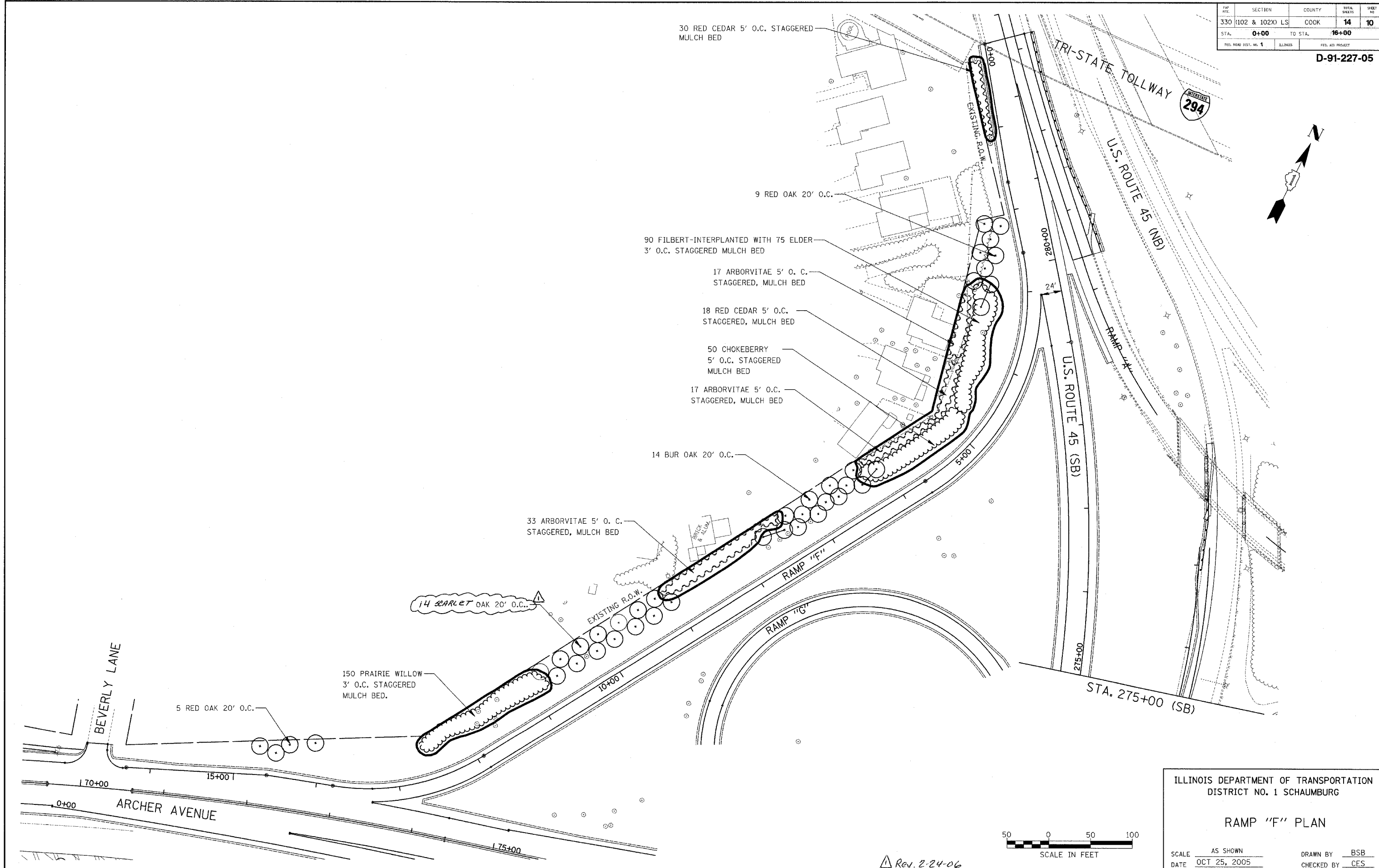

Rev. 2-24-06

ILLINOIS DEPARTMENT OF TRANSPORTATION
DISTRICT NO. 1 SCHAUMBURG

RAMP "F" PLAN

SCALE AS SHOWN
DATE OCT 25, 2005

DRAWN BY BSB
CHECKED BY CFS