

PROFILE	DATE
BY	
REVISIONS	
NOTED	
GRADES CHECKED	
STRUCTURE NOTATIONS CHECKED	
NO.	

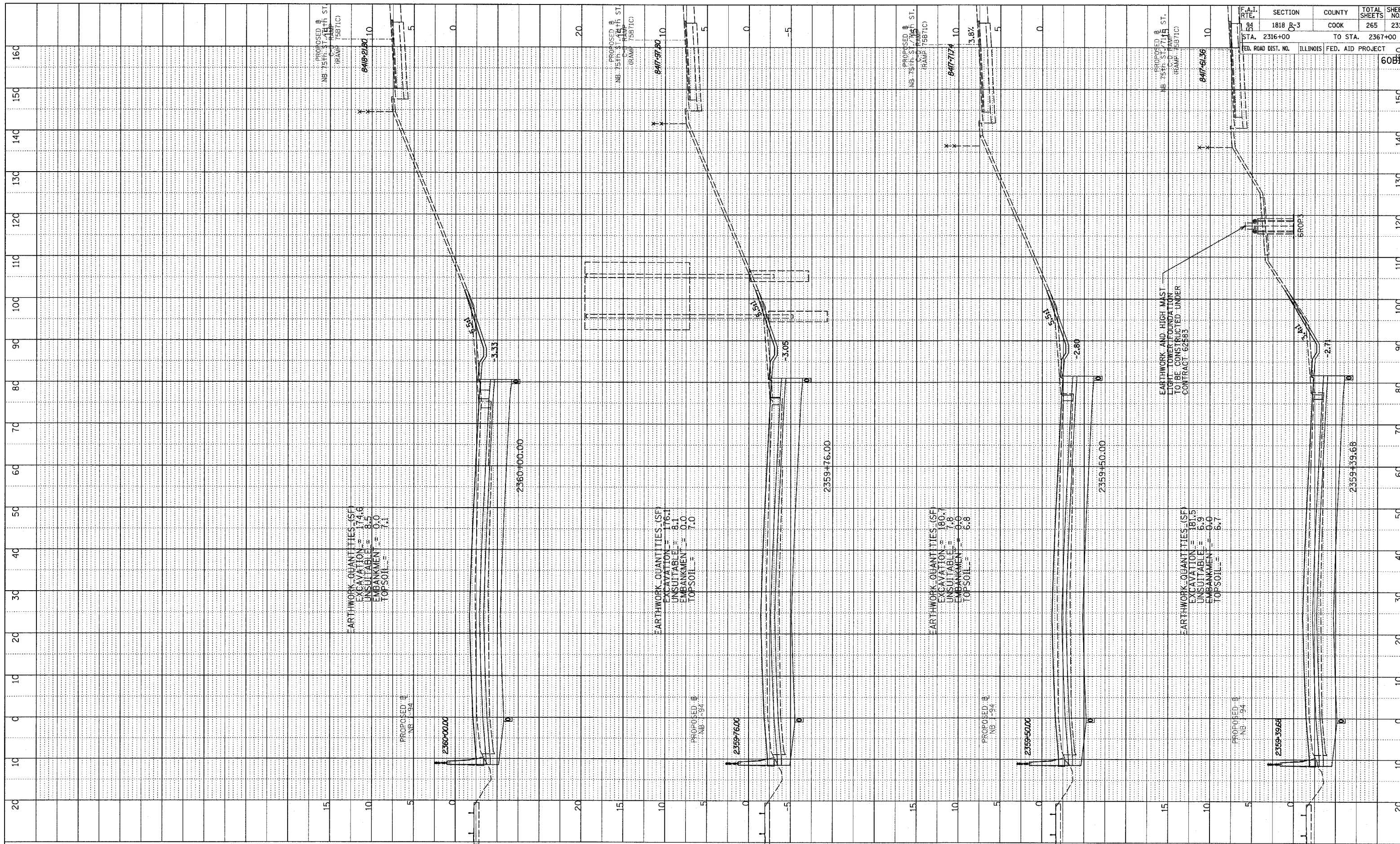

F.A.I. RTE.	SECTION	COUNTY	TOTAL SHEETS	SHEET NO.
84	1818 B-3	COOK	265	231
STA. 2316+00	TO STA. 2367+00		60887	
FED. ROAD DIST. NO.	ILLINOIS	FED. AID PROJECT		

TYLIN INTERNATIONAL



NORTHBOUND I-94 (DAN RYAN EXPWY)
STA. 2359+76 TO STA. 2361+00

03/03/2006 03:41:20 PM