

PROFILE SUBMITTED BY: \_\_\_\_\_ DATE: \_\_\_\_\_  
 GRADES CHECKED: \_\_\_\_\_  
 NOTE BOOK NO. \_\_\_\_\_  
 EMBANKMENT NOTATIONS: \_\_\_\_\_  
 NO. \_\_\_\_\_

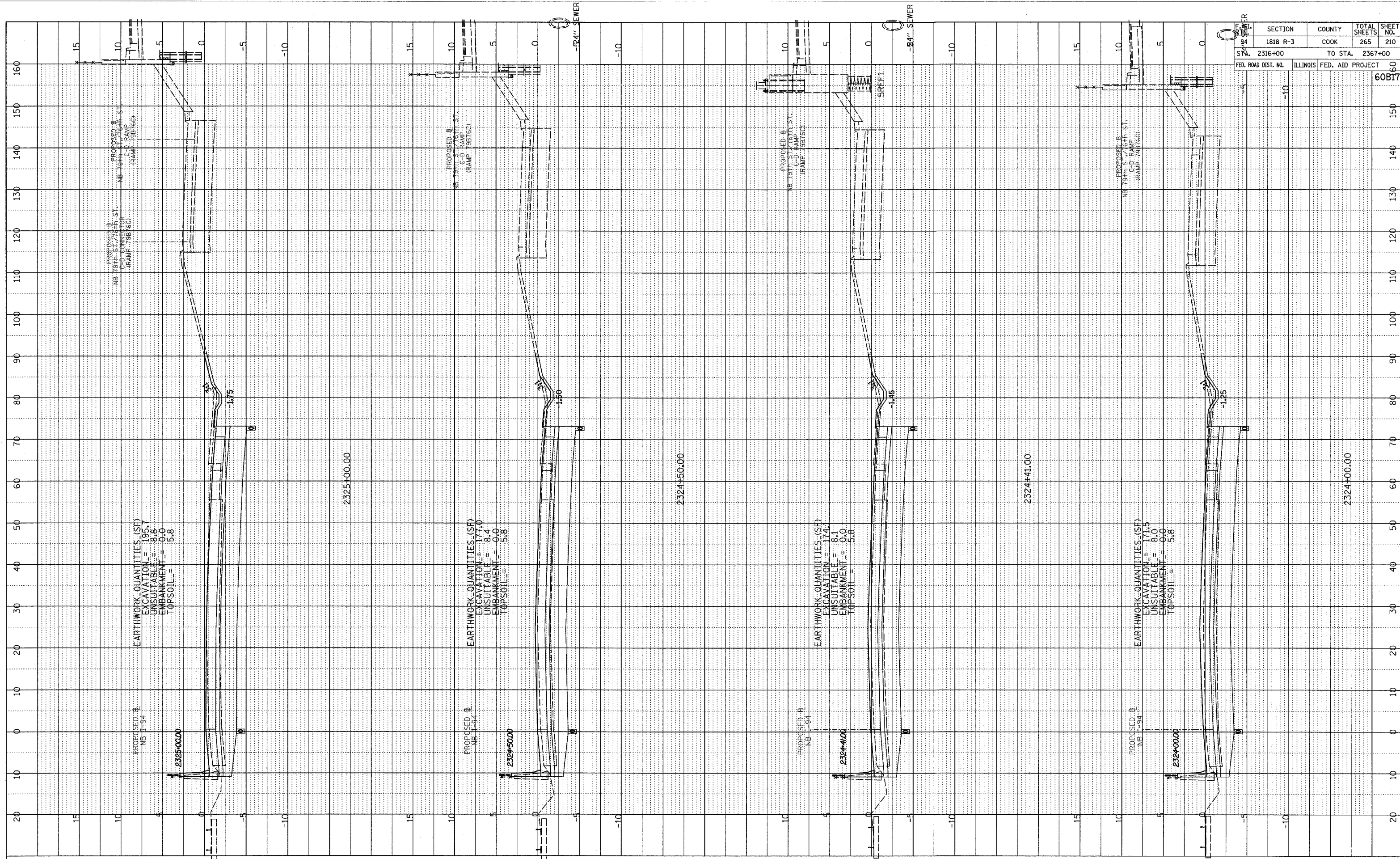

SECTION	COUNTY	TOTAL SHEETS	SHEET NO.
84	1818 R-3	COOK	265
STA. 2316+00		TO STA. 2367+00	
FED. ROAD DIST. NO.		ILLINOIS FED. AID PROJECT	
			60BT7

TYLIN INTERNATIONAL

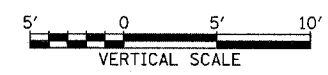
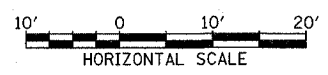

NORTHBOUND I-94 (DAN RYAN EXPWY)  
 STA. 2324+50 TO STA. 2325+89.2

03/03/2006 04:09:21 PM