

ALTERNATE ROUTE SIGNING IS BEING DONE UNDER CONTRACTS 62300 (14) AND 62302 (15). COORDINATION MAY BE REQUIRED TO ELIMINATE DUPLICATE OR CONFLICTING SIGNING.

NOTES:

1. PROPOSED DETOUR TRAILBLAZER TO BE REMOVED AFTER APPROPRIATE ENTRANCE RAMP HAS BEEN OPENED. COST SHALL BE INCLUDED IN TEMPORARY INFORMATION SIGNING. SEE SHEET 1 OF STAGE 1 CONSTRUCTION SIGNING PLANS FOR TRAILBLAZER SIZE.
2. REMOVED SIGN PANEL SHALL BECOME THE PROPERTY OF CONTRACTOR AND BE DISPOSED OFFSITE.
3. RELOCATION OF SIGNS SHALL BE INCLUDED IN THE COST OF TEMPORARY INFORMATION SIGNING.



SIGNING LEGEND:

- EXISTING GROUND MOUNTED SIGN
- EXISTING OVERHEAD TRUSS MOUNTED SIGN
- EXISTING OVERHEAD SIGN STRUCTURE-BRIDGE MOUNTED
- EXISTING OVERHEAD CANTILEVER MOUNTED SIGN
- PROPOSED GROUND MOUNTED SIGN
- PROPOSED OVERHEAD SIGN STRUCTURE - TRUSS
- CONSTRUCTION ZONE
- EXISTING SIGN
- EXISTING SIGN TO BE REMOVED
- PROPOSED SIGN

TEMPORARY INFORMATION SIGNING - 10.2 SF

NOTE 1

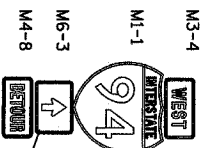

TEMPORARY INFORMATION SIGNING - 10.2 SF

NOTE 1

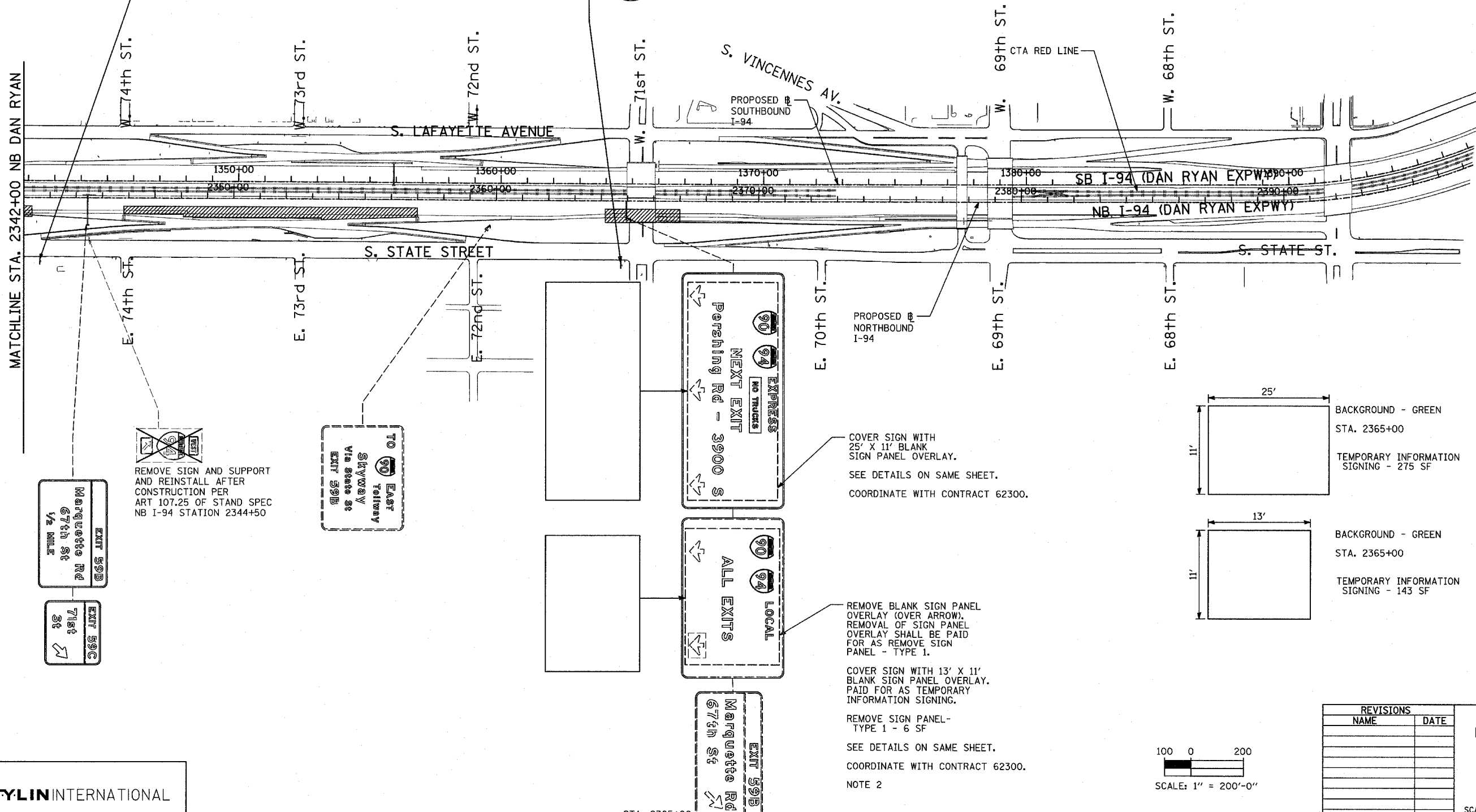
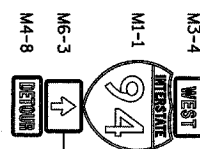

COVER SIGN WITH 25' X 11' BLANK SIGN PANEL OVERLAY. SEE DETAILS ON SAME SHEET. COORDINATE WITH CONTRACT 62300.

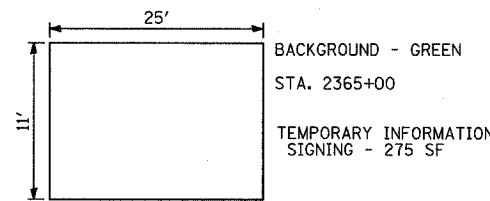

REMOVE BLANK SIGN PANEL OVERLAY (COVER ARROW). REMOVAL OF SIGN PANEL OVERLAY SHALL BE PAID FOR AS REMOVE SIGN PANEL - TYPE 1.

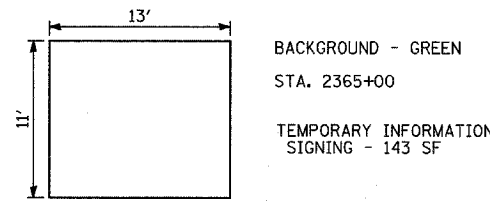

COVER SIGN WITH 13' X 11' BLANK SIGN PANEL OVERLAY. PAID FOR AS TEMPORARY INFORMATION SIGNING.

REMOVE SIGN PANEL - TYPE 1 - 6 SF

SEE DETAILS ON SAME SHEET.

COORDINATE WITH CONTRACT 62300.

NOTE 2

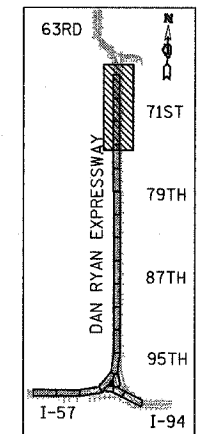
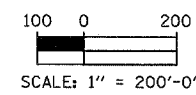

REVISIONS	
NAME	DATE

ILLINOIS DEPARTMENT OF TRANSPORTATION
F.A.I. 94 (DAN RYAN EXPRESSWAY)

CONSTRUCTION SIGNING-STAGE 1
STA. 2342+00 TO STA. 2396+00
SHEET 2 OF 2

SCALE: 1" = 200'
DATE: MARCH 7, 2006

DRAWN BY: AMB
CHECKED BY: TGB