

F.A.I. RTE.	SECTION	COUNTY	TOTAL SHEETS	SHEET NO.
94	1818 R-3	COOK	265	83
STA. 2316+00		TO STA. 2367+00		
FED. ROAD DIST. NO.		ILLINOIS FED. AID PROJECT		

60B17

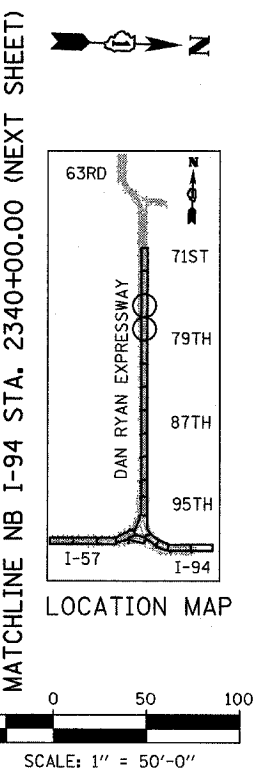
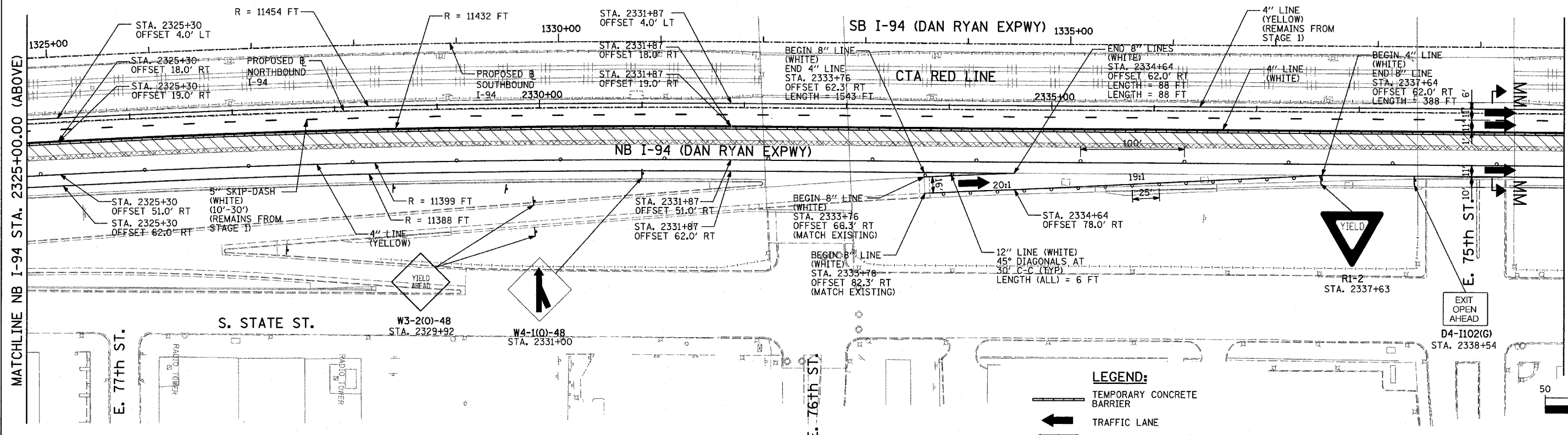
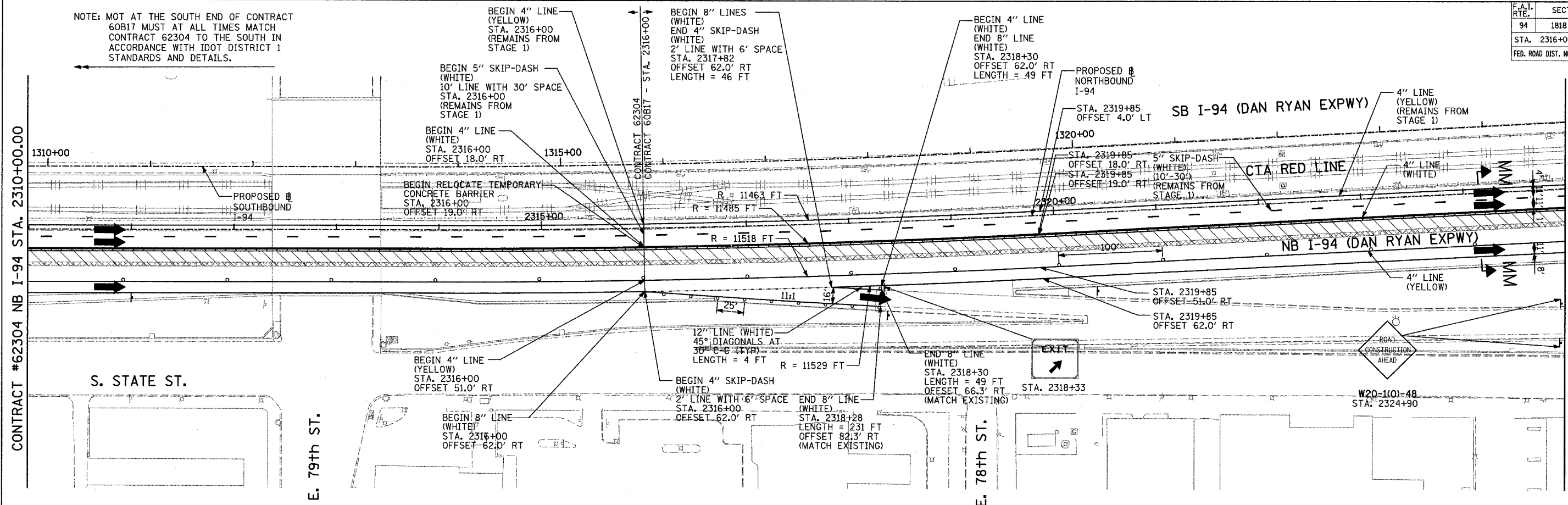

NOTE: MOT AT THE SOUTH END OF CONTRACT 60B17 MUST AT ALL TIMES MATCH CONTRACT 62304 TO THE SOUTH IN ACCORDANCE WITH IDOT DISTRICT 1 STANDARDS AND DETAILS.

NOTE:
ON ALL THE STAGE 2 PLAN SHEETS, CALLOUTS FOR TEMPORARY CONCRETE BARRIER ARE TO THE FRONT FACE OF THE WALL.

- LEGEND:**
- TEMPORARY CONCRETE BARRIER
 - TRAFFIC LANE
 - WORK ZONE
 - BARRICADE, TYPE III
 - DRUM WITH MONO-DIRECTIONAL STEADY BURNING LIGHT
 - ARROW BOARD
 - TEMPORARY PAVEMENT

REVISIONS	
NAME	DATE

ILLINOIS DEPARTMENT OF TRANSPORTATION
F.A.I. 94 (DAN RYAN EXPRESSWAY)
MAINTENANCE OF TRAFFIC PLAN
STAGE 2 - NB I-94
NB I-94 STA. 2310+00 TO 2340+00
SHEET 1 OF 2
SCALE: 1"=50'-0"
DATE: MARCH 7, 2006
DRAWN BY: RTM
CHECKED BY: JDF

TYLIN INTERNATIONAL