

F.A.I. RTE.	SECTION	COUNTY	TOTAL SHEETS	SHEET NO.
94	1818 R-3	COOK	265	44
STA. 2316+00		TO STA. 2367+00		
FED. ROAD DIST. NO.	ILLINOIS	FED. AID PROJECT		

60B17

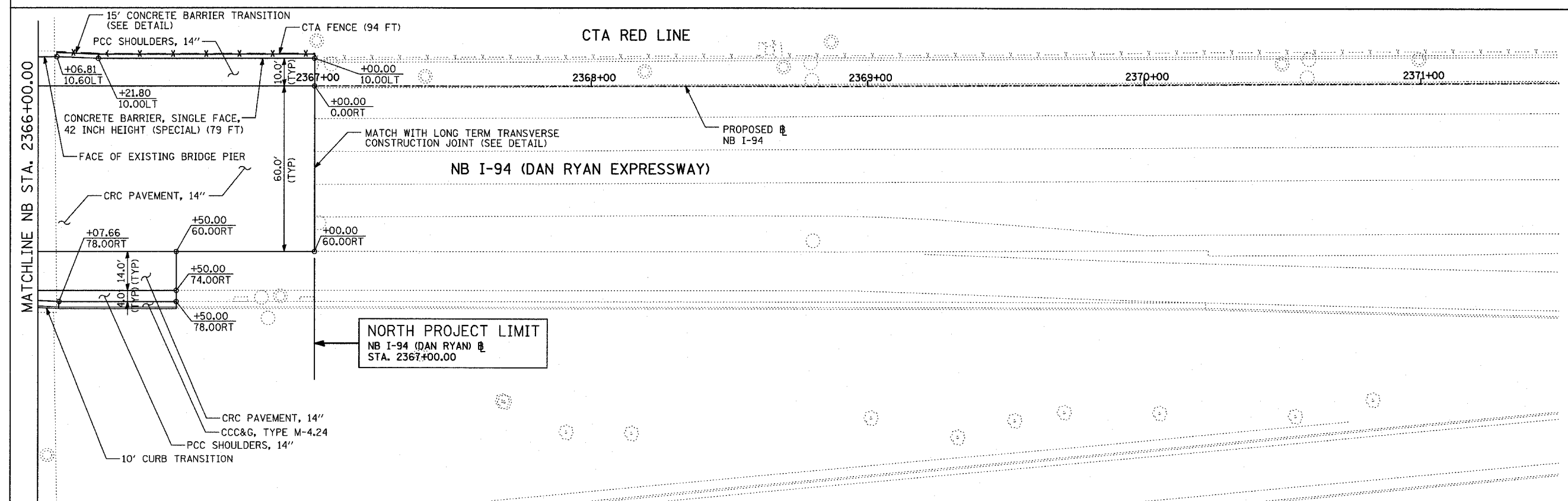

EXISTING CONDITIONS
PROPOSED IMPROVEMENTS

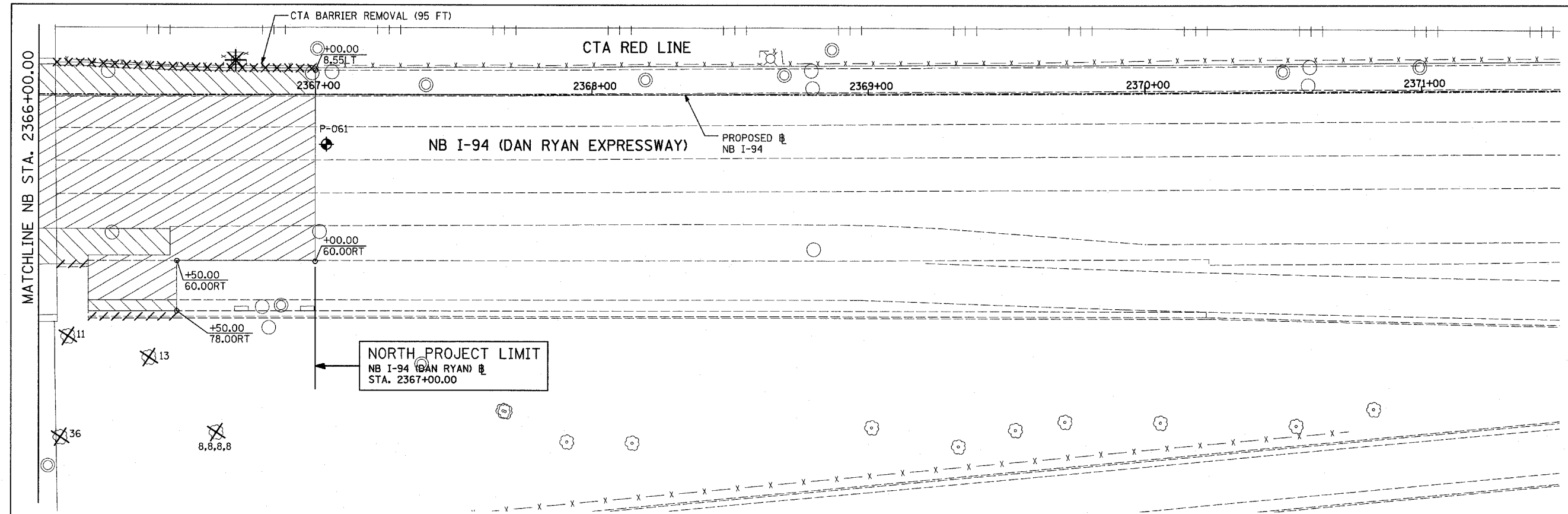
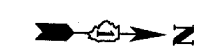
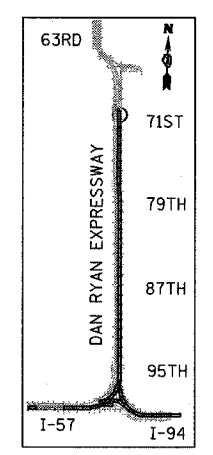
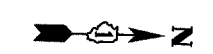

LOCATION MAP

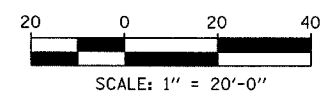

- LEGEND:**
- COMB CONC CURB & GUTTER REMOVAL
 - CHAIN LINK FENCE REMOVAL
 - CONCRETE BARRIER/GUARDRAIL REMOVAL
 - TREE REMOVAL (UNITS) (NO UNIT SHOWN = <6)
 - SOIL BORING LOCATIONS
 - PAVEMENT REMOVAL
 - PAVED SHOULDER REMOVAL
 - PAVEMENT/SHOULDER REMOVAL, SPECIAL
 - BITUMINOUS SURFACE REMOVAL, 4"
 - BITUMINOUS SURFACE REMOVAL, 1/2" OR 1 3/4" (SEE CALLOUT)
 - LIGHT POLE FOUNDATION REMOVAL (SEE ROADWAY LIGHTING & SURVEILLANCE PLANS)
 - +XX.XX MAINLINE & XX.XXRT STATION/OFFSET
- PLAN NOTES:**
- ALL STATION/OFFSET/RADIUS CALLOUTS MEASURED TO EDGE OF PAVEMENT UNLESS OTHERWISE NOTED.
 - EXACT LOCATIONS OF EXISTING PIERS/ABUTMENTS TO BE FIELD VERIFIED

REVISIONS	
NAME	DATE

ILLINOIS DEPARTMENT OF TRANSPORTATION
F.A.I. 94 (DAN RYAN EXPRESSWAY)
EXISTING AND PROPOSED PLAN
NB I-94 (DAN RYAN EXPRESSWAY)
NB I-94 STA. 2366+00.00 TO 2367+00.00

SCALE: 1"=20'
DATE: MARCH 7, 2006

DRAWN BY: RTM
CHECKED BY: MPG

TYLIN INTERNATIONAL