

F.A.I. RTE.	SECTION	COUNTY	TOTAL SHEETS	SHEET NO.
94	1818 R-3	COOK	265	35
STA. 2316+00		TO STA. 2367+00		
FED. ROAD DIST. NO.	ILLINOIS	FED. AID PROJECT		

60B17

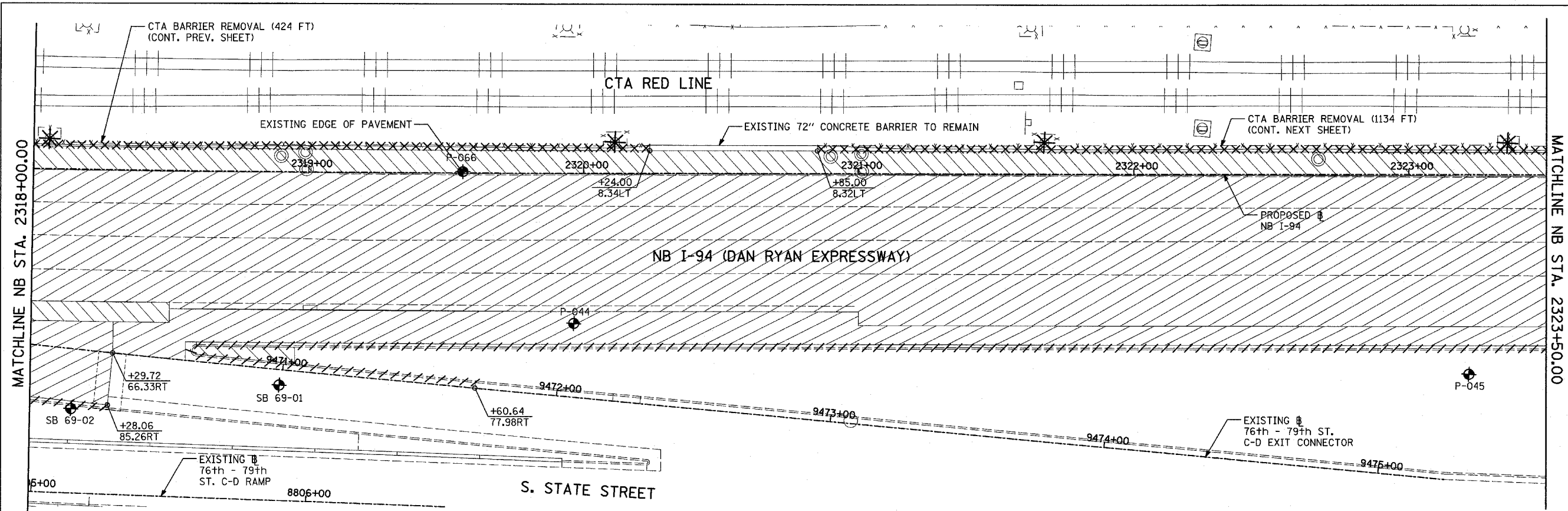

EXISTING CONDITIONS
PROPOSED IMPROVEMENTS

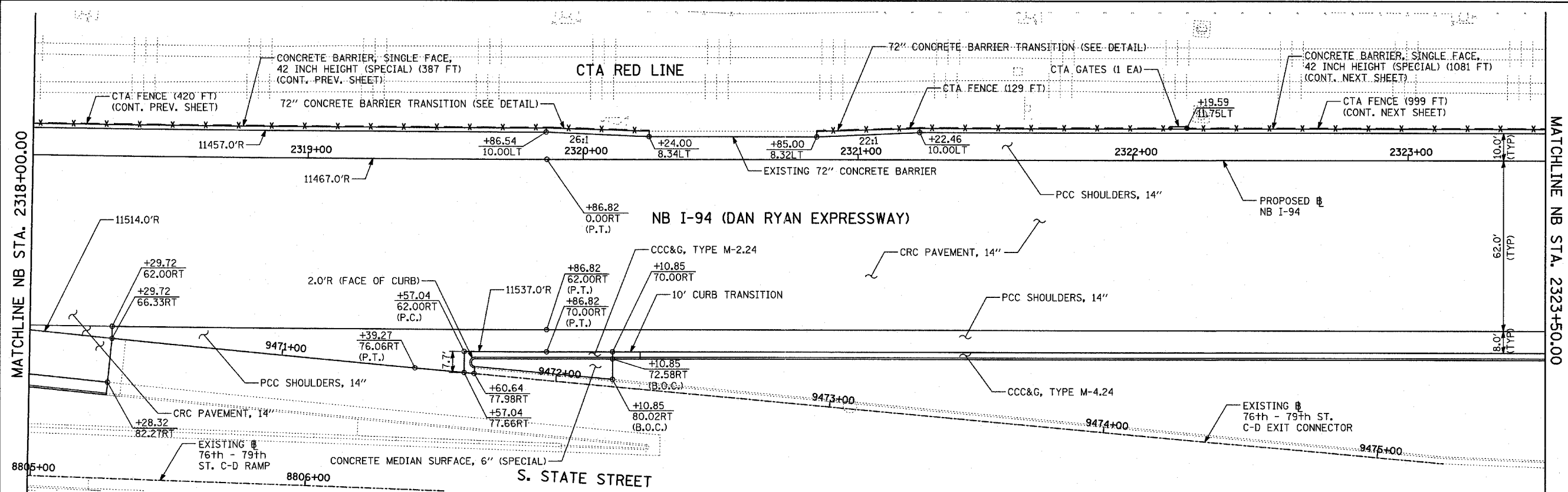

EXISTING CONDITIONS
PROPOSED IMPROVEMENTS

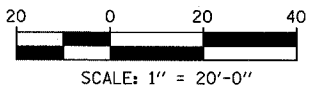
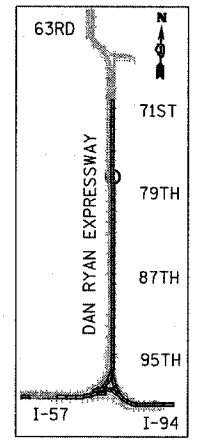

LEGEND:		LIGHT POLE FOUNDATION REMOVAL (SEE ROADWAY LIGHTING & SURVEILLANCE PLANS) +XX.XX MAINLINE # XX.XXRT STATION/OFFSET
COMB CONC CURB & GUTTER REMOVAL CHAIN LINK FENCE REMOVAL CONCRETE BARRIER/GUARDRAIL REMOVAL TREE REMOVAL (UNITS) (NO UNIT SHOWN = <6) SOIL BORING LOCATIONS	PAVEMENT REMOVAL PAVED SHOULDER REMOVAL PAVEMENT/SHOULDER REMOVAL, SPECIAL BITUMINOUS SURFACE REMOVAL, 4" BITUMINOUS SURFACE REMOVAL, 1/2" OR 1 1/4" (SEE CALLOUT)	
		PLAN NOTES: - ALL STATION/OFFSET/RADIUS CALLOUTS MEASURED TO EDGE OF PAVEMENT UNLESS OTHERWISE NOTED. - EXACT LOCATIONS OF EXISTING PIERS/ABUTMENTS TO BE FIELD VERIFIED

REVISIONS	
NAME	DATE

ILLINOIS DEPARTMENT OF TRANSPORTATION
 F.A.I. 94 (DAN RYAN EXPRESSWAY)
 EXISTING AND PROPOSED PLAN
 NB I-94 (DAN RYAN EXPRESSWAY)
 NB I-94 STA. 2318+00.00 TO 2323+50.00

SCALE: 1"=20'
 DATE: MARCH 7, 2006
 DRAWN BY: RTM
 CHECKED BY: MPG

TYLIN INTERNATIONAL