

**INDEX OF SHEETS**

- 1 TITLE SHEET/INDEX OF SHEETS
- 2 SUMMARY OF QUANTITIES AND GENERAL NOTES
- 3 ALIGNMENT, ACCESS, LIMITS AND SITE PLAN
- 4 EXISTING CONTOURS
- 5 PLAN AND PROFILE OF DANVILLE DAM
- 6 DAM REMOVAL DETAILS
- 7 WEST ABUTMENT AND PIER REMOVAL
- 8 EAST ABUTMENT REMOVAL
- 9 CENTER PIER REMOVAL
- 10 ACCESS ROAD PLAN AND PROFILE
- 11 EROSION CONTROL
- 12 EROSION CONTROL DETAILS
- 13-18 BANK STABILIZATION CROSS SECTIONS

**STANDARDS**

- 000001 STANDARD SYMBOLS, ABBREVIATIONS AND PATTERNS
- 280001 TEMPORARY EROSION CONTROL SYSTEMS
- 701901 TRAFFIC CONTROL DEVICES

**STATE OF ILLINOIS**  
**DEPARTMENT OF NATURAL RESOURCES**  
**OFFICE OF WATER RESOURCES**

**VERMILION RIVER**  
**DANVILLE DAM REMOVAL AND BANK STABILIZATION**  
**VERMILION COUNTY**

**FR-441**  
**2018**



VERMILION COUNTY

REGIONAL MAP

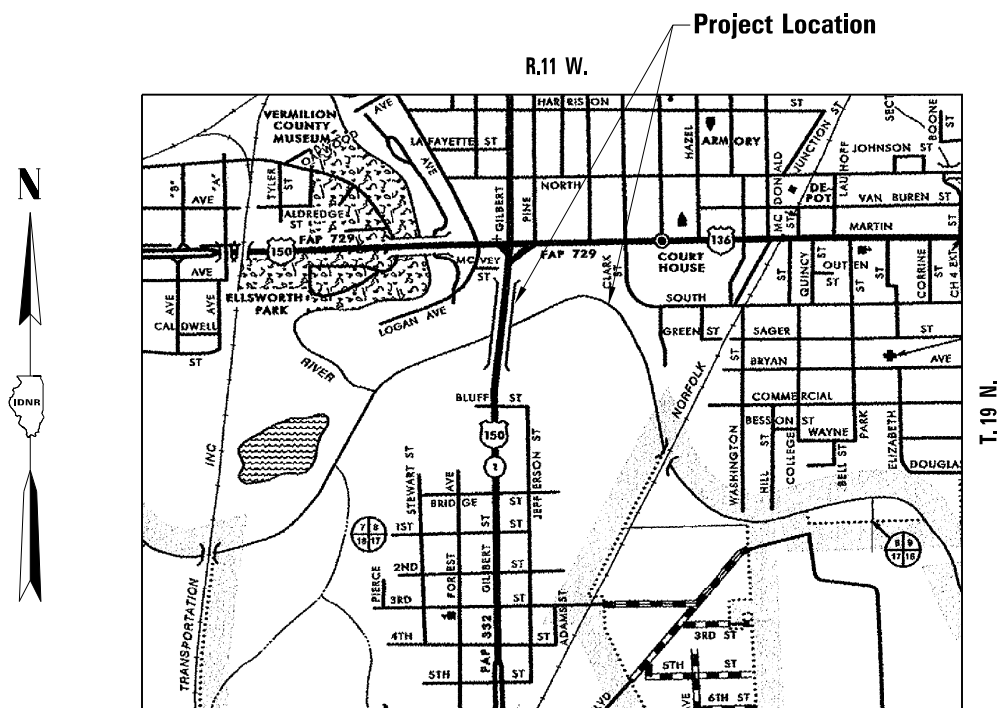

LOCATION MAP

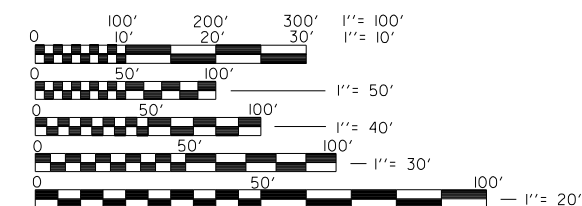
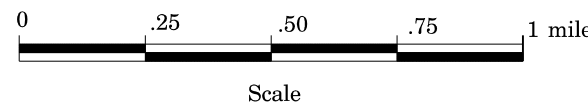

FULL SIZE PLANS HAVE BEEN PREPARED USING STANDARD ENGINEERING SCALES. REDUCED SIZED PLANS WILL NOT CONFORM TO STANDARD SCALES. IN MAKING MEASUREMENTS ON REDUCED PLANS, THE ABOVE SCALES MAY BE USED.



Ted Montrey 2/26/16  
ILLINOIS REGISTERED PROFESSIONAL ENGINEER NO. 062-049591  
LICENSE EXPIRES 11-30-17

SUBMITTED BY *[Signature]* DATE 2/26/16  
MANAGER, DIVISION OF CAPITAL PROGRAMS  
APPROVED BY *[Signature]* DATE 3/1/16  
DIRECTOR, OFFICE OF WATER RESOURCES

SUMMARY OF QUANTITIES			
CODE NO.	PAY ITEM	UNIT	QUANTITY
20300100	CHANNEL EXCAVATION	CU YD	1,743
28000250	TEMPORARY EROSION CONTROL SEEDING	POUND	315
28000400	PERIMETER EROSION BARRIER	FOOT	4,011
28200200	FILTER FABRIC	SQ YD	5,627
40201000	AGGREGATE FOR TEMPORARY ACCESS	TON	3,414
50102400	CONCRETE REMOVAL	CU YD	1,436.7
67000500	ENGINEERS FIELD OFFICE, TYPE B	MONTH	6
67100100	MOBILIZATION	L SUM	1
*NR201004	CLEARING AND TREE REMOVAL	ACRE	4.5
*NR202002	DEBRIS REMOVAL	CU YD	163
*NR202003	ORGANIC DEBRIS REMOVAL	CU YD	432
*NR250001	SEEDING, MULCHING AND FERTILIZING	ACRE	3.15
*NR280002	FLOATING TURBIDITY BARRIER, TYPE 2	FOOT	624
*NR281000	CAUSEWAY	EACH	3
*NR281101	STONE DUMPED RIPRAP, CLASS A4	CU YD	9,582
*NR704001	TRAFFIC CONTROL AND PROTECTION, SPECIAL	L SUM	1
*NR720001	WOOD INFORMATION SIGNS	EACH	2
*NR105001	CONSTRUCTION STAKING	L SUM	1

\* Indicates non-standard item covered by Special Provisions

UTILITY REFERENCE TABLE

J.U.L.I.E.	Call 48 hours prior to construction	(800) 892-0123
Electricity	Ameren IP	Martin Fuller (618) 236-6281
Water & Sewer	City of Danville	David Schnelle (217) 431-2384
	Aqua Illinois, Inc.	Jonathon Keim (217) 442-3063 x 58129
Telephone	ATT / Distribution	(630) 573-5450
	Metro Communications	Zachary Horn (217) 728-2827
Cable Television	Comcast	Rob Valentine (224) 229-3185
Fiber Optics	Windstream KDL, Inc.	Joel Schroeder Specialist-Engineering (319) 790-1514 (800) 289-1901

GENERAL NOTES

- All elevations refer to N.G.V.D. (National Geodetic Vertical Datum) 1988. All coordinates are NAD 1983 with 1997 Adjustment.
- The Contractor shall furnish, erect, and when directed by the Engineer, completely remove two construction signs (see Detail, this sheet). The location of the signs shall be determined by the Engineer in the field.
- All lateral drainage that exists prior to construction shall be restored as shown on the plans and as directed by the Engineer. Unless otherwise specified all costs of restoration shall be considered included in the Contract and no additional compensation will be allowed.
- All construction operations shall be contained within the property lines or work limits as indicated on the Plans and as directed and approved by the Engineer. It shall be the full responsibility of the Contractor to secure all rights of ingress and egress to said right-of-way including the satisfactory protection and restoration of property as required in Art. 107.20 and 107.23 of the Standard Specifications. Cost of restoration is incidental to the Contract.
- The Contractor shall call J.U.L.I.E. (800-892-0123) for the location of existing utilities 48 hours prior to beginning construction.
- Plan dimensions and details relative to existing structures have been assumed from survey data and scaling from photographs and are subject to nominal construction variations. It shall be the Contractor's responsibility to verify such dimensions and details in the field and make necessary approved adjustments prior to construction or ordering of materials. Such variations shall not be cause for additional compensation for a change in the scope of the work, however, the Contractor will be paid for the quantity actually furnished or removed at the unit price bid for the work.
- The Contractor is reminded to protect and restore at his expense, in accordance with Article 107.20 of the Standard Specifications, any private or public property, including access roads, which may be damaged or destroyed due to construction operations.
- The Contractor shall take due care while excavating near existing structures. Any damages caused by the construction activity shall be corrected at the expense of the contractor.
- All material excavated, except rock, from the existing channel must be deposited in a self-contained area in compliance with all state statutes, regulations and permit requirements with no discharge to public waters unless a permit has been issued by the Illinois Environmental Protection Agency.
- Layout of Access Road may be varied in the field to suit ground conditions as directed by the Engineer. Proposed Access Road shall follow the existing path to the greatest extent possible to minimize Tree Removal. The Proposed Access Road and Staging Area #2 shall remain in place. Staging Area #1 will be restored after completion of project.
- It is anticipated that all trees to be removed have been cut down by Others and left on site. The Contractor shall grub the stumps, perform any required clearing, and remove and dispose of any trees and/or other cleared debris within the Tree Removal Limits. If any additional Tree Removal is required and approved by the Engineer, it shall only be performed between October 1 through March 31.
- The Contractor shall contact IDNR Fisheries Biologist Trent Thomas at (217)784-4730 ext. 230 as well as Mussels Biologist Jeremy Tiemann at (217)244-4594 prior to commencing work to coordinate the construction schedule.
- It is recommended the dam removal be conducted during periods of low flow. Historically, low flow periods occur from July to January.
- The Contractor is alerted to the fact that the construction operations necessary to complete all requirements of this Contract will be performed without the use of cofferdams. If the Contractor proposes the use of cofferdams to benefit his/her construction operations, the provisions of Article 502.06 of the Standard Specifications shall apply with the EXCEPTION that all work associated with cofferdams, dewatering and cofferdam excavation shall be considered as included in the Contract. All work associated with cofferdams, dewatering and cofferdam excavation shall abide by all Federal, State and Local laws, rules and regulations.

GENERAL NOTES

Signs shall be made of 3/4" plywood or oxbord, or of metal (18 ga.). The Contractor shall furnish all material and labor for constructing and erecting the signs. The signs shall be placed prior to the starting of actual construction operations at the locations shown on Sheet 5 or as directed by the Engineer. Before any sign is erected, it shall be approved by the Engineer as to its appearance and quality of construction. The signs shall remain in place and shall be maintained in satisfactory condition until the project is accepted by the department. The Contractor shall then remove the signs and the material will become his property.

The letters on the sign shall be black mechanical style on a white background and appropriate border lines.

Paid for as Wood Information Signs.

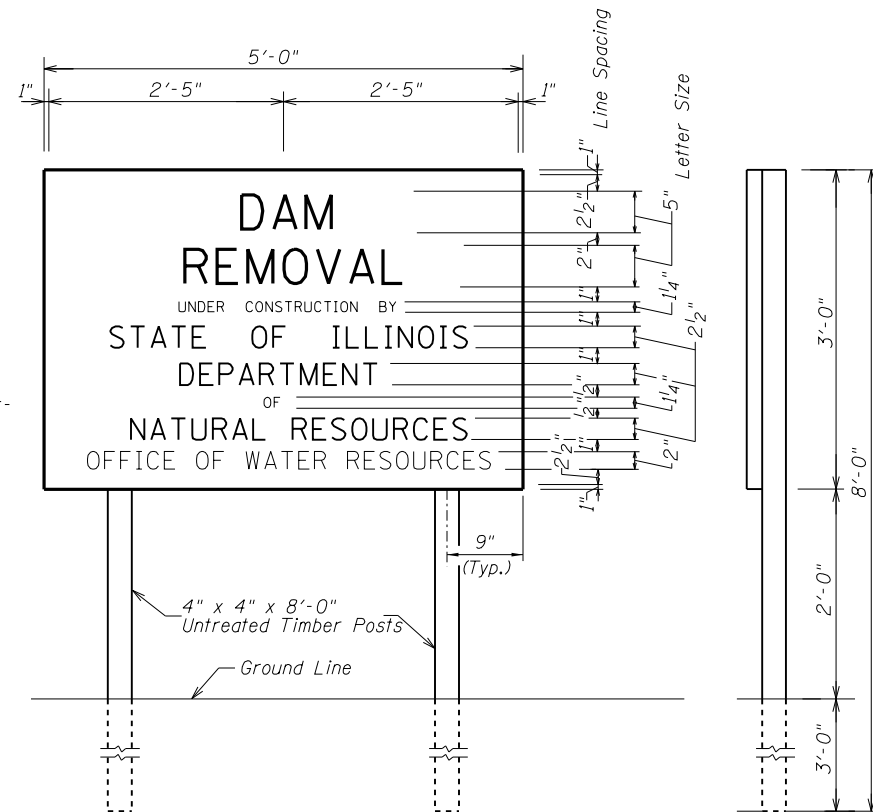

WOOD INFORMATION SIGNS

3/20/2018	DESIGNED - RJM	REVISED -
1:03:24 PM	DRAWN - RJM	REVISED -
	CHECKED - TMM	REVISED -
*SCALE*	DATE - 2-08-16	REVISED -

STATE OF ILLINOIS  
DEPARTMENT OF NATURAL RESOURCES  
OFFICE OF WATER RESOURCES

DANVILLE DAM REMOVAL AND BANK STABILIZATION

SUMMARY OF QUANTITIES AND GENERAL NOTES

COUNTY	TOTAL SHEETS	SHEET NO.
VERMILION	18	2
PROJECT FR-441		

**LEGEND**

Aggregate For Temporary Access	
Stone Dumped Riprap, Class A4	
Existing Wetland Delineation	

**WORK LIMITS**

POINT NUMBER	NORTHING	EASTING
WL1	1,258,480.11	1,179,270.45
WL2	1,258,335.87	1,179,254.36
WL3	1,258,338.74	1,179,483.61
WL4	1,258,601.51	1,179,427.78
WL5	1,258,708.58	1,179,473.15
WL10	1,259,063.74	1,180,204.21
WL11	1,259,046.00	1,180,212.87
WL12	1,258,932.69	1,180,384.24
WL13	1,259,188.74	1,180,741.72
WL14	1,259,489.01	1,180,533.66
WL15	1,259,188.76	1,180,143.65
WL16	1,259,164.16	1,180,155.64
WL17	1,258,846.45	1,179,452.56
WL18	1,259,229.22	1,179,380.55
WL19	1,259,176.38	1,179,264.52
WL20	1,258,893.80	1,179,231.63
WL21	1,258,892.44	1,179,325.70
WL22	1,258,467.06	1,179,387.52

**DANVILLE DAM REMOVAL SITE PROPOSED BASELINE COORDINATES**

STATIONS	NORTHING	EASTING
0+00.00	1,259,114.47	1,179,418.48
(PC) 5+70.00	1,259,379.38	1,179,923.18
(PI) 8+40.17	1,259,500.55	1,180,164.65
(PCC) 10+53.35	1,259,337.43	1,180,380.03
(PI) 12+74.05	1,259,204.80	1,180,556.43
(PRC) 14+61.71	1,258,984.12	1,180,553.23
(PI) 16+74.92	1,258,770.92	1,180,553.34
(PRC) 18+63.05	1,258,627.91	1,180,711.48
(PI) 19+92.02	1,258,537.46	1,180,803.40
(PT) 21+12.17	1,258,410.05	1,180,823.36
24+63.13	1,258,063.39	1,180,878.14



**CURVE DATA FOR RIVER**

PI STA. = 8+40.17	PI STA. = 12+74.05	PI STA. = 16+74.92	PI STA. = 19+92.02
Δ = 63° 47' 10" (RT)	Δ = 53° 53' 29" (RT)	Δ = 47° 50' 46" (LT)	Δ = 36° 33' 41" (RT)
D = 13° 11' 48"	D = 13° 11' 48"	D = 11° 55' 18"	D = 14° 40' 35"
R = 434.16'	R = 434.16'	R = 480.61'	R = 390.39'
T = 270.17'	T = 220.70'	T = 213.21'	T = 128.96'
L = 483.35'	L = 408.37'	L = 401.34'	L = 249.12'
E = 77.20'	E = 52.87'	E = 45.17'	E = 20.75'
P.C. STA = 5+70.00	P.C. STA = 10+53.35	P.C. STA = 14+61.71	P.C. STA = 18+63.05
P.T. STA = 10+53.35	P.T. STA = 14+61.71	P.T. STA = 18+63.05	P.T. STA = 21+12.17

3/20/2018  
1:07:16 PM  
SCALE\*

DESIGNED - RJM  
DRAWN - RJM  
CHECKED - TMM  
DATE - 2-08-16

**STATE OF ILLINOIS  
DEPARTMENT OF NATURAL RESOURCES  
OFFICE OF WATER RESOURCES**

**DANVILLE DAM REMOVAL AND BANK STABILIZATION  
ALIGNMENT, ACCESS, LIMITS AND SITE PLAN**

COUNTY TOTAL SHEETS SHEET NO.  
VERMILION 18 3  
PROJECT FR-441

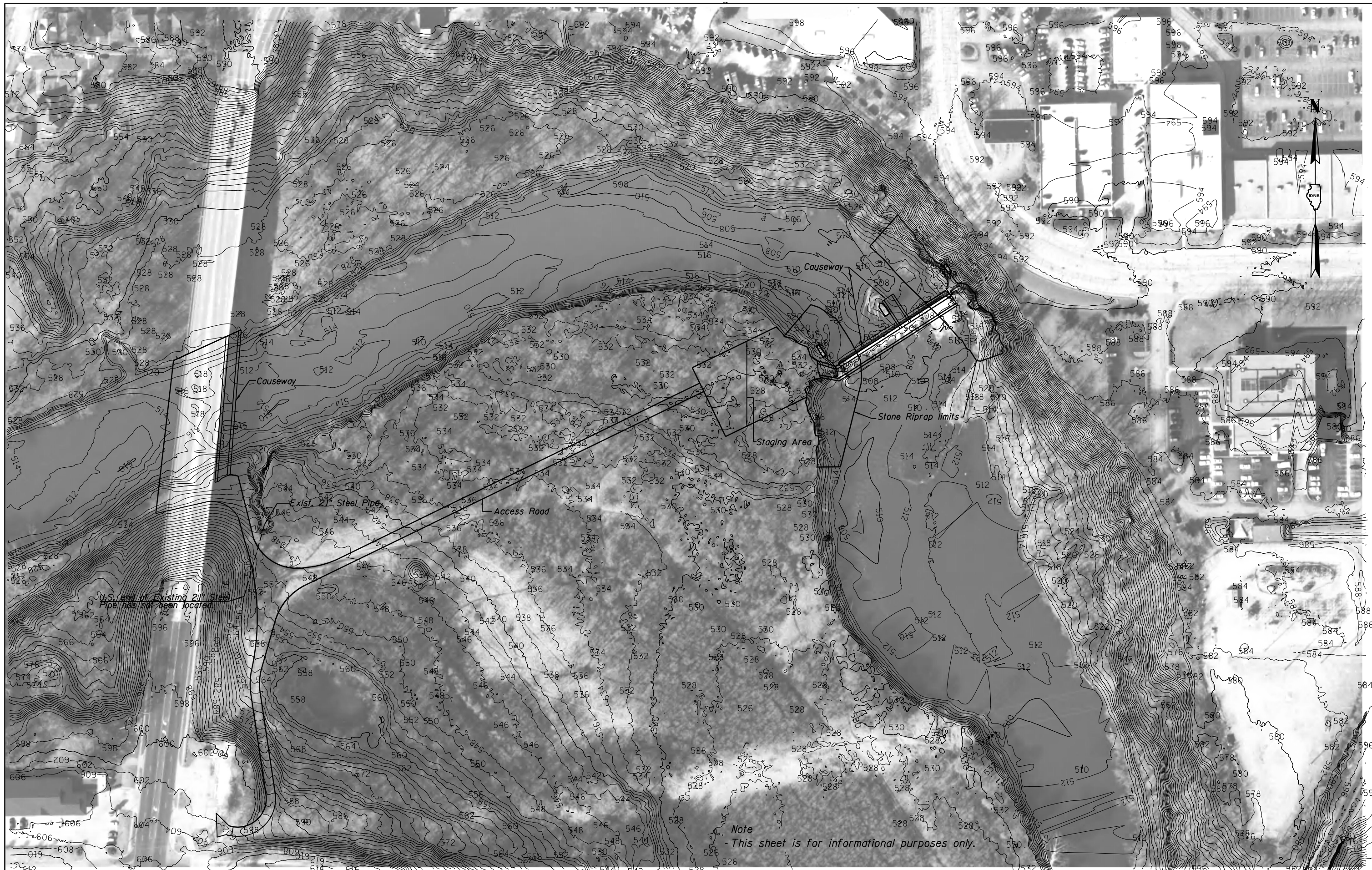

3/20/2018  
 11:53:38 PM  
 \*SCALE\*

DESIGNED - RJM	REVISED -
DRAWN - RJM	REVISED -
CHECKED - TMM	REVISED -
DATE - 2-08-16	REVISED -

**STATE OF ILLINOIS  
 DEPARTMENT OF NATURAL RESOURCES  
 OFFICE OF WATER RESOURCES**

**DANVILLE DAM REMOVAL AND BANK STABILIZATION  
 EXISTING CONTOURS**

COUNTY	TOTAL SHEETS	SHEET NO.
VERMILION	18	4
PROJECT FR-441		

DATE	
BY	
PLAN	
SURVEYED	
PLOTTED	
NOTE BOOK	
NO.	
CHECKED	
FILE NAME	

DATE	
BY	
PROFILE	
SURVEYED	
PLOTTED	
GRADES CHECKED	
NO.	
STRUCTURE	
NOTATION	
CPAD	

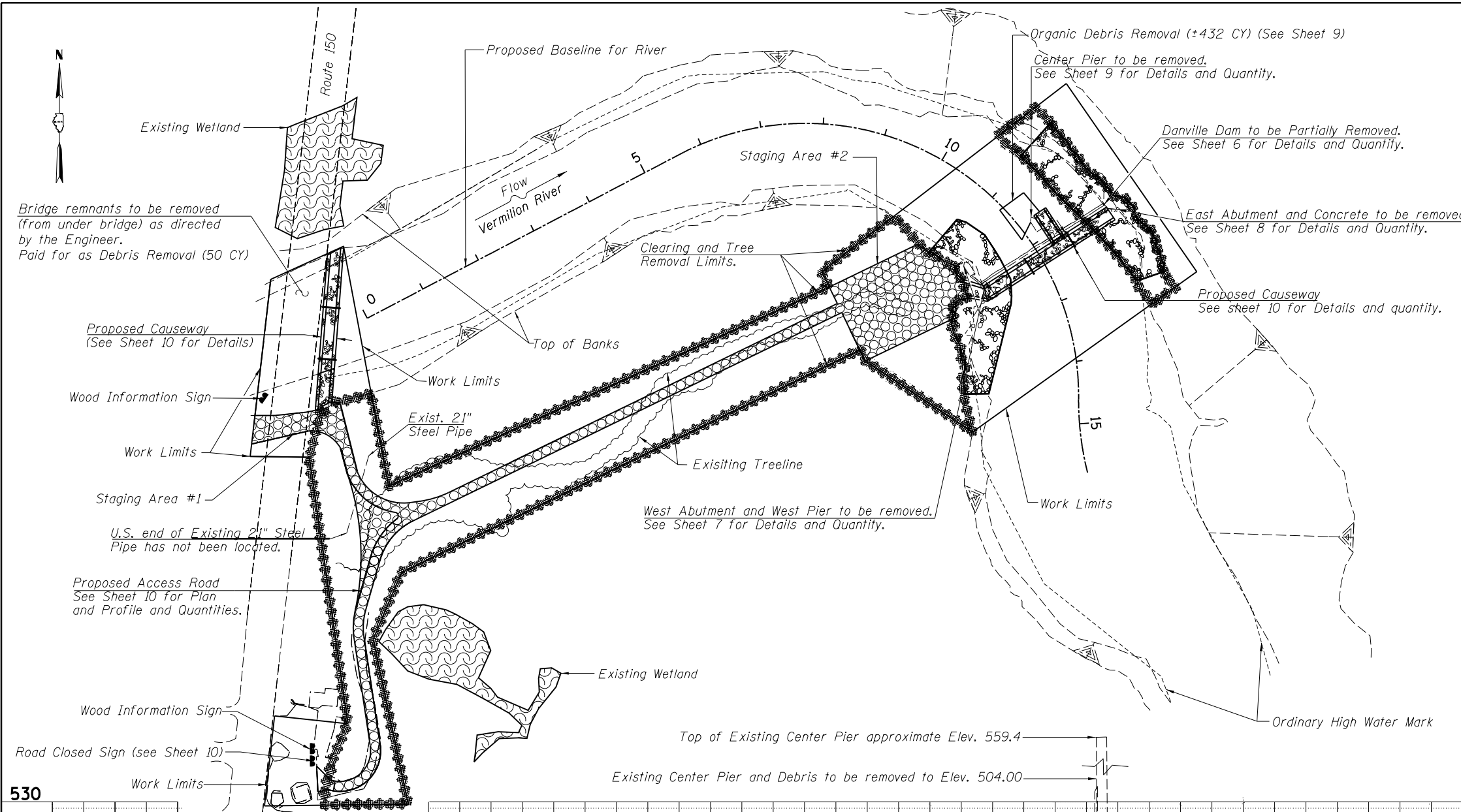

**LEGEND**

Clearing and Tree Removal, Acres	
Aggregate For Temporary Access	
Stone Dumped Riprap, Class A4	
Existing Wetland Delineation	

**BILL OF MATERIALS**

DEBRIS REMOVAL	CU YD	50
ORGANIC DEBRIS REMOVAL	CU YD	432
CLEARING AND TREE REMOVAL	ACRE	4.5
WOOD INFORMATION SIGN	EACH	2

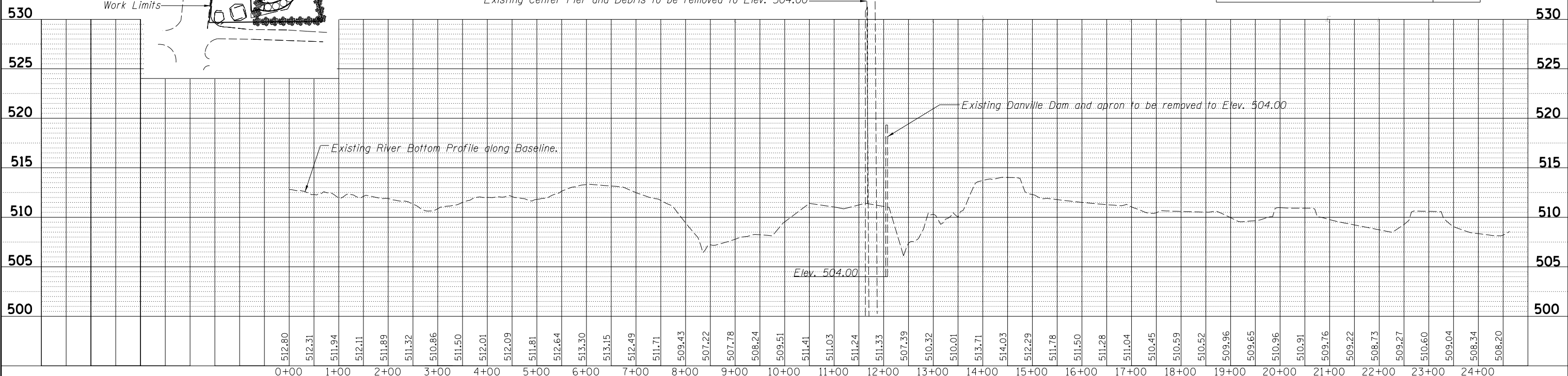

3/20/2018	DESIGNED - RJM	REVISED
1:18:05 PM	DRAWN - RJM	REVISED
	CHECKED - TMM	REVISED
	DATE - 2-08-16	REVISED

**STATE OF ILLINOIS  
DEPARTMENT OF NATURAL RESOURCES  
OFFICE OF WATER RESOURCES**

**DANVILLE DAM REMOVAL AND BANK STABILIZATION  
PLAN AND PROFILE OF DANVILLE DAM**

COUNTY	TOTAL SHEETS	SHEET NO.
VERMILION	18	5
PROJECT FR-441		

Abutment to be removed.  
See Sheet 8 for East Abutment  
Removal Details and Quantity.

Abutment to be removed.  
See Sheet 7 for West Abutment  
Removal Details and Quantity.

Center Pier to be Removed.  
See Sheet 9 for Center Pier  
Removal Details and Quantity.

West Pier to be removed.  
See Sheet 7 for West Pier  
Removal Details and Quantity.

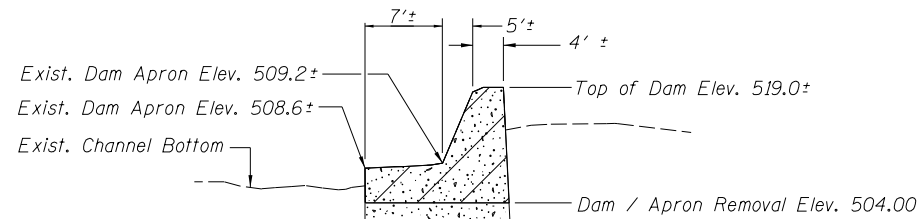

**SECTION B-B**

**PLAN VIEW OF DANVILLE DAM**

**Notes :**

\*Bottom elevation of concrete dam is unknown. Contractor is to remove existing concrete dam as shown to elevation 504. If bottom of existing concrete dam is encountered above 504, Contractor shall remove concrete to bottom of existing dam and side slopes shall be adjusted accordingly to meet existing top of bank. Transition as shown or as approved by the Engineer.

A notch can be made in the dam to stop flow over the dam crest and to allow for a dry surface on the Causeway at a lower elevation than would otherwise be available. Proposed notch dimensions shall be approved by the Engineer.

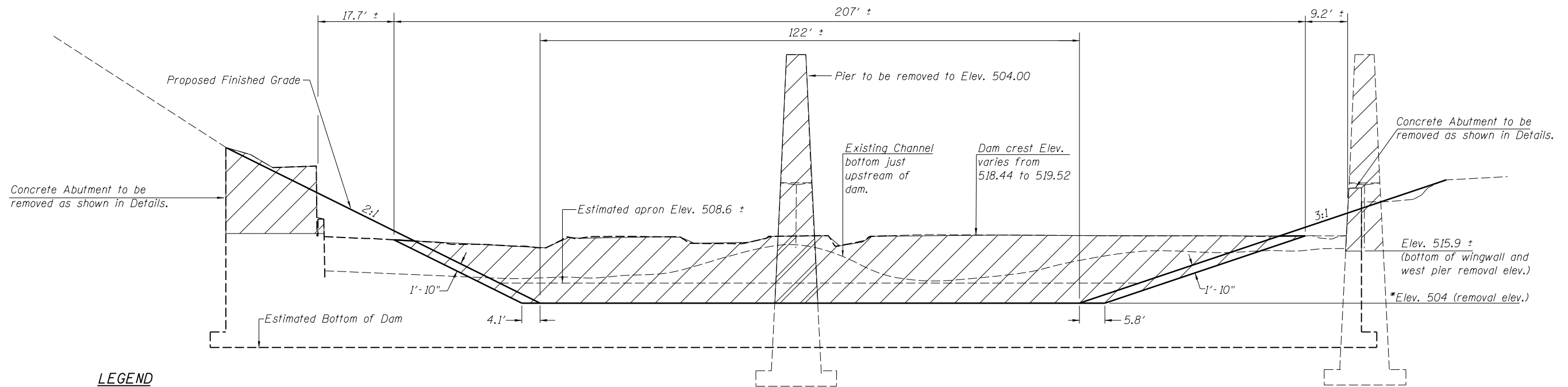

**SECTION A-A**  
(Looking Downstream)

**BILL OF MATERIAL**

CONCRETE REMOVAL	CU YD	834.5
------------------	-------	-------

Concrete Removal quantity on this sheet includes dam and apron only.

3/22/2016	DESIGNED - RJM	REVISED -
9:19:05 AM	DRAWN - RJM	REVISED -
	CHECKED - TMM	REVISED -
	DATE - 2-08-16	REVISED -

**STATE OF ILLINOIS**  
**DEPARTMENT OF NATURAL RESOURCES**  
**OFFICE OF WATER RESOURCES**

**DANVILLE DAM REMOVAL AND BANK STABILIZATION**  
**DAM REMOVAL DETAILS**

COUNTY	TOTAL SHEETS	SHEET NO.
VERMILION	18	6
PROJECT FR-441		

\*SCALE\*

Hatched area showing removal refers to pier behind the tree.



\* Any part of the Existing structure that is undermined shall be completely removed, as directed by the Engineer and quantity adjusted accordingly.

**LEGEND**



**BILL OF MATERIALS**

CONCRETE REMOVAL	CU YD	180
------------------	-------	-----

3/22/2016	DESIGNED - RJM	REVISED -	<b>STATE OF ILLINOIS DEPARTMENT OF NATURAL RESOURCES OFFICE OF WATER RESOURCES</b>	<b>DANVILLE DAM REMOVAL AND BANK STABILIZATION</b>	COUNTY	TOTAL SHEETS	SHEET NO.
9:19:43 AM	DRAWN - RJM	REVISED -				18	7
	CHECKED - TMM	REVISED -		<b>WEST ABUTMENT AND PIER REMOVAL</b>	PROJECT FR-441		
*SCALE*	DATE - 2-08-16	REVISED -					

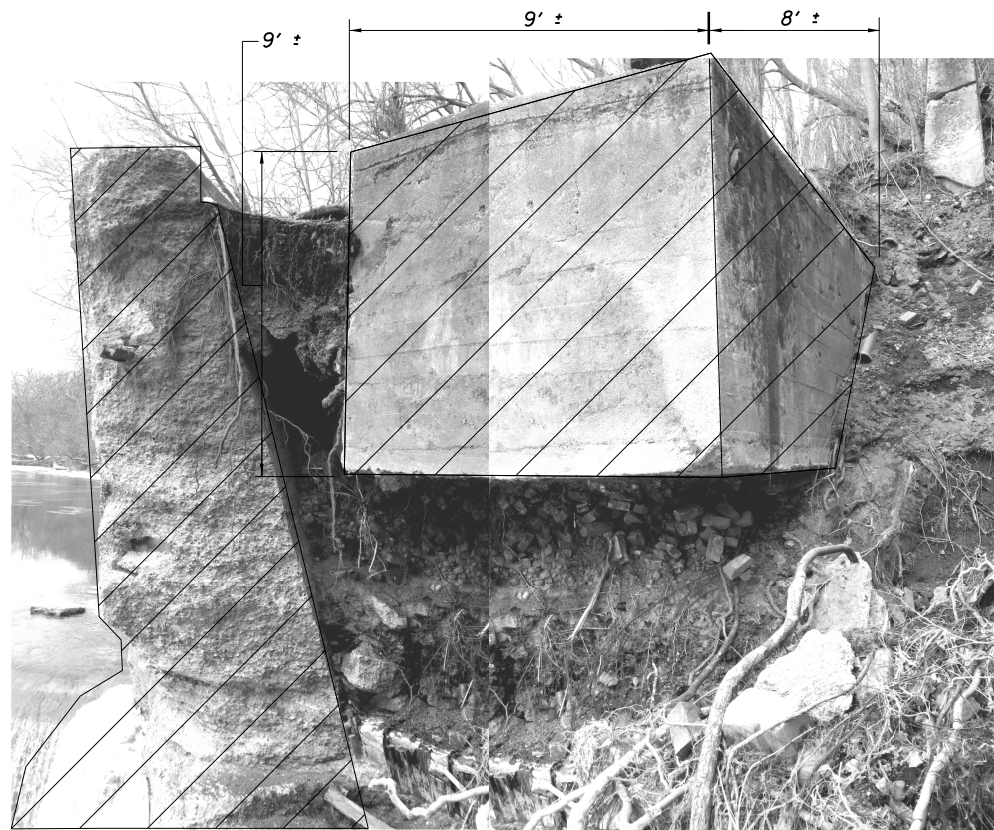

Considered as Debris Removal

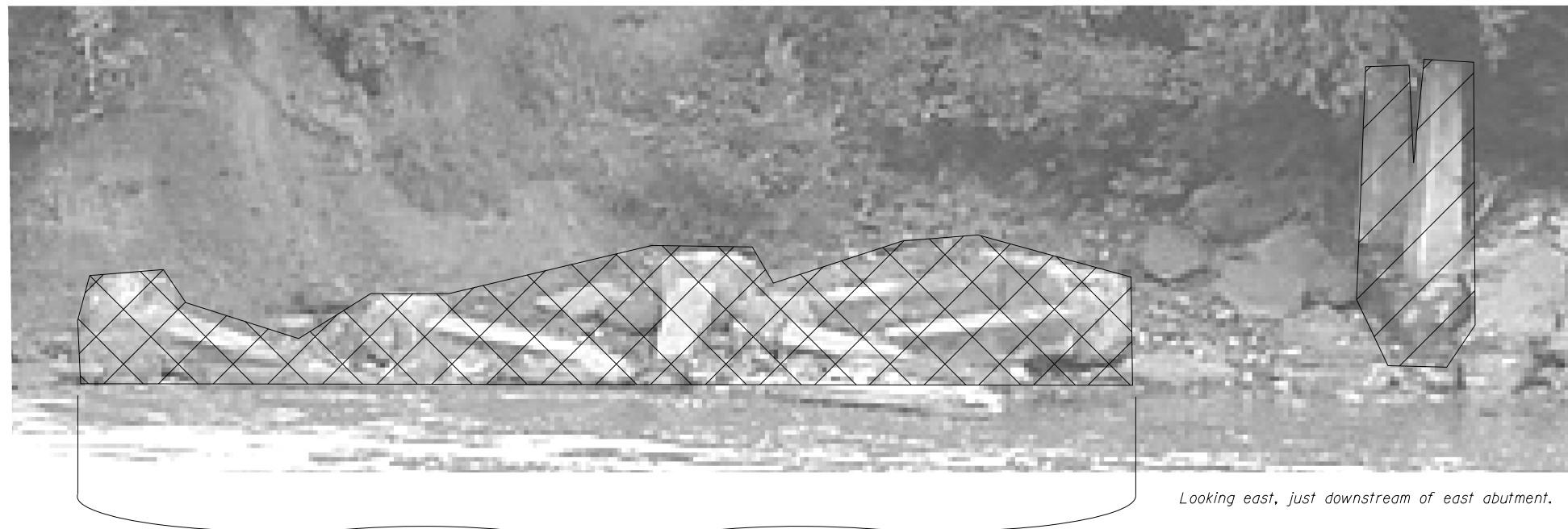

Considered as Debris Removal

**LEGEND**

Concrete Removal	
Debris Removal	

**Note:**

All concrete debris along the bank is to be removed but is not limited to what is shown. Engineer shall direct and approve final removal limits and quantity will be adjusted accordingly.

**BILL OF MATERIALS**

DEBRIS REMOVAL	CU YD	20
CONCRETE REMOVAL	CU YD	87.5

Quantity is based on what is shown in photographs.

3/22/2016	DESIGNED - RJM	REVISED -
9:21:14 AM	DRAWN - RJM	REVISED -
	CHECKED - TMM	REVISED -
*SCALE*	DATE - 2-08-16	REVISED -

**STATE OF ILLINOIS  
DEPARTMENT OF NATURAL RESOURCES  
OFFICE OF WATER RESOURCES**

**DANVILLE DAM REMOVAL AND BANK STABILIZATION  
EAST ABUTMENT REMOVAL**

COUNTY	TOTAL SHEETS	SHEET NO.
VERMILION	18	8
PROJECT FR-441		



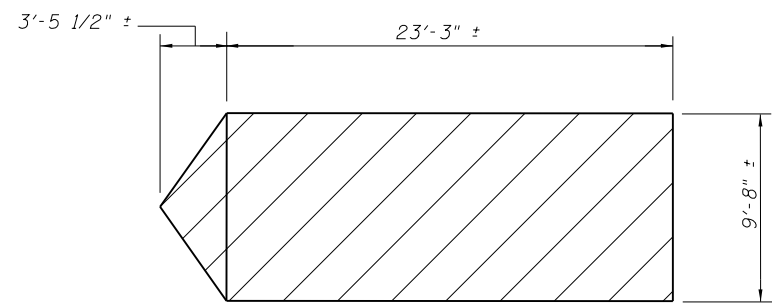

SECTION A-A



Considered as Organic Debris Removal.  
Quantity is listed on Sheet 5 in Bill of Materials

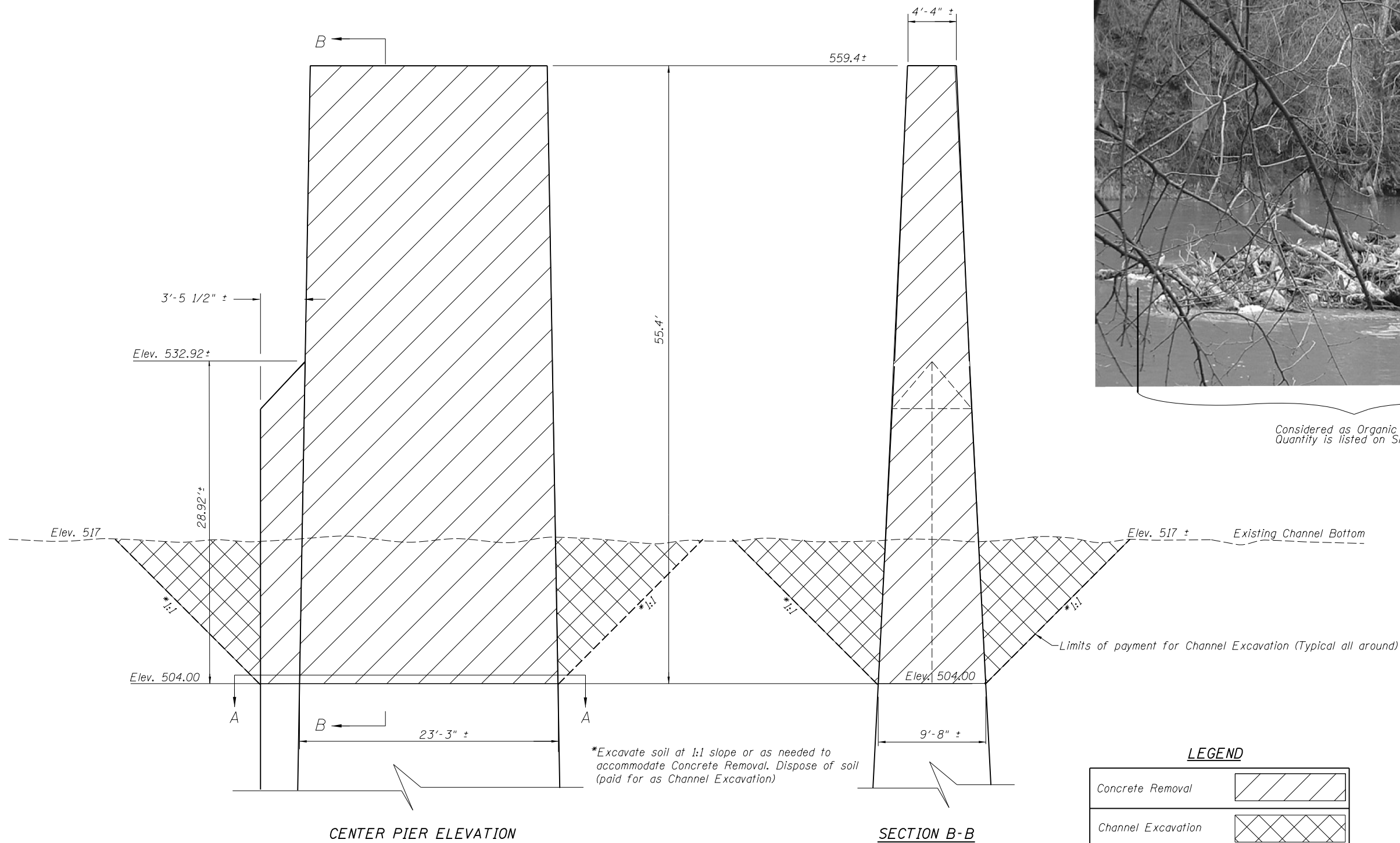

CENTER PIER ELEVATION

SECTION B-B

LEGEND

Concrete Removal	
Channel Excavation	

BILL OF MATERIALS

CHANNEL EXCAVATION	CU YD	382
CONCRETE REMOVAL	CU YD	334.7

Note:  
Soils removed from center pier area shall be billed as Channel Excavation.

3/22/2016	DESIGNED - RJM	REVISED
9:25:23 AM	DRAWN - RJM	REVISED
	CHECKED - TMM	REVISED
*SCALE*	DATE - 2-08-16	REVISED

STATE OF ILLINOIS  
DEPARTMENT OF NATURAL RESOURCES  
OFFICE OF WATER RESOURCES

DANVILLE DAM REMOVAL AND BANK STABILIZATION  
CENTER PIER REMOVAL

COUNTY	TOTAL SHEETS	SHEET NO.
VERMILION	18	9
PROJECT FR-441		



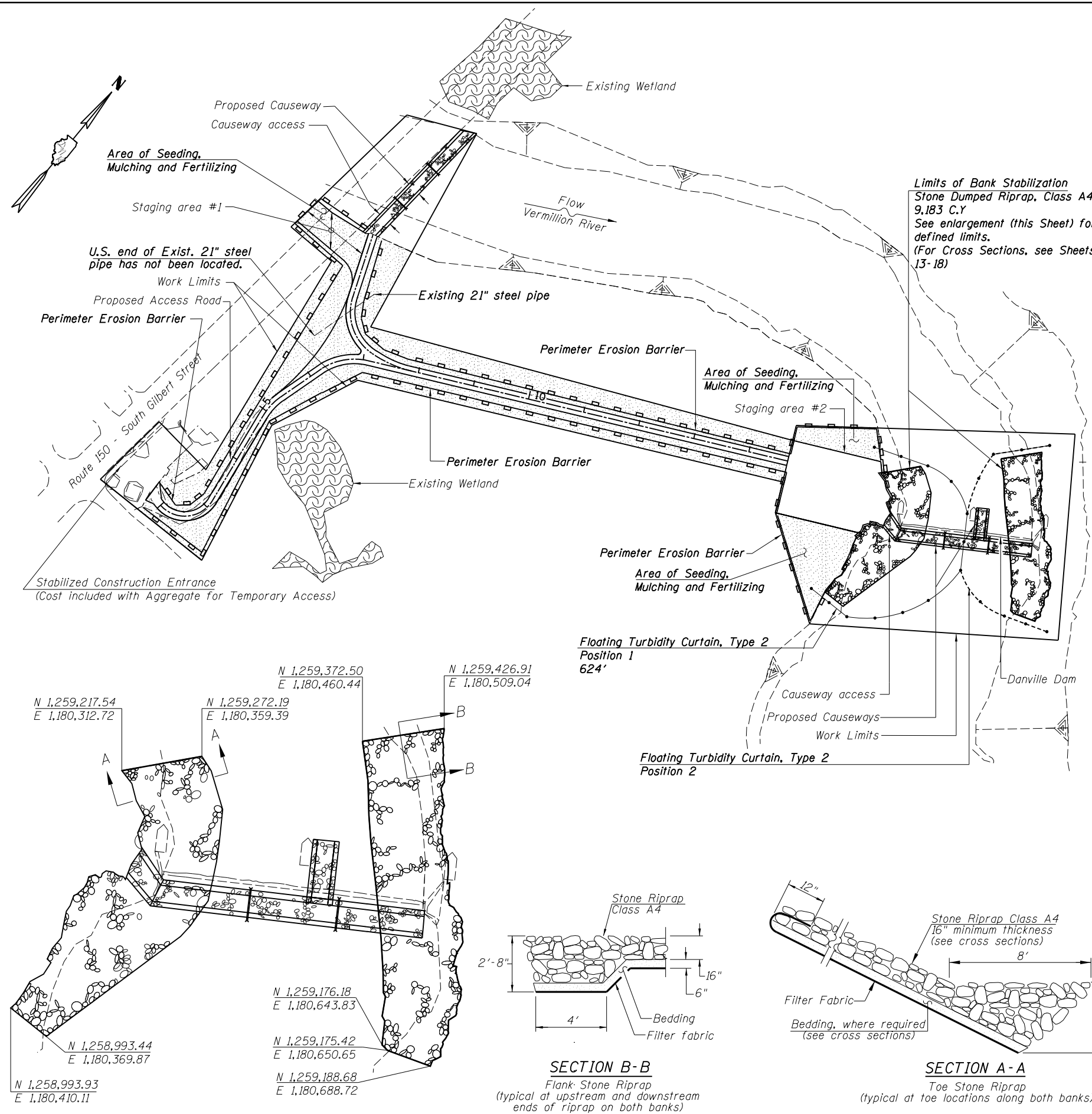

Notes:

- All erosion control items to be furnished and maintained by the Contractor for the entire duration of the project, as directed by the Engineer.
- Unless otherwise indicated, all vegetative and structural erosion and sediment control practices shall be constructed according to minimum standards and specifications in the most current Illinois Urban Manual and the current IDOT Standard Specifications and current Supplemental Specifications.
- The Vermillion County Soil and Water Conservation District (VCSWCD) must be notified one week prior to the pre-construction conference, one week prior to the commencement of land disturbing activities and one week prior to the final inspection.
- A copy of the Erosion Control Plan shall be maintained on the site at all times.
- Prior to commencing land-disturbing activities in areas other than indicated on these plans (including, but not limited to, off site borrow or waste areas) a Supplementary Erosion Control Plan shall be submitted to the owner for review.
- The Contractor is responsible for installation of all erosion control measures necessary to prevent erosion and sedimentation as determined by the Engineer. Exact sizes and locations may be adjusted in the field. All installations shall be maintained to ensure they are functioning properly.
- All adjacent streets must be kept clear of debris, inspected daily and cleaned when necessary.
- All erosion control measures must be inspected weekly and after each 1/2" rain event.
- Seeding, Mulching and Fertilizing shall be installed on all areas immediately upon final grading.
- The priority shall be given to the completion and stabilization of the disturbed areas. Work in these areas shall not be prolonged in attempt that all final grading and stabilization can take place at one time.
- Stockpiles of soil and other materials to remain in place more than three (3) days shall be furnished with erosion and sediment control measures (I.E. perimeter erosion barrier). Stockpiles to remain in place for 21 days or more shall receive temporary seeding.
- In areas where work is complete, permanent stabilization shall occur within 7 days of completion, and in areas where work will temporarily cease for 21 days or more, temporary stabilization shall occur by the 14th day after work has ceased.
- Completed slopes shall be seeded, fertilized and mulched as the excavation proceeds to the extent considered desirable and practical. Permanent seeding shall be used whenever possible. Under no circumstances shall the contractor prolong final grading and shaping so that the entire project can be permanently seeded at one time.
- The contractor shall amend the plans as needed to show changes in construction. these shall be kept up to date throughout construction.
- All non-project areas that are disturbed shall be returned to their pre-construction condition at no additional cost to the Department.
- Dewatering of the project area is not proposed for this project. Optionally, the Contractor may submit dewatering plans to the Department/Engineer and permitting agencies for approval.
- All construction entrances, staging areas & access roadways will be maintained such that it will prevent tracking or flow of sediment on public roads. This may require periodic top dress of the construction entrances as needed and as directed by the Engineer.
- Layout of Stone Dumped Riprap, Class A4 may be varied in the field to suit ground conditions as directed by the Engineer.
- The condition of the construction site for winter shutdown shall be addressed early in the fall growing season so that slopes and other bare earth areas may be stabilized with temporary and/or permanent vegetative cover for proper erosion and sediment control. All open areas that are to remain idle throughout the winter shall receive temporary erosion control measures including temporary seeding, mulching and/or erosion control blanket prior to the end of the fall growing season. Costs of Mulching and Erosion Control Blanket are included with Temporary Erosion Control Seeding.

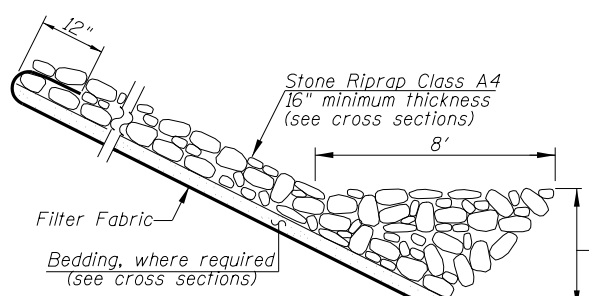
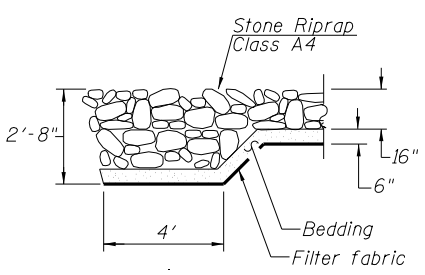

**LEGEND**

Seeding, Mulching and Fertilizing	
Stone Dumped Riprap, Class A4	
Existing Wetland Delineation	
Perimeter Erosion Barrier	
Floating Turbidity Barrier, Type 2	

**BILL OF MATERIALS**

PERIMETER EROSION BARRIER	FOOT	4,011
FLOATING TURBIDITY BARRIER, TYPE 2	FOOT	624
SEEDING, MULCHING AND FERTILIZING	ACRE	3.15
STONE DUMPED RIPRAP, CLASS A4	CU YD	9,582
FILTER FABRIC	SQ YD	5,627
TEMPORARY EROSION CONTROL SEEDING	POUND	315

3/20/2018	DESIGNED - RJM	REVISED
1:22:22 PM	DRAWN - RJM	REVISED
	CHECKED - TMM	REVISED
#SCALE#	DATE - 2-08-16	REVISED

STATE OF ILLINOIS  
DEPARTMENT OF NATURAL RESOURCES  
OFFICE OF WATER RESOURCES

DANVILLE DAM REMOVAL AND BANK STABILIZATION  
EROSION CONTROL

COUNTY	TOTAL SHEETS	SHEET NO.
VERMILION	18	11
PROJECT FR-441		

**INSPECTION AND MAINTENANCE SCHEDULE**

ACTIVITY	RESPONSIBLE PARTY	DURATION
Stabilization during construction maintenance	Contractor	Weekly and after every 1/2" of rainfall
Inspection of stabilization during construction	Engineer	Weekly and after every 1/2" of rainfall
Vegetation maintenance	Contractor	Completion of Contract
Vegetation and stabilization maintenance	City of Danville	Ongoing after construction completion

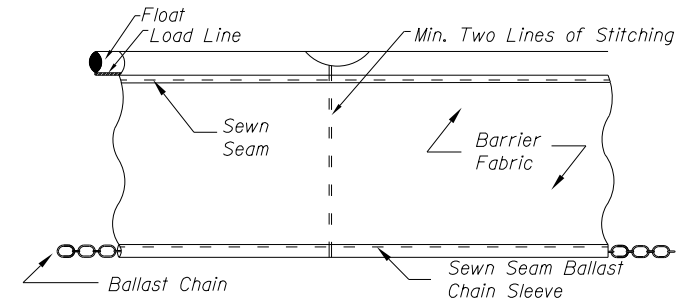

**SEWN SEAM**

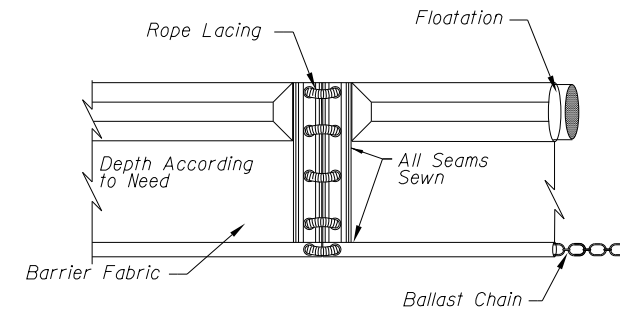

**GROMMETED HOLES WITH ROPE LACING**

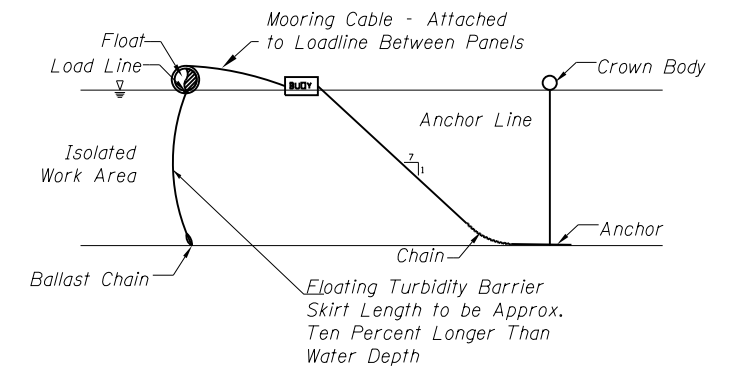

**TYPICAL COMPONENTS / ANCHORAGE SYSTEM**

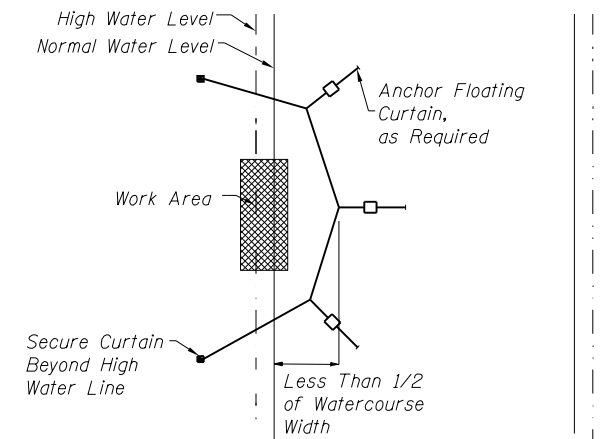

**TYPICAL PLAN VIEW**

Maximum flow for waterbody shall be less than 5fps. Isolated work area shall not exceed more than 1/2 stream width. Turbidity curtain shall be placed parallel to stream flow.

**FLOATING TURBIDITY CURTAIN - TYPICAL LAYOUT**

**NOTES:**

- The Curtain Shall be Supplied, Installed and Maintained in Accordance With Code 917 of the Illinois Urban Manual.
- The Curtain Shall be Placed Parallel to or at an Angle to the Direction of Flow, not Perpendicular to the Flow and Shall not Extend Across an Entire Waterway.
- The Curtain Depth Shall be approximately 10% Longer than the Water Depth (at the Anticipated High Water Level) to Ensure the Curtain Rests on the Bottom.
- Both the Top and the Bottom of the Curtain Shall Continue Up Onto the Shore Beyond the Anticipated High Water Level. The Bottom of the Curtain Shall be Tapered to the Shape of the Shore.
- The Type of Curtain Used Shall be a Type II Rated for Moderate Current and Moderate Wind and Wave Action.

**STABILIZED CONSTRUCTION ENTRANCE PLAN**

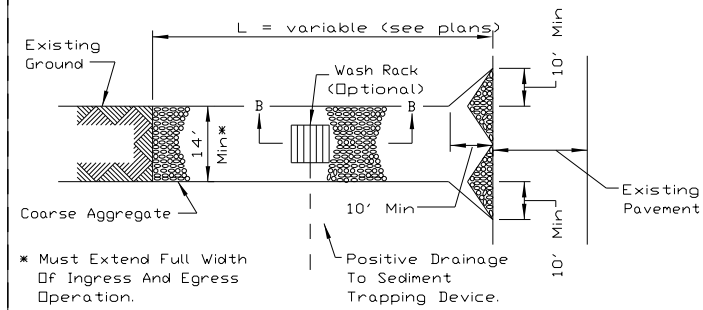

**PLAN VIEW**

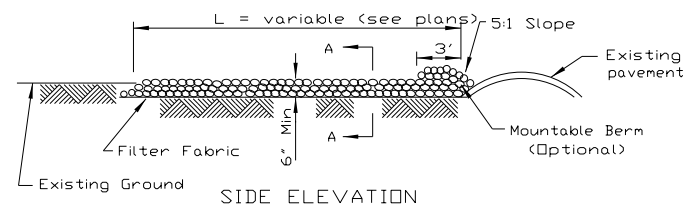

**SIDE ELEVATION**

- NOTES:**
- Filter fabric shall meet the requirements of material specification 592 GEOTEXTILE, Table I or 2, Class IV, and shall be placed over the cleared area prior to the placing of rock.
  - Rock or reclaimed concrete shall meet one of the following IDOT coarse aggregate gradation, CA-1, CA-2, CA-3 or CA-4 and be placed according to construction specification 25 ROCKFILL using placement Method 1 and Class III compaction.
  - Any drainage facilities required because of washing shall be constructed according to manufacturers specifications.
  - If wash racks are used they shall be installed according to the manufacturer's specifications.

REFERENCE Project	STANDARD DWG. NO. IL-630
Designed _____ Date _____	SHEET 1 OF 2
Checked _____ Date _____	DATE 8-18-94
Approved _____ Date _____	

**STABILIZED CONSTRUCTION ENTRANCE PLAN**

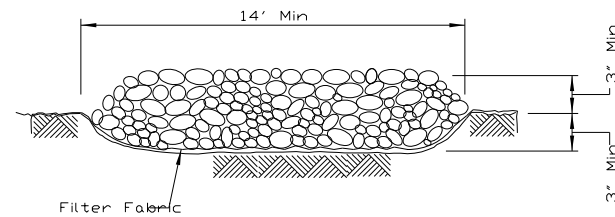

**SECTION A-A**

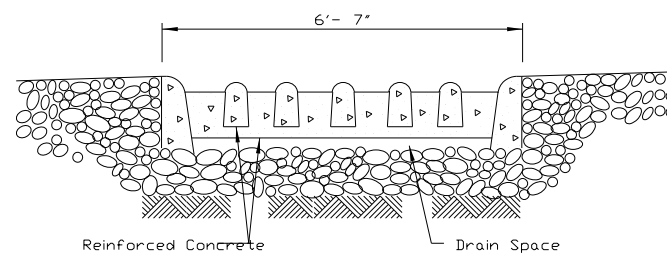

**SECTION B-B**

REFERENCE Project	STANDARD DWG. NO. IL-630
Designed _____ Date _____	SHEET 2 OF 2
Checked _____ Date _____	DATE 8-18-94
Approved _____ Date _____	

**CONTRACTOR CERTIFICATION**

"I certify under penalty of law that I understand the terms and conditions of the General National Pollutant Discharge Elimination System (NPDES) Permit (ILR10) that authorizes the storm water discharges associated with industrial activity from the construction site identified as part of this Certification."

**GENERAL CONTRACTOR**

Signature \_\_\_\_\_ Title \_\_\_\_\_  
Company \_\_\_\_\_ Date \_\_\_\_\_

**SUB-CONTRACTOR**

Signature \_\_\_\_\_ Title \_\_\_\_\_  
Company \_\_\_\_\_ Date \_\_\_\_\_

**WITNESSED BY DEPARTMENT**

Signature \_\_\_\_\_ Title \_\_\_\_\_  
Company \_\_\_\_\_ Date \_\_\_\_\_

ORIGINAL SURVEY	SURVEYED _____	BY _____	DATE _____
NOTE BOOK	PLOTTED _____		
	TEMPLATE _____		
	AREAS _____		
	AREAS CHECKED _____		

FINAL SURVEY	SURVEYED _____	BY _____	DATE _____
NOTE BOOK	PLOTTED _____		
	TEMPLATE _____		
	AREAS _____		
	AREAS CHECKED _____		

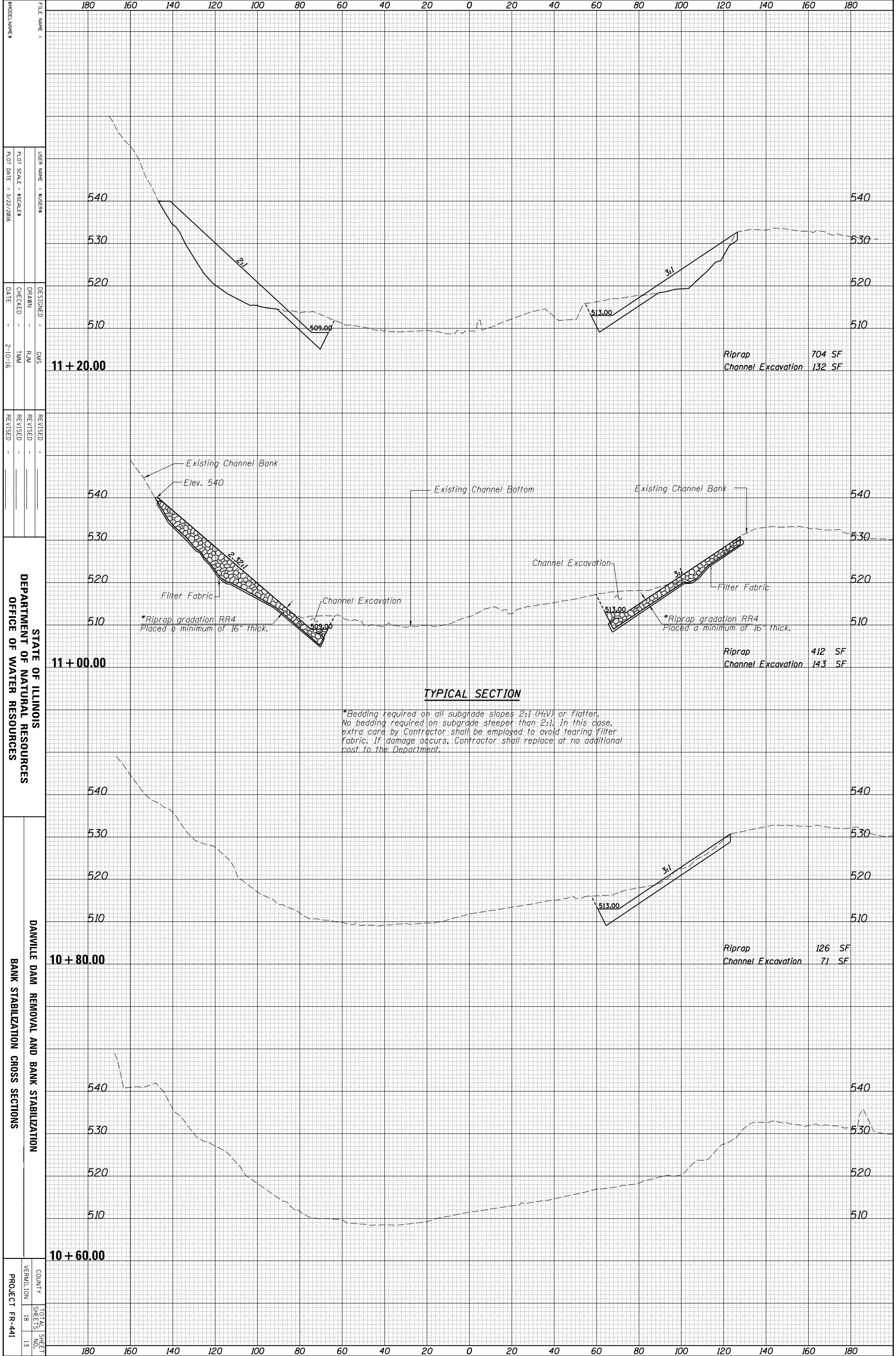

MODEL NUMBER: \_\_\_\_\_  
 FILE NAME: \_\_\_\_\_  
 USER NAME: \$USER\$  
 DESIGNER: \_\_\_\_\_  
 DRAWN: \_\_\_\_\_  
 CHECKED: \_\_\_\_\_  
 DATE: 2-10-16  
 REVISIONS: \_\_\_\_\_  
 DEPARTMENT OF NATURAL RESOURCES  
 OFFICE OF WATER RESOURCES  
 DANVILLE DAM REMOVAL AND BANK STABILIZATION  
 BANK STABILIZATION CROSS SECTIONS  
 COUNTY: \_\_\_\_\_  
 VERMILION: \_\_\_\_\_  
 PROJECT: FR-441  
 TOTAL SHEETS: 18  
 SHEET NO.: 13

ORIGINAL SURVEY	SURVEYED _____	BY _____	DATE _____
NOTE BOOK	PLOTTED _____		
	TEMPLATE _____		
	AREAS _____		
	AREAS CHECKED _____		

FINAL SURVEY	SURVEYED _____	BY _____	DATE _____
NOTE BOOK	PLOTTED _____		
	TEMPLATE _____		
	AREAS _____		
	AREAS CHECKED _____		

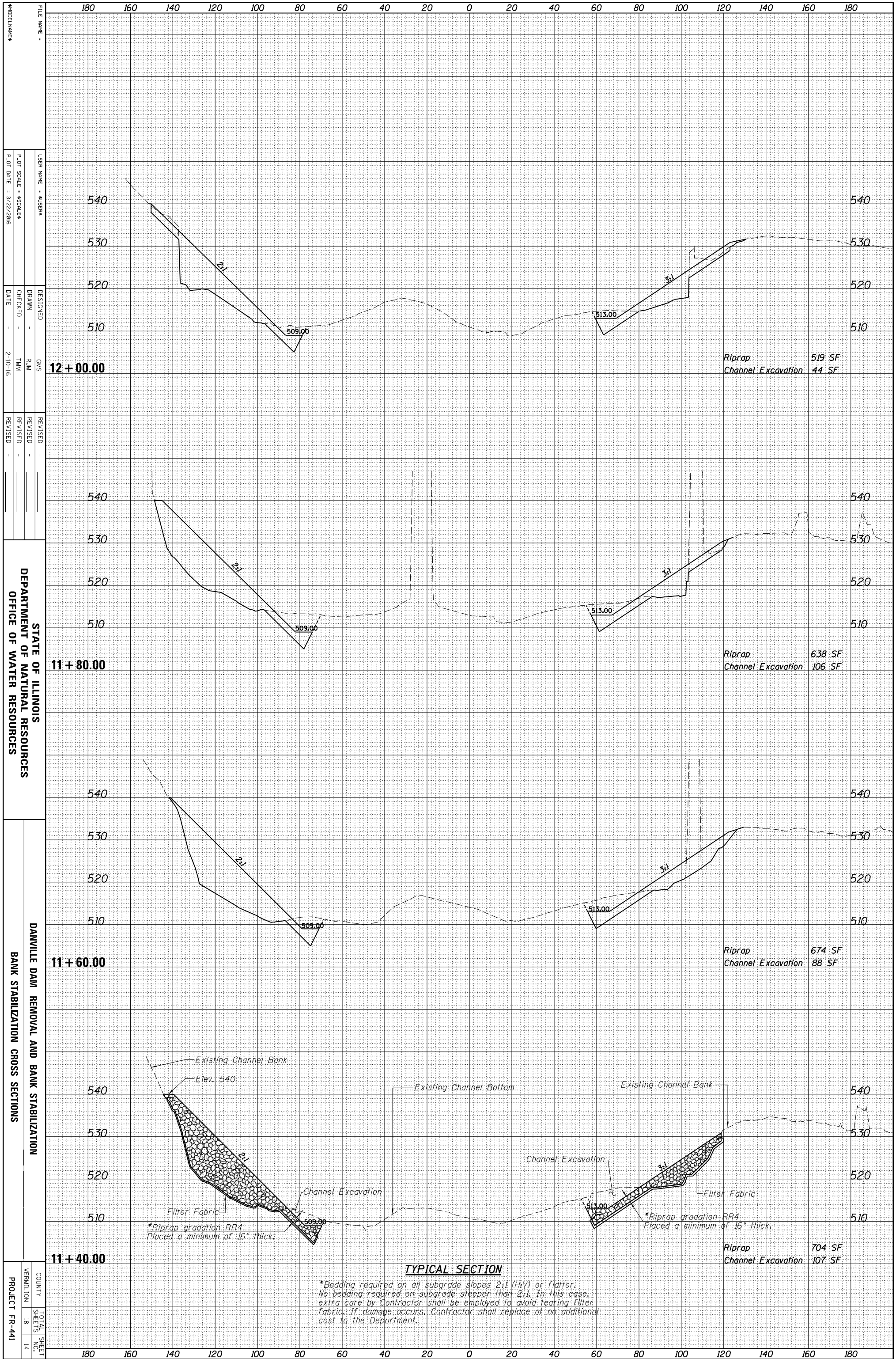

MODEL NUMBER: \_\_\_\_\_  
 FILE NAME: \_\_\_\_\_  
 USER NAME: SUSENS  
 DESIGNER: \_\_\_\_\_  
 DRAWN: \_\_\_\_\_  
 CHECKED: \_\_\_\_\_  
 DATE: 2-10-16  
 REVISED: \_\_\_\_\_  
 REVISED: \_\_\_\_\_  
 REVISED: \_\_\_\_\_

STATE OF ILLINOIS  
 DEPARTMENT OF NATURAL RESOURCES  
 OFFICE OF WATER RESOURCES

DANVILLE DAM REMOVAL AND BANK STABILIZATION  
 BANK STABILIZATION CROSS SECTIONS

COUNTY: \_\_\_\_\_  
 VERMILION: \_\_\_\_\_  
 PROJECT: FR-441

TOTAL SHEET NO. 14  
 SHEETS 18

180 160 140 120 100 80 60 40 20 0 20 40 60 80 100 120 140 160 180

540 530 520 510

2:1 3:1

509.00 513.00

540 530 520 510

2:1 3:1

509.00 513.00

540 530 520 510

2:1 3:1

509.00 513.00

Existing Channel Bank  
 Elev. 540  
 Existing Channel Bottom  
 Channel Excavation  
 Filter Fabric  
 \*Riprap gradation RR4  
 Placed a minimum of 16" thick.

Existing Channel Bank  
 Channel Excavation  
 Filter Fabric  
 \*Riprap gradation RR4  
 Placed a minimum of 16" thick.

ORIGINAL SURVEY	SURVEYED _____	BY _____	DATE _____
NOTE BOOK	PLOTTED _____		
	TEMPLATE _____		
	AREAS _____		
	AREAS CHECKED _____		

FINAL SURVEY	SURVEYED _____	BY _____	DATE _____
NOTE BOOK	PLOTTED _____		
	TEMPLATE _____		
	AREAS _____		
	AREAS CHECKED _____		

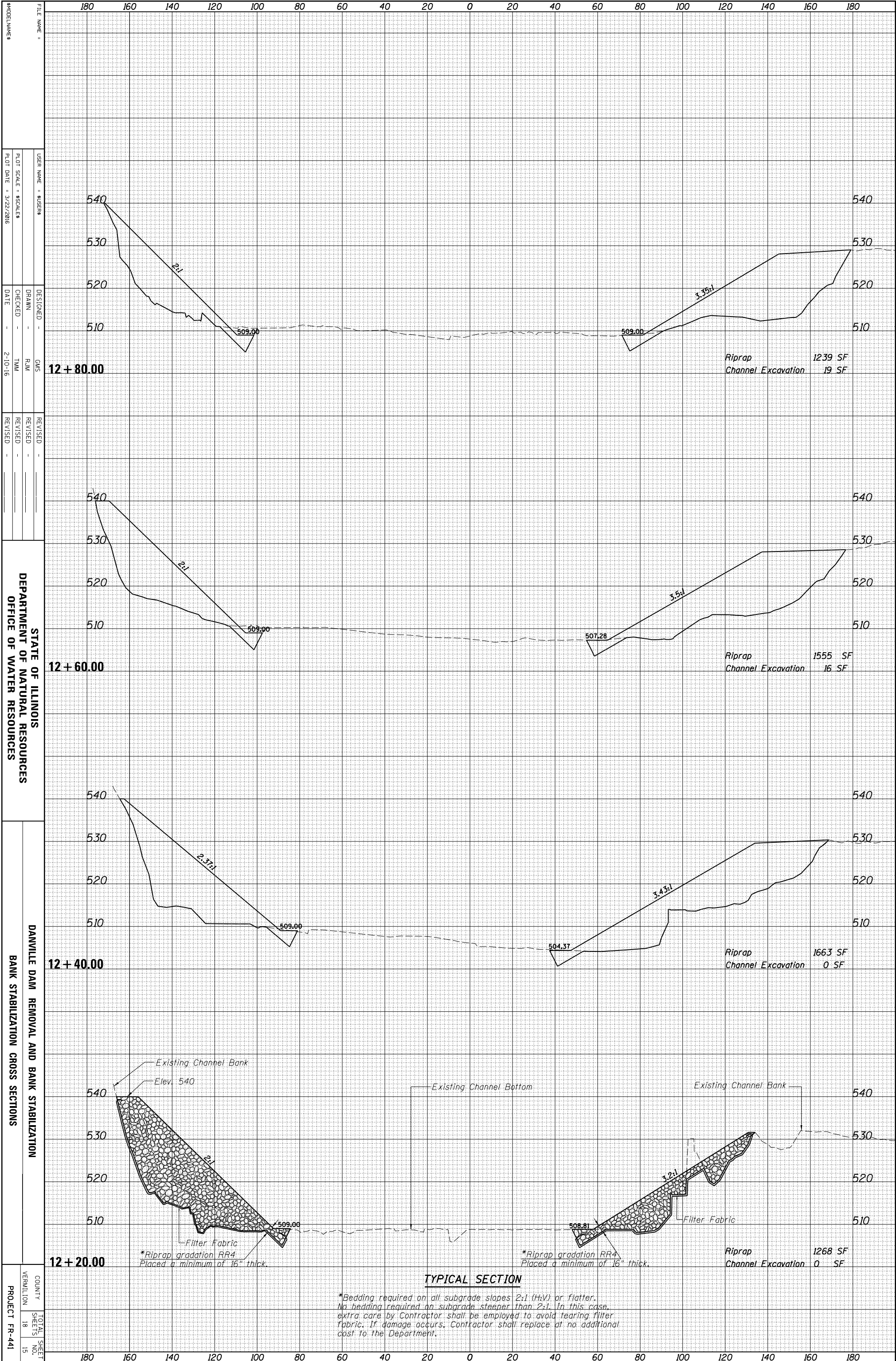

MODEL NUMBER: \_\_\_\_\_  
 FILE NAME: \_\_\_\_\_  
 USER NAME: \$USER\$  
 PLOT SCALE: \$SCALE\$  
 PLOT DATE: 3/22/2016

DESIGNED: \_\_\_\_\_  
 DRAWN: \_\_\_\_\_  
 CHECKED: \_\_\_\_\_  
 DATE: 2-10-16

REVISED: \_\_\_\_\_  
 REVISED: \_\_\_\_\_  
 REVISED: \_\_\_\_\_  
 REVISED: \_\_\_\_\_

STATE OF ILLINOIS  
 DEPARTMENT OF NATURAL RESOURCES  
 OFFICE OF WATER RESOURCES

DANVILLE DAM REMOVAL AND BANK STABILIZATION  
 BANK STABILIZATION CROSS SECTIONS

COUNTY: VERMILION  
 TOTAL SHEETS: 18  
 SHEET NO.: 15  
 PROJECT: FR-441

ORIGINAL SURVEY	SURVEYED _____	BY _____	DATE _____
NOTE BOOK	PLOTTED _____		
	TEMPLATE _____		
	AREAS _____		
	AREAS CHECKED _____		

FINAL SURVEY	SURVEYED _____	BY _____	DATE _____
NOTE BOOK	PLOTTED _____		
	TEMPLATE _____		
	AREAS _____		
	AREAS CHECKED _____		

MODEL NAME: \_\_\_\_\_  
 FILE NAME: \_\_\_\_\_  
 USER NAME: \$USER\$  
 DESIGNER: \_\_\_\_\_  
 DRAWN: \_\_\_\_\_  
 CHECKED: \_\_\_\_\_  
 DATE: 2-10-16

STATE OF ILLINOIS  
 DEPARTMENT OF NATURAL RESOURCES  
 OFFICE OF WATER RESOURCES

DANVILLE DAM REMOVAL AND BANK STABILIZATION  
 BANK STABILIZATION CROSS SECTIONS

COUNTY: VERMILION  
 TOTAL SHEETS: 18  
 SHEET NO.: 16  
 PROJECT: FR-441

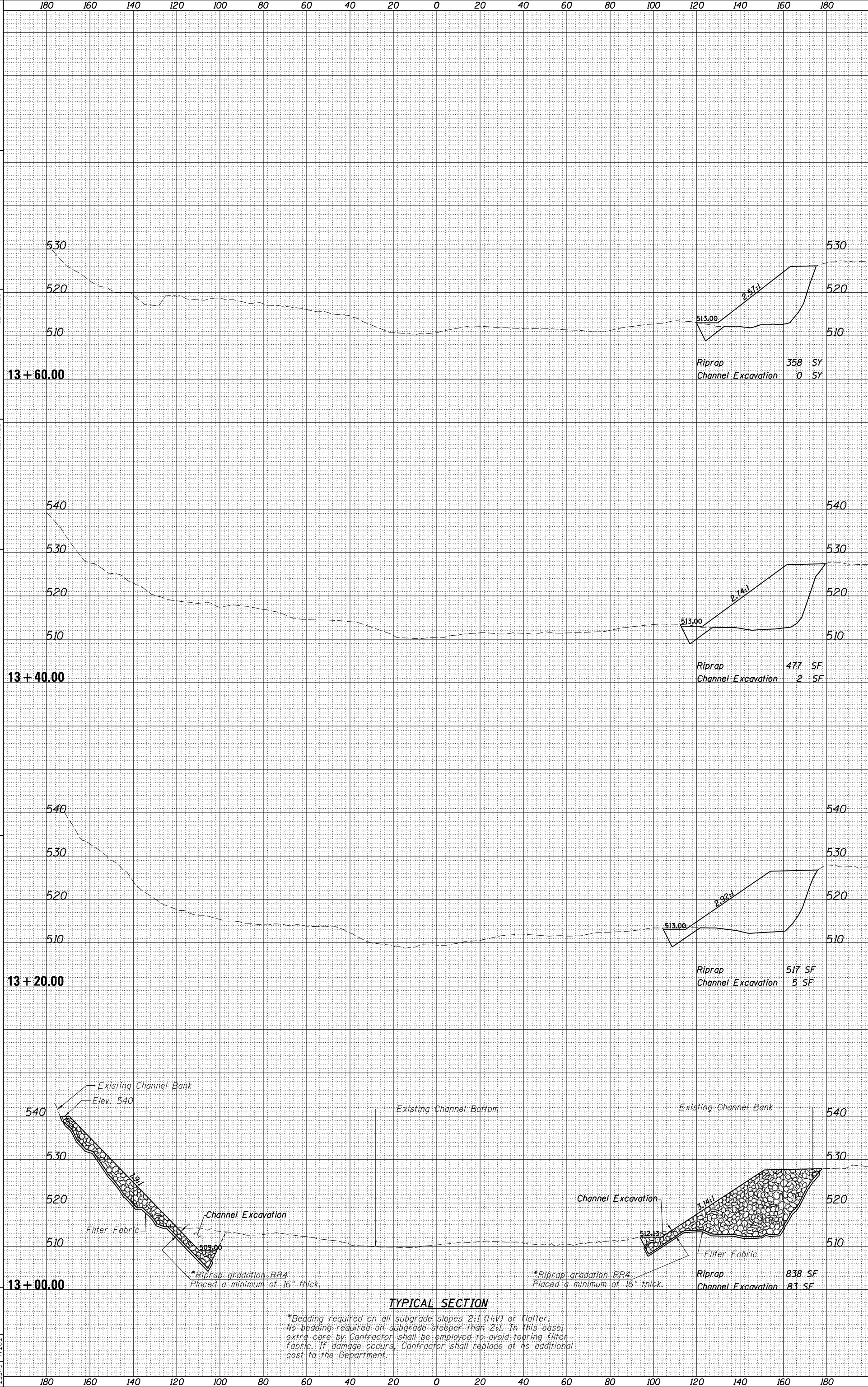

**TYPICAL SECTION**

\*Bedding required on all subgrade slopes 2:1 (H:V) or flatter. No bedding required on subgrade steeper than 2:1. In this case, extra care by Contractor shall be employed to avoid tearing filter fabric. If damage occurs, Contractor shall replace at no additional cost to the Department.



ORIGINAL SURVEY	SURVEYED _____	BY _____	DATE _____
NOTE BOOK	PLOTTED _____		
	TEMPLATE _____		
	AREAS _____		
	AREAS CHECKED _____		

FINAL SURVEY	SURVEYED _____	BY _____	DATE _____
NOTE BOOK	PLOTTED _____		
	TEMPLATE _____		
	AREAS _____		
	AREAS CHECKED _____		

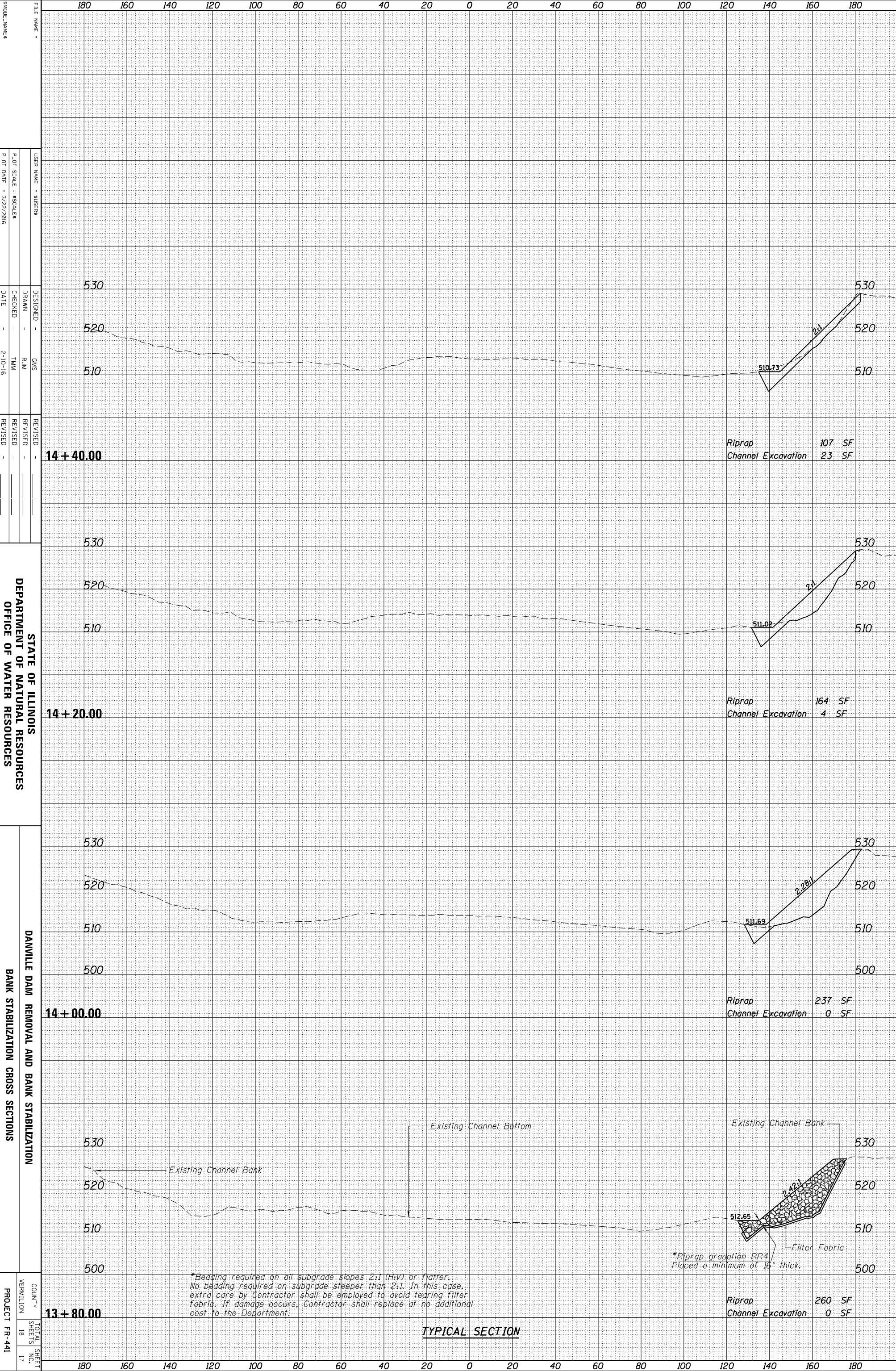

MODEL NUMBER: \_\_\_\_\_

FILE NAME: \_\_\_\_\_

USER NAME: \$USER\$

DESIGNED: \_\_\_\_\_

DRAWN: \_\_\_\_\_

CHECKED: \_\_\_\_\_

DATE: 2-10-16

REVISIONS:

NO.	DATE	DESCRIPTION

STATE OF ILLINOIS  
DEPARTMENT OF NATURAL RESOURCES  
OFFICE OF WATER RESOURCES

DANVILLE DAM REMOVAL AND BANK STABILIZATION  
BANK STABILIZATION CROSS SECTIONS

COUNTY: \_\_\_\_\_

VERMILION: \_\_\_\_\_

PROJECT: FR-441

TOTAL SHEETS: 18

SHEET NO.: 17

**TYPICAL SECTION**

ORIGINAL SURVEY	SURVEYED _____	BY _____	DATE _____
NOTE BOOK	PLOTTED _____		
	TEMPLATE _____		
	AREAS _____		
	AREAS CHECKED _____		

FINAL SURVEY	SURVEYED _____	BY _____	DATE _____
NOTE BOOK	PLOTTED _____		
	TEMPLATE _____		
	AREAS _____		
	AREAS CHECKED _____		

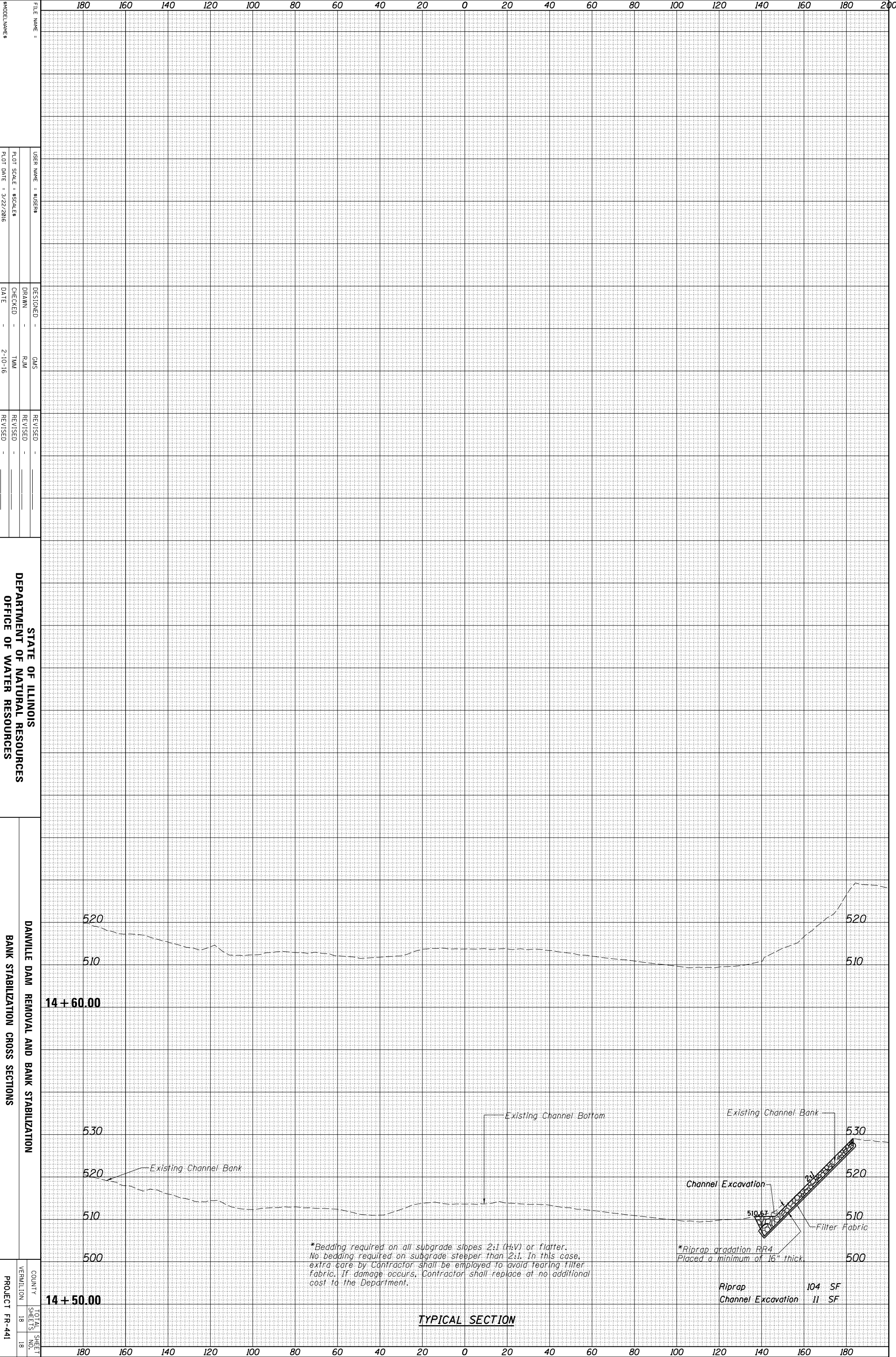

MODEL NUMBER: \_\_\_\_\_

FILE NAME: \_\_\_\_\_

USER NAME: \$USER\$

DESIGNED: \_\_\_\_\_

DRAWN: \_\_\_\_\_

CHECKED: \_\_\_\_\_

DATE: 2-10-16

REVISIONS:

NO.	DATE	DESCRIPTION

STATE OF ILLINOIS  
DEPARTMENT OF NATURAL RESOURCES  
OFFICE OF WATER RESOURCES

DANVILLE DAM REMOVAL AND BANK STABILIZATION  
BANK STABILIZATION CROSS SECTIONS

COUNTY: \_\_\_\_\_

VERMILION: \_\_\_\_\_

PROJECT: FR-441

TOTAL SHEETS: 18

SHEET NO.: 18