

F.A.U. RTE.	SECTION	COUNTY	TOTAL SHEETS	SHEET NO.
2688	2017-064BR	WILL	15	1
		ILLINOIS	CONTRACT NO. 62G06	

04-27-2018 LETTING ITEM 116

STATE OF ILLINOIS  
DEPARTMENT OF TRANSPORTATION

**PROPOSED  
HIGHWAY PLANS**

**FAU ROUTE 2688: WOLF RD.  
AT HICKORY CREEK  
SECTION: 2017-064BR  
BRIDGE REPAIR / BRIDGE DECK OVERLAY  
WILL COUNTY**

D-91-240-18

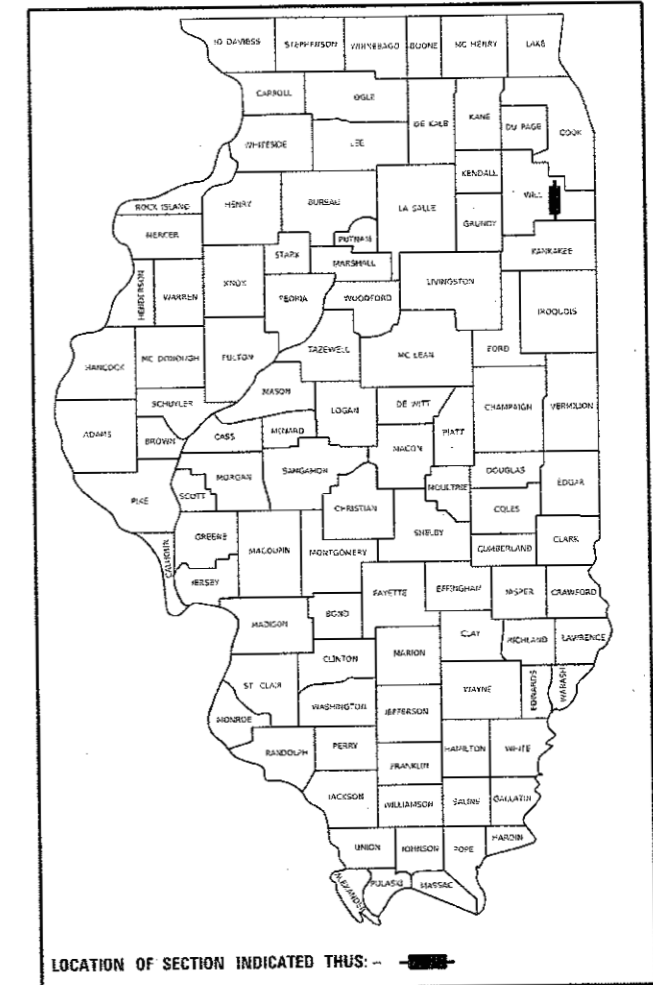

LOCATION OF SECTION INDICATED THUS: - [black rectangle] -

FOR INDEX OF SHEETS, SEE SHEET NO. 2.

THE PROJECT IS LOCATED IN THE VILLAGE  
OF MOKENA

**TRAFFIC DATA**

2016 ADT = 14,600  
POSTED SPEED = 40 MPH

IMPROVEMENT LOCATION:  
WOLF ROAD  
AT HICKORY CREEK  
SN: 099-0271

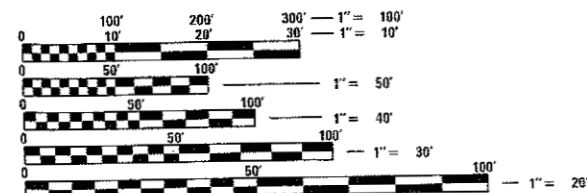

FULL SIZE PLANS HAVE BEEN PREPARED USING STANDARD  
ENGINEERING SCALES. REDUCED SIZED PLANS WILL NOT  
CONFORM TO STANDARD SCALES. IN MAKING MEASUREMENTS  
ON REDUCED PLANS, THE ABOVE SCALES MAY BE USED.

J.U.L.I.E.  
JOINT UTILITY LOCATION INFORMATION FOR EXCAVATION  
1-800-892-0123  
OR 811

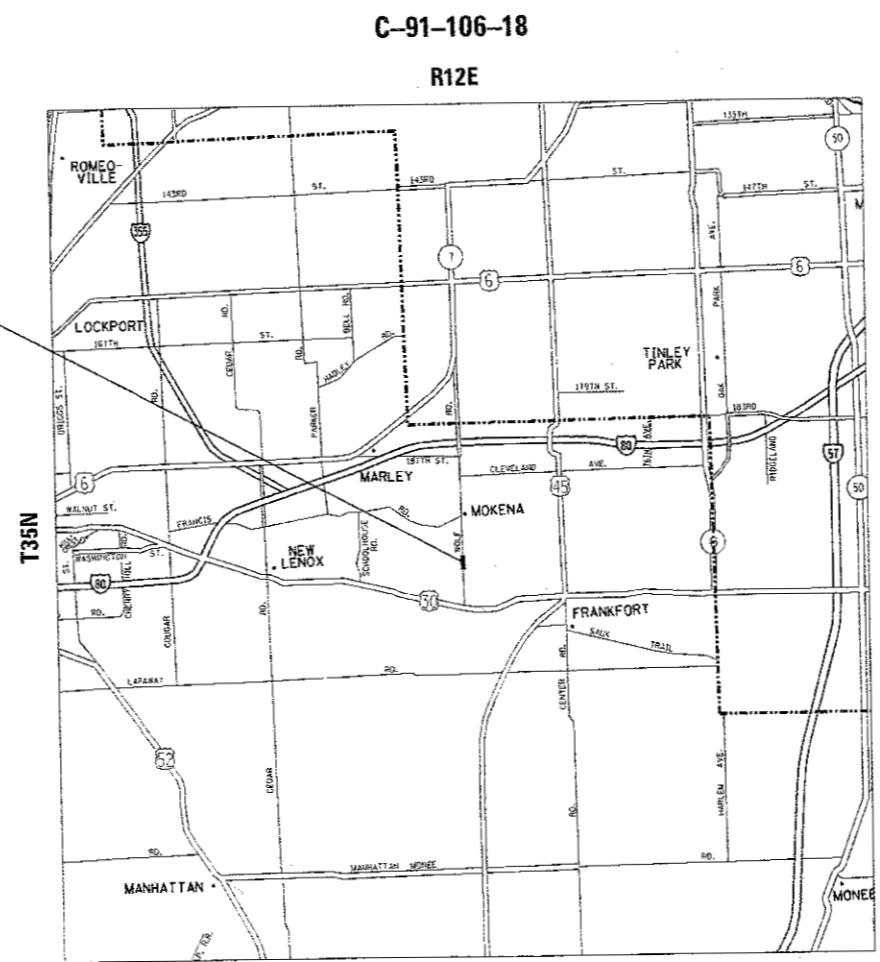

PROJECT ENGINEER: J. ALAIN MIDY (847) 221-3056  
PROJECT MANAGER: FAWAD AQUEEL (847) 705-4247

CONTRACT NO. 62G06

FRANKFORT TOWNSHIP  
NET LENGTH = 1,777 FT. = 0.336 MILE

STATE OF ILLINOIS  
DEPARTMENT OF TRANSPORTATION  
SUBMITTED January 24, 2018  
Anthony J. Quigg / CAS REGIONAL ENGINEER  
Mar 23, 2018  
Anthony J. Quigg ENGINEER OF DESIGN AND ENVIRONMENT  
Mar 23, 2018  
Paul P. [Signature] DIRECTOR OF HIGHWAYS PROJECT IMPLEMENTATION

PRINTED BY THE AUTHORITY  
OF THE STATE OF ILLINOIS

### INDEX OF SHEETS

SHEET NO.	DESCRIPTION
1.	TITLE SHEET
2.	INDEX OF SHEETS, HIGHWAY STANDARDS, AND GENERAL NOTES
3.	SUMMARY OF QUANTITIES
4.	DETOUR PLAN
5.	EXISTING PLAN AND ELEVATION
6.	EXISTING SUPERSTRUCTURE
7.	EXISTING BRIDGE APPROACH
8.	TYPICAL SECTION
9.	BRIDGE REPAIRS
10.	PAVEMENT MARKINGS
11.	BUTT JOINT AND HMA TAPER DETAILS (BD-32)
12.	TYPICAL APPLICATIONS RAISED REFLECTIVE PAVEMENT MARKERS (SNOW-PLOW RESISTANT) (TC-11)
13.	DISTRICT ONE TYPICAL PAVEMENT MARKINGS (TC-13)
14.	DETOUR SIGNING FOR CLOSING STATE HIGHWAYS (TC-21)
15.	ARTERIAL ROAD INFORMATION SIGN (TC-22)

### STATE HIGHWAY STANDARDS

STANDARD NO.	DESCRIPTION
000001-06	STANDARD SYMBOLS, ABBREVIATIONS AND PATTERNS
701301-04	LANE CLOSURE . 2L, 2W, SHORT TIME OPERATIONS
701311-03	LANE CLOSURE, 2L, 2W MOVING OPERATIONS - DAY ONLY
701427-05	LANE CLOSURE, MULTILANE, INTERMITTENT OR MOVING OPERATIONS, FOR SPEEDS < 40 MPH
701901-07	TRAFFIC CONTROL DEVICES

### GENERAL NOTES

- BEFORE STARTING ANY EXCAVATION, THE CONTRACTOR SHALL CALL "J.U.L.I.E." AT (800) 892-0123 OR 811 FOR FIELD LOCATIONS OF BURIED ELECTRIC, TELEPHONE AND GAS UTILITIES. 48 HOUR NOTIFICATION IS REQUIRED.
- THE CONTRACTOR SHALL COORDINATE CONSTRUCTION ACTIVITIES WITH UTILITY COMPANIES, AND THE VILLAGE OF MOKENA.
- THE CONTRACTOR WILL NOT BE ALLOWED TO SET UP A YARD OR FIELD OFFICE ON STATE PROPERTY WITHOUT WRITTEN PERMISSION FROM THE DEPARTMENT.
- ALL DAMAGE TO EXISTING PAVEMENT MARKINGS OR RAISED REFLECTIVE PAVEMENT MARKERS OUTSIDE THE REMOVAL LINE SHOWN ON THE PLANS SHALL BE REPLACED AT NO ADDITIONAL COST TO THE DEPARTMENT.
- IT SHALL BE THE CONTRACTOR'S RESPONSIBILITY TO VERIFY ALL DIMENSIONS AND CONDITIONS EXISTING IN THE FIELD PRIOR TO CONSTRUCTION AND ORDERING OF MATERIALS.
- BEFORE BEGINNING ANY WORK, THE CONTRACTOR SHALL RETAIN AND RECORD FOR FUTURE REFERENCE, ALL EXISTING PAVEMENT MARKING LINES (AND RAISED REFLECTIVE PAVEMENT MARKERS) IN ORDER THAT THESE LOCATIONS CAN BE RE-ESTABLISHED FOR STRIPING. EXACT LOCATIONS OF ALL PAVEMENT MARKINGS SHALL BE AS DIRECTED BY THE ENGINEER.
- THE CONTRACTOR SHALL CONTACT THE DISTRICT ONE TRAFFIC CONTROL SUPERVISOR AT (847) 705-4470 A MINIMUM OF 72 HOURS IN ADVANCE OF BEGINNING WORK.
- THE RESIDENT ENGINEER SHALL CONTACT ERIC CAMPOS, ARTERIAL TRAFFIC FIELD ENGINEER VIA E-MAIL AT ERIC.CAMPOS@ILLINOIS.GOV, A MINIMUM OF 2 WEEKS PRIOR TO PLACEMENT OF PERMANENT PAVEMENT MARKINGS.
- THE CONTRACTOR SHALL BE REQUIRED TO PROVIDE ACCESS TO ABUTTING PROPERTY AT ALL TIMES DURING THE CONSTRUCTION OF THIS PROJECT.
- DO NOT SCALE PLANS FOR CONSTRUCTION DIMENSIONS.
- THESE PLANS HAVE BEEN PREPARED FROM NOTICES RECEIVED FROM DISTRICT 1 BRIDGE INSPECTORS.
- THE CONTRACTOR MUST NOTIFY ALL LOCAL MUNICIPALITIES WHEN BRIDGE IS CLOSED, SO THAT EMERGENCY SERVICES CAN BE REROUTED ACCORDINGLY.

MODEL: Default  
 FILE NAME: P:\V\0848181\NTEG\Illinois\gov\p\MD\OT\Documents\DOT\_offices\DRUGSCT\_1\Projects\10124018\CAD\Drawn\Design\124018\_ghs.plan.dgn

USER NAME = guillaumefp	DESIGNED -	REVISED -
PLOT SCALE = 100.0000' / in.	DRAWN -	REVISED -
PLOT DATE = 2/8/2018	CHECKED -	REVISED -
	DATE -	REVISED -

STATE OF ILLINOIS  
DEPARTMENT OF TRANSPORTATION

WOLF RD. OVER HICKORY CREEK (SN 099-0271)  
GENERAL NOTES

SCALE: 1"= 50' SHEET 1 OF 1 SHEETS STA. TO STA.

F.A.U. RTE. 2688	SECTION 2017-046BR	COUNTY WILL	TOTAL SHEETS 15	SHEET NO. 2
CONTRACT NO. 62G06			ILLINOIS FED. AID PROJECT	

100% STATE

100% STATE

SUMMARY OF QUANTITIES			CONSTRUCTION TYPE CODE				
CODE NO	ITEM	UNIT	URBAN TOTAL QUANTITIES	0047			
40600290	BITUMINOUS MATERIALS (TACK COAT)	POUND	130	130			
40600982	HOT-MIX ASPHALT SURFACE REMOVAL - BUTT JOINT	SO YD	14	14			
40600985	PORTLAND CEMENT CONCRETE SURFACE REMOVAL - BUTT JOINT	SO YD	135	135			
40603340	HOT-MIX ASPHALT SURFACE COURSE, MIX "D", NTO	TON	28	28			
50300260	BRIDGE DECK GROOVING	SO YD	510	510			
67000400	ENGINEER'S FIELD OFFICE, TYPE A	CAL MO	3	3			
67100100	MOBILIZATION	L SUM	1	1			
78008210	POLYUREA PAVEMENT MARKING TYPE I - LINE 4"	FOOT	750	750			
78100100	RAISED REFLECTIVE PAVEMENT MARKER	EACH	6	6			
78300200	RAISED REFLECTIVE PAVEMENT MARKER REMOVAL	EACH	6	6			
X0326394	FLOOR DRAINS TO BE CLEANED	EACH	12	12			
X5870015	BRIDGE DECK CONCRETE SEALER	SO FT	855	855			
X7010216	TRAFFIC CONTROL AND PROTECTION, (SPECIAL)	L SUM	1	1			

SUMMARY OF QUANTITIES			CONSTRUCTION TYPE CODE				
CODE NO	ITEM	UNIT	URBAN TOTAL QUANTITIES	0047			
Z0001800	APPROACH SLAB REPAIR (PARTIAL DEPTH)	SO YD	9	9			
Z0006014	BRIDGE DECK LATEX CONCRETE OVERLAY, 2 1/2 INCHES	SO YD	550	550			
Z0012130	BRIDGE DECK SCARIFICATION 3/4"	SO YD	550	550			
Z0016002	DECK SLAB REPAIR (FULL DEPTH, TYPE II)	SO YD	25	25			
Z0030850	TEMPORARY INFORMATION SIGNING	SO FT	51.4	51.4			
Z0073510	TEMPORARY TRAFFIC SIGNAL TIMING	EACH	10	10			
	* SPECIALTY ITEMS						

13

6

FILE NAME =	USER NAME = gdlkaur/p	DESIGNED -	REVISED -
DIR\NLD\HEBUNTEG\misp\PROJECT\Documents\000	OFFICE\gdlkaur\p\Projects\02409\CAD\Design\02409	CHECKED -	REVISED -
	PLOT SCALE = 1/8" = 1' / In.	DATE -	REVISED -
	PLOT DATE = 2/8/2018		

**STATE OF ILLINOIS  
DEPARTMENT OF TRANSPORTATION**

<b>WOLF RD. OVER HICKORY CREEK (SN 099-0271)</b>			
<b>SUMMARY OF QUANTITIES</b>			
SCALE:	SHEET NO.	OF SHEETS	STA. TO STA.

F.A.U. RTE.	SECTION	COUNTY	TOTAL SHEETS	SHEET NO.
2688	2017-064BR	WILL	15	3
CONTRACT NO. 62G06				
FED. ROAD DIST. NO. 1   ILLINOIS FED. AID PROJECT				

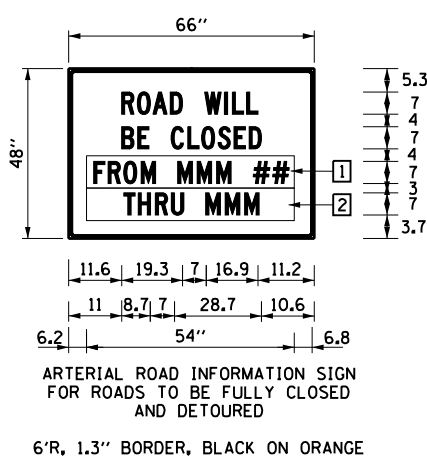
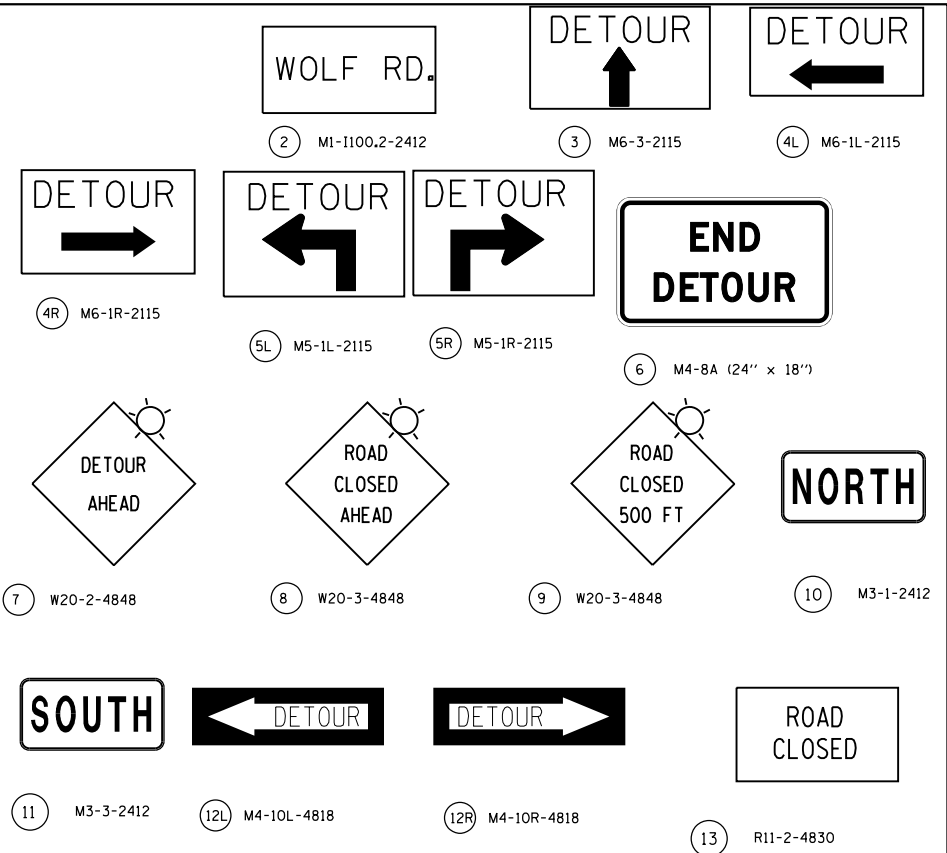
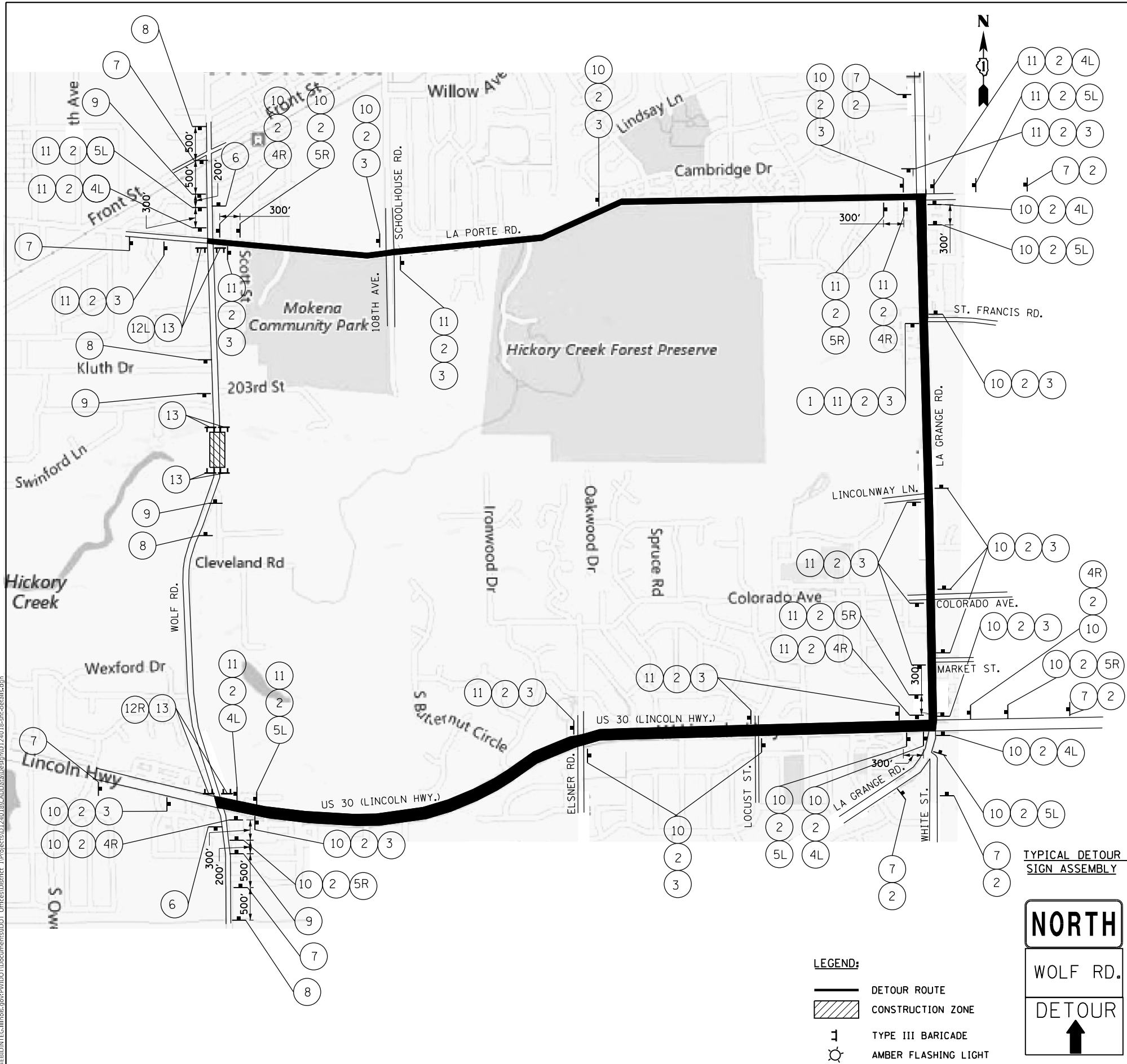

- ARTERIAL ROAD INFORMATION SIGN NOTES:**
- SIGN SHALL BE PAID FOR AS TEMPORARY INFORMATION SIGNING. ONE SIGN ASSEMBLY EQUALS 27.3 SQ FT.
  - OVERLAY PANELS SHALL BE "HIGHWAY C" FONT
  - OVERLAY PANEL 1 TO CONTAIN STARTING DATE OF FULL CLOSURE AND DETOUR IMPLEMENTATION
  - OVERLAY PANEL 2 TO CONTAIN ENDING MONTH OF FULL CLOSURE AND DETOUR. OMIT THE DATE ON PANEL; MONTH ONLY.
  - ERECT SIGN ASSEMBLY (POST-MOUNTED) WITH PANELS 1 AND 2 IN PLACE ON ROAD TO BE CLOSED IN EACH DIRECTION NEAR POINT OF CLOSURE OR WITHIN SECTION TO BE FULLY CLOSED TWO (2) WEEKS PRIOR TO START DATE OF FULL CLOSURE. REMOVE ASSEMBLY AFTER CLOSURE.

- NOTE:**
- PLACEMENT AND SPACING OF SIGNS AND BARRICADES SHALL BE IN ACCORDANCE WITH TC-21 (DETOUR SIGNING FOR CLOSING STATE HIGHWAYS).
  - THE COST OF SUPPLYING, ERECTING AND MAINTAINING BARRICADES, WARNING LIGHTS AND SIGNS SHALL BE INCLUDED IN THE CONTRACT COST OF TRAFFIC CONTROL AND PROTECTION (SPECIAL).
  - TWO WEEKS PRIOR OF BEGINNING OF WORK, TEMPORARY INFORMATION SIGNING SHALL BE PLACED AT THE NORTH AND SOUTH END OF WOLF RD. FOR THE DURATION OF THE PROJECT.
  - THE CONTRACTOR SHALL DEVELOP AND MAINTAIN APPROPRIATE SIGNAL TIMINGS FOR THE FOLLOWING INTERSECTIONS, OR AS DIRECTED BY THE ENGINEER:
    - 1) WOLF RD. / US 30
    - 2) US 30 / ELSNER RD.
    - 3) US 30 / LOCUST ST.
    - 4) US 30 / LA GRANGE RD.
    - 5) LA GRANGE RD. / MARKET ST.
    - 6) LA GRANGE RD. / LINCOLNWAY LN.
    - 7) LA GRANGE RD. / ST. FRANCIS RD.
    - 8) LA GRANGE RD. / LA PORTE RD.
    - 9) LA PORTE RD. / WOLF RD.

MODEL: Default  
 FILE: \\mchilb8a\BENIDNTEC\Illinois\pov\p\WIDOT\Documents\DOT Office\Illinois\11\Projects\012401\B\CADD\Drawings\Drawings\124018-ehr-detailed.dgn

USER NAME = quillamefp	DESIGNED -	REVISED -
	DRAWN -	REVISED -
PLOT SCALE = 100.0000' / in.	CHECKED -	REVISED -
PLOT DATE = 2/8/2018	DATE -	REVISED -

**STATE OF ILLINOIS**  
**DEPARTMENT OF TRANSPORTATION**

SCALE:		SHEET	OF	SHEETS	STA.	TO	STA.
--------	--	-------	----	--------	------	----	------

**WOLF RD. OVER HICKORY CREEK (SN 099-0271)**  
**DETOUR PLAN**

F.A.U. RTE.	SECTION	COUNTY	TOTAL SHEETS	SHEET NO.
2688	2017-0648R	WILL	15	4
CONTRACT NO. 62G06				
ILLINOIS FED. AID PROJECT				





# FOR INFORMATION ONLY

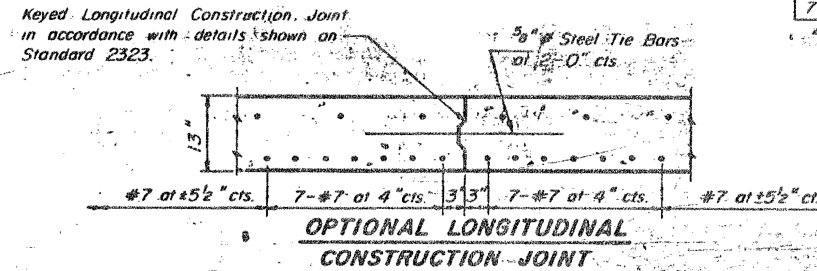
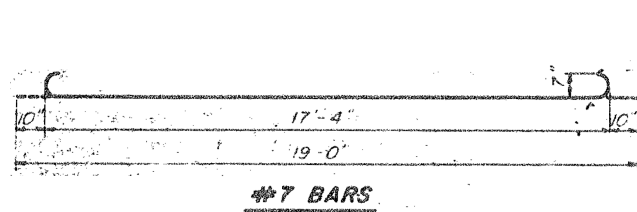
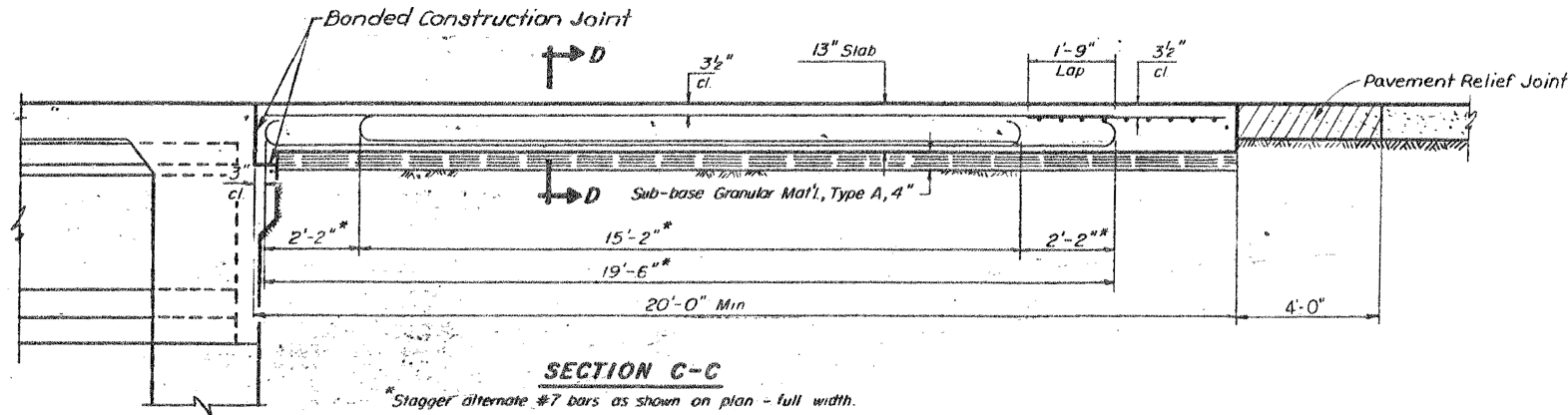

When the road plans show curb and gutter, gutter, or bridge approach shoulder pavement adjacent to approach slabs, place  $\frac{1}{2}$ "  $\phi$  steel tie bars at 2'-6" centers in accordance with the detail for Bulkhead Longitudinal Construction Joint shown on Standard 2323. Cost of the tie bars will be included in the contract unit price for the adjacent item Transitions for curb and gutter or gutter shall be as shown on the plans.

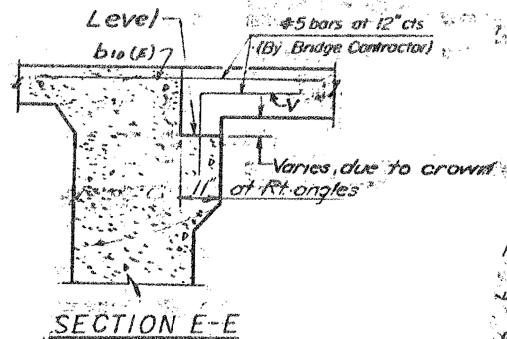
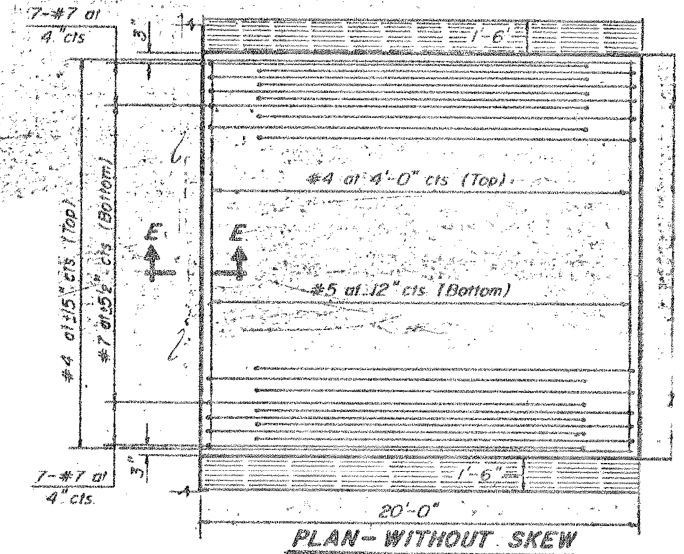
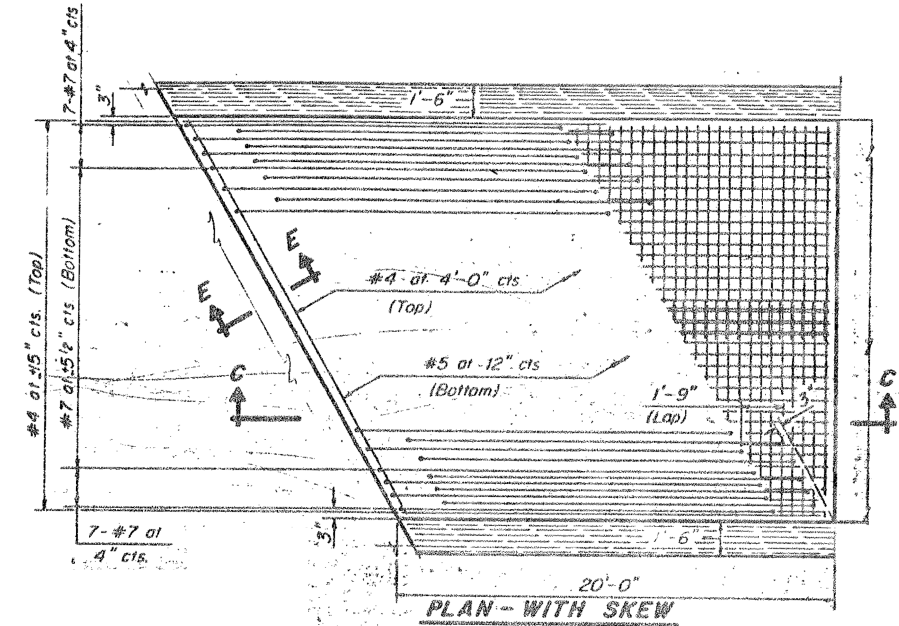
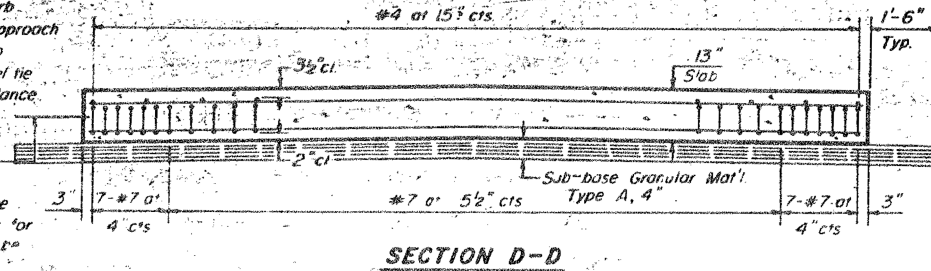

**Notes:**  
For skews of less than 10° omit wire fabric. For skews of 10° or more use Welded Wire Fabric, 6"x6"-W5.5 x W5.5, placed 3 1/2" below top of slab.  
Expanded Metal weighing not less than 78 Pounds per 100 Sq. Ft. or a welded bar mat weighing not less than 78 Pounds per 100 Sq. Ft. having members of equal size in both directions and spaced not over 8" apart may be used instead of the Welded Wire Fabric, 6"x6"-W5.5 x W5.5, provided the expanded metal or bar mat is furnished at no additional cost to the State.  
Reinforcement bars shall conform to the requirements of AASHTO M 31 or M 53, Grade 60.

**DESIGN STRESSES**

$f_y = 60,000$  psi  
 $f_c = 3500$  psi  
 $n = 8.5$

STATE OF ILLINOIS  
DEPARTMENT OF TRANSPORTATION

WOLF RD. OVER HICKORY CREEK (SN 099-0271)  
EXISTING BRIDGE APPROACH

F.A.U. RTE.	SECTION	COUNTY	TOTAL SHEETS	SHEET NO.
2688	2017-064BR	WILL	15	7
CONTRACT NO. 62G06				
ILLINOIS FED. AID PROJECT				

SCALE: SHEET OF SHEETS STA. TO STA.

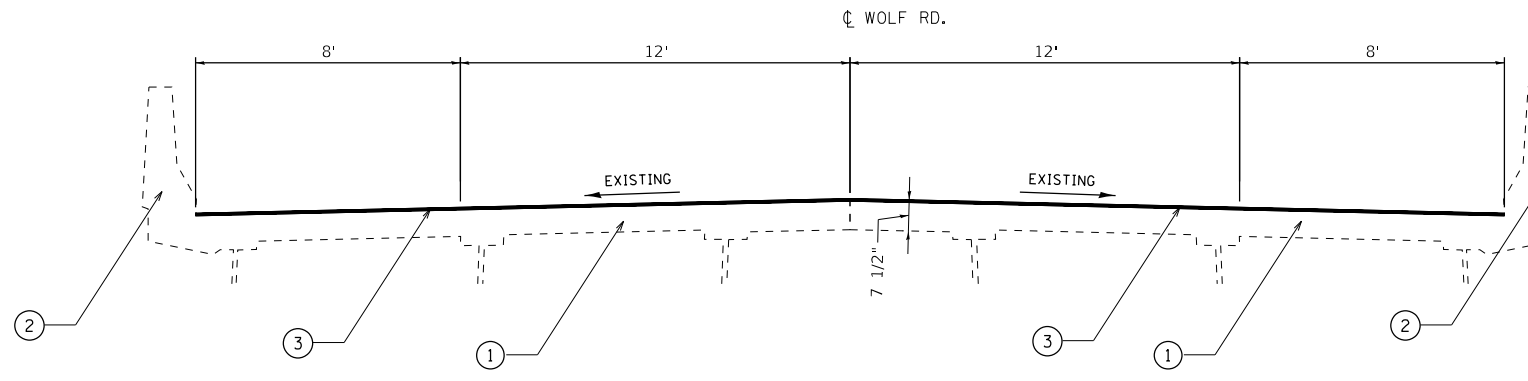

**EXISTING DECK TYPICAL SECTION**

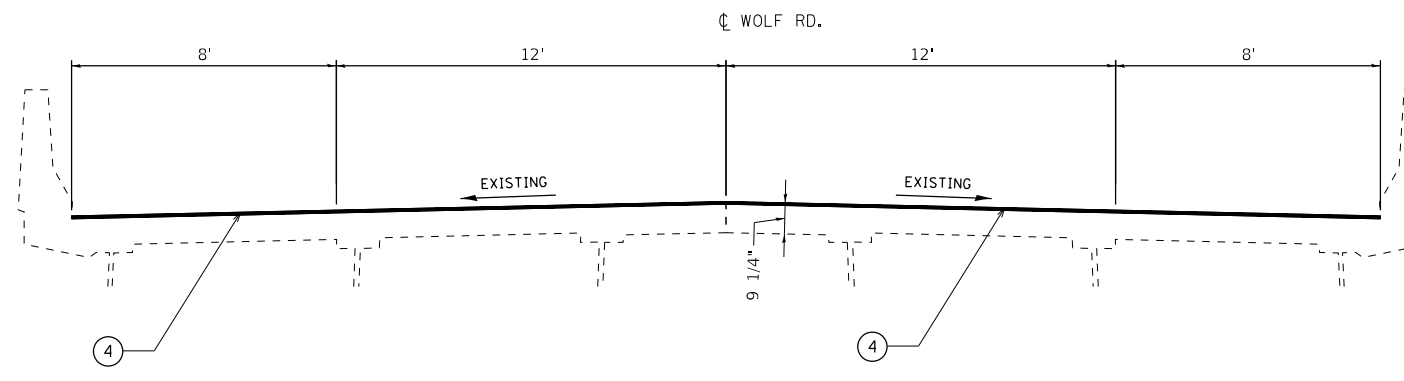

**PROPOSED DECK TYPICAL SECTION**

**LEGEND**

- ① EXISTING BRIDGE DECK
- ② EXISTING PARAPET
- ③ PROP. BRIDGE DECK SCARIFICATION 3/4"
- ④ PROP. BRIDGE DECK LATEX CONCRETE OVERLAY, 2 1/2"

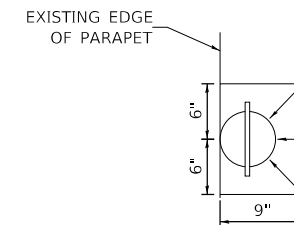

**OVERLAY TREATMENT AT FLOOR DRAIN**  
TAPER OVERLAY FROM 2 1/2" TO 1" AT EDGE OF DRAIN

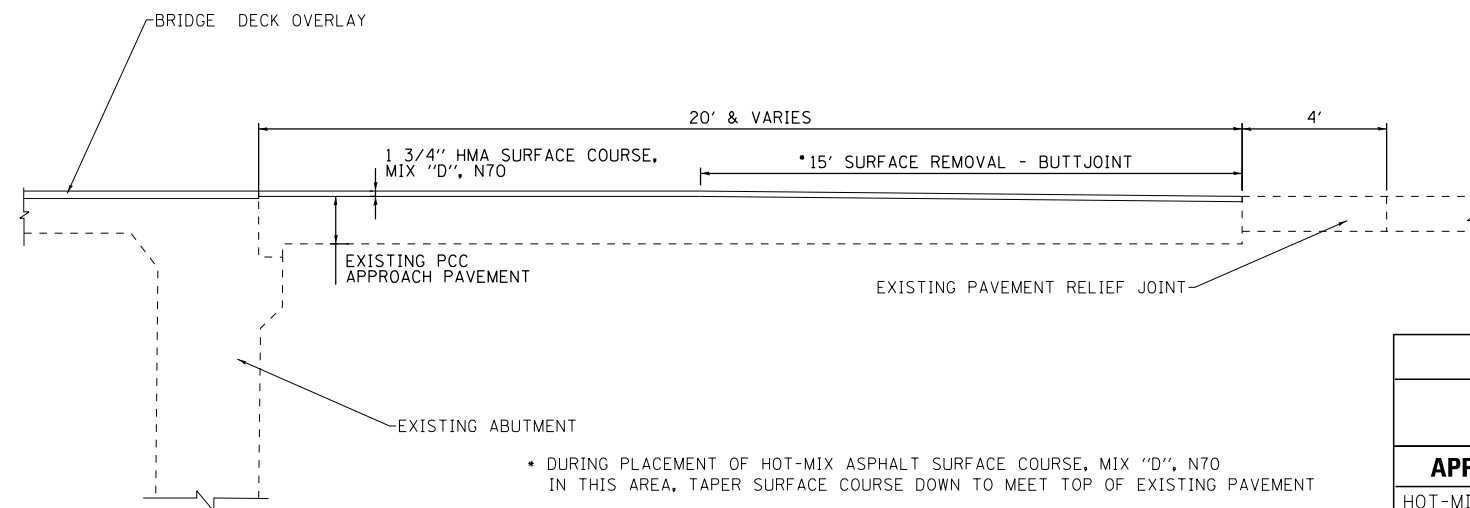

**PROPOSED APPROACH TYPICAL SECTION**

**NOTES**

1. LIMITS OF PROTECTIVE COAT ARE: TOP AND ROADWAY FACES OF PARAPETS.
2. OVERLAY NORTH AND SOUTH APPROACHES WITH HMA TO PROPOSED ELEVATION OF BRIDGE DECK OVERLAY.

HMA MIXTURE REQUIREMENTS		QUALITY MANAGEMENT PROGRAM (QMP)
MIXTURE TYPE	PERCENT AIR VOIDS AT Ndes	
<b>APPROACH OVERLAY</b>		<b>QC/QA</b>
HOT-MIX ASPHALT SURFACE COURSE, MIX "D", N70 (IL 9.5 mm), 1 3/4"	4% AT 70 GYR.	
QMP Designation: Quality Control/Quality Assurance (QC/QA)		

**NOTE:**

1. THE UNIT WEIGHT USED TO CALCULATE ALL HMA SURFACE MIXTURE QUANTITIES IS 112 LBS/SQYD/IN
2. THE "AC TYPE" FOR POLYMERIZED HMA MIXES SHALL BE "SBS/SBR PG 76-22" AND FOR NON-POLYMERIZED HMA THE "AC TYPE" SHALL BE "PG 64-22" UNLESS MODIFIED BY DISTRICT ONE SPECIAL PROVISIONS.
3. FOR USE OF RECYCLED MATERIALS SEE SPECIAL PROVISIONS.
4. QUALITY MANAGEMENT PROGRAM (QMP) IDENTIFIES THE PARTICULAR QUALITY CONTROL SPECIFICATION THAT APPLIES TO THE HMA MIXTURE.

MODEL: Default  
 FILE: \\nas01.cba.eidnet.ecs.illinois.gov:PWIDOT\Documents\DOT\_Offices\District 1\Projects\124018\CADD\Drawings\124018-ah-rlb-dgn

USER NAME = quillaumefp	DESIGNED -	REVISED -
	DRAWN -	REVISED -
PLOT SCALE = 100.0000' / in.	CHECKED -	REVISED -
PLOT DATE = 2/8/2018	DATE -	REVISED -

**STATE OF ILLINOIS  
DEPARTMENT OF TRANSPORTATION**

**WOLF RD. OVER HICKORY CREEK (SN 099-0271)  
TYPICAL SECTION**

SCALE: SHEET OF SHEETS STA. TO STA.

F.A.U. RTE.	SECTION	COUNTY	TOTAL SHEETS	SHEET NO.
2688	2017-064BR	WILL	15	8
ILLINOIS FED. AID PROJECT			CONTRACT NO. 62G06	





**LEGEND**

- ① PROP. POLYUREA PAVING MARKING 4", EDGE LINE, WHITE RIGHT (TYP.)
- ② PROP. POLYUREA PAVING MARKING 4", CENTERLINE, 2 @ 11" C-C YELLOW (TYP.)



**N. BRIDGE APPROACH**

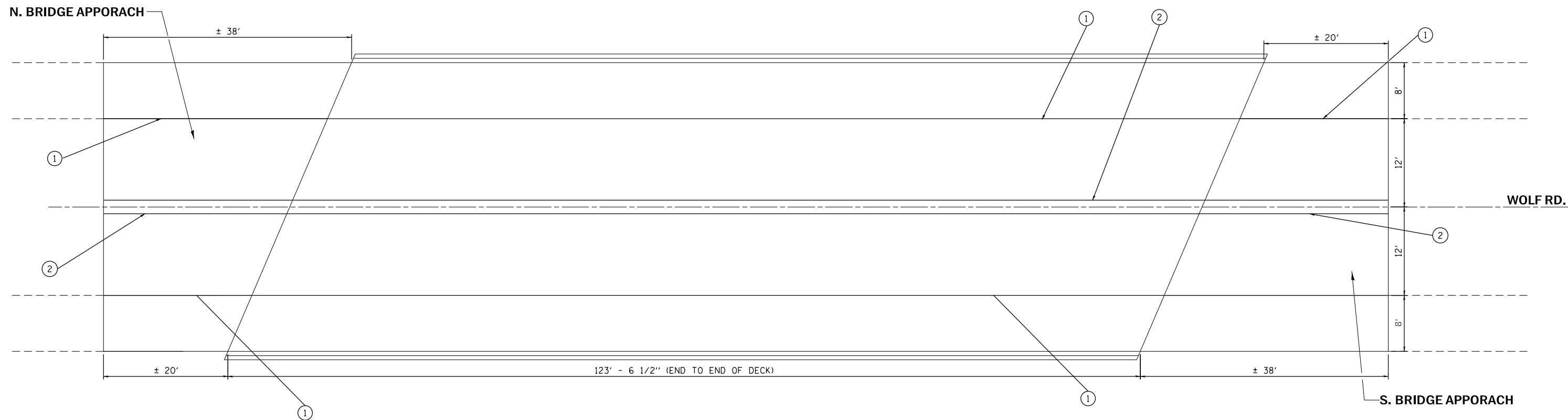

**WOLF RD.**

**S. BRIDGE APPROACH**

123' - 6 1/2" (END TO END OF DECK)

**PLAN**

MODEL: Default  
 FILE: \\nas01.cpe.uiowa.edu\BID\NTEC\Illinois\gov\PI\DOT\Documents\BIDD\Office\BID\ref\1\Projects\1240\BID\CADD\BID\ref\1\1240-18-shr-plan.dgn

USER NAME = quillamefp	DESIGNED -	REVISED -
	DRAWN -	REVISED -
PLOT SCALE = 100.0000' / in.	CHECKED -	REVISED -
PLOT DATE = 2/8/2018	DATE -	REVISED -

**STATE OF ILLINOIS  
DEPARTMENT OF TRANSPORTATION**

<b>WOLF RD. OVER HICKORY CREEK (SN 099-0271)</b>			
<b>PAVEMENT MARKINGS</b>			
SCALE:	SHEET	OF	SHEETS
	STA.		TO STA.

F.A.U. RTE.	SECTION	COUNTY	TOTAL SHEETS	SHEET NO.
2688	2017-064BR	WILL	15	10
CONTRACT NO. 62G06				
ILLINOIS FED. AID PROJECT				

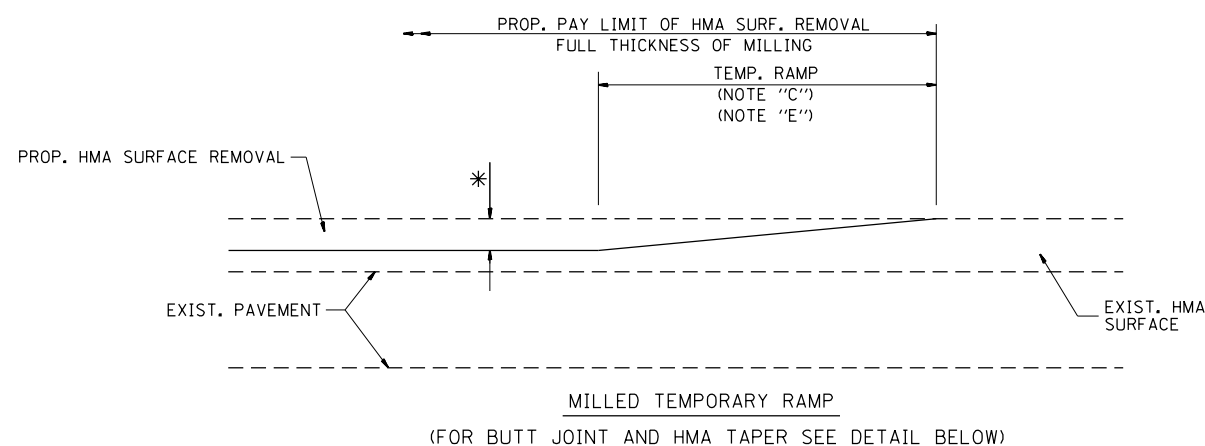

**OPTION 1**

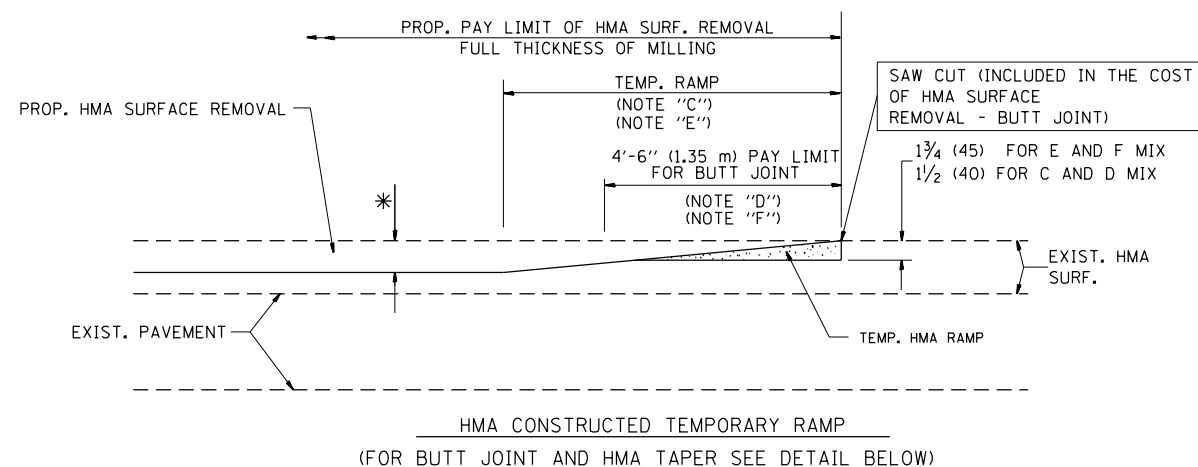

**OPTION 2**

**TYPICAL TEMPORARY RAMP**

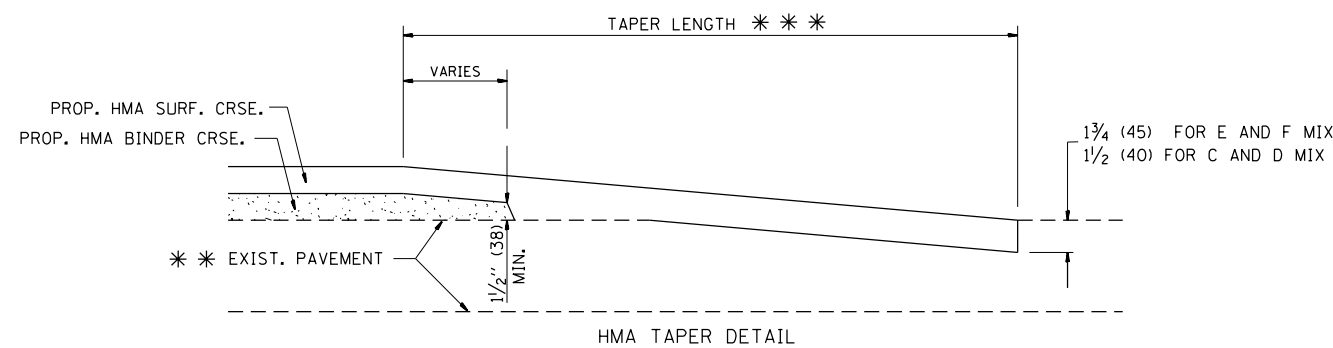
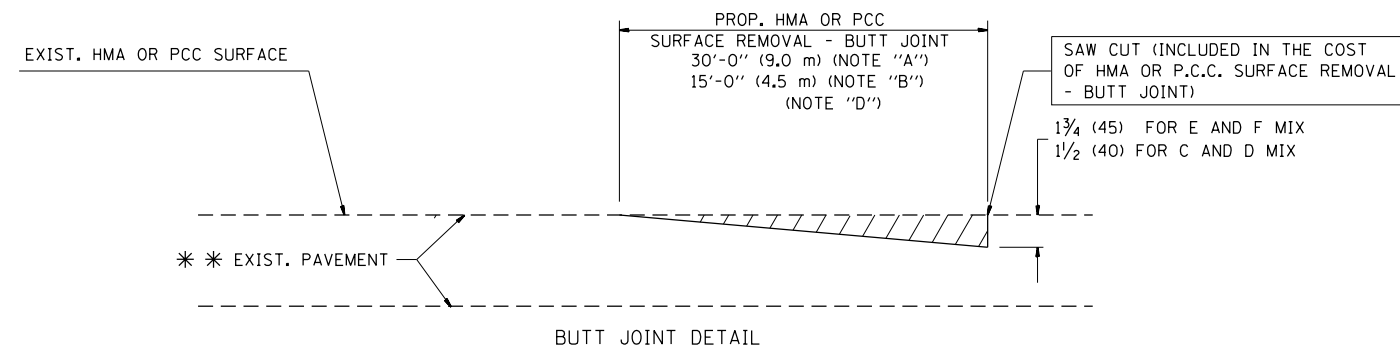

**TYPICAL BUTT JOINT AND HMA TAPER FOR RESURFACING ONLY**

\*\*\* PC CONCRETE, HMA OR HMA RESURFACED PAVEMENT.

**NOTES**

- A: MAINLINE ROADWAYS AND MAJOR SIDE ROADS.
- B: MINOR SIDE ROADS.
- C: THE TEMP. RAMP SHALL BE CONSTRUCTED IMMEDIATELY UPON REMOVAL OF THE EXISTING HMA SURFACE.
- D: THE BUTT JOINT SHALL BE CONSTRUCTED IMMEDIATELY PRIOR TO PLACING THE PROPOSED HMA COURSES.
- E: TAPER THE TEMP. RAMP AT A RATE OF 3'-0" (900 mm) PER 1 INCH (25 mm) OF MILLING THICKNESS.
- F: INSTALLATION AND REMOVAL OF THE 4'-6" (1.35 m) TEMP. RAMP IS INCLUDED IN COST OF HMA SURFACE REMOVAL - BUTT JOINT
- G: SEE ARTICLE 406.08 AND 406.14 OF THE STANDARD SPECIFICATIONS FOR "HMA AND/OR PCC SURFACE REMOVAL, BUTT JOINT".

\* SEE TYPICAL SECTIONS FOR MILLING THICKNESS.

\*\*\* 20'-0" (6.1 m) PER 1 (25) RESURFACING (NOTE "A")  
10'-0" (3.0 m) PER 1 (25) RESURFACING (NOTE "B")

**BASIS OF PAYMENT:**

THE BUTT JOINT WILL BE PAID FOR AT THE CONTRACT UNIT PRICE PER SQUARE YARD (SQUARE METER) FOR "HOT-MIX ASPHALT SURFACE REMOVAL - BUTT JOINT" OR FOR "PORTLAND CEMENT CONCRETE SURFACE REMOVAL - BUTT JOINT".

ALL DIMENSIONS ARE IN INCHES (MILLIMETERS) UNLESS OTHERWISE SHOWN.

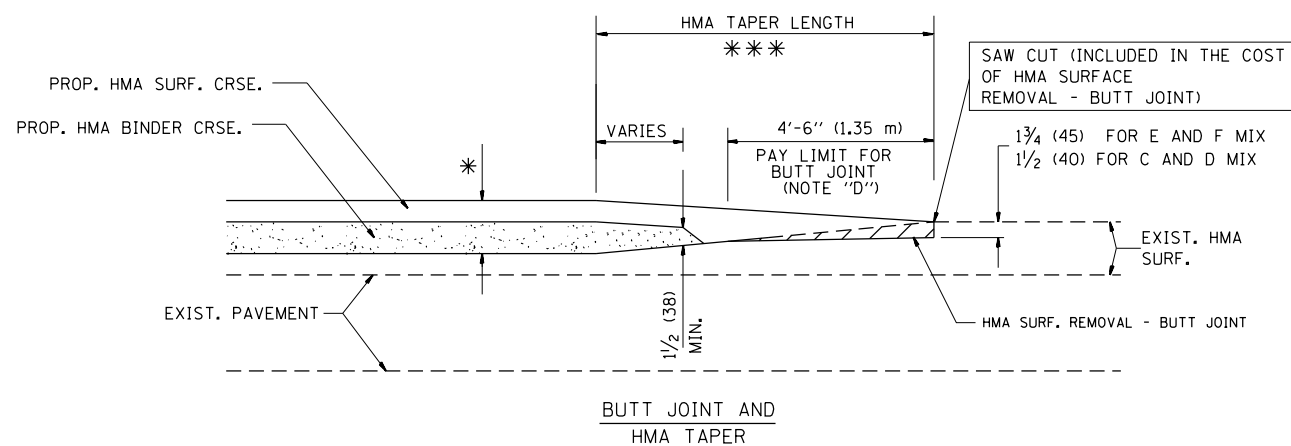

**TYPICAL BUTT JOINT AND HMA TAPER FOR MILLING AND RESURFACING**

FILE NAME =	USER NAME = guillaumejp	DESIGNED - M. DE YONG	REVISED - R. SHAH 10-25-94
p:\1\084EBIDINTEG.illinois.gov\PIWIDOT\Documents\IDOT Offices\District 1\Projects\DI240\Drawings\Design\DistStd.dgn			REVISED - A. ABBAS 03-21-97
	PLOT SCALE = 100.0000' / in.	CHECKED -	REVISED - M. GOMEZ 04-06-01
	PLOT DATE = 2/8/2018	DATE - 06-13-90	REVISED - R. BORO 01-01-07

**STATE OF ILLINOIS  
DEPARTMENT OF TRANSPORTATION**

**BUTT JOINT AND  
HMA TAPER DETAILS**

SCALE: NONE SHEET NO. 1 OF 1 SHEETS STA. TO STA.

F.A.U. RTE.	SECTION	COUNTY	TOTAL SHEETS	SHEET NO.
2688	2017-064BR	WILL	15	11
BD400-05 BD32		CONTRACT NO. 62G06		
FED. ROAD DIST. NO. 1 ILLINOIS FED. AID PROJECT				

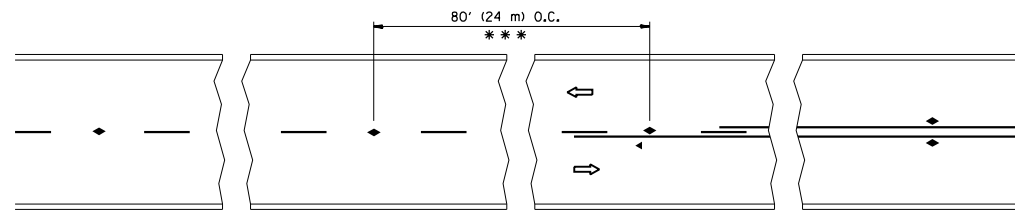

\*\*\* REDUCE TO 40' (12 m) O.C. ON CURVES WITH POSTED OR ADVISORY SPEED 45 M.P.H. (70 km/h) OR LESS.

TWO-LANE/TWO-WAY

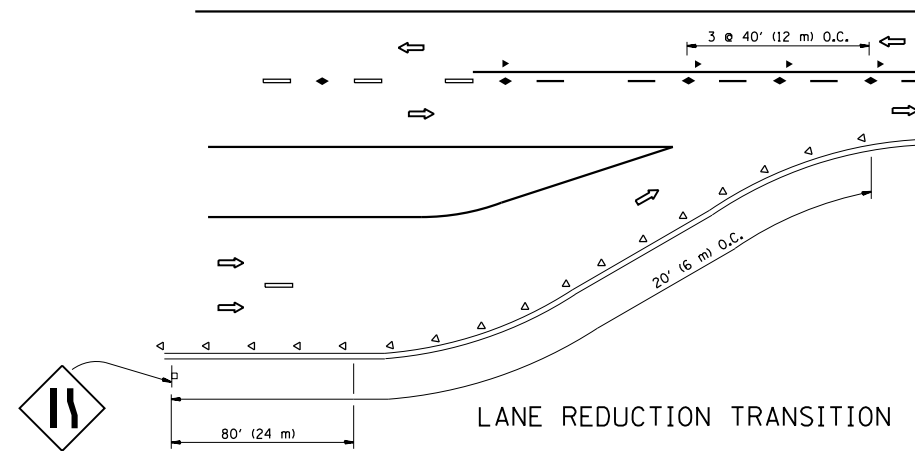

LANE REDUCTION TRANSITION

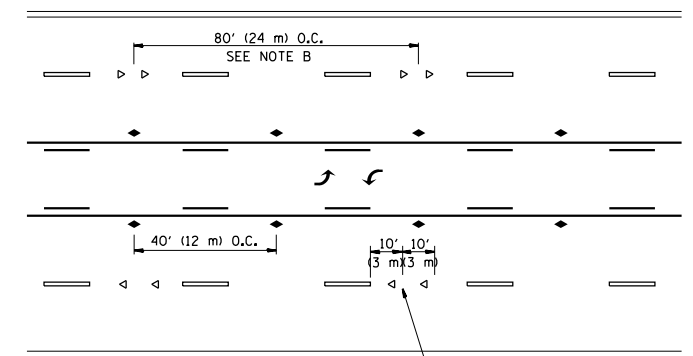

TWO-WAY LEFT TURN

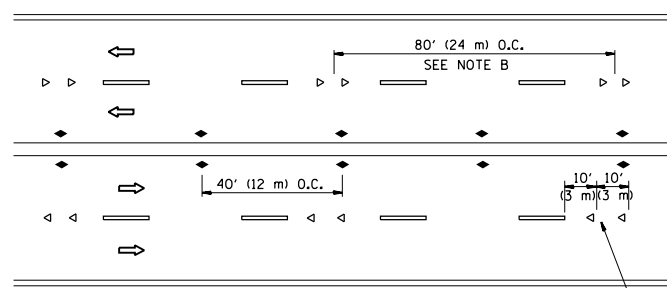

MULTI-LANE/UNDIVIDED

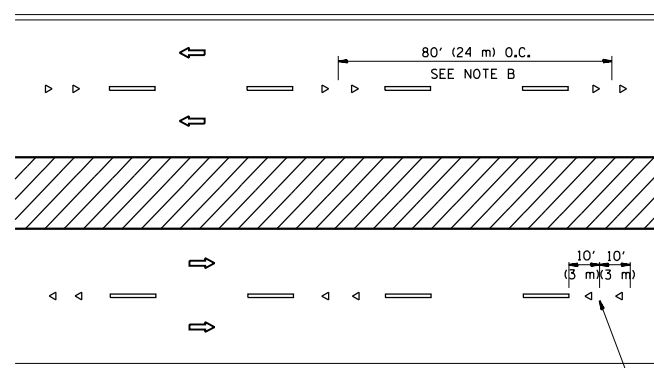

MULTI-LANE/DIVIDED

GENERAL NOTES

1. MARKERS USED WITH DASHED LINES SHALL BE CENTERED IN THE GAP BETWEEN SEGMENTS.
2. MARKERS USED ADJACENT TO SOLID LINES SHALL BE OFFSET 2 TO 3 (50 TO 75) TOWARD TRAFFIC AS SHOWN.
3. MARKERS THROUGH TANGENTS LESS THAN 500' (150 m) IN LENGTH BETWEEN CURVES SHALL BE INSTALLED AT THE LESSER OF THE TWO CURVE SPACINGS.

SYMBOLS

- YELLOW STRIPE
- WHITE STRIPE
- ◀ ONE-WAY AMBER MARKER
- ◁ ONE-WAY CRYSTAL MARKER (W/O)
- ◆ TWO-WAY AMBER MARKER

LANE MARKER NOTES

- A. USE DOUBLE LANE LINE MARKERS SPACED AS SHOWN.
- B. REDUCE TO 40' (12 m) O.C. ON CURVES WHERE ADVISORY SPEEDS ARE 10 M.P.H (20 km/h) LOWER THAN POSTED SPEEDS.

DESIGN NOTES

1. DOUBLE LANE LINE MARKERS SHALL BE USED UNLESS SPECIFIED OTHERWISE.
2. EXCEPT AS SHOWN ON THE LANE REDUCTION TRANSITION AND FREEWAY EXIT RAMP DETAIL, MARKERS ARE NOT TO BE SPECIFIED ON RIGHT EDGE LINES.
3. THE EXACT MARKER LIMITS, SPACING, AND COLOR SHALL BE INCLUDED IN THE PLANS WHEN STANDARD SPECIFICATIONS ARE NOT BEING USED.
4. MARKERS SHOULD NOT BE USED ALONGSIDE CURBS EXCEPT FOR EXTREMELY SHORT SECTIONS OF CURBS WHERE NOT MORE THAN TWO MARKERS WOULD BE INVOLVED.

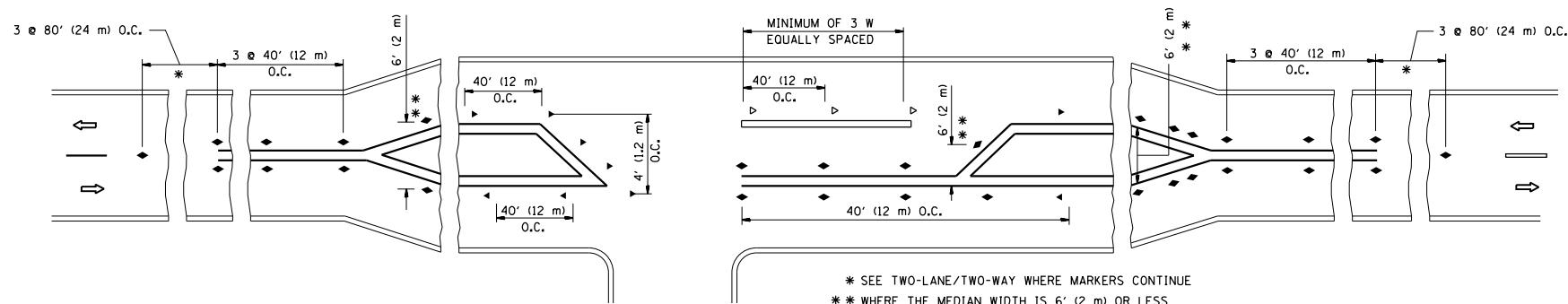

LEFT TURN

\* SEE TWO-LANE/TWO-WAY WHERE MARKERS CONTINUE  
 \*\* WHERE THE MEDIAN WIDTH IS 6' (2 m) OR LESS USE TWO-WAY MARKERS.

All dimensions are in inches (millimeters) unless otherwise shown.

FILE NAME =	USER NAME = guillaumejp	DESIGNED -	REVISED - T. RAMMACHER 09-19-94
pw:\IL\084EBIDINTEG\illinois.gov\PIWIDOT\Documents\IDOT Offices\District 1\Projects\DI240\Drawings\Design\DistStd.dgn		CHECKED -	REVISED - T. RAMMACHER 03-12-99
		DATE -	REVISED - T. RAMMACHER 01-06-00
			REVISED - C. JUCIUS 09-09-09

STATE OF ILLINOIS  
DEPARTMENT OF TRANSPORTATION

TYPICAL APPLICATIONS			
RAISED REFLECTIVE PAVEMENT MARKERS (SNOW-PLOW RESISTANT)			
SCALE: NONE	SHEET NO. 1 OF 1 SHEETS	STA.	TO STA.

F.A.U. RTE.	SECTION	COUNTY	TOTAL SHEETS	SHEET NO.
2688	2017-064BR	WILL	15	12
TC-11		CONTRACT NO. 62G06		
FED. ROAD DIST. NO. 1 ILLINOIS FED. AID PROJECT				

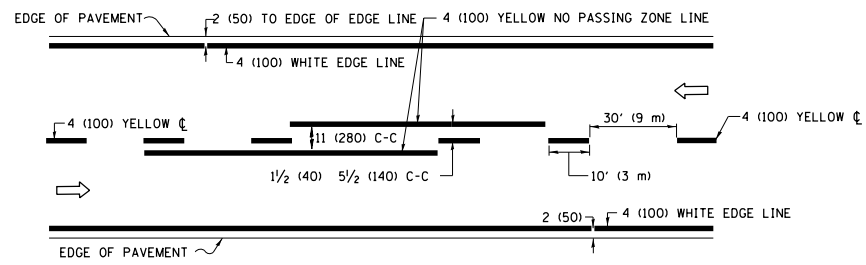

**2-LANE ROADWAY**

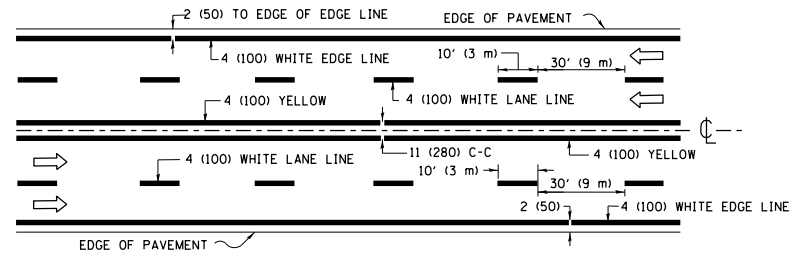

**MULTI-LANE UNDIVIDED**

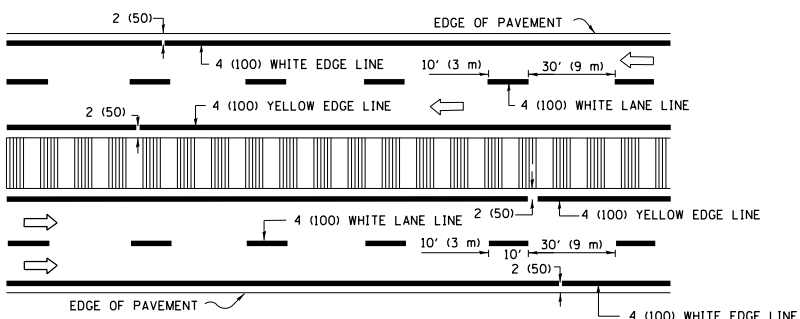

**MULTI-LANE DIVIDED WITH MEDIAN**

**TYPICAL LANE AND EDGE LINE MARKING**

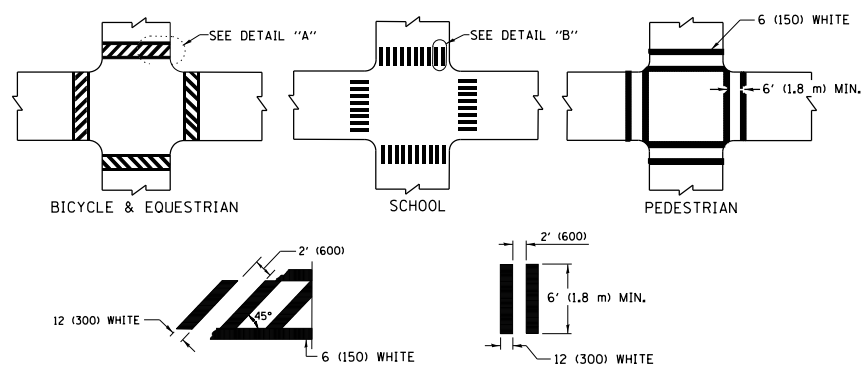

**TYPICAL CROSSWALK MARKING**

\* MARKINGS SHALL BE INSTALLED PARALLEL TO THE CENTERLINE OF THE ROAD WHICH IT CROSSES

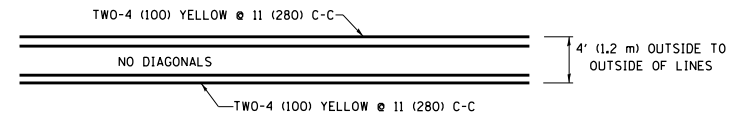

**4' (1.2 m) WIDE MEDIANS ONLY**

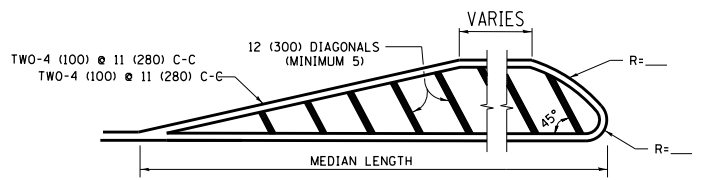

**MEDIANS OVER 4' (1.2 m) WIDE**

DIAGONAL LINE SPACING: 50' (15 m) C-C (LESS THAN 30MPH (50 km/h))  
75' (25 m) C-C 30MPH (50 km/h) TO 45MPH (70 km/h)  
150' (45 m) C-C (MORE THAN 45MPH (70 km/h))

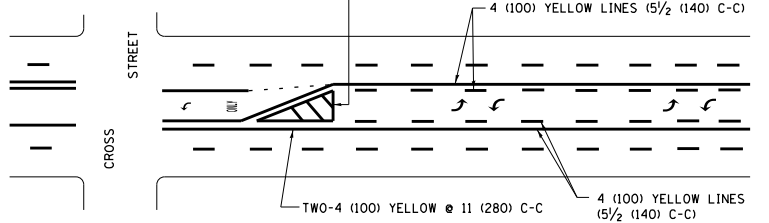

**MEDIAN WITH TWO-WAY LEFT TURN LANE  
TYPICAL PAINTED MEDIAN MARKING**

A MINIMUM OF TWO PAIRS OF TURN ARROWS SHALL BE USED, WHITE IN COLOR. ADDITIONAL PAIRS SHALL BE PLACED AT 200' (60 m) TO 300' (90 m) INTERVALS.

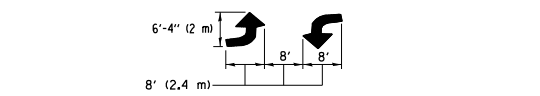

**TYPICAL LEFT (OR RIGHT) TURN LANE**

**TYPICAL TURN LANE MARKING**

FULL SIZE LETTERS 8" (2.4 m) AND ARROWS SHALL BE USED.  
AREA = 15.6 SQ. FT. (1.5 m<sup>2</sup>) ONLY AREA = 20.8 SQ. FT. (1.9 m<sup>2</sup>)  
\* TURN LANES IN EXCESS OF 400' (120 m) IN LENGTH MAY HAVE AN ADDITIONAL SET OF ARROW - "ONLY" INSTALLED MIDWAY BETWEEN THE OTHER TWO SETS OF ARROW - "ONLY".

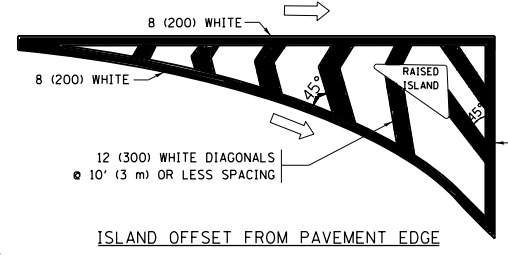

**ISLAND OFFSET FROM PAVEMENT EDGE**

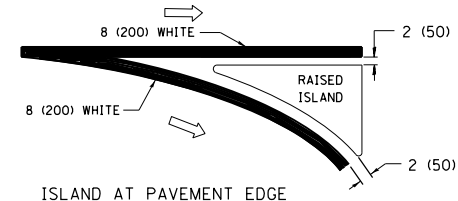

**ISLAND AT PAVEMENT EDGE  
TYPICAL ISLAND MARKING**

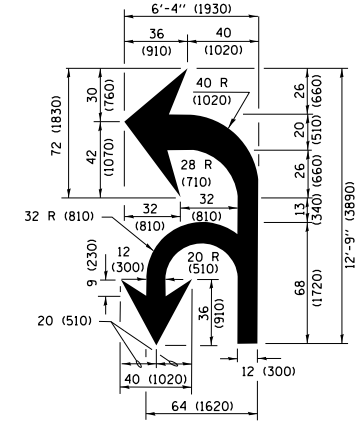

**COMBINATION LEFT AND U-TURN**

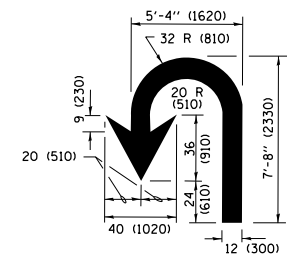

**U-TURN**

**LANE REDUCTION TRANSITION**

\* LANE REDUCTION ARROWS REQUIRED AT SPEEDS OF 45 MPH OR GREATER OR WHEN SPECIFIED IN PLANS.

D(FT)	SPEED LIMIT
345	30
425	35
500	40
580	45
665	50
750	55

TYPE OF MARKING	WIDTH OF LINE	PATTERN	COLOR	SPACING /REMARKS
CENTERLINE ON 2 LANE PAVEMENT	4 (100)	SKIP-DASH	YELLOW	10' (3 m) LINE WITH 30' (9 m) SPACE
CENTERLINE ON MULTI-LANE UNDIVIDED PAVEMENT	2 @ 4 (100)	SOLID	YELLOW	11 (280) C-C
NO PASSING ZONE LINES FOR ONE DIRECTION FOR BOTH DIRECTIONS	4 (100) 2 @ 4 (100)	SOLID SOLID	YELLOW YELLOW	5 1/2 (140) C-C FROM SKIP-DASH CENTERLINE 11 (280) C-C OMIT SKIP-DASH CENTERLINE BETWEEN
LANE LINES	4 (100) 5 (125) ON FREEWAYS	SKIP-DASH SKIP-DASH	WHITE WHITE	10' (3 m) LINE WITH 30' (9 m) SPACE
DOTTED LINES (EXTENSIONS OF CENTER, LANE OR TURN LANE MARKINGS)	SAME AS LINE BEING EXTENDED	SKIP-DASH	SAME AS LINE BEING EXTENDED	2' (600) LINE WITH 6' (1.8 m) SPACE
EDGE LINES	4 (100)	SOLID	YELLOW-LEFT WHITE-RIGHT	OUTLINE MEDIANS IN YELLOW
TURN LANE MARKINGS	6 (150) LINE; FULL SIZE LETTERS & SYMBOLS (8' (2.4m))	SOLID	WHITE	SEE TYPICAL TURN LANE MARKING DETAIL
TWO WAY LEFT TURN MARKING	2 @ 4 (100) EACH DIRECTION 8' (2.4m) LEFT ARROW	SKIP-DASH AND SOLID IN PAIRS	YELLOW WHITE	10' (3 m) LINE WITH 30' (9 m) SPACE FOR SKIP-DASH; 5 1/2 (140) C-C BETWEEN SOLID LINE AND SKIP-DASH LINE SEE TYPICAL TWO-WAY LEFT TURN MARKING DETAIL
CROSSWALK LINES (PEDESTRIAN) A. DIAGONALS (BIKE & EQUESTRIAN) B. LONGITUDINAL BARS (SCHOOL)	2 @ 6 (150) 12 (300) @ 45° 12 (300) @ 90°	SOLID SOLID SOLID	WHITE WHITE WHITE	NOT LESS THAN 6' (1.8 m) APART 2' (600) APART 2' (600) APART SEE TYPICAL CROSSWALK MARKING DETAILS.
STOP LINES	24 (600)	SOLID	WHITE	PLACE 4' (1.2 m) IN ADVANCE OF AND PARALLEL TO CROSSWALK, IF PRESENT, OTHERWISE, PLACE AT DESIRED STOPPING POINT, PARALLEL TO CROSSROAD CENTERLINE, WHERE POSSIBLE.
PAINTED MEDIANS	2 @ 4 (100) WITH 12 (300) DIAGONALS @ 45° NO DIAGONALS USED FOR 4' (1.2 m) WIDE MEDIANS	SOLID	YELLOW; TWO WAY TRAFFIC WHITE; ONE WAY TRAFFIC	11 (280) C-C FOR THE DOUBLE LINE SEE TYPICAL PAINTED MEDIAN MARKING.
GORE MARKING AND CHANNELIZING LINES	8 (200) WITH 12 (300) DIAGONALS @ 45°	SOLID	WHITE	DIAGONALS: 15' (4.5 m) C-C (LESS THAN 30MPH (50 km/h)) 20' (6 m) C-C 30MPH (50 km/h) TO 45MPH (70 km/h) 30' (9 m) C-C (OVER 45MPH (70 km/h))
RAILROAD CROSSING	24 (600) TRANSVERSE LINES; "RR" IS 6' (1.8 m) LETTERS; 16 (400) LINE FOR "X"	SOLID	WHITE	SEE STATE STANDARD 780001 AREA OF: "R"=3.6 SQ. FT. (0.33 m <sup>2</sup> ) EACH "X"=54.0 SQ. FT. (5.0 m <sup>2</sup> )
SHOULDER DIAGONALS (REQUIRED FOR SHOULDERS ≥ 8')	12 (300) @ 45°	SOLID	WHITE - RIGHT YELLOW - LEFT	50' (15 m) C-C (LESS THAN 30MPH (50 km/h)) 75' (25 m) C-C (30 MPH (50 km/h) TO 45MPH (70 km/h)) 150' (45 m) C-C (OVER 45MPH (70 km/h))
U TURN ARROW	SEE DETAIL	SOLID	WHITE	16.3 SF
2 ARROW COMBINATION LEFT AND U TURN	SEE DETAIL	SOLID	WHITE	30.4 SF

FOR FURTHER DETAILS ON PAVEMENT MARKING REFER TO STANDARD SPECIFICATIONS FOR ROAD AND BRIDGE CONSTRUCTION AND STATE STANDARD 780001.

All dimensions are in inches (millimeters) unless otherwise shown.



FILE NAME =	USER NAME = guillaumejp	DESIGNED - EVERS	REVISED - C. JUCIUS 09-09-09
pw\1\084EBIDINTEG\illinois.gov\PIWIDOT\Documents\DOT Offices\District 1\Projects\DI240\Drawings\Design\DistStd.dgn		CHECKED -	REVISED - C. JUCIUS 07-01-13
Default	PLOT SCALE = 100.0000' / in.	DATE - 03-19-90	REVISED - C. JUCIUS 12-21-15
	PLOT DATE = 2/8/2018		REVISED - C. JUCIUS 04-12-16

**STATE OF ILLINOIS  
DEPARTMENT OF TRANSPORTATION**





<b>DISTRICT ONE</b>			
<b>TYPICAL PAVEMENT MARKINGS</b>			
SCALE: NONE	SHEET 1	OF 1 SHEETS	STA. TO STA.

F.A.U R.T.E.	SECTION	COUNTY	TOTAL SHEETS	SHEET NO.
2688	2017-064BR	WILL	15	13
<b>TC-13</b>		<b>CONTRACT NO. 62G06</b>		
ILLINOIS FED. AID PROJECT				



**ROUTE MARKERS**

-  FOR U.S. ROUTES  
M1-40-2424
-  FOR ILLINOIS ROUTES  
M1-50-2424
-  R.R., UNMARKED ROUTES  
SPECIAL 24" x 18" VARIABLE  
4" BLACK LETTERS ON WHITE  
REFLECTIVE BACKGROUND

**ARROWS SIGNS**

-  M5-1L-2115
-  M5-1R-2115
-  M6-1-2115
-  M6-1-2115
-  M6-3-2115

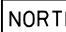
**CARDINAL DIRECTION & DETOUR SIGNS**

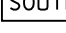
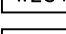
-  NORTH M3-1-2412
-  EAST M3-2-2412
-  SOUTH M3-3-2412
-  WEST M3-4-2412
-  DETOUR M4-8-2412

**STATE ROUTE**

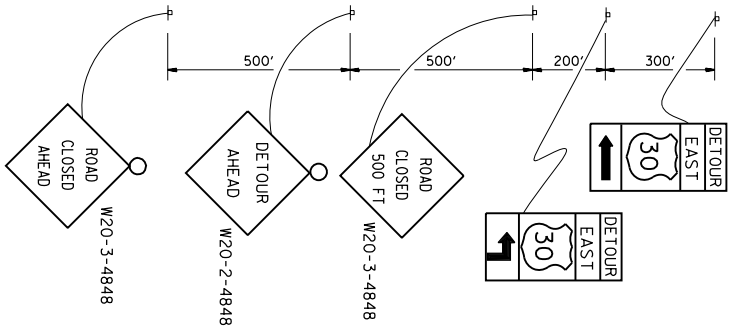

**COMPLETELY CLOSED PORTION**

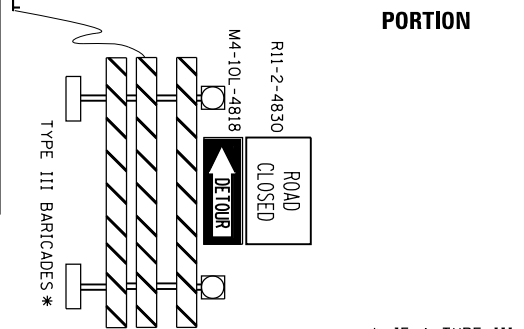

**PARTIALLY CLOSED PORTION**

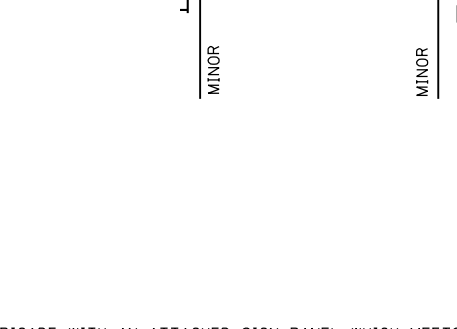

**STATE ROUTE**

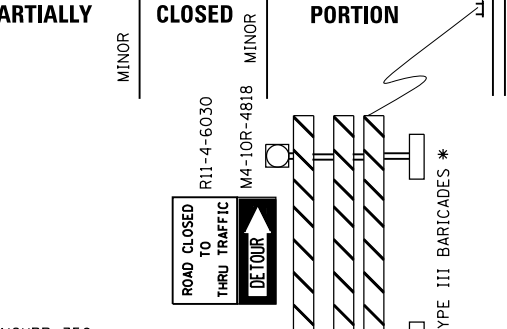

\* IF A TYPE III BARRICADE WITH AN ATTACHED SIGN PANEL WHICH MEETS NCHRP 350 REQUIREMENTS IS NOT AVAILABLE, THE SIGNS SHALL BE MOUNTED, ABOVE THE BARRICADES, ON SEPARATE SIGNS SUPPORTS THAT MEET NCHRP 350 REQUIREMENTS.

FILE NAME =	USER NAME = guillaumejp	DESIGNED -	REVISED - 10-18-02
p:\1\084EBIDINTEG\illinois.gov\PIWIDOT\Documents\IDOT Offices\District 1\Projects\DI240\Drawings\Design\DistStd.dgn		CHECKED -	REVISED - R. BORO 09-14-09
		DATE -	REVISED -
			REVISED -

**STATE OF ILLINOIS  
DEPARTMENT OF TRANSPORTATION**

<b>DETOUR SIGNING</b>		<b>FOR CLOSING STATE HIGHWAYS</b>	
SCALE: NONE	SHEET NO. 1 OF 1 SHEETS	STA.	TO STA.

F.A.U. RE.	SECTION	COUNTY	TOTAL SHEETS	SHEET NO.
2688	2017-064BR	WILL	15	14
<b>TC-21</b>		<b>CONTRACT NO. 62G06</b>		
FED. ROAD DIST. NO. 1 ILLINOIS FED. AID PROJECT				

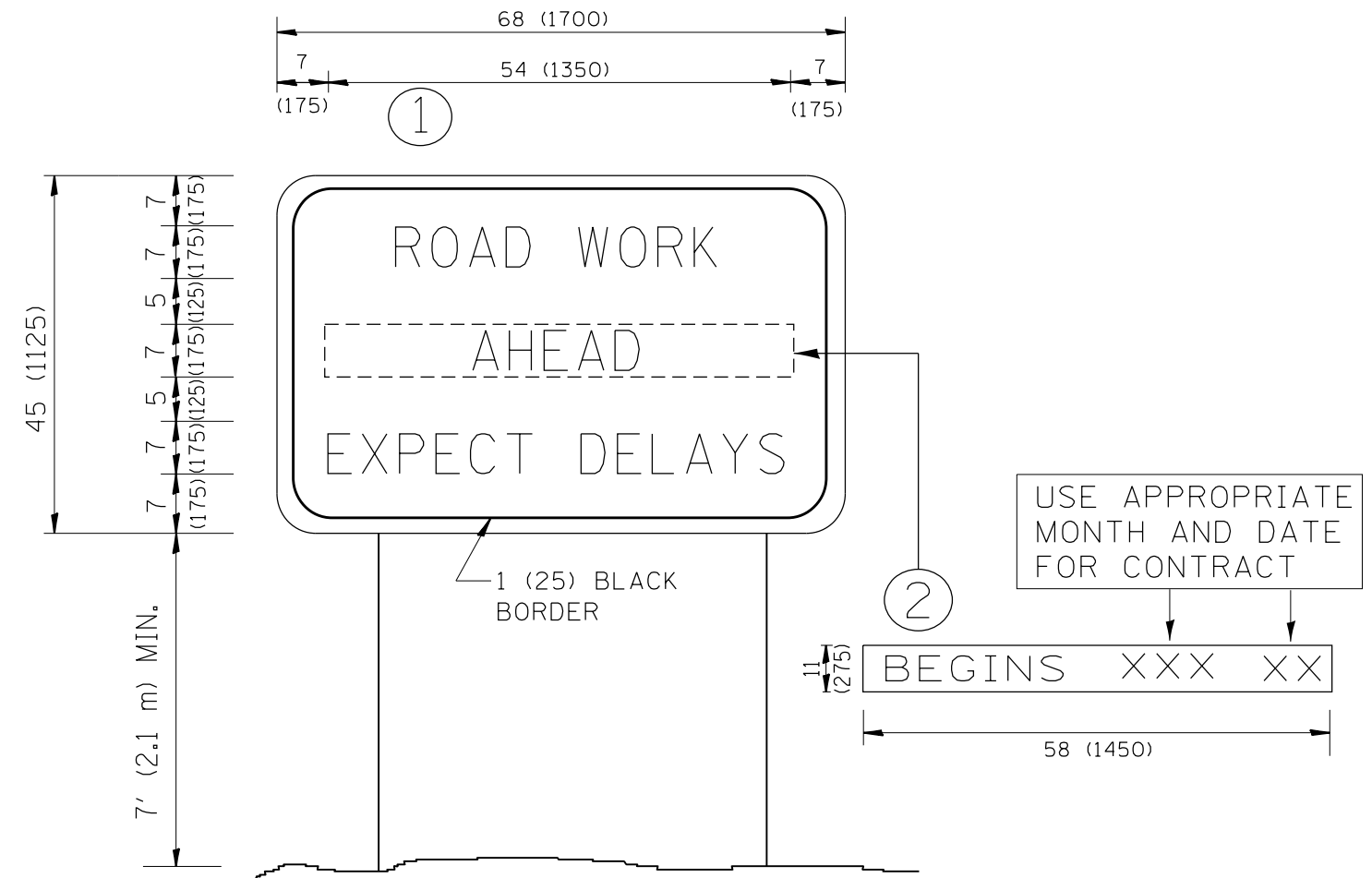

**NOTES:**

1. USE BLACK LETTERING ON ORANGE BACKGROUND.
2. ERECT SIGNS IN ADVANCE OF THE LOCATION FOR THE "ROAD CONSTRUCTION AHEAD" SIGN AT LOCATIONS AS DIRECTED BY THE ENGINEER.
3. ERECT SIGN ① WITH INSTALLED PANEL ② ONE WEEK PRIOR TO THE START OF CONSTRUCTION.
4. REMOVE PANEL ② SOON AFTER THE START OF CONSTRUCTION.
5. SEE SPECIAL PROVISION FOR "TEMPORARY INFORMATION SIGNING" FOR ADDITIONAL INFORMATION.
6. ONE SIGN ASSEMBLY EQUALS 25.70 SQ. FT. (2.3 SQ. M.)
7. SHALL BE PAID FOR AS TEMPORARY INFORMATION SIGNING.

ALL DIMENSIONS ARE IN INCHES (MILLIMETERS) UNLESS OTHERWISE SHOWN.

FILE NAME =	USER NAME = guillaumejp	DESIGNED -	REVISED - R. MIRS 09-15-97	<b>STATE OF ILLINOIS DEPARTMENT OF TRANSPORTATION</b>	<b>ARTERIAL ROAD INFORMATION SIGN</b>	F.A.U. RTE.	SECTION	COUNTY	TOTAL SHEETS	SHEET NO.
p:\11\084EBIDINTEG.illinois.gov\PWIDOT\Documents\DOT Offices\District 1\Projects\DI2400\Drawings\Design\DistStd.dgn		REVISED - R. MIRS 12-11-97	REVISED - T. RAMMACHER 02-02-99			2688	2017-064BR	WILL	15	15
PLOT SCALE = 100.0000' / in.	CHECKED -	REVISED - C. JUCIUS 01-31-07				<b>TC-22</b>		<b>CONTRACT NO. 62G06</b>		
PLOT DATE = 2/8/2018	DATE -					SCALE: NONE		SHEET NO. 1 OF 1 SHEETS		STA. TO STA.