

PLAN	DATE
BY	
REVISIONS	
NO.	
DATE	
BY	
DESCRIPTION	
1	
2	
3	
4	
5	
6	
7	
8	
9	
10	

PROFILE	DATE
BY	
REVISIONS	
NO.	
DATE	
BY	
DESCRIPTION	
1	
2	
3	
4	
5	
6	
7	
8	
9	
10	

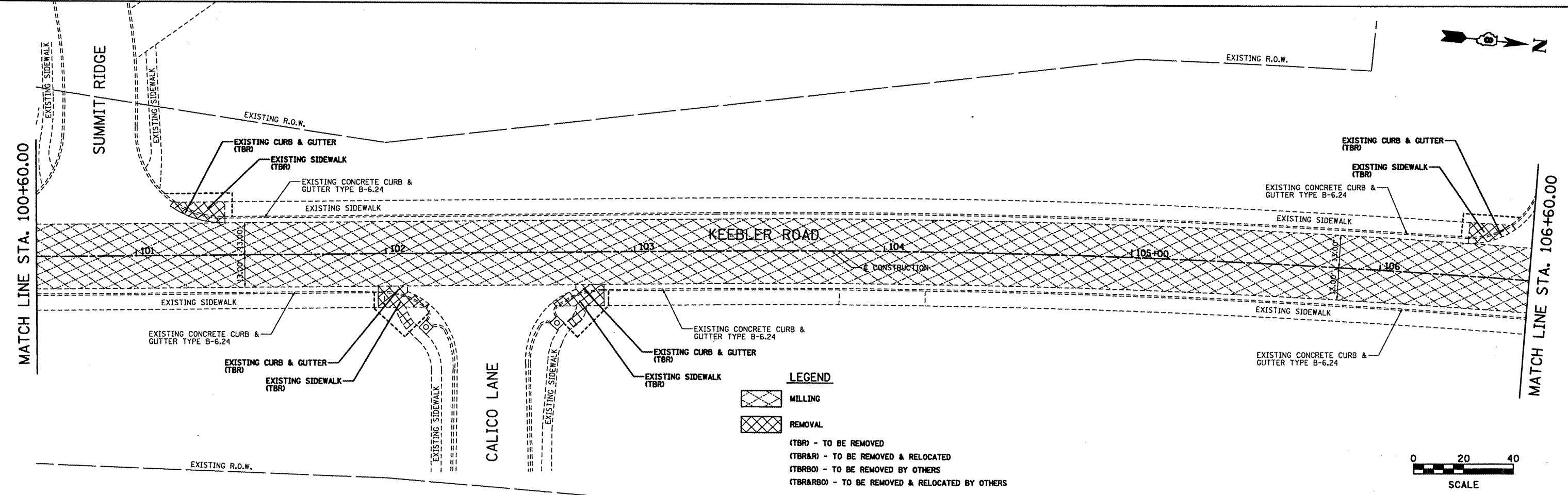
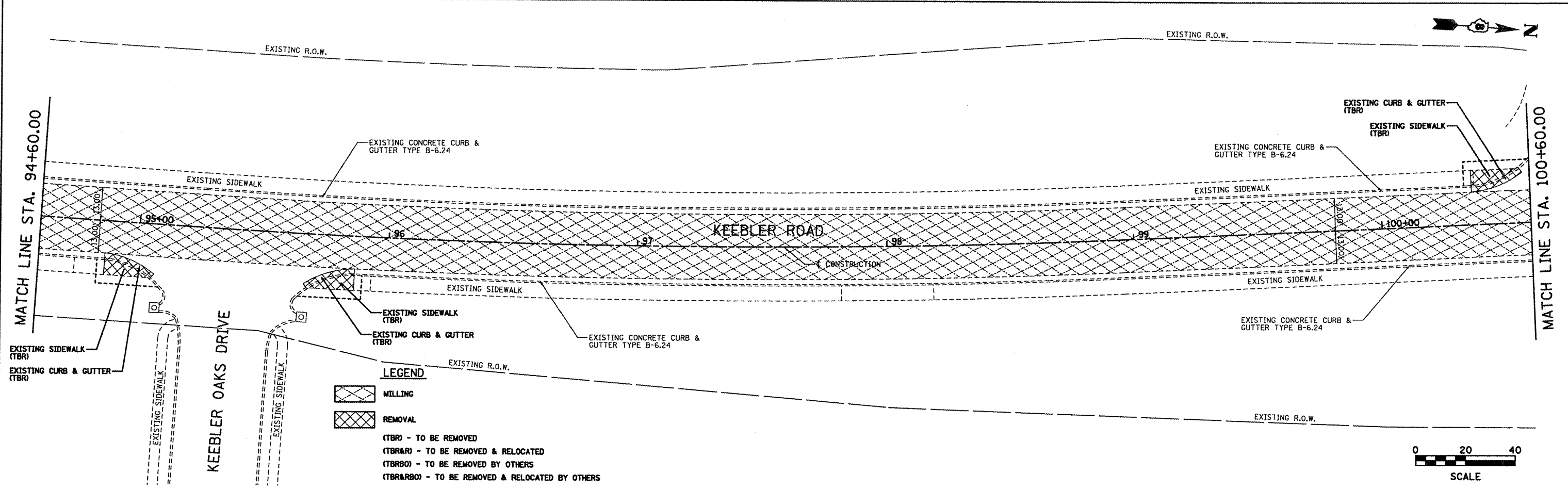

**LEGEND**

MILLING

REMOVAL

(TBR) - TO BE REMOVED  
 (TBR&R) - TO BE REMOVED & RELOCATED  
 (TBR&O) - TO BE REMOVED BY OTHERS  
 (TBR&R&O) - TO BE REMOVED & RELOCATED BY OTHERS

**LEGEND**

MILLING

REMOVAL

(TBR) - TO BE REMOVED  
 (TBR&R) - TO BE REMOVED & RELOCATED  
 (TBR&O) - TO BE REMOVED BY OTHERS  
 (TBR&R&O) - TO BE REMOVED & RELOCATED BY OTHERS

FILE NAME = P1an_03.dgn	USER NAME = famesh	DESIGNED - BFK	REVISED -	<b>VILLAGE OF MARYVILLE KEEBLER ROAD</b>	<b>REMOVAL</b>	F.A.I. RTE. 9135	SECTION 10-00018-00-RS	COUNTY MADISON	TOTAL SHEETS 22	SHEET NO. 20		
PLOT SCALE = #SCALE#	CHECKED - BFK	REVISED -	SCALE: 1"=20'			SHEET NO. 2 OF 3 SHEETS	STA. 94+60.00 TO STA. 106+60.00	CONTRACT NO. 97486				
PLOT DATE = 3/8/2012	DATE - 1/17/12	REVISED -	ILLINOIS FED. AID PROJECT									