

PLAN	DATE
SURVEYED	BY
ALIGNED	
CHECKED	
RT. OF WAY	
CHECKED	
PAV. FILE NAME	

PROFILE	DATE
SURVEYED	BY
GRADES	
CHECKED	
NOTE BOOK	
STRUCTURE	
NOTATIONS	
CHKD	

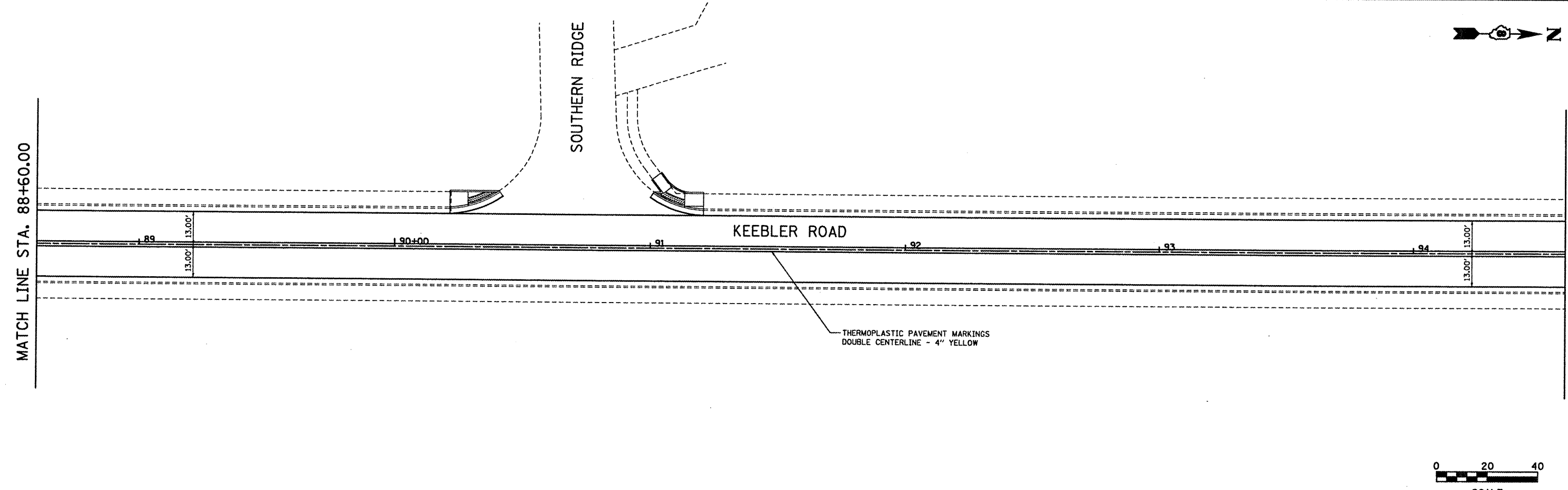
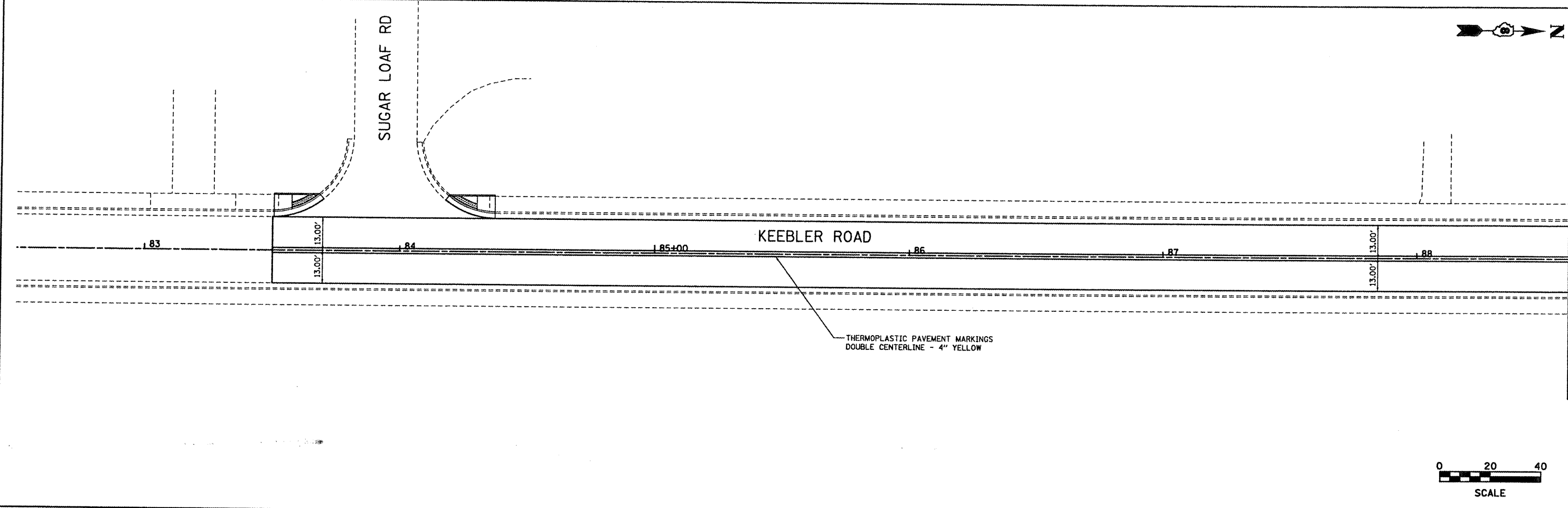

FILE NAME = Pmark_01.dgn	USER NAME = ramesh	DESIGNED - BFK	REVISED -	<b>VILLAGE OF MARYVILLE KEEBLER ROAD</b>	<b>PAVEMENT MARKINGS</b>			F.A.U. RTE. 9135	SECTION 10-00018-00-RS	COUNTY MADISON	TOTAL SHEETS 22	SHEET NO. 16
	PLOT SCALE = #SCALE#	DRAWN - JJB	REVISED -		SCALE: 1"=20'	SHEET NO. 1 OF 3 SHEETS	STA. 82+60.00 TO STA. 94+60.00	CONTRACT NO. 97486		[ILLINOIS] FED. AID PROJECT		
	PLOT DATE = 3/8/2012	CHECKED - BFK	REVISED -									
		DATE - 1/17/12	REVISED -									