

55	60	65	70	75
F.A.S.	SECTION	COUNTY	TOTAL SHEETS	SHEET NO.
680	10-00101-00-SP	EDGAR	132	131
EDGAR COUNTY, ILLINOIS		CONTRACT NO. 91467		

**187 + 30.70**  
**PRIVATE ENTRANCE**

**185 + 25.00**

**182 + 75.00**

DATE	BY
DATE	BY
DATE	BY
DATE	BY
DATE	BY

DATE	BY
DATE	BY
DATE	BY
DATE	BY
DATE	BY

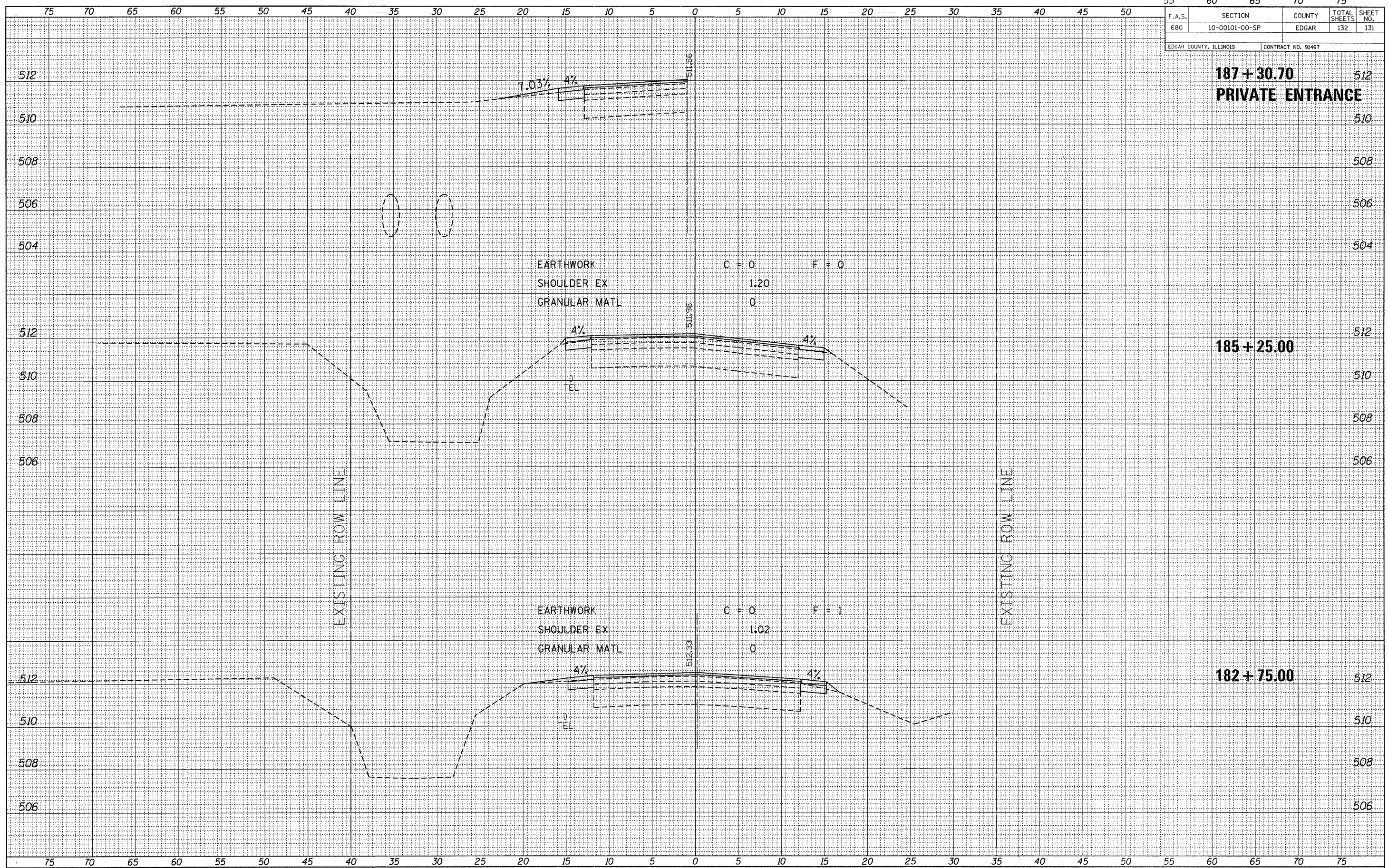

FILE NAME = 118330-sht-sxs.dgn  
PLOT DATE = 1/19/2012  
SCALE: 1" = 5' HORZ, 1" = 2' VERT

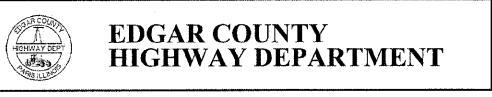

**CROSS SECTIONS EAST OF ELBRIDGE**  
STATION 182+75 TO STATION 187+30.70