

55	60	65	70	75
F.A.S.	SECTION	COUNTY	TOTAL SHEETS	SHEET NO.
680	10-00101-00-SP	EDGAR	132	71
EDGAR COUNTY, ILLINOIS		CONTRACT NO. 91467		

FINAL SURVEY	SURVEYED	DATE
NOTE BOOK	PLOTTED	
NO.	TEMPLATE	
	AREAS CHECKED	

ORIGINAL SURVEY	SURVEYED	DATE
NOTE BOOK	PLOTTED	
NO.	TEMPLATE	
	AREAS CHECKED	

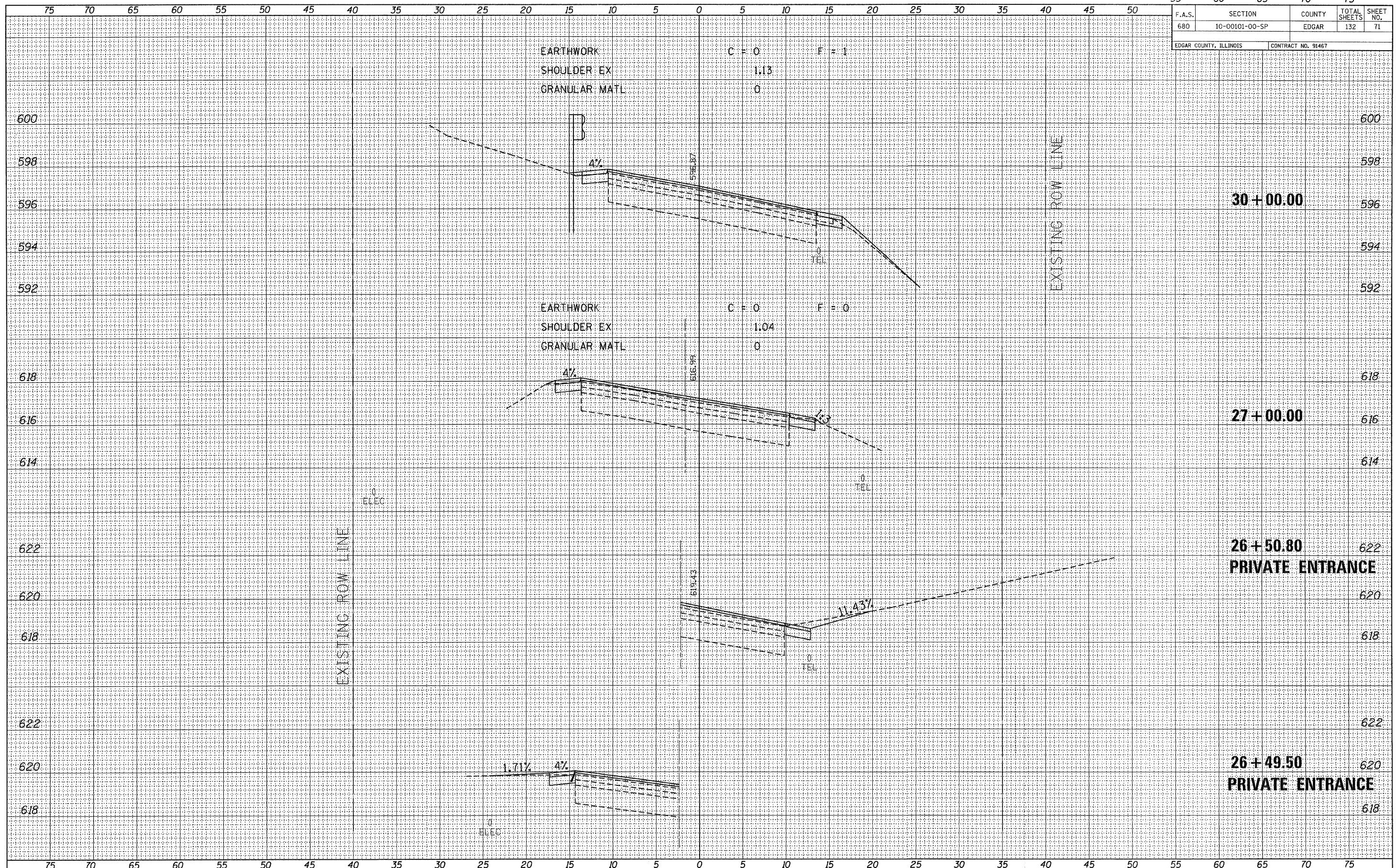

FILE NAME = 118330-shr-axs.dgn
 PLOT DATE = 1/19/2012
 SCALE: 1" = 5' HORIZ, 1" = 2' VERT



CROSS SECTIONS EAST OF ELBRIDGE
 STATION 26+49.50 TO STATION 30+00