

F.A.S.	SECTION	COUNTY	TOTAL SHEETS	SHEET NO.
680	10-00101-00-SP	EDGAR	132	56
EDGAR COUNTY, ILLINOIS		CONTRACT NO. 91467		

FINAL SURVEY	SURVEYED	DATE
NOTE BOOK NO.	PLOTTED	
	TEMPLATE	
	AREAS CHECKED	

ORIGINAL SURVEY	SURVEYED	DATE
NOTE BOOK NO.	PLOTTED	
	TEMPLATE	
	AREAS CHECKED	

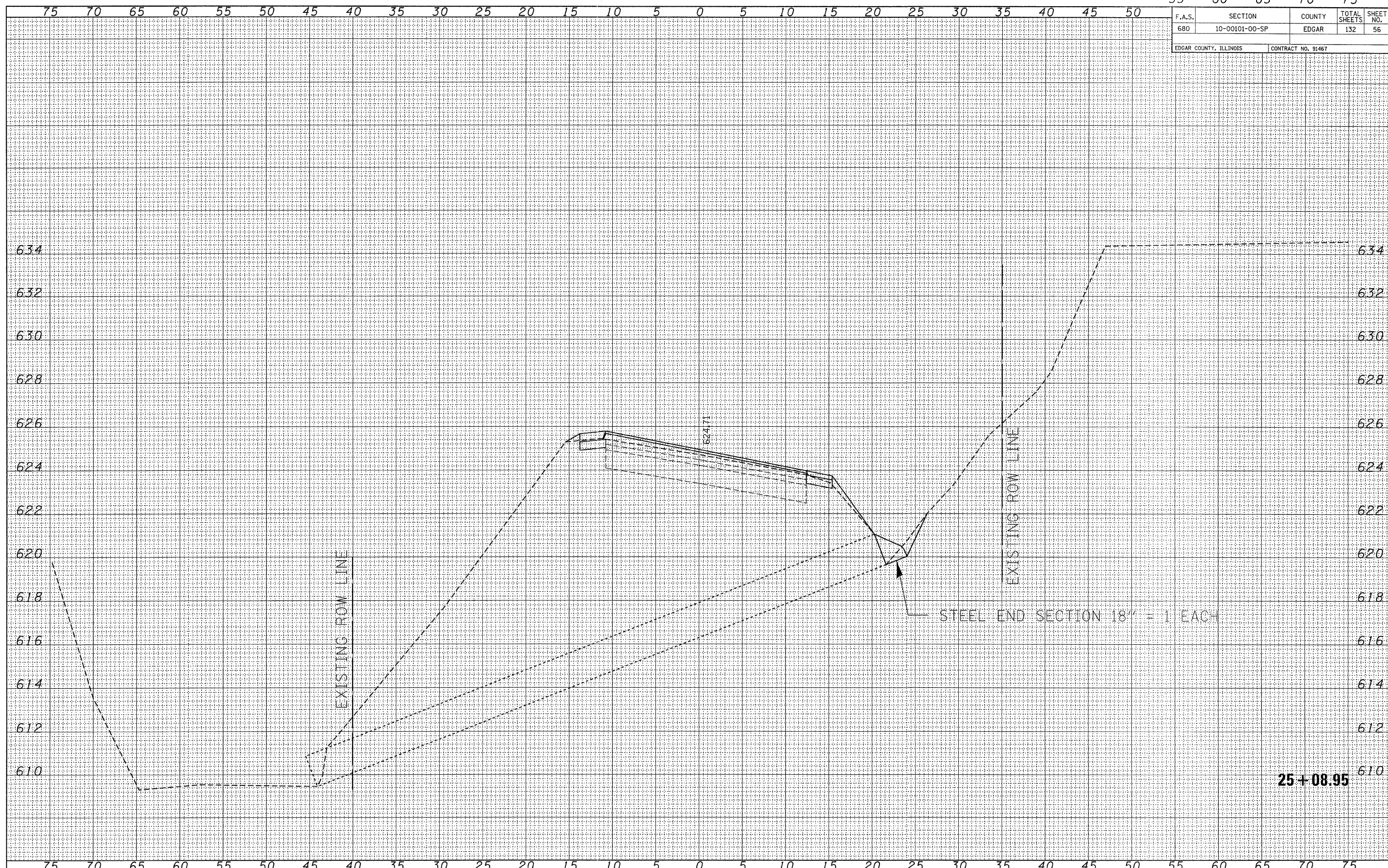

FILE NAME = 118330-shr-axs-oross-road-pipes.dgn
 PLOT DATE = 1/19/2012
 SCALE: 1" = 5' HORZ, 1" = 2' VERT

**EDGAR COUNTY
 HIGHWAY DEPARTMENT**

CULVERT PROFILES