

SECTION 7, T.12N., R.10W., 2nd P.M.

F.A.S.	SECTION	COUNTY	TOTAL SHEETS	SHEET NO.
680	10-00101-00-SP	EDGAR	132	21
EDGAR COUNTY, ILLINOIS		CONTRACT NO. 91467		

EXIST. \odot CURVE DATA
 PI STA. = 72+79.30
 Δ = 22° 05' 24" (LT)
 D = 4° 09' 51"
 R = 1,375.96'
 T = 268.58'
 L = 530.49'
 E = 25.97'
 e = 0.075 FT/FT
 T.R. = 38.30'
 S.E. RUN = 176'
 P.C. STA. = 70+10.72
 P.T. STA. = 75+41.21
S.E. ATTAINED:
 STATION 68+50.03 TO STATION 70+64.32
 STATION 74+87.67 TO STATION 77+01.96

STATE BANK OF CHRISMAN, TRUST NO 507

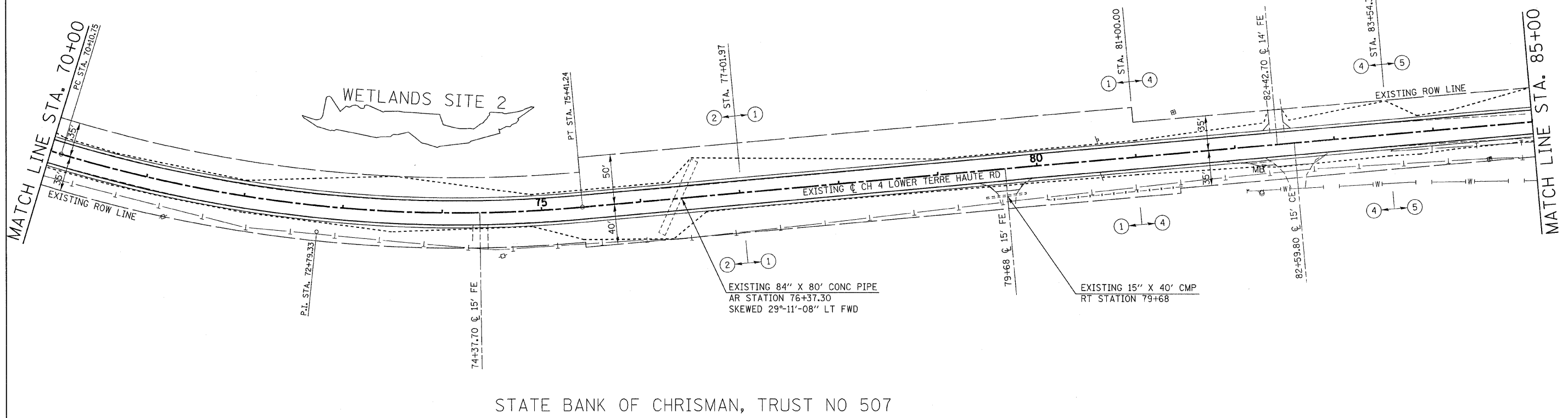
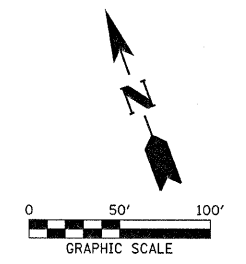

STATE BANK OF CHRISMAN, TRUST NO 507

FILE NAME = 118338-shr-plans.dgn
 PLOT DATE = 1/19/2012
 SCALE: 1" = 50'

**EDGAR COUNTY
 HIGHWAY DEPARTMENT**

SECTION 7, T.12N., R.10W., 2nd P.M.

