

BM 12 - TOP OF 3"± CONCRETE LEDGE ABOVE AND BETWEEN TWO AUTOMATIC SPRINKLER CONNECTIONS AT S.E. CORNER OF VERIZON BUILDING AT 104 MULBERRY AVENUE. ELEV. 787.89 (FARNSWORTH BOOK NO. 2831-10)

THE PROPOSED PARKING LOT PAVEMENT MARKINGS ARE SHOWN FOR INFORMATION ONLY. PROPOSED PAVEMENT MARKINGS WILL BE DONE BY OTHERS.

- LEGEND**
- PROPOSED PCC DRIVEWAY PAVEMENT (8" THICK)
 - PROPOSED HOT-MIX ASPHALT SURFACING (2" THICK, MIN.)
 - PROPOSED UNIT PAVERS (SEE SPECIAL PROVISIONS)
 - PROPOSED TOPSOIL FOR PLANTING BEDS 24" THICK (PLANTS AND MULCH BY OTHERS)

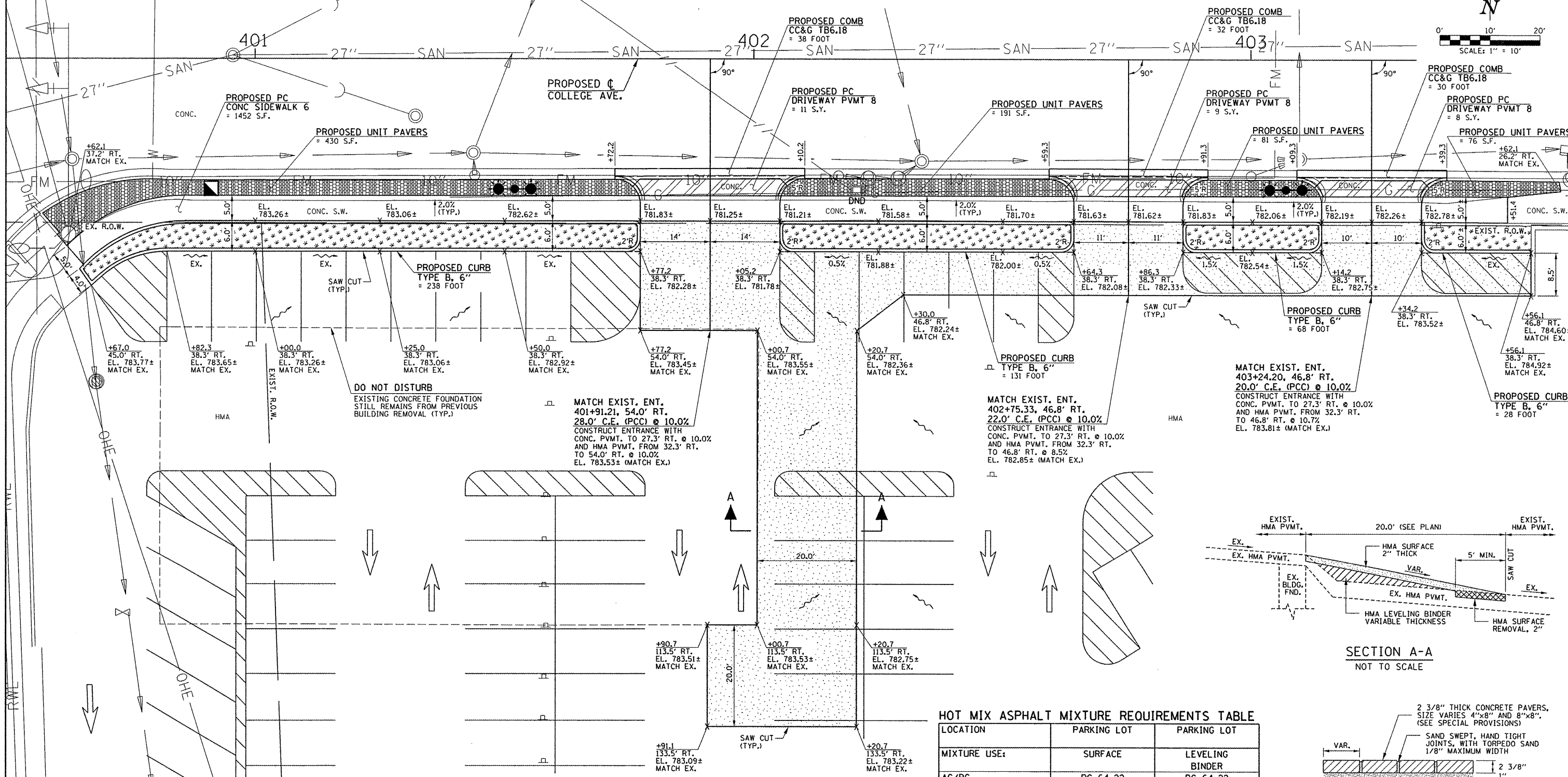
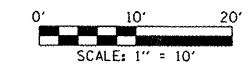

DO NOT DISTURB
EXISTING CONCRETE FOUNDATION STILL REMAINS FROM PREVIOUS BUILDING REMOVAL (TYP.)

MATCH EXIST. ENT.
401+91.21, 54.0' RT.
28.0' C.E. (PCC) @ 10.0%
CONSTRUCT ENTRANCE WITH CONC. PVMT. TO 27.3' RT. @ 10.0% AND HMA PVMT. FROM 32.3' RT. TO 54.0' RT. @ 10.0% EL. 783.53± (MATCH EX.)

MATCH EXIST. ENT.
402+75.33, 46.8' RT.
22.0' C.E. (PCC) @ 10.0%
CONSTRUCT ENTRANCE WITH CONC. PVMT. TO 27.3' RT. @ 10.0% AND HMA PVMT. FROM 32.3' RT. TO 46.8' RT. @ 8.5% EL. 782.85± (MATCH EX.)

MATCH EXIST. ENT.
403+24.20, 46.8' RT.
20.0' C.E. (PCC) @ 10.0%
CONSTRUCT ENTRANCE WITH CONC. PVMT. TO 27.3' RT. @ 10.0% AND HMA PVMT. FROM 32.3' RT. TO 46.8' RT. @ 10.7% EL. 783.81± (MATCH EX.)

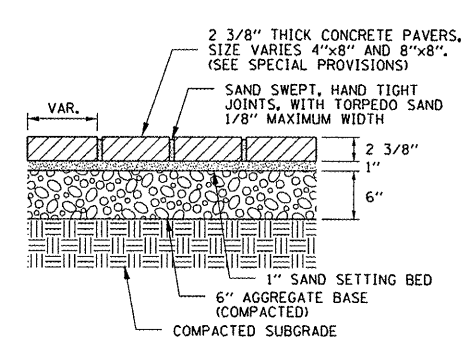
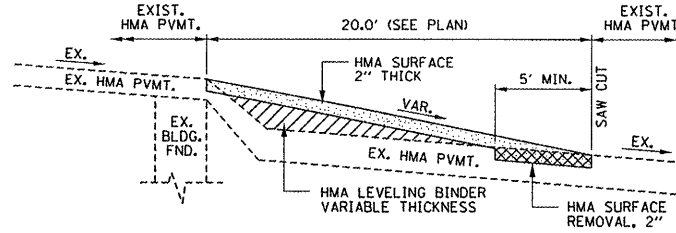

PAVING REMOVAL SCHEDULE

LOCATION	44000100 PAVEMENT REM (SQ YD)	44000200 DRIVEWAY PAVEMENT REM (SQ YD)	44000500 COMB. CURB AND GUTTER REM (FOOT)	44000600 SIDEWALK REM (SQ FT)
PARKING LOT (PLANTING BED AREAS)	145			1178
400+62.1 RT. TO 403+51.4 RT.				
401+91.2 RT. - COMMERCIAL ENTRANCE		13	38	
402+75.3 RT. - COMMERCIAL ENTRANCE		11	32	
403+24.2 RT. - COMMERCIAL ENTRANCE		10	30	
SHEET TOTAL	145	34	100	1178

PROPOSED PARKING LOT PLAN
COLLEGE & CONSTITUTION - EAST LOT

THE EXISTING HMA PAVEMENT THICKNESS VARIES WITHIN THE LIMITS OF CONSTRUCTION AND ACTUAL THICKNESS IS UNKNOWN. IF THE EXISTING BASE IS ENCOUNTERED DURING CONSTRUCTION, THE CONTRACTOR SHALL BE RESPONSIBLE FOR PREPARING THE BASE TO THE SATISFACTION OF THE ENGINEER. ANY PREPARATION OF BASE SHALL BE INCLUDED IN THE VARIOUS CONTRACT ITEMS OF WORK AND WILL NOT BE MEASURED FOR PAYMENT.

HOT MIX ASPHALT MIXTURE REQUIREMENTS TABLE

LOCATION	PARKING LOT	PARKING LOT
MIXTURE USE:	SURFACE	LEVELING BINDER
AC/PG	PG 64-22	PG 64-22
RAP % (MAX)	10	15
DESIGN AIR VOIDS	4.0% @ NDES = 70	4.0% @ NDES = 70
MIXTURE COMPOSITION (GRADATION)	IL 9.5	IL 9.5
FRICTION AGGREGATE	MIXTURE C	N/A

THE CONTRACTOR SHALL MILL THE EXISTING HMA PAVEMENT AS NEEDED FOR THE PROPOSED SLOPE CORRECTIONS AND AS DIRECTED BY THE ENGINEER. THE CONTRACTOR SHALL PROVIDE A SMOOTH TRANSITION BETWEEN EXISTING AND PROPOSED HMA SURFACES BY MEANS OF SAW CUTTING AND BUTT JOINTS WITH A 2" MINIMUM THICKNESS. THIS WORK SHALL BE PAID FOR AT THE CONTRACT UNIT PRICE PER SQUARE YARDS OF HOT-MIX ASPHALT SURFACE REMOVAL, VARIABLE DEPTH. SEE PLANS AND SPECIAL PROVISIONS.

FILE NAME = p:\02400941\...Plans\sheet\ 6-parkinglots.dgn
PLOT DATE = 1/18/2012 7:35:35 PM

DESIGNED - K.L.R.
DRAWN - K.L.R.
CHECKED - S.M.W.
DATE - 1-12

STATE OF ILLINOIS
DEPARTMENT OF TRANSPORTATION

PARKING LOT PLAN
SCALE: 1"=10' SHEET NO. 14 OF 14 SHEETS STA. TO STA.

F.A.U. RTE.	SECTION	COUNTY	TOTAL SHEETS	SHEET NO.
	10-00242-00-LT	MCLEAN	14	14
CONTRACT NO. 91460				
FED. ROAD DIST. NO. ILLINOIS FED. AID PROJECT				