

PAINT PAVEMENT MARKING LINE, 4" (DEEMACK ROAD AND COOPER ROAD)			
	SOLID YELLOW	YELLOW DASH	SOLID WHITE
STA. 192+09 TO STA. 200+00	1216'	92'	1742'
STA. 200+00 TO STA. 208+11	1025'	128'	1783'
SUB-TOTALS:	2241'	220'	3525'
TOTAL:	5986'		

PAINT PAVEMENT MARKING LINE, 12" (COOPER ROAD)	
	SOLID WHITE
STA. 99+62	10'
STA. 100+38	10'
TOTAL:	20'

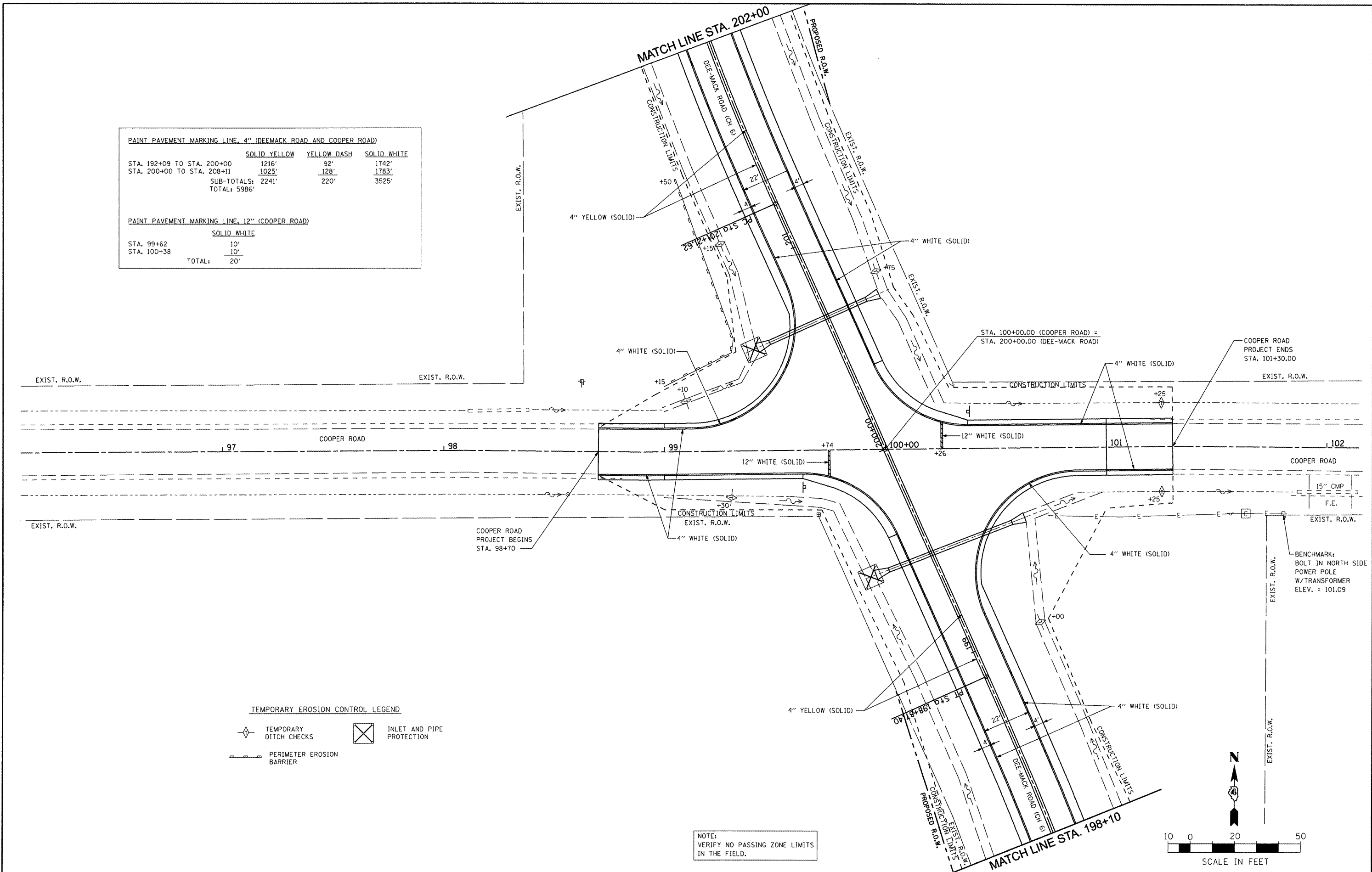

TEMPORARY EROSION CONTROL LEGEND

	TEMPORARY DITCH CHECKS		INLET AND PIPE PROTECTION
	PERIMETER EROSION BARRIER		

NOTE:
VERIFY NO PASSING ZONE LIMITS
IN THE FIELD.

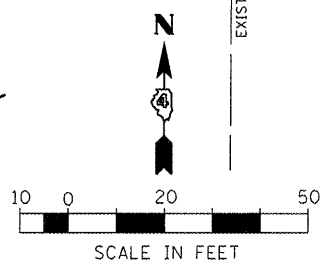

FILE NAME = X:\PROJECTS\200705506\DWG\DEEMACK-COOPER\PLANS-REFS\PAVT MRKNG-EROS CNTRL 01.DWG	USER NAME =	DESIGNED - REW	REVISED -	STATE OF ILLINOIS DEPARTMENT OF TRANSPORTATION	TAZEWELL COUNTY - DEE-MACK ROAD AND COOPER ROAD INTERSECTION IMPROVEMENTS PAVEMENT MARKING AND EROSION CONTROL PLAN		F.A.S. RTE. 470	SECTION 10-00076-00 RS	COUNTY TAZEWELL	TOTAL SHEETS 38	SHEET NO. 11	
	PLOT SCALE =	DRAWN - KRS, DLC	REVISED -		SCALE:	SHEET NO. OF SHEETS	STA. TO STA.	ILLINOIS FED. AID PROJECT				
	PLOT DATE = 2/24/2012	CHECKED - KMC	REVISED -									
		DATE -	REVISED -									