

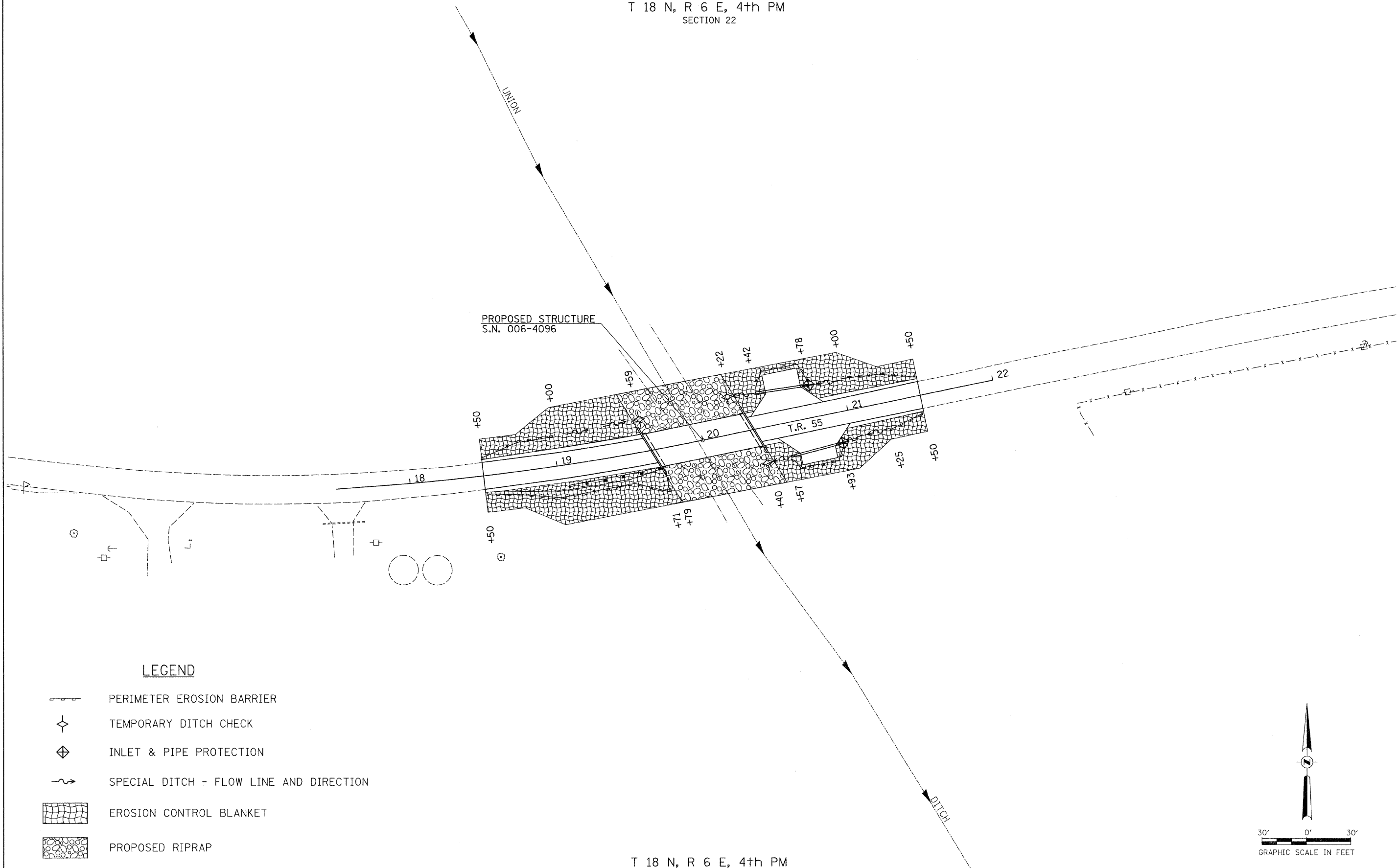

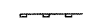

T 18 N, R 6 E, 4th PM
SECTION 22

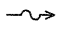

LEGEND

-  PERIMETER EROSION BARRIER
-  TEMPORARY DITCH CHECK
-  INLET & PIPE PROTECTION
-  SPECIAL DITCH - FLOW LINE AND DIRECTION
-  EROSION CONTROL BLANKET
-  PROPOSED RIPRAP

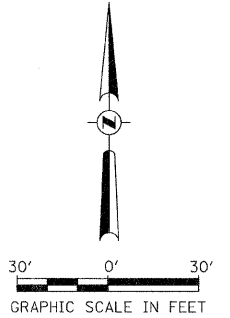

T 18 N, R 6 E, 4th PM
SECTION 22

FILE NAME = V:\Bridg\2984 - Bureau\2984S001.dgn	USER NAME = cthomas	DESIGNED -	REVISED -	BUREAU COUNTY TOWNSHIP ROAD 55 OVER UNION DITCH	EROSION CONTROL PLAN			RTE.	SECTION	COUNTY	TOTAL SHEETS	SHEET NO.	
		DRAWN -	REVISED -		TR 55	11-07119-00-BR	BUREAU	21	5				
		CHECKED -	REVISED -		SCALE: 1" = 30'			SHEET NO. 1 OF 1 SHEETS		STA. 18+50.00	TO STA. 21+50.00	CONTRACT NO. 87499	
		DATE -	REVISED -		FED. ROAD DIST. NO. 7 ILLINOIS FED. AID PROJECT BROS-00110837								