

PROFILE FOR SIDEWALK ON LEFT SIDE OF ROAD

F.A. RTE.	SECTION	COUNTY	TOTAL SHEETS	SHEET NO.
SRTS - 4009(054)	10-00007-00-SW	OGLE	15	6
		ILLINOIS	CONTRACT NO. 85541	

SCALE:  
1" = 20'-0" Horizontal  
1" = 5'-0" Vertical

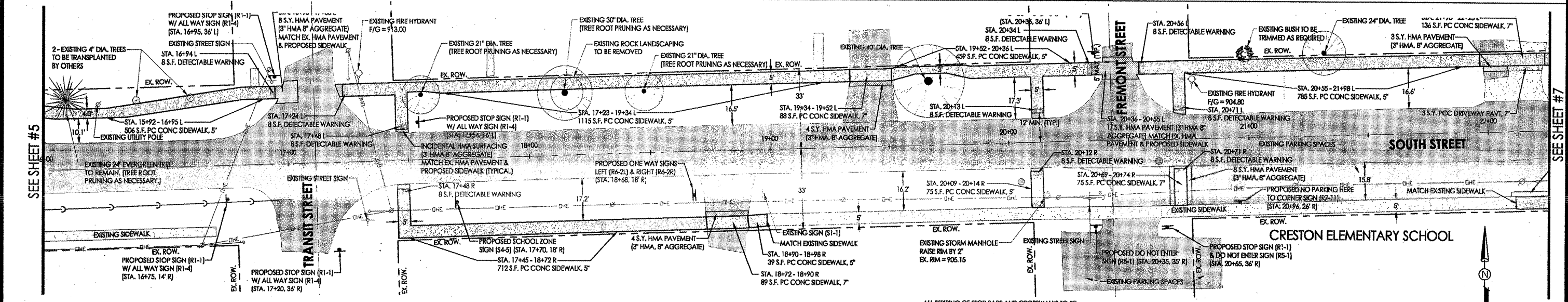
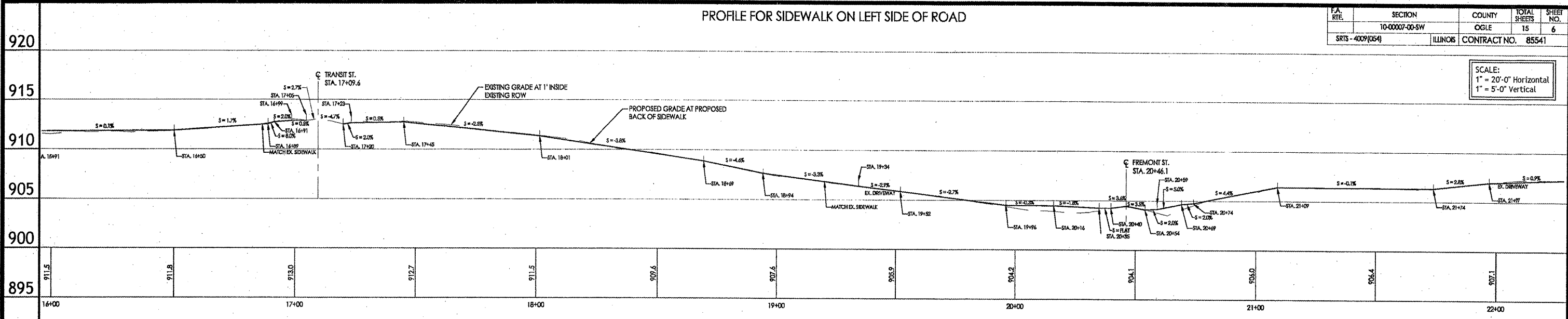

	EXISTING CONCRETE SIDEWALK		EXISTING CONCRETE DRIVEWAY		EXISTING ASPHALT PAVEMENT		EXISTING AGGREGATE DRIVEWAY
	PROPOSED CONCRETE SIDEWALK		PROPOSED CONCRETE DRIVEWAY		PROPOSED HMA PAVEMENT		PROPOSED AGGREGATE DRIVEWAY

ALL STRIPING OF STOP BARS AND CROSSWALKS TO BE DONE BY VILLAGE UNDER A SEPARATE CONTRACT  
 VILLAGE TO NOTIFY OWNERS OF TREES TO BE REMOVED OR TRIMMED. ALL TREES DESIGNATED TO BE REMOVED ARE WITHIN THE VILLAGE ROW.  
 USE STAINLESS STEEL DETECTABLE WARNING (2' X 4' PANEL TO ALLOW FOR A 6" FINISHED EDGE AROUND THE PLATE TO LOCK THE PLATE IN PLACE)  
 ALL SIGNS TO BE SIGN PANEL - TYPE 1 ON TELESCOPING STEEL SIGN SUPPORT.

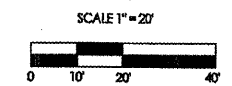

PROFILE FOR SIDEWALK ON RIGHT SIDE OF ROAD

SCALE:  
1" = 20'-0" Horizontal  
1" = 5'-0" Vertical

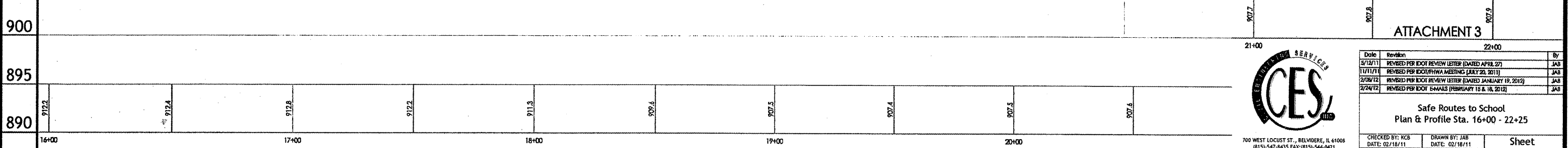
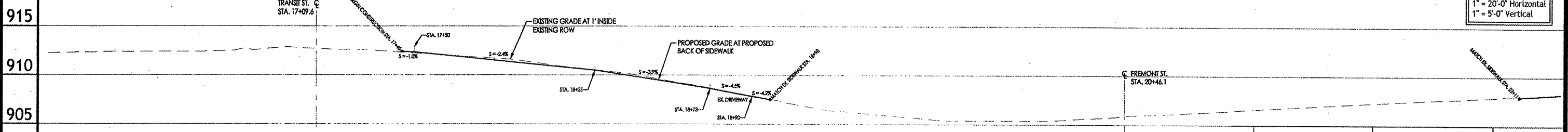

Date	Revision	By
5/12/11	REVISED PER IDOT REVIEW LETTER (DATED APRIL 22)	JAS
11/11/11	REVISED PER IDOT/PHVA MEETING (JULY 20, 2011)	JAS
2/26/12	REVISED PER IDOT REVIEW LETTER (DATED JANUARY 19, 2012)	JAS
2/24/12	REVISED PER IDOT E-MAILS (FEBRUARY 15 & 16, 2012)	JAS

Safe Routes to School  
 Plan & Profile Sta. 16+00 - 22+25  
 Checked by: KCB DATE: 02/18/11  
 Drawn by: JAS DATE: 02/18/11  
 3000\_BASE.dwg  
 Sheet 6 of 15