

PLAN

MINIMUM BAR LAP
#5 bar = 2'-7"

Notes:
See Sheet 10 of 20 for superstructure details, parapet reinforcement, bar details and Bill of Material.
Bars indicated thus 32 x 3-#5 etc. indicates 32 lines of bars with 3 lengths per line.
See Sheet 11 of 20 for Section A-A and diaphragm details.
See Sheet 19 of 20 for Bar Splicer Assembly Details.

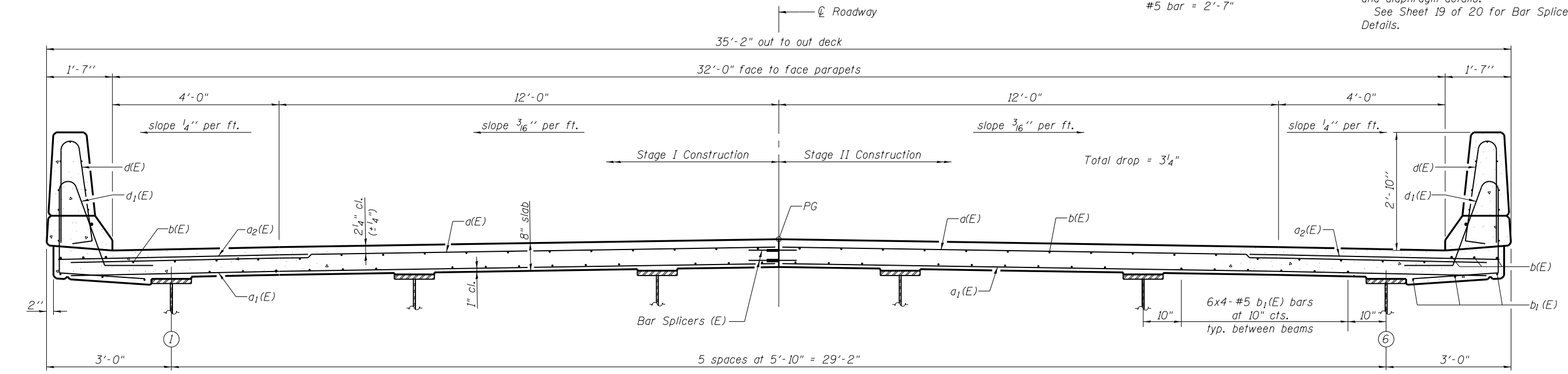

CROSS SECTION
(Looking South)

CB Coombe-Bloxdorf P.C.
- CIVIL ENGINEERS -
- STRUCTURAL ENGINEERS -
- LAND SURVEYORS -
Design Firm License No. 184-002703

FILE NAME =	USER NAME = \$USER\$	DESIGNED - CME	REVISED -
et:\pw\work\p1dot\lavenderba\d0293530\0760030-78165-009-superstructure.dgn		CHECKED - MCB	REVISED -
	PLOT SCALE = 0:2.000002 '1' / in.	DRAWN - CFC/MML	REVISED -
CB PROJECT NO 08056-14	PLOT DATE = 1/23/2012	CHECKED - CME	REVISED -

STATE OF ILLINOIS
DEPARTMENT OF TRANSPORTATION

SUPERSTRUCTURE
STRUCTURE NO. 076-0030

SHEET NO. 9 OF 20 SHEETS

F.A.P. R.T.E.	SECTION	COUNTY	TOTAL SHEETS	SHEET NO.
885	6B-3	POPE	41	30
CONTRACT NO. 78165				

ILLINOIS FED. AID PROJECT