

THOUGH EXISTING SEWERS ARE SHOWN, NO OTHER EXISTING UTILITIES ARE PROVIDED ON THE CROSS SECTIONS. PROPOSED SEWERS ARE BASED ON THE PROPOSED DRAINAGE DESIGN SHOWN WITHIN THESE PLANS. THE CONTRACTOR IS RESPONSIBLE FOR IDENTIFYING ALL EXISTING UTILITIES PRIOR TO CONSTRUCTION. THE CONTRACTOR SHALL REFER TO S.U.E. PLANS FOR EXISTING UTILITY INFORMATION.

BY	DATE
SURVEYED	
PLOTTED	
DATE	
AREAS	
CHECKED	
NO.	

BY	DATE
ORIGINAL SURVEY	
PLOTTED	
DATE	
AREAS	
CHECKED	
NO.	

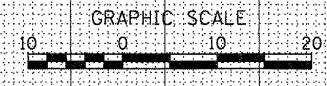
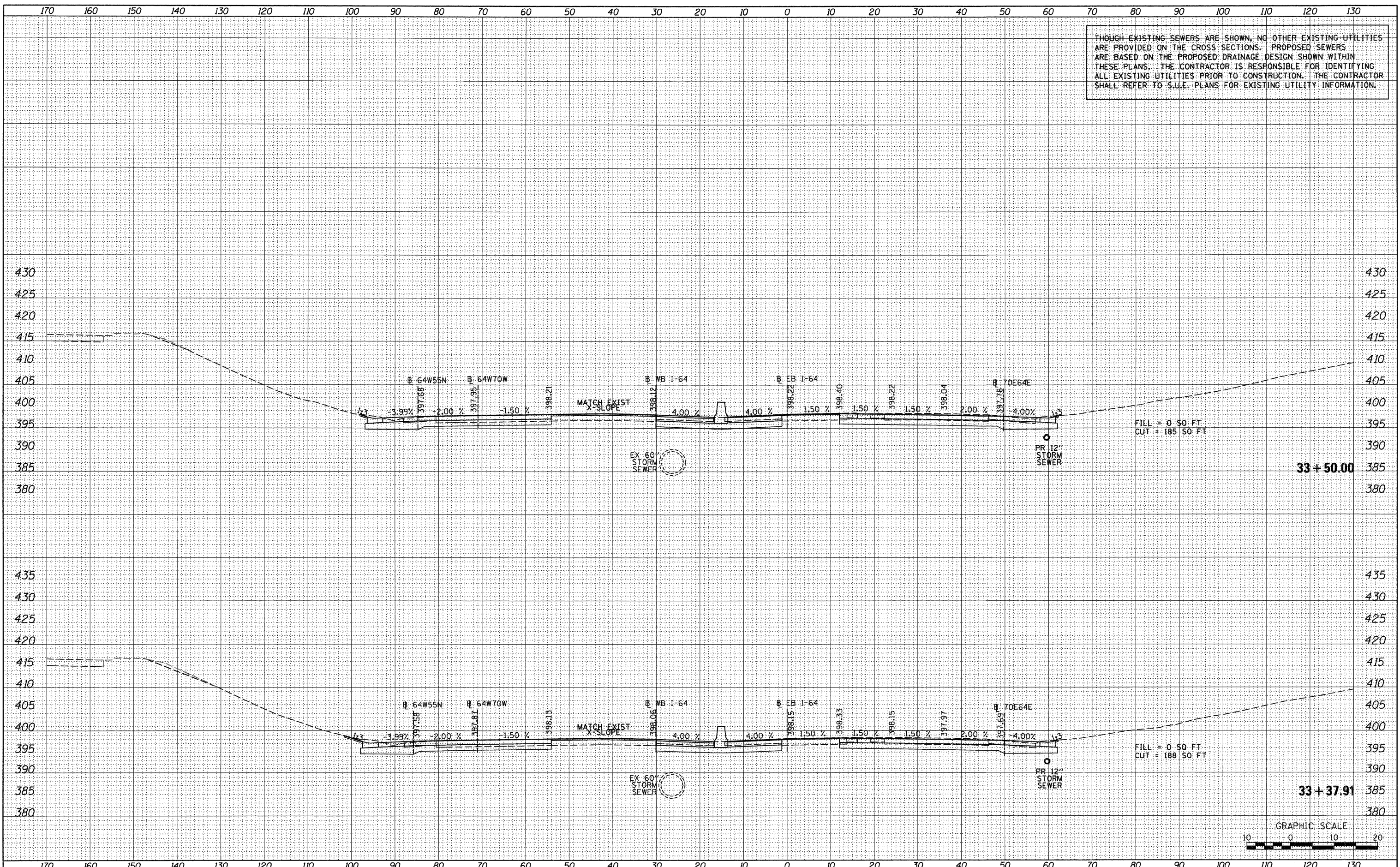

FILE NAME =	USER NAME = s00r0b	DESIGNED - SDH	REVISED -	<b>STATE OF ILLINOIS</b> <b>DEPARTMENT OF TRANSPORTATION</b>	<b>CROSS SECTIONS - I-64</b>				F.A. RTE.	SECTION	COUNTY	TOTAL SHEETS	SHEET NO.	
#FILEL*		DRAWN - SDH	REVISED -						64/998	82-1-RIA)	ST. CLAIR	629	598	
	PLOT SCALE = 20.0000' / in.	CHECKED - DBM	REVISED -		SCALE: 1" = 10'				SHEET NO. 3 OF 25 SHEETS		STA. 33+37.91 TO STA. 33+50.00		CONTRACT NO. 76C52	
	PLOT DATE = 1/24/2012	DATE - 1-20-12	REVISED -		ILLINOIS FED. AID PROJECT									