

DATE _____
 BY _____
 SURVEYED _____
 PLOTTED _____
 FINISH DATE _____
 NOTE BOOK _____
 AREAS CHECKED _____
 NO. _____

DATE _____
 BY _____
 SURVEYED _____
 PLOTTED _____
 FINISH DATE _____
 NOTE BOOK _____
 AREAS CHECKED _____
 NO. _____

ALTHOUGH EXISTING SEWERS ARE SHOWN, NO OTHER EXISTING UTILITIES ARE PROVIDED ON THE CROSS SECTIONS. PROPOSED SEWERS ARE BASED ON THE PROPOSED DRAINAGE DESIGN SHOWN WITHIN THESE PLANS. THE CONTRACTOR IS RESPONSIBLE FOR IDENTIFYING ALL EXISTING UTILITIES PRIOR TO CONSTRUCTION. THE CONTRACTOR SHALL REFER TO S.U.E. PLANS FOR EXISTING UTILITY INFORMATION.

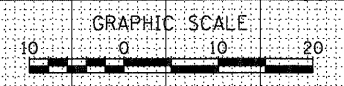
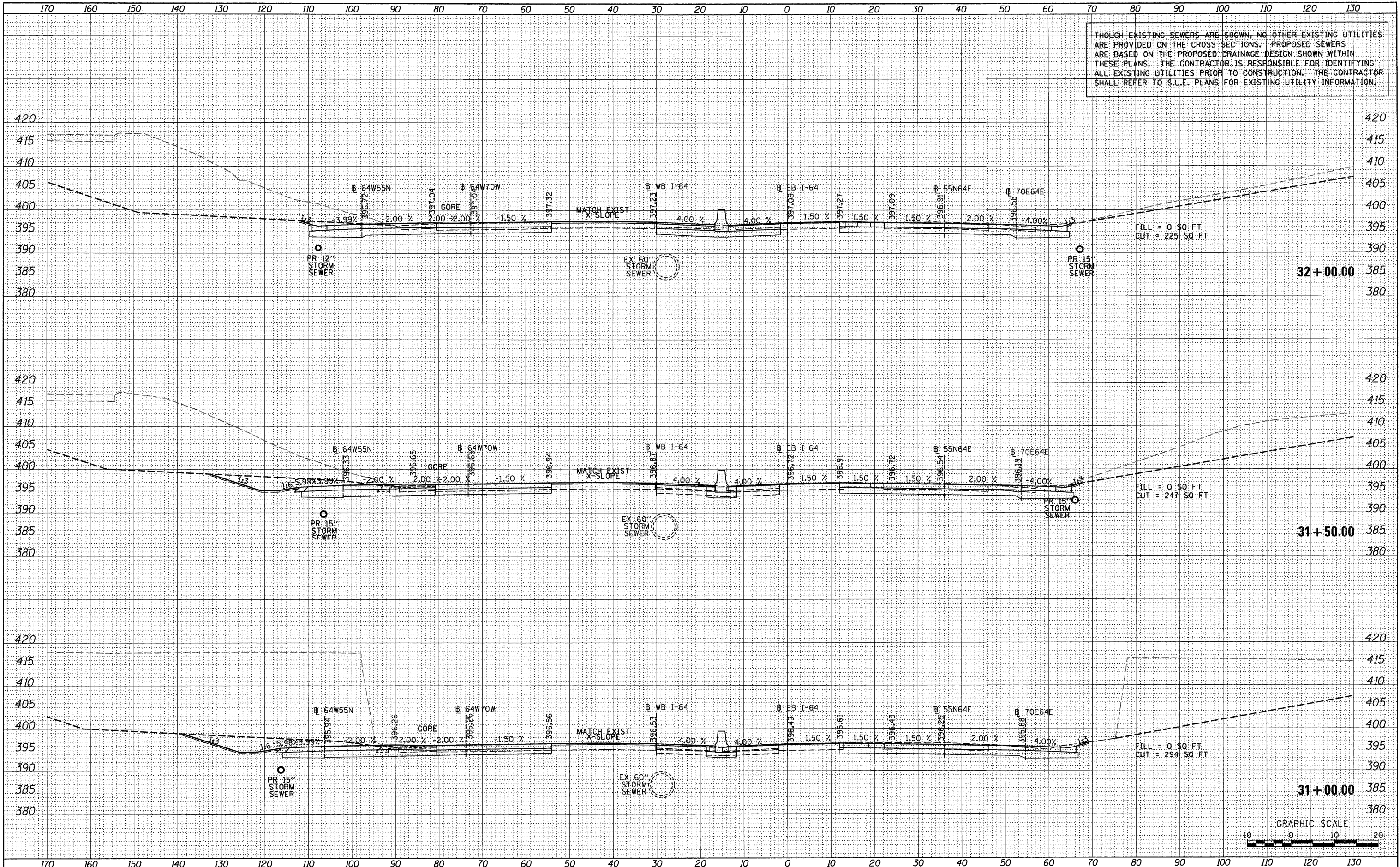

FILE NAME = #FILE#	USER NAME = searsh	DESIGNED - SDH	REVISED -	STATE OF ILLINOIS DEPARTMENT OF TRANSPORTATION	CROSS SECTIONS - I-64				F.A. RTE. 64/998	SECTION 82-1-RIA)	COUNTY ST. CLAIR	TOTAL SHEETS 629	SHEET NO. 596
	PLT SCALE = 20.0000' / in.	CHECKED - DBM	REVISED -		SCALE: 1" = 10'	SHEET NO. 1 OF 25 SHEETS	STA. 31+00.00	TO STA. 32+00.00	CONTRACT NO. 76C52				
	PLT DATE = 1/24/2012	DATE - 1-20-12	REVISED -		ILLINOIS FED. AID PROJECT								