

THOUGH EXISTING SEWERS ARE SHOWN, NO OTHER EXISTING UTILITIES ARE PROVIDED ON THE CROSS SECTIONS. PROPOSED SEWERS ARE BASED ON THE PROPOSED DRAINAGE DESIGN SHOWN WITHIN THESE PLANS. THE CONTRACTOR IS RESPONSIBLE FOR IDENTIFYING ALL EXISTING UTILITIES PRIOR TO CONSTRUCTION. THE CONTRACTOR SHALL REFER TO S.U.E. PLANS FOR EXISTING UTILITY INFORMATION.

FINAL SURVEY	BY	DATE
SURVEYED		
PLOTTED		
NOTE BOOK		
AREAS		
AREAS CHECKED		
NO.		

ORIGINAL SURVEY	BY	DATE
SURVEYED		
PLOTTED		
NOTE BOOK		
AREAS		
AREAS CHECKED		
NO.		

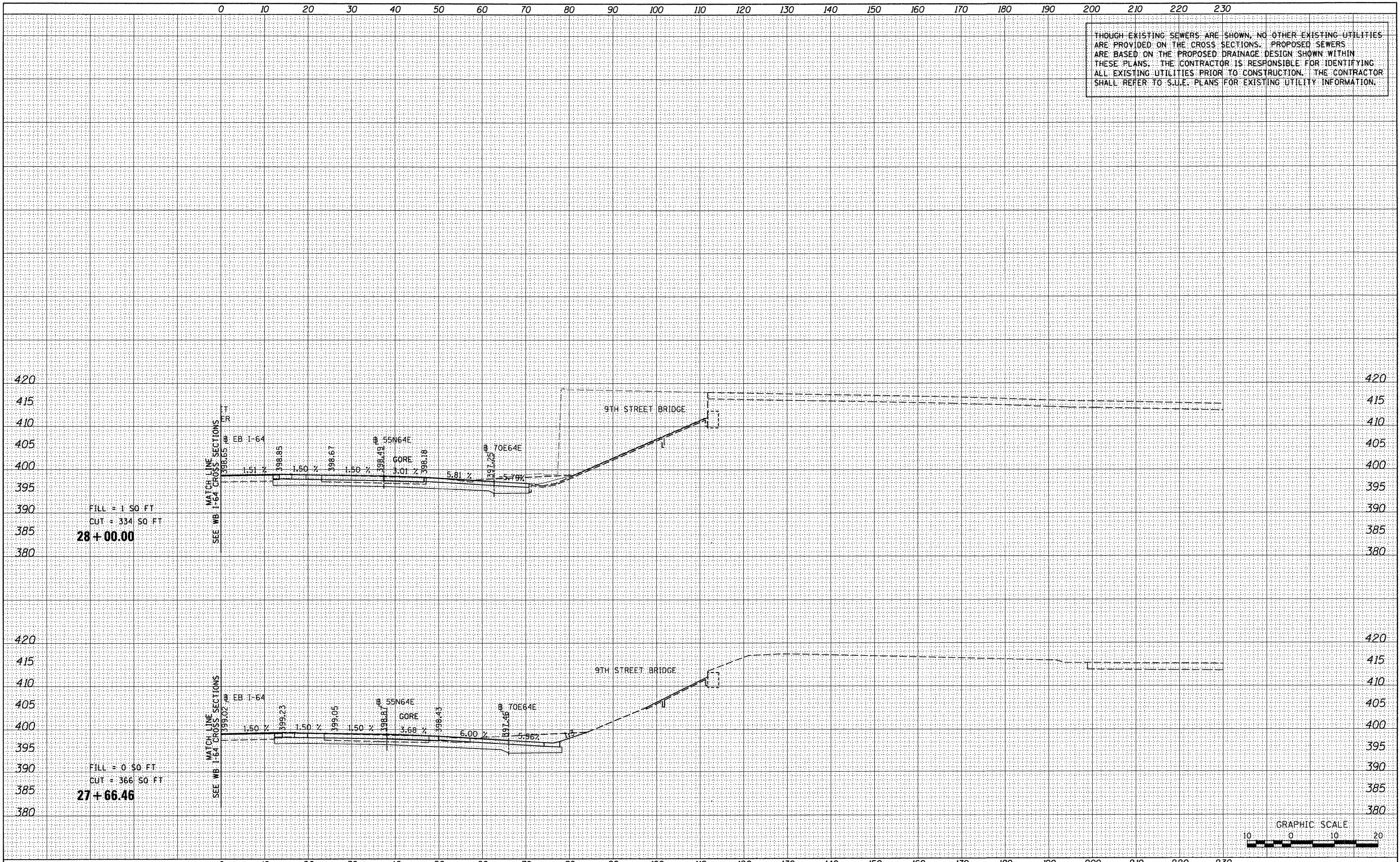

FILL = 1.50 FT
CUT = 334.50 FT
28 + 00.00

FILL = 0.50 FT
CUT = 366.50 FT
27 + 66.46

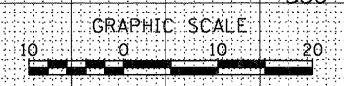

FILE NAME =	USER NAME = sear:sb	DESIGNED - SDH	REVISED -	STATE OF ILLINOIS DEPARTMENT OF TRANSPORTATION	CROSS SECTIONS - EB I-64			F.A. RTE. 64/998	SECTION 82-1-RIA)	COUNTY ST. CLAIR	TOTAL SHEETS 629	SHEET NO. 592
#FILE#		DRAWN - SDH	REVISED -		SCALE: 1" = 10'	SHEET NO. 2 OF 35 SHEETS	STA. 27+66.46 TO STA. 28+00.00	CONTRACT NO. 76C52				
		CHECKED - DBM	REVISED -		ILLINOIS FED. AID PROJECT							
		DATE - 1-20-12	REVISED -									