

THOUGH EXISTING SEWERS ARE SHOWN, NO OTHER EXISTING UTILITIES ARE PROVIDED ON THE CROSS SECTIONS. PROPOSED SEWERS ARE BASED ON THE PROPOSED DRAINAGE DESIGN SHOWN WITHIN THESE PLANS. THE CONTRACTOR IS RESPONSIBLE FOR IDENTIFYING ALL EXISTING UTILITIES PRIOR TO CONSTRUCTION. THE CONTRACTOR SHALL REFER TO S.U.E. PLANS FOR EXISTING UTILITY INFORMATION.

DATE	
BY	
FINAL SURVEY	
SURVEYED	
PLOTTED	
NOTE BOOK	
NO.	
AREAS CHECKED	

DATE	
BY	
ORIGINAL SURVEY	
SURVEYED	
PLOTTED	
NOTE BOOK	
NO.	
AREAS CHECKED	

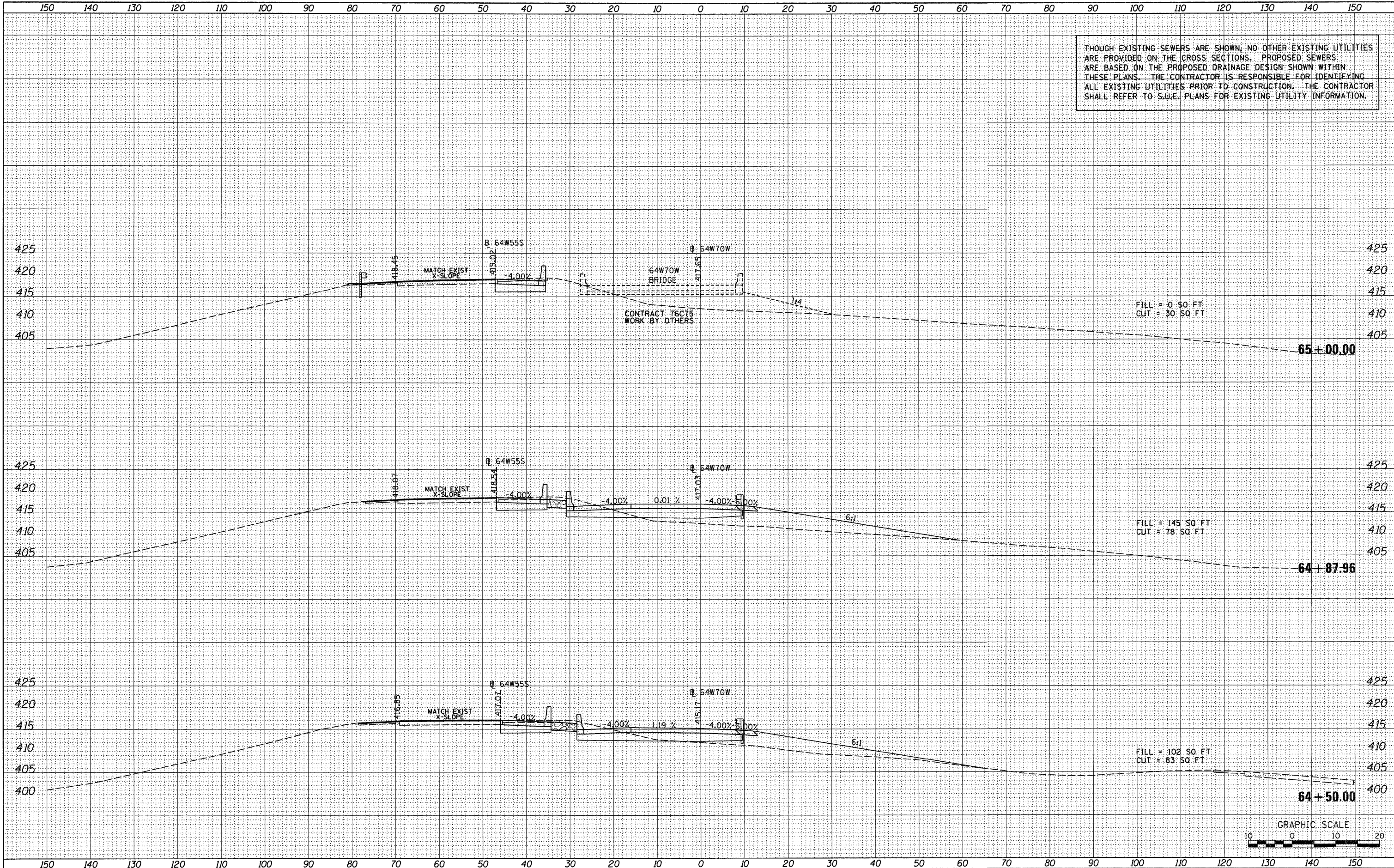

FILE NAME =	USER NAME = sear-sb	DESIGNED - SDH	REVISED -	STATE OF ILLINOIS DEPARTMENT OF TRANSPORTATION	CROSS SECTIONS - RAMP 64W70W			F.A. RTE. 64/998	SECTION 82-1-RIA)	COUNTY ST. CLAIR	TOTAL SHEETS 629	SHEET NO. 584
FILEL		DRAWN - SDH	REVISED -		SCALE: 1" = 10'	SHEET NO. 3 OF 4 SHEETS	STA. 64+50.00 TO STA. 65+00.00	CONTRACT NO. 76C52		ILLINOIS FED. AID PROJECT		
		CHECKED - DBM	REVISED -									
		PLLOT DATE = 1/24/2012	DATE - 1-20-12									