

THOUGH EXISTING SEWERS ARE SHOWN, NO OTHER EXISTING UTILITIES ARE PROVIDED ON THE CROSS SECTIONS. PROPOSED SEWERS ARE BASED ON THE PROPOSED DRAINAGE DESIGN SHOWN WITHIN THESE PLANS. THE CONTRACTOR IS RESPONSIBLE FOR IDENTIFYING ALL EXISTING UTILITIES PRIOR TO CONSTRUCTION. THE CONTRACTOR SHALL REFER TO S.U.E. PLANS FOR EXISTING UTILITY INFORMATION.

DATE	
BY	
SURVEYED	
PLOTTED	
TEMPLATE	
NOTE BOOK	
AREAS CHECKED	
NO.	

DATE	
BY	
SURVEYED	
PLOTTED	
TEMPLATE	
NOTE BOOK	
AREAS CHECKED	
NO.	

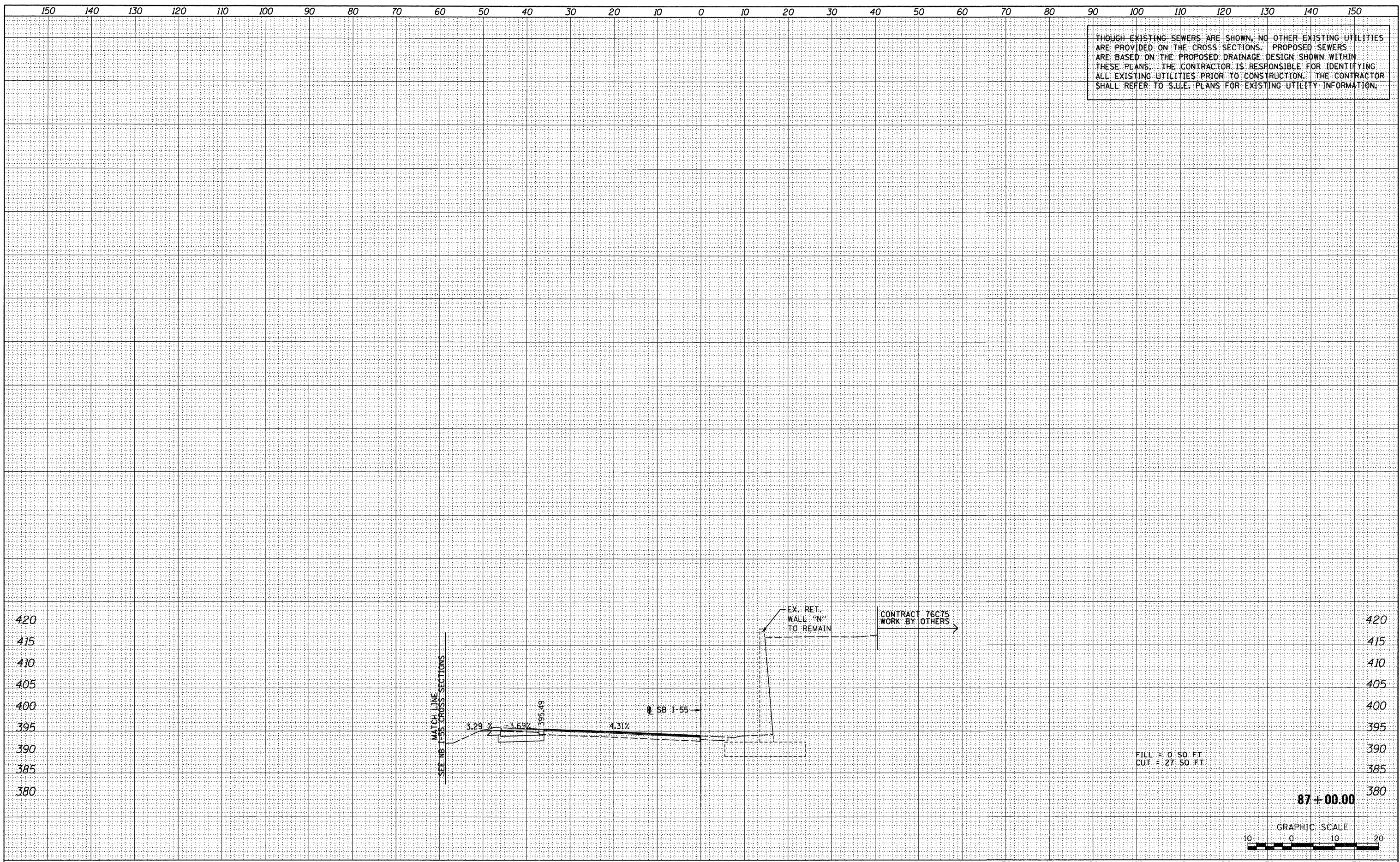

FILL = 0 SO. FT.
CUT = 27 SO. FT.

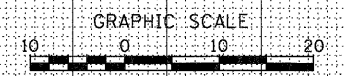

87+00.00

FILE NAME =	USER NAME = searab	DESIGNED - KM	REVISED -	STATE OF ILLINOIS DEPARTMENT OF TRANSPORTATION	CROSS SECTIONS - SB I-55		F.A. RTE.	SECTION	COUNTY	TOTAL SHEETS	SHEET NO.	
*FILE#		DRAWN - KM	REVISED -		SCALE: 1" = 10'	SHEET NO. 4 OF 4 SHEETS	STA. 87+00.00 TO STA. 87+00.00	64/998	82-1-RIA)	ST. CLAIR	629	556
		CHECKED - DBM	REVISED -								CONTRACT NO. 76C52	
		PLLOT SCALE = 20.0000' / in.	REVISED -								ILLINOIS FED. AID PROJECT	
		PLLOT DATE = 1/24/2012	DATE - 1-20-12	REVISED -								