

THOUGH EXISTING SEWERS ARE SHOWN, NO OTHER EXISTING UTILITIES ARE PROVIDED ON THE CROSS SECTIONS. PROPOSED SEWERS ARE BASED ON THE PROPOSED DRAINAGE DESIGN SHOWN WITHIN THESE PLANS. THE CONTRACTOR IS RESPONSIBLE FOR IDENTIFYING ALL EXISTING UTILITIES PRIOR TO CONSTRUCTION. THE CONTRACTOR SHALL REFER TO S.U.E. PLANS FOR EXISTING UTILITY INFORMATION.

DATE	
BY	
FINAL SURVEY	
PLOTTED	
NOTE BOOK	
NO.	
AREAS CHECKED	

DATE	
BY	
ORIGINAL SURVEY	
PLOTTED	
NOTE BOOK	
NO.	
AREAS CHECKED	

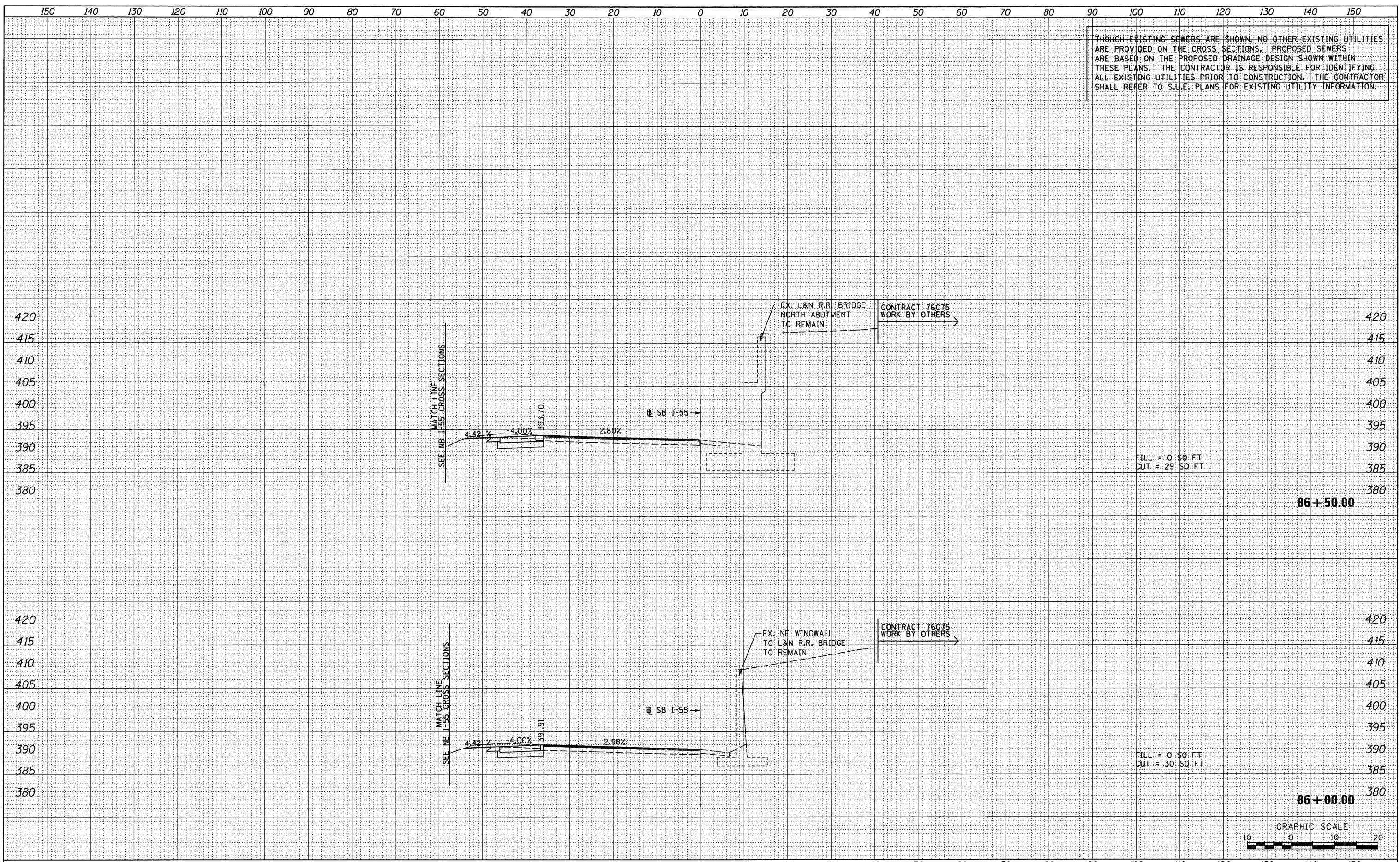

FILE NAME =	USER NAME = searab	DESIGNED - KM	REVISED -	STATE OF ILLINOIS DEPARTMENT OF TRANSPORTATION	CROSS SECTIONS - SB I-55		F.A. RTE. 64/998	SECTION 82-1-RIA)	COUNTY ST. CLAIR	TOTAL SHEETS 629	SHEET NO. 555	
#FILE#		DRAWN - KM	REVISED -		SCALE: 1" = 10'	SHEET NO. 3 OF 4 SHEETS	STA. 86+00.00 TO STA. 86+50.00	CONTRACT NO. 76C52				
		CHECKED - DBM	REVISED -		ILLINOIS FED. AID PROJECT							
		DATE - 1-20-12	REVISED -									