

ALTHOUGH EXISTING SEWERS ARE SHOWN, NO OTHER EXISTING UTILITIES ARE PROVIDED ON THE CROSS SECTIONS. PROPOSED SEWERS ARE BASED ON THE PROPOSED DRAINAGE DESIGN SHOWN WITHIN THESE PLANS. THE CONTRACTOR IS RESPONSIBLE FOR IDENTIFYING ALL EXISTING UTILITIES PRIOR TO CONSTRUCTION. THE CONTRACTOR SHALL REFER TO S.U.E. PLANS FOR EXISTING UTILITY INFORMATION.

BY	DATE
SURVEYED	
PLOTTED	
NOTE BOOK	
AREAS	
CHECKED	
NO.	

BY	DATE
ORIGINAL SURVEY	
PLOTTED	
NOTE BOOK	
AREAS	
CHECKED	
NO.	

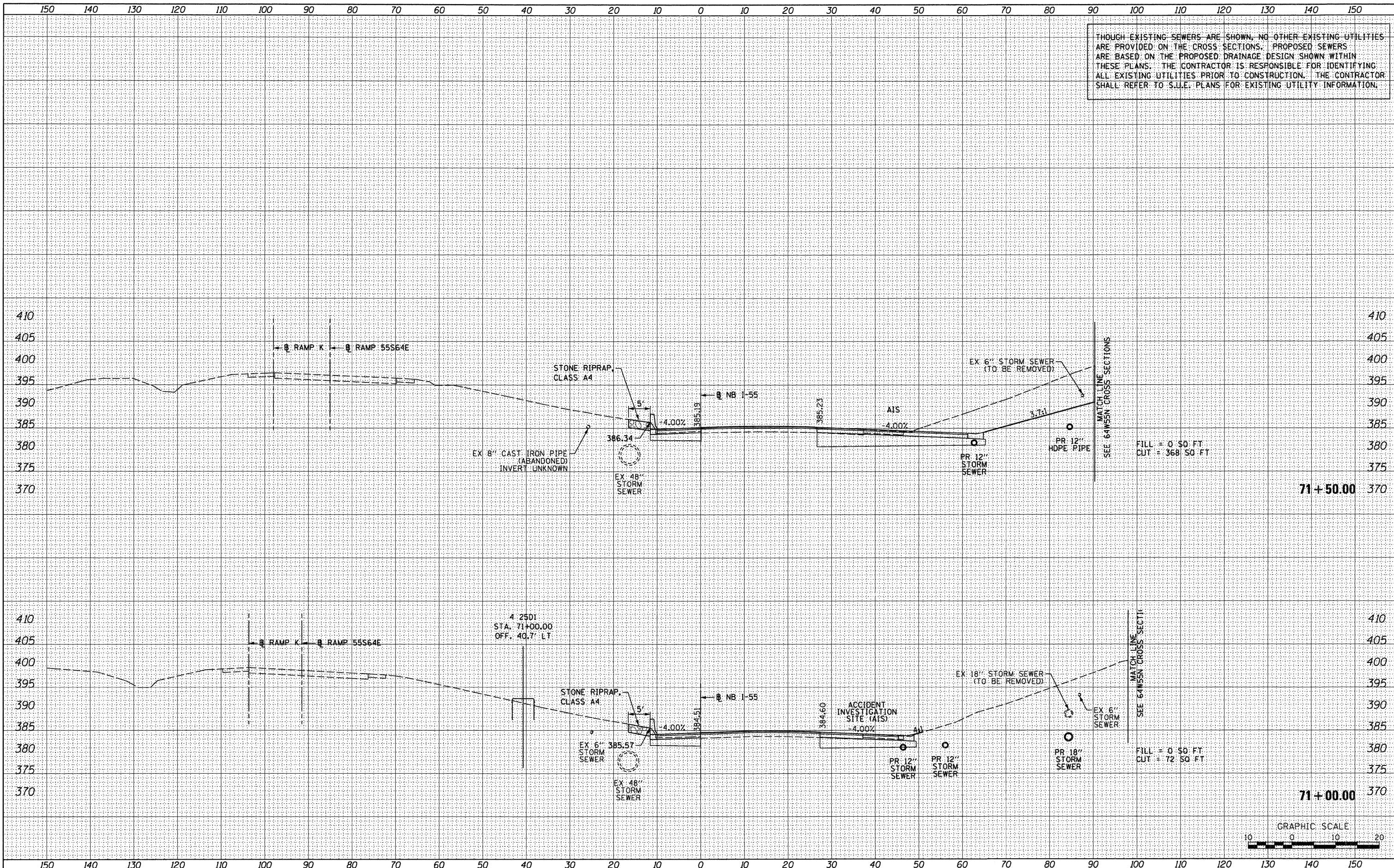

FILE NAME =	USER NAME = searsb	DESIGNED - KM	REVISED -	<b>STATE OF ILLINOIS DEPARTMENT OF TRANSPORTATION</b>	<b>CROSS SECTIONS - NB I-55</b>				F.A. RTE. = 64/998	SECTION = 82-1-RIA)	COUNTY = ST. CLAIR	TOTAL SHEETS = 629	SHEET NO. = 536
#FILEL#		DRAWN - KM	REVISED -		SCALE: 1" = 10'	SHEET NO. 9 OF 25 SHEETS	STA. 71+00.00	TO STA. 71+50.00	CONTRACT NO. 76C52				
		CHECKED - DBM	REVISED -		ILLINOIS FED. AID PROJECT								
		DATE - 1-20-12	REVISED -										