

THOUGH EXISTING SEWERS ARE SHOWN, NO OTHER EXISTING UTILITIES ARE PROVIDED ON THE CROSS SECTIONS. PROPOSED SEWERS ARE BASED ON THE PROPOSED DRAINAGE DESIGN SHOWN WITHIN THESE PLANS. THE CONTRACTOR IS RESPONSIBLE FOR IDENTIFYING ALL EXISTING UTILITIES PRIOR TO CONSTRUCTION. THE CONTRACTOR SHALL REFER TO S.U.E. PLANS FOR EXISTING UTILITY INFORMATION.

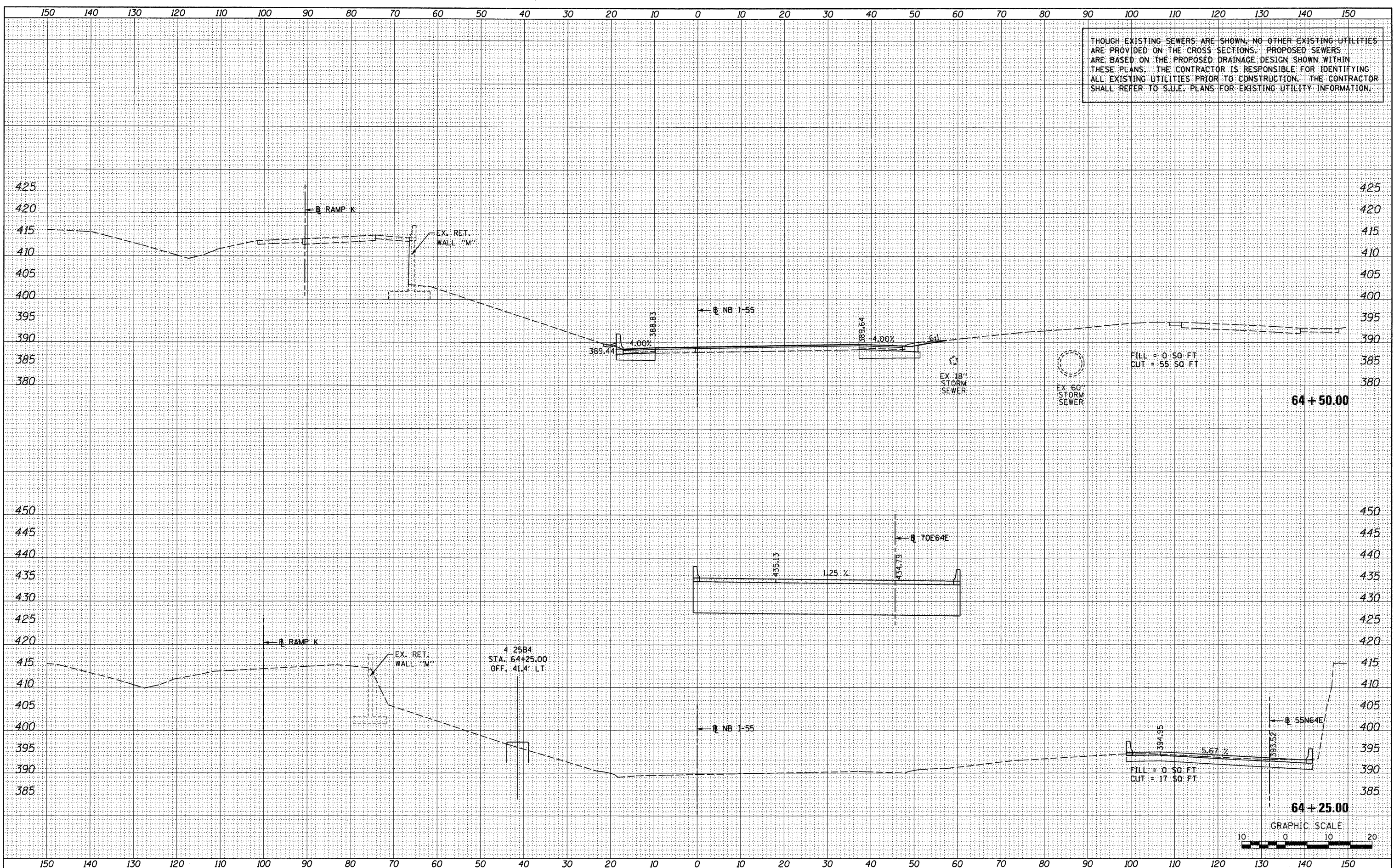

DATE	
BY	
FINAL SURVEY	
PLOTTED	
NOTE BOOK	
NO.	
AREAS CHECKED	

DATE	
BY	
ORIGINAL SURVEY	
PLOTTED	
NOTE BOOK	
NO.	
AREAS CHECKED	

FILE NAME =
#FILEL#

USER NAME = sear-sb
PLOT SCALE = 20.0000' / 1" =
PLOT DATE = 1/24/2012

DESIGNED - KM
DRAWN - KM
CHECKED - DBM
DATE - 1-20-12

REVISED -
REVISED -
REVISED -
REVISED -

**STATE OF ILLINOIS
DEPARTMENT OF TRANSPORTATION**

CROSS SECTIONS - NB I-55

SCALE: 1" = 10' SHEET NO. 2 OF 25 SHEETS STA. 64+25.00 TO STA. 64+50.00

F.A. RTE. 64/998	SECTION 82-1-(A)	COUNTY ST. CLAIR	TOTAL SHEETS 629	SHEET NO. 529
CONTRACT NO. 76C52			ILLINOIS FED. AID PROJECT	

