

PLAN	SURVEYED	DATE
	PLOTTED	BY
	GRADES CHECKED	
	STRUCTURE NOTATIONS CHECKED	
	NOTE BOOK NO.	
	FILE NAME	

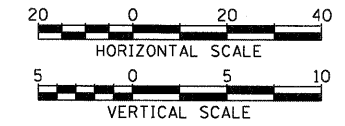

PROFILE	SURVEYED	DATE
	PLOTTED	BY
	GRADES CHECKED	
	STRUCTURE NOTATIONS CHECKED	
	NOTE BOOK NO.	
	FILE NAME	

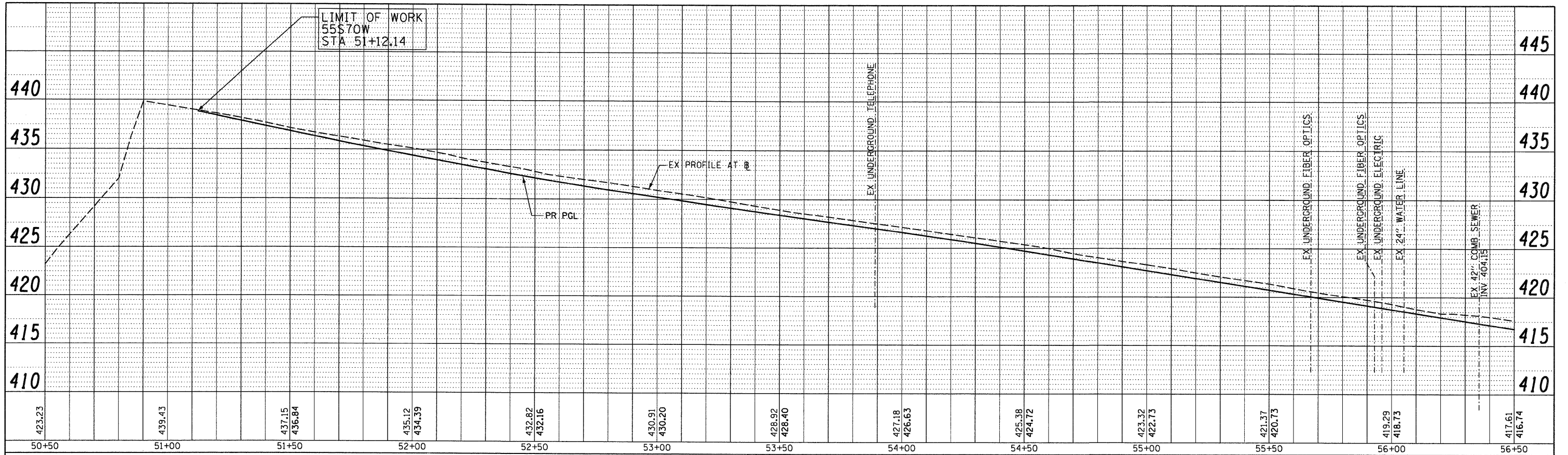
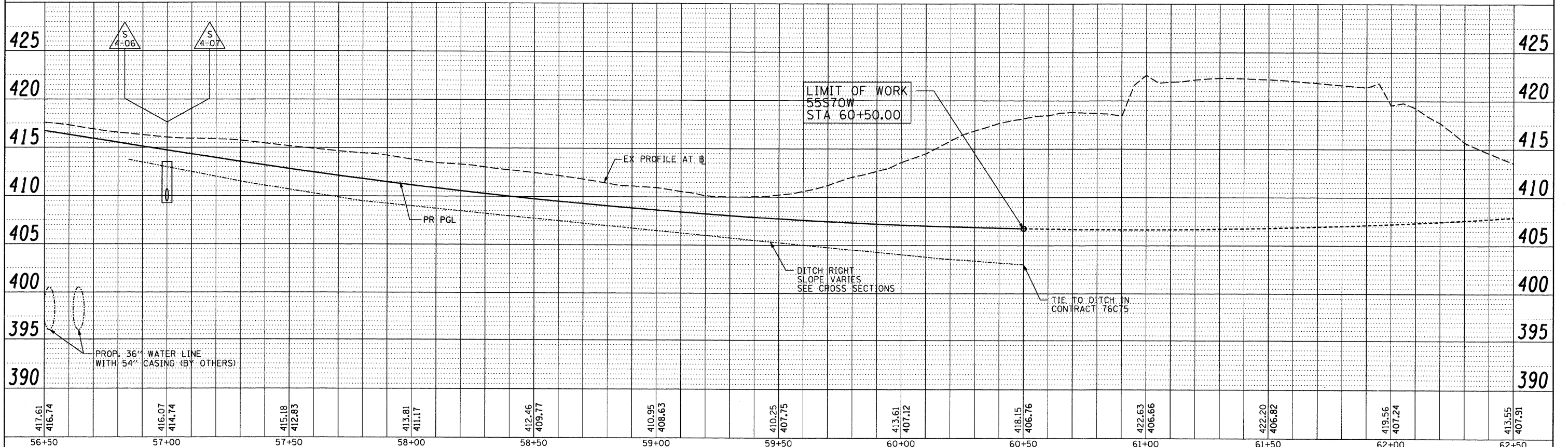

FILE NAME = DBTRI-76C52-Sht-Prof-Drain-18-55S70W.dgn	USER NAME = searsb	DESIGNED - MAN	REVISED -	<b>STATE OF ILLINOIS DEPARTMENT OF TRANSPORTATION</b>	<b>DRAINAGE PROFILE RAMP 55S70W</b>	F.A. RTE.	SECTION	COUNTY	TOTAL SHEETS	SHEET NO.
	PLOT SCALE = 40.000' / in.	DRAWN - CJS	REVISED -			82-1-RAI, 82-1-R(B)	ST. CLAIR	629	285	
	PLOT DATE = 1/24/2012	CHECKED - JF	REVISED -			64/998/70	CONTRACT NO. 76C52			
		DATE - 1-20-12	REVISED -			FED. ROAD DIST. NO.	ILLINOIS FED. AID PROJECT			
SCALE: H: 20 V: 5 SHEET NO. 18 OF 32 SHEETS STA. 50+50 TO STA. 62+50										