

**NOTES:**

1. USE STANDARD 701446 FOR CONTINUATION OF TWO LANE CLOSURE
2. SEE STANDARD 701400 FOR APPROACH

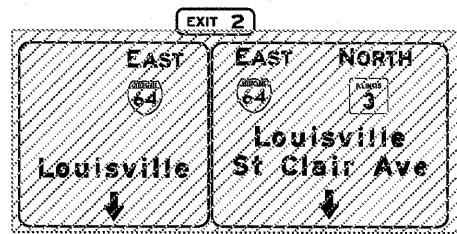

NOTE 1:  
COVER EX SIGN PANELS FOR  
EXIT FROM NB I-55 TO  
EB I-64 AND NB IL-3/  
ST. CLAIR AVE (RAMPS 55N64E)  
AND PLACE E5-2G BELOW  
"EXIT 2" PANEL

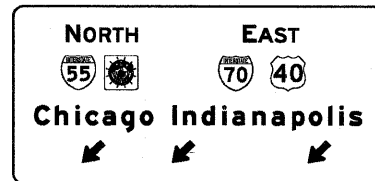
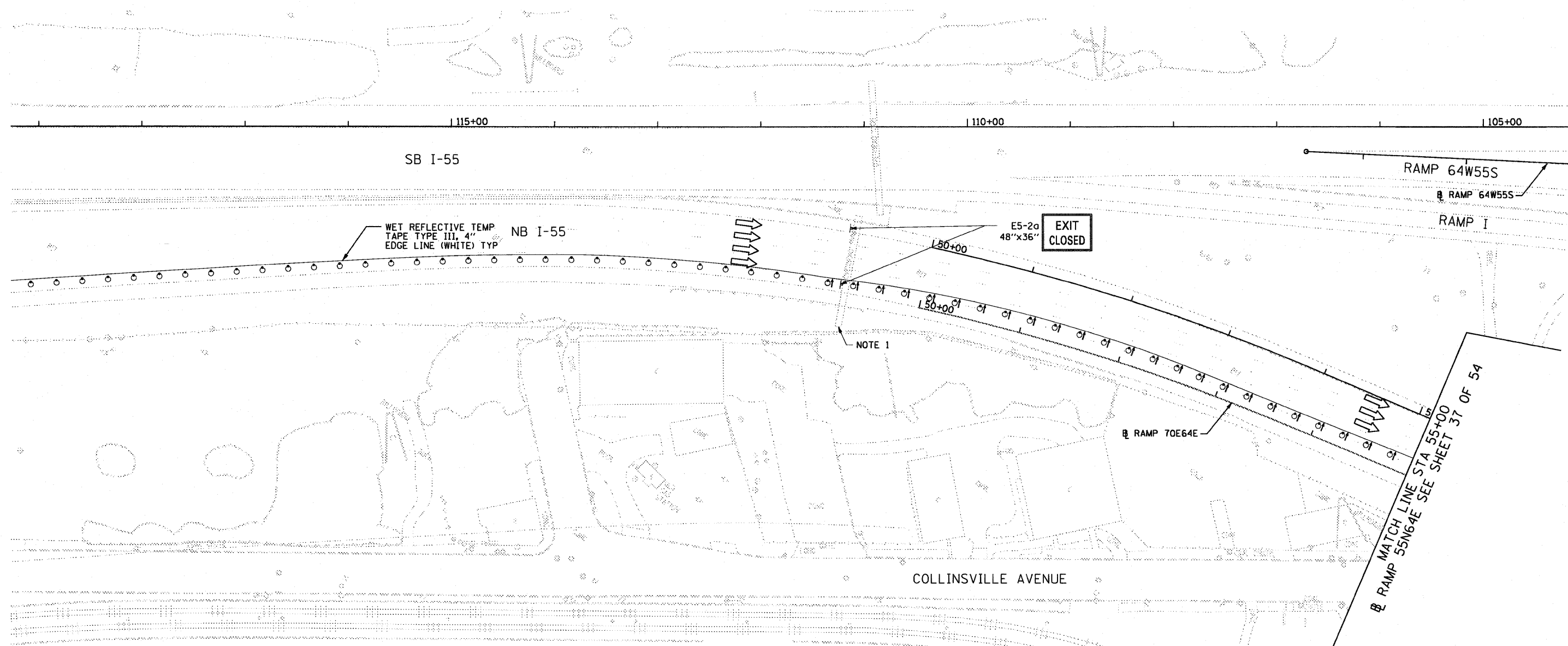
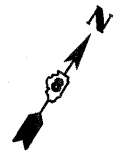

FILE NAME = DBT-r-76C52-sh-t-Stage4A-01.dgn	USER NAME = searsb	DESIGNED KM	REVISED -	<b>STATE OF ILLINOIS DEPARTMENT OF TRANSPORTATION</b>	<b>I-64 MAINLINE - SUGGESTED STAGES OF CONSTRUCTION AND TRAFFIC CONTROL PLAN - STAGE 4 PHASE 2</b>	F.A.I. RTE.	SECTION	COUNTY	TOTAL SHEETS	SHEET NO.	
	PLOT SCALE = 100.0000' / 1" =	DRAWN PHP	REVISED -			• 64/998/70	82-1-(A), 82-1-(B)	ST. CLAIR	629	218	
	PLOT DATE = 1/25/2012	CHECKED DBM	REVISED -			CONTRACT NO. 76C52					
		DATE 1-20-12	REVISED -			SCALE: 1" = 50'		SHEET NO. 37 OF 54 SHEETS		STA. 50+00 TO STA. 55+00	