

NOTE 1:  
COVER EX SIGN PANEL FOR  
EXIT FROM WB I-64 TO WB I-70  
AND NB I-55 (RAMPS 64W70W  
AND 64W55N) AND PLACE E5-2a  
BELOW "EXIT 3"

NOTE 2:  
COVER EX SIGN PANEL FOR EXIT FROM  
WB I-64 TO WB I-70 AND NB I-55  
(RAMPS 64W70W AND 64W55N) AND  
PLACE E5-2a BELOW "EXIT 3"

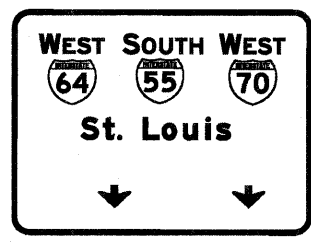
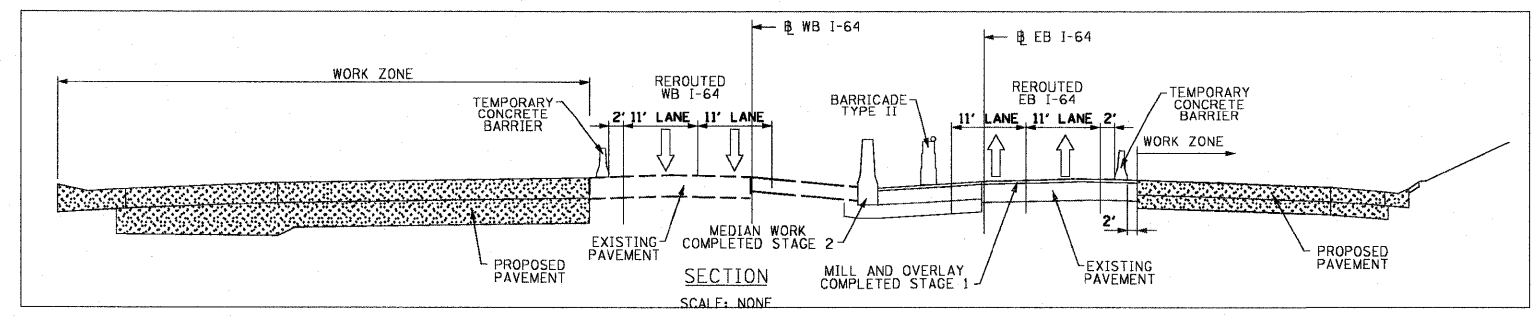
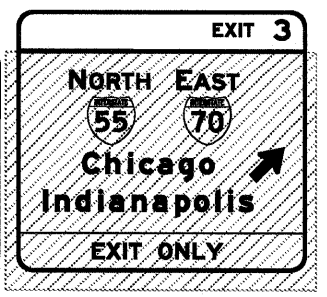
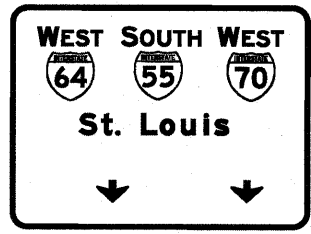

|  |                               |              |           |   |  |                     |                           |           |              |           |                    |
|--|-------------------------------|--------------|-----------|---|--|---------------------|---------------------------|-----------|--------------|-----------|--------------------|
| FILE NAME = DBT1-76C52-sh1-Stage3-03.dgn | USER NAME = searsb            | DESIGNED KM  | REVISED - | <b>STATE OF ILLINOIS<br/>DEPARTMENT OF TRANSPORTATION</b> | <b>I-64 MAINLINE - SUGGESTED STAGES OF CONSTRUCTION AND<br/>TRAFFIC CONTROL PLAN - STAGE 3</b> | F.A.I. RTE.         | SECTION                   | COUNTY    | TOTAL SHEETS | SHEET NO. |                    |
|  | PLOT SCALE = 100.0000' / 1" = | DRAWN PHP    | REVISED - |   |  | 64                  | 82-1-RIA, 82-1-RIB)       | ST. CLAIR | 629          | 207       |                    |
|  | PLOT DATE = 1/25/2012         | CHECKED DBM  | REVISED - |   |  | 64/998/70           |                           |           |              |           | CONTRACT NO. 76C52 |
|  |                               | DATE 1-20-12 | REVISED - |   |  | FED. ROAD DIST. NO. | ILLINOIS FED. AID PROJECT |           |              |           |                    |