

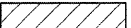

- LEGEND:**
-  PAVEMENT REMOVAL
 -  PAVED SHOULDER REMOVAL
 -  HMA SURFACE REMOVAL, 4"
 -  HMA SURFACE REMOVAL, SEE PLANS AND HMA TABLES FOR THICKNESS
 -  LINEAR REMOVAL

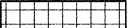
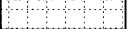

FILE NAME = DBT-1-76C52-sht-rem-02.dgn

USER NAME = searsb
 PLOT SCALE = 48,0000 / in.
 PLOT DATE = 2/3/2012

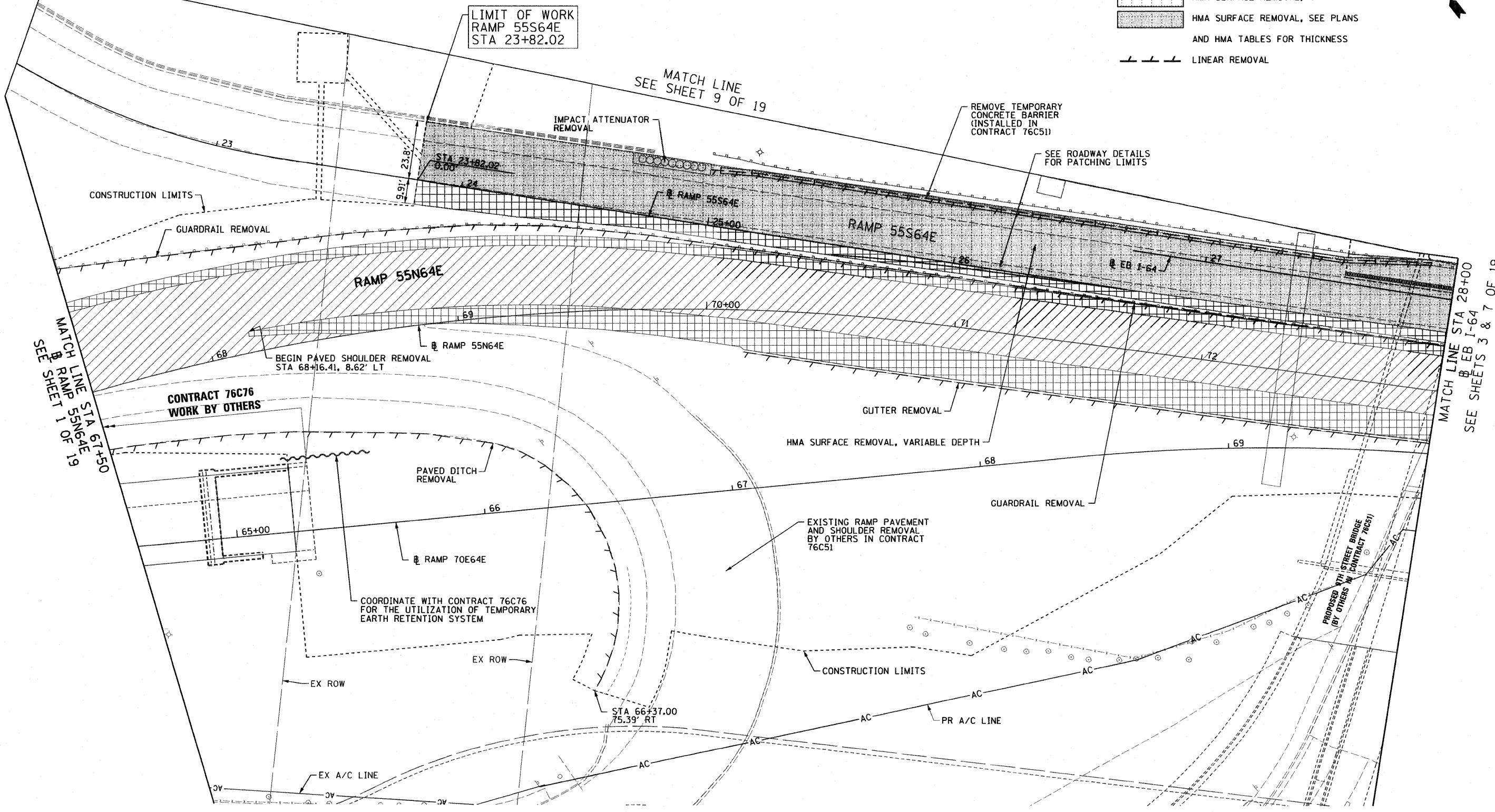
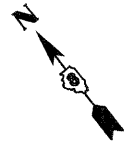
DESIGNED OP
 DRAWN PHP
 CHECKED DBM
 DATE 1-20-12

REVISED -
 REVISED -
 REVISED -
 REVISED -

**STATE OF ILLINOIS
 DEPARTMENT OF TRANSPORTATION**

**REMOVAL PLAN
 RAMP 55N64E & RAMP 70E64E**
 SCALE: 1" = 20' SHEET NO. 2 OF 19 SHEETS STA. 67+50 TO STA. 27+00

| F.A.I. RTE. | SECTION | COUNTY | TOTAL SHEETS | SHEET NO. |
|---|----------------------|-----------|--------------------|-----------|
| 64/998/70 | 82-1-R(A), 82-1-R(B) | ST. CLAIR | 629 | 73 |
| FED. ROAD DIST. NO. ILLINOIS FED. AID PROJECT | | | CONTRACT NO. 76C52 | |