

STATE OF ILLINOIS
DEPARTMENT OF TRANSPORTATION
DIVISION OF HIGHWAYS

**PROPOSED
HIGHWAY PLANS**

FAP ROUTE 514 (IL 94)
SECTION 106RS-6
PROJECT F-0514(011)
RESURFACING (3P)
HANCOCK COUNTY
C-96-087-09

F.A.P. RTE.	SECTION	COUNTY	TOTAL SHEETS	SHEET NO.
514	106RS-6	HANCOCK	26	1
ILLINOIS CONTRACT NO. 72C92				

D-96-087-09

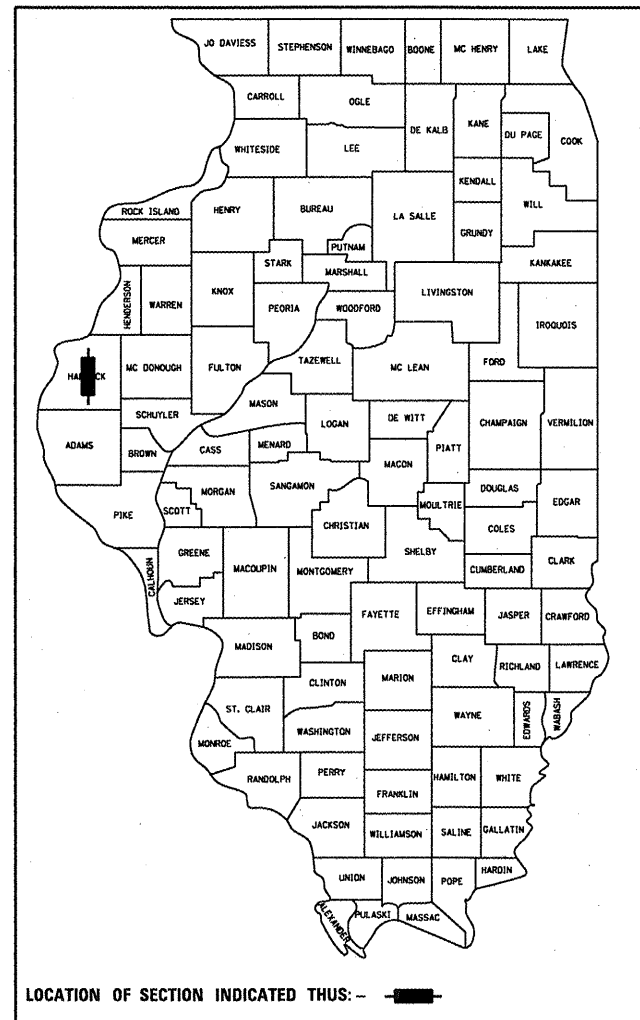

FOR INDEX OF SHEETS, SEE SHEET NO. 2

HIGHWAY CLASSIFICATION

F.A.P. ROUTE 514 (IL 94)

CLASSIFICATION: MINOR ARTERIAL

ADT: 1,374 (2009)

PV = 1,125, 82% (2009)

ADT: 1,677 (2029)

SU = 100, 7%

DESIGN SPEED: 60 MPH

MU = 150, 11%

POSTED SPEED: 55 MPH

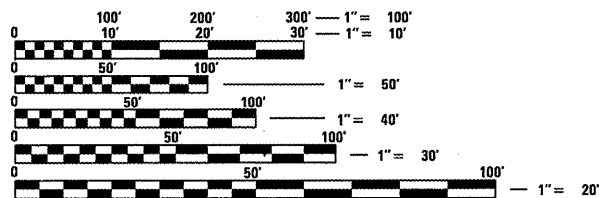
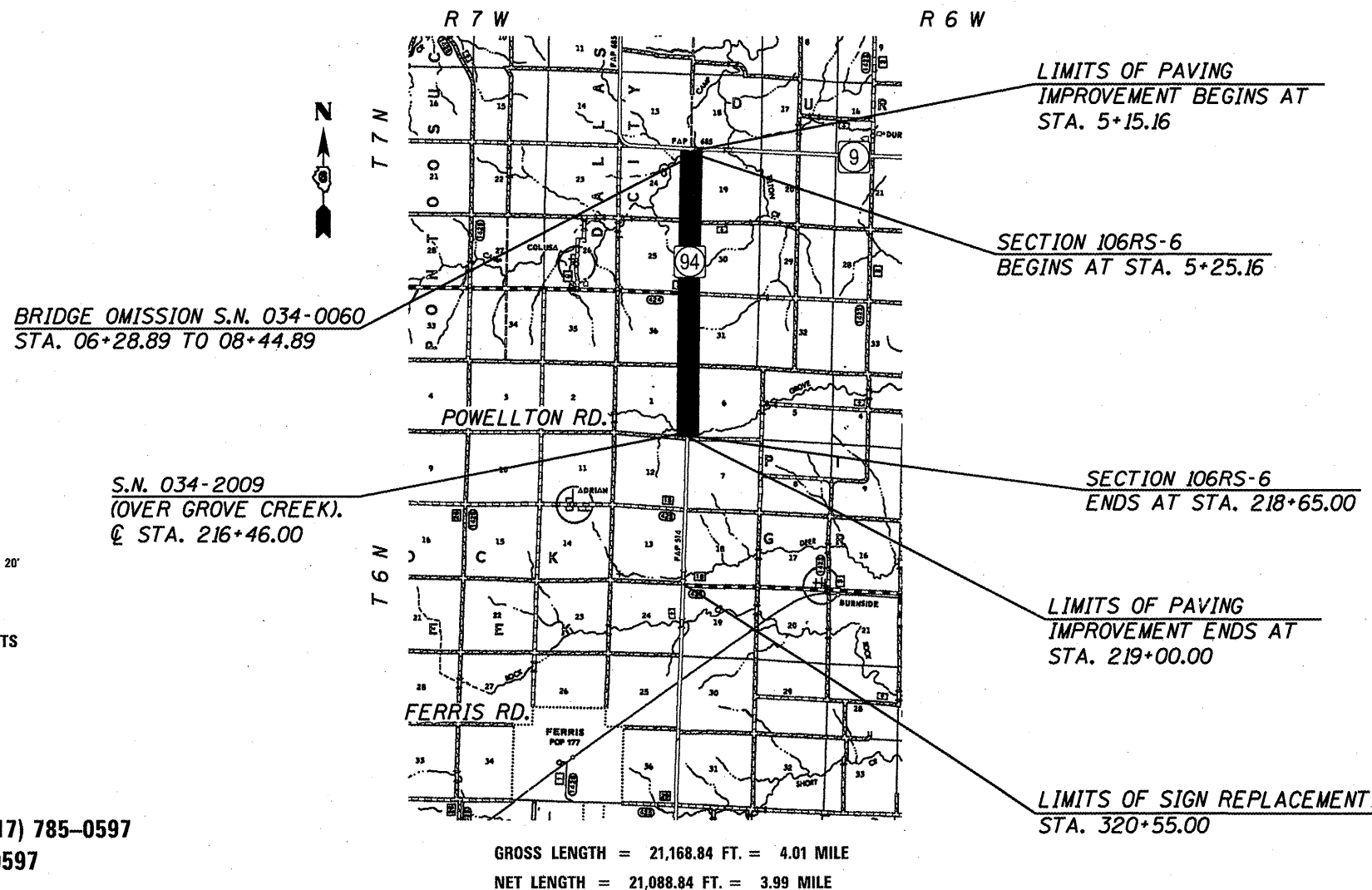

FULL SIZE PLANS HAVE BEEN PREPARED USING STANDARD ENGINEERING SCALES. REDUCED SIZED PLANS WILL NOT CONFORM TO STANDARD SCALES. IN MAKING MEASUREMENTS ON REDUCED PLANS, THE ABOVE SCALES MAY BE USED.

J.U.L.I.E.
JOINT UTILITY LOCATION INFORMATION FOR EXCAVATION
1-800-892-0123
OR 811

SENIOR TEAM ENGINEER: MARK DUST (217) 785-0597

TEAM ENGINEER: MARK DUST (217) 785-0597

CONTRACT NO. 72C92

GROSS LENGTH = 21,168.84 FT. = 4.01 MILE
NET LENGTH = 21,088.84 FT. = 3.99 MILE

STATE OF ILLINOIS
DEPARTMENT OF TRANSPORTATION
DIVISION OF HIGHWAYS

SUBMITTED Feb 8 20 12

Ray 2 Dalky
DEPUTY DIRECTOR OF HIGHWAYS, REGION ENGINEER

March 23 20 12
John D. Baranzelli, P.E. /a
acting ENGINEER OF DESIGN AND ENVIRONMENT

March 23 20 12
William R. Fley /a
acting DIRECTOR OF HIGHWAYS CHIEF ENGINEER

**PRINTED BY THE AUTHORITY
OF THE STATE OF ILLINOIS**

INDEX OF SHEETS

GENERAL NOTES

- ① WHERE SECTION OR SUBSECTION MONUMENTS ARE ENCOUNTERED, THE ENGINEER SHALL BE NOTIFIED BEFORE SUCH MONUMENTS ARE REMOVED. THE CONTRACTOR SHALL PROTECT AND CAREFULLY PRESERVE ALL PROPERTY MARKS AND MONUMENTS UNTIL THE OWNER, AND AUTHORIZED SURVEYOR OR AGENT HAS WITNESSES OR OTHERWISE REFERENCED THEIR LOCATION.
- ② THE NOMINAL THICKNESS FOR BASE AND SURFACE COURSES ARE SHOWN ON THE TYPICAL SECTIONS, STANDARDS, SCHEDULES, OR SPECIAL DETAILS. THE CONSTRUCTED THICKNESS OF THE ABOVE ITEM SHALL NOT BE LESS THAN 90 PERCENT OF THE NOMINAL THICKNESS AT ANY LOCATION.
- ③ THE THICKNESS OF THE HMA MIXTURE SHOWN ON THE PLANS IS THE NOMINAL THICKNESS. DEVIATIONS FROM THE NOMINAL THICKNESS WILL BE PERMITTED WHEN SUCH DEVIATION OCCUR DUE TO IRREGULARITIES IN THE EXISTING SURFACE OR BASE ON WHICH THE BITUMINOUS MIXTURE IS PLACED.
- ④ ANY REFERENCE TO A STANDARD IN THE PLANS SHALL BE INTERPRETED TO MEAN THE EDITION, AS INDICATED BY THE SUB-NUMBER LISTED IN THE INDEX OF SHEETS, OR THE COPY OF THE STANDARD INCLUDED IN THE PLANS.
- ⑤ THE CONTRACTOR SHALL BE RESPONSIBLE FOR PROTECTING UTILITY PROPERTY FROM CONSTRUCTION OPERATIONS AS OUTLINED IN ARTICLE 107.31 OF THE STANDARD SPECIFICATIONS. THE JULIE NUMBER IS 800-892-0123. A MINIMUM OF FORTY-EIGHT HOURS ADVANCED NOTICE IS REQUIRED. ANY DAMAGE TO THE UNDERGROUND FACILITIES CAUSED BY THE CONTRACTOR SHALL BE REPAIRED TO THE SATISFACTION OF THE DEPARTMENT AT THE CONTRACTORS EXPENSE, INCLUDING TEMPORARY REPAIRS WHICH MAY BE REQUIRED TO KEEP THE FACILITY OPERATIONAL WHILE MATERIAL IS BEING OBTAINED TO MAKE PERMANENT REPAIRS.
- ⑥ THE LOCATIONS OF THOSE BURIED AND ABOVEGROUND UTILITIES SHOWN ARE APPROXIMATE, ARE SHOWN FOR CONTRACTOR INFORMATIONAL USE ONLY, AND ARE NOT TO BE REFERENCED FOR CONSTRUCTION PURPOSES. THE IMPLIED PRESENCE OR ABSENCE OF UTILITIES IS NOT TO BE CONSTRUED BY THE OWNER, ENGINEER, CONTRACTOR OR SUBCONTRACTORS TO BE AN ACCURATE AND COMPLETE REPRESENTATION OF UTILITIES THAT MAY OR MAY NOT EXIST ON THE CONSTRUCTION SITE. BURIED AND ABOVE GROUND UTILITY LOCATIONS, IDENTIFICATION, AND MARKING ARE THE SOLE RESPONSIBILITY OF THE CONTRACTOR, REROUTING, DISCONNECTION, PROTECTION, ...ETC OF ANY UTILITIES MUST BE COORDINATED BETWEEN CONTRACTOR, UTILITY COMPANY, AND OWNER. SITE SAFETY, INCLUDING THE AVOIDANCE OF HAZARDOUS ASSOCIATED WITH BURIED AND ABOVE GROUND UTILITIES REMAIN THE SOLE RESPONSIBILITY OF THE CONTRACTOR.
- ⑦ THE FOLLOWING MIXTURE REQUIREMENTS ARE APPLICABLE:

LOCATION(S):	IL 94	IL 94	IL 94	Side Rds. & Entr.
MIXTURE USE(S):	HMA CONC SURF CSE	LEV BIND MM N50	PATCHING	INCIDENTAL HMA SURF
AC/PG:	• PG 64-22	• PG 64-22	• PG 64-22	• PG 64-22
DESIGN AIR VOIDS	4.0 @ N design = 50	4.0 @ N design = 50	4.0 @ N design = 50	4.0 @ N design = 50
MIXTURE COMPOSITION (Gradation Mixture)	IL 9.5 OR 12.5	IL 9.5	IL 19.0	IL 9.5 OR 12.5
FRICTION AGGREGATE	MIX "C"	N/A	N/A	MIX "C"

- ⑧ IN ADDITION TO FIELD AND AERIAL SURVEYS, PLAN DIMENSIONS AND DETAILS RELATIVE TO THE EXISTING FACILITIES HAVE BEEN TAKEN FROM EXISTING PLANS AND ARE SUBJECT TO CONSTRUCTION VARIATIONS. IT SHALL BE THE CONTRACTOR'S RESPONSIBILITY TO VERIFY SUCH DIMENSIONS AND DETAILS IN THE FIELD. SUCH VARIATIONS SHALL NOT BE A CAUSE FOR ADDITIONAL COMPENSATION DUE TO A CHANGE IN THE SCOPE OF WORK. HOWEVER, THE CONTRACTOR WILL BE PAID FOR THE QUANTITY ACTUALLY FURNISHED AT THE UNIT PRICE BID FOR THE WORK.
- ⑨ THE EXACT LOCATIONS AND SIZES OF PAVEMENT PATCHES SHALL BE DETERMINED BY THE ENGINEER IN THE FIELD.
- ⑩ THE APPROXIMATE AVERAGE THICKNESS OF 2" IS USED FOR CALCULATING THE QUANTITY FOR AGGREGATE SHOULDERS, TYPE B.
- ⑪ SEEDING INVOLVED IN EARTH OR FURNISHED EXCAVATION, SHOULDER WIDENING, AND INSTALLATION OF TYPE 1 (SPECIAL) GUARDRAIL TERMINALS SHALL BE DONE TO THE SATISFACTION OF THE ENGINEER AND BE INCLUDED IN THE CONTRACT UNIT PRICE PER EACH FOR TRAFFIC BARRIER TERMINAL, TYPE 1, (SPECIAL) TANGENT.
- ⑫ EXISTING ROADWAY RUMBLE STRIPS BETWEEN STATION 8+44.89 TO 18+04.00 LT SHALL BE REMOVED AND INCLUDED IN THE COST FOR HOT-MIX ASPHALT SURFACE REMOVAL, VARIABLE DEPTH.
- ⑬ NO PASSING ZONES TO BE FIELD VERIFIED BY THE BUREAU OF OPERATIONS. THE RESIDENT ENGINEER SHALL NOTIFY THE BUREAU OF OPERATIONS AT LEAST 14 DAYS PRIOR TO PLACEMENT OF FINAL PERMANENT PAVEMENT MARKING. (PH: 217-785-5312)

RATES OF APPLICATION TABLES

THE FOLLOWING RATES OF APPLICATION HAVE BEEN ASSUMED IN CALCULATING PLAN QUANTITIES.

BITUMINOUS MATERIALS (PRIME COAT):	0.00038 TON / SQ YD (ON PAVEMENT)
AGGREGATE MATERIALS (PRIME COAT):	0.001425 TON / SQ YD (ON AGGREGATE)
HMA SURFACE MIX C / BINDER (112 LBS):	0.056 TON / SQ YD • in.
AGGREGATE MATERIALS:	2.05 TON / CU YD

COMMITMENTS

THE RESIDENT ENGINEER SHALL CONTACT STUDIES AND PLANS CONCERNING ANY MAJOR PLAN CHANGE. TO MAKE SURE NO PREVIOUS COMMENTS (NOT LISTED) WERE MADE AFFECTING THE DESIGN AND ALLOW AN IMPROVED DESIGN FOR FUTURE PROJECTS.

INDEX OF SHEETS

- 1 COVER SHEET
- 2 INDEX OF SHEETS & GENERAL NOTES
- 3 - 4 SUMMARY OF QUANTITIES (2)
- 5 - 10 SCHEDULE OF QUANTITIES (6)
- 11 - 14 TYPICAL SECTIONS (4)
- 15 - 22 PLAN VIEW (8)
- 23 PAVEMENT MARKING DETAIL
- 24 - 26 ENTRANCE AND SIDEROAD DETAILS (3)

STANDARDS

000001-06	STANDARD SYMBOLS, ABBREVIATIONS, AND PATTERNS
442201-03	CLASS C & D PATCHES
630001-10	STEEL PLATE BEAM GUARDRAIL
630301-05	SHOULDER WIDENING FOR TYPE 1 (SPECIAL) GUARDRAIL TERMINALS
635006-03	REFLECTOR AND TERMINAL MARKER PLACEMENT
635011-02	REFLECTOR MARKER AND MOUNTING DETAILS
701011-02	OFF ROAD MOVING OPERATIONS 2L, 2W DAY ONLY <i>(SHOULDER WORK)</i>
701201-04	LANE CLOSURE 2L, 2W DAY ONLY, FOR SPEEDS ≥ 45MPH <i>(PATCHING)</i>
701301-04	LANE CLOSURE 2L, 2W SHORT TIME OPERATIONS <i>(MARKING PATCHES & CLEAN-UP)</i>
701306-03	LANE CLOSURE 2L, 2W SLOW MOVING OPERATIONS - DAY ONLY FOR SPEEDS ≥ 45MPH <i>(HMA SURF, SHDR OPS. & MILLING)</i>
701311-03	LANE CLOSURE 2L, 2W MOVING OPERATIONS - DAY ONLY <i>(PAVEMENT MARKING & CLEANUP)</i>
701901-02	TRAFFIC CONTROL DEVICES
720001-01	SIGN PANEL MOUNTING DETAILS
720006-03	SIGN PANEL ERECTION DETAILS
720011-01	METAL POSTS FOR SIGNS, MARKERS & DELINEATORS
728001-01	TELESCOPING STEEL SIGN SUPPORT
729001-01	APPLICATIONS OF TYPES A & B METAL POSTS (FOR SIGNS & MARKERS)
780001-03	TYPICAL PAVEMENT MARKING
781001-03	TYPICAL APPLICATIONS OF RAISED REFLECTIVE PAVEMENT MARKERS
701326-04	LANE CLOSURE, 2L, 2W, PAVEMENT WIDENING, FOR SPEEDS > 45 MPH <i>THE ITALICIZED TEXT DESCRIBING STANDARDS ARE GENERAL USES FOR THE APPLICATION SPECIFIED AND NOT LIMITED TO THEM.</i>

DISTRICT SIX	
EXAMINED <u>1/10</u>	20 <u>12</u>
<i>William M. Brown</i>	
OPERATIONS ENGINEER	
EXAMINED <u>JAN 31</u>	20 <u>12</u>
<i>Tommy J. ...</i>	
PROJECT IMPLEMENTATION ENGINEER	
EXAMINED <u>February 1</u>	20 <u>12</u>
<i>ARML</i>	
PROGRAM DEVELOPMENT ENGINEER	

CODE NO.	ITEM	UNIT	TOTAL QUANTITY	CONSTR. CODE	
				80% FEDERAL 20% STATE ROADWAY	
				0005	
				RURAL	
20100210	TREE REMOVAL (OVER 15 UNITS DIAMETER)	UNIT	66	66	
20200600	EXCAVATING AND GRADING EXISTING SHOULDER	UNIT	7	7	
20400800	FURNISHED EXCAVATION	CU YD	109	109	
35800100	PREPARATION OF BASE	SQ YD	129	129	
40200800	AGGREGATE SURFACE COURSE, TYPE B	TON	11	11	
40600200	BITUMINOUS MATERIALS (PRIME COAT)	TON	23	23	
40600300	AGGREGATE (PRIME COAT)	TON	117	117	
40600625	LEVELING BINDER, (MACHINE METHOD), N50	TON	2,389	2,389	
40600895	CONSTRUCTING TEST STRIP	EACH	1	1	
40600982	HOT-MIX ASPHALT SURFACE REMOVAL - BUTT JOINT	SQ YD	541	541	
40600990	TEMPORARY RAMP	SQ YD	176	176	
40603310	HOT-MIX ASPHALT SURFACE COURSE, MIX "C", N50	TON	5,135	5,135	
40800050	INCIDENTAL HOT-MIX ASPHALT SURFACING	TON	104	104	
44000155	HOT-MIX ASPHALT SURFACE REMOVAL, 1 1/2"	SQ YD	730	730	
44200180	PAVEMENT PATCHING, TYPE II, 15 INCH	SQ YD	144	144	

CODE NO.	ITEM	UNIT	TOTAL QUANTITY	CONSTR. CODE	
				80% FEDERAL 20% STATE ROADWAY	
				0005	
				RURAL	
44200184	PAVEMENT PATCHING, TYPE III, 15 INCH	SQ YD	155	155	
44200186	PAVEMENT PATCHING, TYPE IV, 15 INCH	SQ YD	331	331	
44300200	STRIP REFLECTIVE CRACK CONTROL TREATMENT	FOOT	42,111	42,111	
48101200	AGGREGATE SHOULDERS, TYPE B	TON	1,580	1,580	
48203023	HOT-MIX ASPHALT SHOULDERS, 6 1/2"	SQ YD	307	307	
* 63000001	STEEL PLATE BEAM GUARDRAIL, TYPE A, 6 FOOT POSTS	FOOT	625	625	
* 63100167	TRAFFIC BARRIER TERMINAL, TYPE 1 SPECIAL (TANGENT)	EACH	4	4	
63200310	GUARDRAIL REMOVAL	FOOT	300	300	
67000400	ENGINEER'S FIELD OFFICE, TYPE A	CAL MO	6	6	
67100100	MOBILIZATION	L SUM	1	1	
70100450	TRAFFIC CONTROL AND PROTECTION, STANDARD 701201	L SUM	1	1	
70100460	TRAFFIC CONTROL AND PROTECTION, STANDARD 701306	L SUM	1	1	
70100500	TRAFFIC CONTROL AND PROTECTION, STANDARD 701326	L SUM	1	1	
70300100	SHORT TERM PAVEMENT MARKING	FOOT	5,774	5,774	
70103815	TRAFFIC CONTROL SURVEILLANCE	CAL DA	2	2	
70300230	TEMPORARY PAVEMENT MARKING - LINE 5"	FOOT	52,073	52,073	

*SPECIALTY ITEM

FILE NAME =	USER NAME = sparksgn	DESIGNED - JWC	REVISED -
et:\pwork\pwork\sparksgn\d0221152\0672	C92-shr-500.dgn	DRAWN - JWC	REVISED -
	PLOT SCALE = 100.0000' / 1"	CHECKED - MSD	REVISED -
	PLOT DATE = Feb-07-2012 01:37:46PM	DATE -	REVISED -

**STATE OF ILLINOIS
DEPARTMENT OF TRANSPORTATION**

SUMMARY OF QUANTITIES			
SCALE:	SHEET 1 OF 2 SHEETS	STA.	TO STA.

F.A.P. RTE.	SECTION	COUNTY	TOTAL SHEETS	SHEET NO.
514	106RS-6	HANCOCK	26	3
CONTRACT NO. 72C92			ILLINOIS FED. AID PROJECT	

CODE NO.	ITEM	UNIT	TOTAL QUANTITY	CONSTR. CODE	
				80% FEDERAL 20% STATE ROADWAY	
				0005	
				RURAL	
70300250	TEMPORARY PAVEMENT MARKING - LINE 8"	FOOT	172	172	
70300260	TEMPORARY PAVEMENT MARKING - LINE 12"	FOOT	88	88	
70300280	TEMPORARY PAVEMENT MARKING - LINE 24"	FOOT	30	30	
70301000	WORK ZONE PAVEMENT MARKING REMOVAL	SQ FT	642	642	
* 72800100	TELESCOPING STEEL SIGN SUPPORT	FOOT	728	728	
* 78001120	PAINT PAVEMENT MARKING - LINE 5"	FOOT	52,073	52,073	
* 78004240	PREFORMED PLASTIC PAVEMENT MARKING, TYPE B - INLAID - LINE 8"	FOOT	172	172	
* 78004250	PREFORMED PLASTIC PAVEMENT MARKING, TYPE B - INLAID - LINE 12"	FOOT	88	88	
* 78004280	PREFORMED PLASTIC PAVEMENT MARKING, TYPE B - INLAID - LINE 24"	FOOT	30	30	
* 78100100	RAISED REFLECTIVE PAVEMENT MARKER	EACH	267	267	
* 78200410	GUARDRAIL MARKERS, TYPE A	EACH	9	9	
* 78201000	TERMINAL MARKER - DIRECT APPLIED	EACH	4	4	
78300200	RAISED REFLECTIVE PAVEMENT MARKER REMOVAL	EACH	264	264	
X4401198	HOT-MIX ASPHALT SURFACE REMOVAL (VARIABLE DEPTH)	SQ YD	56,907	56,907	

CODE NO.	ITEM	UNIT	TOTAL QUANTITY	CONSTR. CODE	
				80% FEDERAL 20% STATE ROADWAY	
				0005	
				RURAL	
* Z0005305	BOX CULVERT TO BE CLEANED	FOOT	216	216	
* X7200105	SIGN PANEL - TYPE 1 (SPECIAL)	SQ FT	155	155	
* X7200205	SIGN PANEL - TYPE 2 (SPECIAL)	SQ FT	225	225	
X7240200	REMOVE SIGN PANEL ASSEMBLY TYPE B (SPECIAL)	EACH	12	12	
X7240110	REMOVE SIGN PANEL ASSEMBLY TYPE A (SPECIAL)	EACH	24	24	

• SPECIALTY ITEM
● NON-PARTICIPATING
100% STATE

FILE NAME :	USER NAME : sparkgr	DESIGNED - JWC	REVISED -
c:\pw\work\pvidot\sparkgr\d0221152\0673\92-shc-500.dgn		DRAWN - JWC	REVISED -
	PLOT SCALE : 100.0000' / in.	CHECKED - MSD	REVISED -
	PLOT DATE : Feb-07-2012 01:37:46PM	DATE -	REVISED -

**STATE OF ILLINOIS
DEPARTMENT OF TRANSPORTATION**

SUMMARY OF QUANTITIES			
SCALE:	SHEET 2	OF 2 SHEETS	STA. TO STA.

F.A.P. RTE.	SECTION	COUNTY	TOTAL SHEETS	SHEET NO.
514	106RS-6	HANCOCK	26	4
ILLINOIS FED. AID PROJECT			CONTRACT NO. 72C92	

HOT-MIX ASPHALT SURFACE REMOVAL

TYP. SEC. #	LOCATION	QUANTITY		
		BUTT JOINT (SQ YD)	VAR. DEPTH (SQ YD)	1.50" (SQ YD)
	F. A. P. 514 (IL 94)			
(1)	STA. 5+15.16 TO STA. 5+25.16	207.01		
(1-2)	STA. 5+25.16 TO STA. 6+18.89			729.23
(2)	STA. 6+18.89 TO STA. 6+28.89	53.33		
	(BRIDGE OMISSION) S. N. 034-0060 STA. 6+28.89 TO STA. 8+44.89			
(3)	STA. 8+44.89 TO STA. 8+59.89	43.33		
(3-5)	STA. 8+59.89 TO STA. 14+30.00		1,646.98	
(6-18)	STA. 14+30.00 TO STA. 213+35.00		53,080	
(19-21)	STA. 213+35.00 TO STA. 218+85.00		2,180.00	
(21)	STA. 218+85.00 TO STA. 219+00.00	60.00		
	TR 57A (2600 N) LT	41.75		
	FAS 424 (2500 N.) RT	80.50		
	TR 71 (2500 N.) LT	55.00		
	PROJECT TOTAL	541	56,907	730

TEMPORARY RAMP

TYP. SEC. #	LOCATION	QUANTITY (SQ YD)
	F. A. P. 733 (IL 61/94)	
(1)	STA. 5+15.16 TO STA. 5+20.16	114.48
(2)	STA. 6+23.89 TO STA. 6+28.89	26.67
	(BRIDGE OMISSION) S. N. 034-0060 STA. 6+28.89 TO STA. 8+44.89	
(3)	STA. 8+44.89 TO STA. 8+49.89	14.44
(21)	STA. 218+95.00 TO STA. 219+00.00	20.00
	PROJECT TOTAL	176

GUARDRAIL REMOVAL

TYP. SEC. #	LOCATION	QUANTITY (FOOT)
	F. A. P. 514 (IL 94)	
(17)	STA. 136+41.00 TO STA. 137+91.00 RT	150
(17)	STA. 136+90.00 TO STA. 138+40.00 LT	150
	PROJECT TOTAL	300

RAISED REFLECTIVE PAVEMENT MARKER REMOVAL

LOCATION	QUANTITY (EACH)
F. A. P. 514 (IL 94)	
Limits of Improv. to SN 034-0060	1
SN 034-0060 to 2600 N	62
2600N to 2600N(A)	1
2600N(A) to 2500N	66
2500N to 2400N	67
2400N to Limits of Improv.	67
PROJECT TOTAL	264

TREE REMOVAL (OVER 15 UNITS DIAMETER)

LOCATION	QUANTITY (UNIT)
F. A. P. 514 (IL 94)	
STA. 45+60.00, 34.45' LT 66' Dia	66
PROJECT TOTAL	66

RAISED REFLECTIVE PAVEMENT MARKER

TYP. SEC. #	LOCATION	QUANTITY (EACH)
	F. A. P. 514 (IL 94)	
(1-2)	STA. 5+15.16 TO STA. 6+28.89	3
	(BRIDGE OMISSION) S. N. 034-0060 STA. 6+28.89 TO STA. 8+44.89	
(3-21)	STA. 8+44.89 TO STA. 219+00.00	264
	PROJECT TOTAL	267

BOX CULVERT TO BE CLEANED

TYP. SEC. #	LOCATION	QUANTITY (FOOT)
	F. A. P. 514 (IL 94)	
(20)	Over Grove Creek S. N. 034-2009 Box Culvert C. L. Sta. 216+46.01, 4 CELL 10' x10' Length=44'	216
	PROJECT TOTAL	216

FILE NAME =	USER NAME = sparksgw	DESIGNED - JWC	REVISED -
et:\pw\work\p\idot\sparksgw\10221152\0672\c92-sht-schedule.dgn		DRAWN - JWC	REVISED -
		CHECKED - MSD	REVISED -
		DATE -	REVISED -

STATE OF ILLINOIS
DEPARTMENT OF TRANSPORTATION

SCHEDULE OF QUANTITIES

SCALE: 50 SHEET 1 OF 6 SHEETS STA. TO STA.

F.A.P. RTE.	SECTION	COUNTY	TOTAL SHEETS	SHEET NO.
514	106R5-6	HANCOCK	26	5
ILLINOIS FED. AID PROJECT			CONTRACT NO. 72C92	

AGGREGATE SHOULDERS, TYPE B

TYP. SEC. #	LOCATION	QUANTITY (TON)
	F. A. P. 514 (IL 94)	
(1-2)	STA. 5+15.16 TO STA. 6+28.89 (BRIDGE OMISSION) S. N. 034-0060 STA. 6+28.89 TO STA. 8+44.89	8.64
(3-21)	STA. 8+44.89 TO STA. 219+00.00	1,598.63
	SUBTOTAL	1,607.26
	[SUBTRACT]	
	SIDE ROADS & ENTRANCES	27.17
	PROJECT TOTAL	1,580

STRIP REFLECTIVE CRACK CONTROL TREATMENT

TYP. SEC. #	LOCATION	QUANTITY (FOOT)
	F. A. P. 514 (IL 94)	
	(BRIDGE OMISSION) S. N. 034-0060 STA. 6+28.89 TO STA. 8+44.89	
(3-18)	STA. 8+44.89 TO 213+35.00	42,110.22
	PROJECT TOTAL	42,111

GUARDRAIL MARKER, TYPE B

TYP. SEC. #	LOCATION	QUANTITY (EACH)
	F. A. P. 514 (IL 94)	
(17)	STA. 135+18.00 TO STA. 138+67.00 RT	5
(17)	STA. 136+56.00 TO STA. 139+72.00 LT	4
	PROJECT TOTAL	9

AGGREGATE SURFACE COURSE, TYPE B

LOCATION	QUANTITY (TON)
F. A. P. 514 (IL 94)	
Quantity for HMA PE's and CE's	10.92
PROJECT TOTAL	11

STEEL PLATE BEAM GUARDRAIL, TYPE A, 6 FOOT POSTS

TYP. SEC. #	LOCATION	QUANTITY (FOOT)
	F. A. P. 514 (IL 94)	
	NEW GUARDRAIL	
(17)	STA. 135+28.00 TO STA. 138+57.00 RT	329.00
(17)	STA. 136+66.00 TO STA. 139+62.00 LT	296.00
	PROJECT TOTAL	625

TRAFFIC BARRIER TERMINAL, TYPE 1, SPECIAL (TANGENT)

TYP. SEC. #	LOCATION	QUANTITY (EACH)
	F. A. P. 514 (IL 94)	
(17)	STA. 135+28.00 TO STA. 135+78.00 RT	1
(17)	STA. 136+66.00 TO STA. 137+16.00 LT	1
(17)	STA. 138+07.00 TO STA. 138+57.00 RT	1
(17)	STA. 139+12.00 TO STA. 139+62.00 LT	1
	PROJECT TOTAL	4

TERMINAL MARKER-DIRECT APPLIED

TYP. SEC. #	LOCATION	QUANTITY (EACH)
	F. A. P. 733 (IL 61/94)	
(17)	STA. 135+28.00 RT	1
(17)	STA. 136+65.00 LT	1
(17)	STA. 138+57.00 RT	1
(17)	STA. 139+62.00 LT	1
	PROJECT TOTAL	4

PAVEMENT SCHEDULE

TYP SEC #	LOCATION STATION TO STATION		LENGTH	PAVEMENT WIDTH	LEVELING BINDER THICKNESS	HMA SURF THICKNESS	HMA SURF REM BUTT JOINT	HMA SURF REMOVAL VAR DP	HMA SURF REMOVAL 1 1/2"	HMA CONC SURF CSE "C" N50	LEV BINDER (MM), N50	BIT MAT PRIME COAT	AGG PRIME COAT
			FOOT	FOOT	INCH	INCH	SQ YD	SQ YD	SQ YD	TON	TON	TON	TON
	F. A. P. 514 (IL 94)		-	-	-	-	-	-	-	-	-	-	-
(1)	STA. 5+15.16	TO STA. 6+28.89	(MEASURED USING CADD)		-	-	-	-	-	83.59	-	-	-
(1)	STA. 5+15.16	TO STA. 5+25.16	(MEASURED USING CADD)		-	-	207.01	-	-	-	-	0.08	0.41
(1-2)	STA. 5+25.16	TO STA. 6+18.89	(MEASURED USING CADD)		-	1.5	-	-	729.23	-	-	0.28	1.46
(2)	STA. 6+18.89	TO STA. 6+28.89	10.00	48	-	-	53.33	-	-	-	-	0.02	0.11
	(BRIDGE OMISSION) STA. 6+28.89 TO STA. 8+44.89												
(3-5)	STA. 8+44.89	TO STA. 14+30.00	585.11	26	-	-	-	-	-	141.99	-	-	-
(3)	STA. 8+44.89	TO STA. 8+59.89	15.00	26	-	-	43.33	-	-	-	-	0.02	0.09
(3)	STA. 8+59.89	TO STA. 8+74.89	15.00	26	0 to 0.75	-	-	-	-	-	0.91	-	-
(3-5)	STA. 8+59.89	TO STA. 14+30.00	570.11	26	-	-	-	1,646.98	-	-	-	0.63	3.29
(4-5)	STA. 8+74.89	TO STA. 14+30.00	555.11	26	0.75	-	-	-	-	-	67.35	-	-
(6-16)	STA. 14+30.00	TO STA. 135+18.00	12,088.00	26	-	-	-	-	-	2,707.71	-	-	-
(17)	STA. 135+18.00	TO STA. 139+72.00 RT	454.00	24	-	-	-	-	-	101.70	-	-	-
(17)	STA. 135+18.00	TO STA. 138+67.00 RT	349.00	1	South Bound Shoulder		-	-	-	12.75	-	-	-
(17)	STA. 135+55.77	TO STA. 139+72.00 LT	416.23	1	North Bound Shoulder		-	-	-	11.54	-	-	-
(18)	STA. 139+72.00	TO STA. 213+35.00	7,363.00	24	-	-	-	-	-	1,649.31	-	-	-
(6-18)	STA. 14+30.00	TO STA. 213+35.00	19,905.00	24	0.75	-	-	53,080.00	-	-	2,229.36	20.17	106.16
(19-21)	STA. 213+35.00	TO STA. 218+70.00	535.00	36	0.75	-	-	-	-	-	89.88	-	-
(19-21)	STA. 213+35.00	TO STA. 218+80.00	545.00	36	-	-	-	2,180.00	-	-	-	0.83	4.36
(19-21)	STA. 213+35.00	TO STA. 219+00.00	565.00	36	-	-	-	-	-	189.84	-	-	-
(21)	STA. 218+70.00	TO STA. 218+85.00	15.00	36	0.75 to 0	-	-	-	-	-	1.26	-	-
(21)	STA. 218+85.00	TO STA. 219+00.00	15.00	36	-	-	60.00	-	-	-	-	0.02	0.12
	TR 57A (2600 N.) LT		-	-	-	-	41.75	-	-	-	-	-	-
	FAS 424 (2500 N.) RT		-	-	-	-	80.50	-	-	-	-	-	-
	TR 71 (2500 N.) LT		-	-	-	-	55.00	-	-	-	-	-	-
	SAFETY EDGE FOR SURFACE COURSE		-	-	-	-	-	-	-	235.90	-	-	-
			-	-	-	-	-	-	-	-	-	-	-
TOTAL							540.92	56,906.98	729.23	5,134.32	2,388.76	22.04	115.99

PROJECT TOTAL	541	56,907	730	5,135	2,389	23	117
---------------	-----	--------	-----	-------	-------	----	-----

WORK ZONE PAVEMENT MARKING REMOVAL

LOCATION	QUANTITY (SQ FT)
(Removal of Short-Term Pavement Marking) (After Surface Course) (1,924.44)(4/12)	641.48
PROJECT TOTAL	642

FURNISHED EXCAVATION

TYP. SEC. #	LOCATION	QUANTITY (CU YD)
	F. A. P. 514 (IL 94)	
(17)	STA. 135+18.00 TO STA. 138+67.00 RT	52
(17)	STA. 136+56.00 TO STA. 139+72.00 LT	47
	ADD 10%	1.10
	PROJECT TOTAL	109

PREFORMED PLASTIC PAVEMENT MARKING, TYPE B - INLAID - LINE

TYP. SEC. #	LOCATION	8"	12"	24"
		WHITE		
		SOLID (FOOT)	SOLID (FOOT)	SOLID (FOOT)
	F. A. P. 514 (IL 94)	PAINTED	CHEVRONS	STOP BAR
	IL 94/IL 9 INTERSECTION	ISLAND		
(1)	Sta. 5+30.00, 25' LT	171.49	87.49	
(1)	Sta. 5+37.00			18
(1)	Sta. 5+48.00			12
	TOTAL	172	88	30

EXC & GR EX SHLD

HOT-MIX ASPHALT SHOULDERS 6 1/2"

TYP. SEC. #	LOCATION	QUANTITY (SQ YD)	QUANTITY (UNIT)
	F. A. P. 514 (IL 94)		
(17)	STA. 135+18.00 TO STA. 135+43.00 RT	13.89	25.0
(17)	STA. 135+43.00 TO STA. 136+81.00 RT	61.33	138.0
(17)	STA. 136+56.00 TO STA. 136+81.00 LT	13.89	25.0
(17)	STA. 136+81.00 TO STA. 138+42.00	143.11	322.0
(17)	STA. 138+42.00 TO STA. 138+67.00 RT	13.89	25.0
(17)	STA. 138+42.00 TO STA. 139+47.00 LT	46.67	105.0
(17)	STA. 139+47.00 TO STA. 139+72.00 LT	13.89	25.0
	PROJECT TOTAL	307	7

PAINT PAVEMENT MARKING - LINE 5"

TYP. SEC. #	LOCATION	YELLOW			WHITE
		DBL-SOLID (FOOT)	SOLID (FOOT)	SKIP-DASH (FOOT)	SOLID (FOOT)
	F. A. P. 514 (IL 94)				
(1-2)	STA. 5+15.16 TO STA. 6+28.89 (BRIDGE OMISSION) S. N. 034-0060	227.46			227.46
	STA. 6+28.89 TO STA. 8+44.89		216	216	432
(3-21)	STA. 8+44.89 TO STA. 219+00.00			5,263.78	42,110.22
(3-7)	STA. 8+44.89 TO STA. 29+50.00		2,105		
(7-8)	STA. 33+60.00 TO STA. 41+77.00		817		
(19-21)	STA. 214+43.00 TO STA. 219+00.00		457		
	SUBTOTAL	227	3,595	5,480	42,770
	PROJECT TOTAL				52,073

SHORT-TERM PAVEMENT MARKING

TYP. SEC. #	LOCATION	QUANTITY (FOOT)
	F. A. P. 514 (IL 94)	
(1-2)	STA. 5+15.16 TO STA. 6+28.89 (BRIDGE OMISSION) S. N. 034-0060 STA. 6+28.89 TO STA. 8+44.89	10.34
(3-21)	STA. 8+44.89 TO STA. 219+00.00	1,914.10
	SUBTOTAL (After Milling)	1,924.44
	SUBTOTAL (After Binder)	1,924.44
	SUBTOTAL (After Surface)	1,924.44
	PROJECT TOTAL	5,774

FILE NAME *	USER NAME * cao.jw	DESIGNED - JWC	REVISED -
ca:\pwwork\pwwork\cao.jw\08221152\087209\shs-schedule.dgn		DRAWN - JWC	REVISED -
PLOT SCALE * 100.0000' / in.		CHECKED - MSD	REVISED -
PLOT DATE * Feb-16-2012 01:26:54PM		DATE -	REVISED -

STATE OF ILLINOIS
DEPARTMENT OF TRANSPORTATION

SCHEDULE OF QUANTITIES

SCALE: 50 SHEET 4 OF 6 SHEETS STA. TO STA.

F.A.P. RTE. 514	SECTION 106RS-6	COUNTY HANCOCK	TOTAL SHEETS 26	SHEET NO. 8
CONTRACT NO. 72C92			ILLINOIS FED. AID PROJECT	

SIGN REPLACEMENT SCHEDULE

STATION	FACING	OFFSET	SIGN	SIGN DESIGNATION	SIGN SIZE (in.)	Sign Panel Ty 1 Spl (Sq. Ft.)	Sign Panel Ty 2 Spl (Sq. Ft.)	Rem Sign Panel Assembly Ty A Spl (Each)	Rem Sign Panel Assembly Ty B Spl (Each)	No. of Posts	Telescoping Stl Sign Support (Foot)
11+15	South	23RT	Carthage 12 Bowen 27	D2-2	24 x 48	8					
11+15	South	23RT	Speed limit 55	R2-1	24 x 30	5			1	2	28
11+15	South	23RT	South	M3-1	24 x 12	2					
11+15	South	23RT	Illinois Route Marker (Ill. 94)	D3-1	30 x 24	5					
11+20	North	23LT	< - Dallas City Laharpe ->	D1-2	24 x 48	8					
11+20	North	23LT	Illinois Route Marker (Ill. 94)	D3-1	24 x 30	5			1	2	28
11+20	North	23LT	Illinois Route Marker (Ill. 9)	D3-1	24 x 30	5					
11+20	North	23LT	Double Horizontal Arrow (symbol)	M6-4	24 x 12	2					
11+20	North	23LT	Advance Right Arrow (Symbol)	M6-1	21 x 15	2.2					
16+43	North	23LT	Stop Ahead (Symbol)	W3-1	36 x 36		9	1		1	14
19+59	North	23LT	JCT	M2-1	21 x 15	2.2		1		1	14
19+59	North	23LT	Illinois Route Marker (Ill. 9)	D3-1	30 x 24	5					
23+29	South	25LT	No Pass Zone (Rural)	W14-3	64 x 48		10.7				
23+29	North	25LT	Rumble Strips	STATE	36 x 36		9		1	2	28
23+29	North	25RT	No Pass Zone (Rural)	W14-3	64 x 48		10.7		1	2	28
41+77	North	25RT	No Pass Zone (Rural)	W14-3	64 x 48		10.7		1	2	28
54+97	South	25RT	< - Byler Historic Cemetery	STATE	24 x 48	8		1		2	28
57+61	North	25LT	County Reference Marker (Symbol) (Hancock)	STATE	18 x 18	2.3		1		1	14
57+61	South	25LT	County Reference Marker (Symbol) (Hancock)	STATE	18 x 18	2.3					
58+67	West	33RT	Stop	R1-1	36 x 36		9	1		1	14
59+19	East	33LT	Stop	R1-1	36 x 36		9	1		1	14
107+24	South	25LT	Crossroad (Symbol)	W2-1	36 x 36		9		1	1	14
107+24	South	25LT	Colusa Nauvoo Rd. (Bow Tie)	D3-1	18 x 30	3.8					
108+30	South	25LT	Nauvoo State Park -> Colusa ->	D1-2	24 x 48	8		1		2	28
111+99	West	33RT	Stop	R1-1	36 x 36		9	1		1	14
112+52	East	33LT	Stop	R1-1	36 x 36		9	1		1	14
114+63	North	25LT	< - Colusa 2 < - Nauvoo State Park	D1-2	24 x 48	8		1		2	28
115+69	North	25LT	Crossroad (Symbol)	W2-1	36 x 36		9				
115+69	North	25LT	Colusa Nauvoo Rd. (Bow Tie)	D3-1	18 x 30	3.8			1	2	28
115+69	North	25LT	County Reference Marker (Symbol) (Hancock)	STATE	18 x 18	2.3					
115+69	South	25LT	County Reference Marker (Symbol) (Hancock)	STATE	18 x 18	2.3					
116+22	North	25LT	Byler Historic Cemetery ->	STATE	24 x 48	8		1		1	14
163+21	South	25LT	County Reference Marker (Symbol) (Hancock)	STATE	18 x 18	2.3		1		1	14
163+21	North	25LT	County Reference Marker (Symbol) (Hancock)	STATE	18 x 18	2.3					
165+32	West	33RT	Stop	R1-1	36 x 36		9	1		1	14
165+85	East	33LT	Stop	R1-1	36 x 36		9	1		1	14
210+73	South	25LT	Crossroad (Symbol)	W2-1	36 x 36		9	1		1	14
SUB TOTAL =							102.8	131.1	15	7	434

SIGN REPLACEMENT SCHEDULE

STATION	FACING	OFFSET	SIGN	SIGN DESIGNATION	SIGN SIZE (in.)	Sign Panel Ty 1 Spl (Sq. Ft.)	Sign Panel Ty 2 Spl (Sq. Ft.)	Rem Sign Panel Assembly Ty A Spl (Each)	Rem Sign Panel Assembly Ty B Spl (Each)	No. of Posts	Telescoping Stl Sign Support (Foot)
214+43	South	25LT	No Pass Zone (Rural)	W14-3	64 x 48		10.7				
214+43	South	25LT	County Reference Marker (Symbol) (Hancock)	STATE	18 x 18	2.3			1	2	28
214+43	North	25LT	County Reference Marker (Symbol) (Hancock)	STATE	18 x 18	2.3					
219+18	West	33RT	Stop	R1-1	36 x 36		9	1		1	14
219+71	East	33LT	Stop	R1-1	36 x 36		9	1		1	14
226+57	North	25LT	Crossroad (Symbol)	W2-1	36 x 36		9	1		1	14
231+32	North	25RT	No Pass Zone (Rural)	W14-3	64 x 48		10.7		1	2	28
269+87	South	25LT	Crossroad (Symbol)	W2-1	36 x 36		9				
269+87	South	25LT	Adrian Rd. (Bow Tie)	D3-1	18 x 30	3.8			1	2	28
269+87	South	25LT	County Reference Marker (Symbol) (Hancock)	STATE	18 x 18	2.3					
269+87	North	25LT	County Reference Marker (Symbol) (Hancock)	STATE	18 x 18	2.3					
271+45	South	25LT	Adrian 2->	D1-1	24 x 48	8		1		1	14
273+03	East	25LT	Double Arrow (symbol)	W1-7	24 x 48	8		1		2	28
273+03	East	25LT	Yellow Diamond	OM1-1	18 x 18	2.3		1		1	14
273+46	West	33RT	Stop	R1-1	36 x 36		9	1		1	14
273+56	East	33LT	Stop	R1-1	36 x 36		9	1		1	14
273+56	North	33LT	< - Adrian 2	D1-1	24 x 48	8		1		2	28
278+31	North	25LT	Crossroad (Symbol)	W2-1	36 x 36		9		1	2	28
278+31	North	25LT	Adrian Rd. (Bow Tie)	D3-1	18 x 30	3.8					
320+55	South	25RT	Crossroad (Symbol)	W2-1	36 x 36		9				
320+55	South	25RT	Burnside Rd (Bow Tie)	D3-1	18 x 30	3.8			1	2	28
320+55	South	25RT	County Reference Marker (Symbol) (Hancock)	STATE	18 x 18	2.3					
320+55	North	25RT	County Reference Marker (Symbol) (Hancock)	STATE	18 x 18	2.3					
SUB TOTAL =						51.5	93.4	9	5		294

TOTAL =	155	225	24	12		728
---------	-----	-----	----	----	--	-----

*NOTE: SIGNS TO BE SUPPLIED BY THE DISTRICT 6 SIGN SHOP

☉ F.A.P. 514 (IL 94)

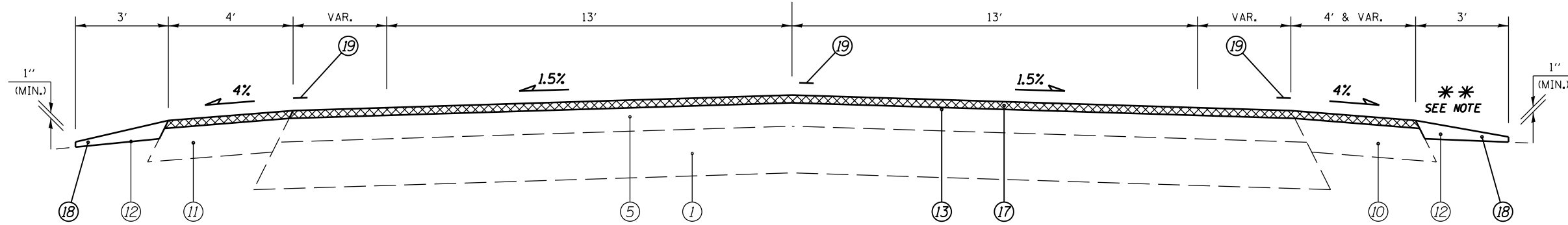

(1) STA 5+25.16 TO STA 5+97.69 [72.53']

☉ F.A.P. 514 (IL 94)

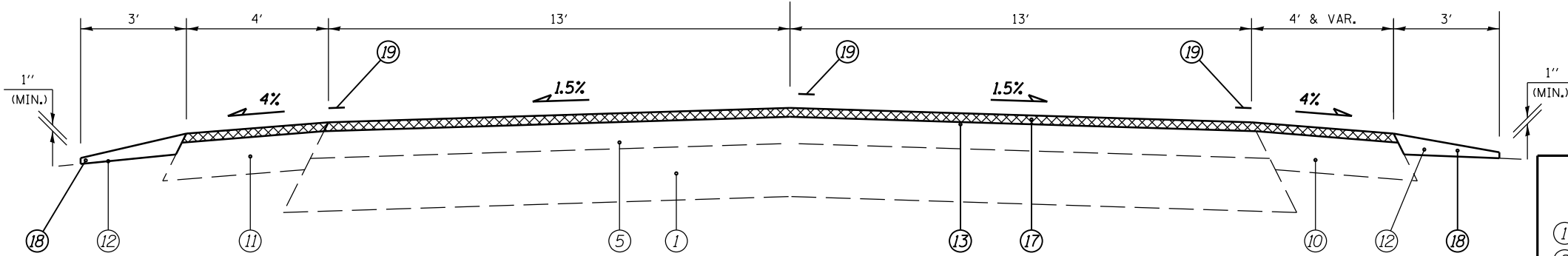

(2) STA 5+97.69 TO STA 6+18.89 [21.20']

☉ F.A.P. 514 (IL 94)

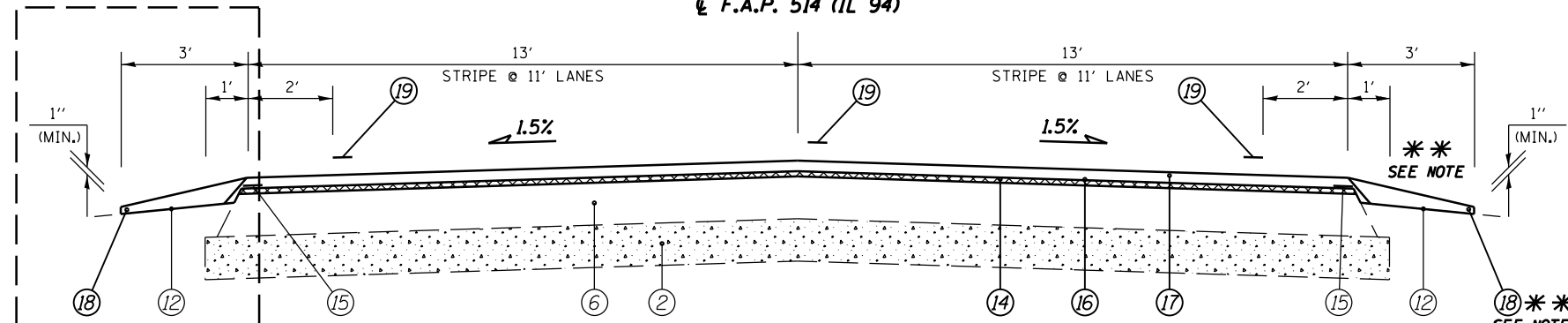

(3) STA 8+74.89 TO STA 9+70.00 [95.11']

SEE SHEET 12 FOR SAFETY EDGE DETAIL

*** NOTE:

PROP. SAFETY EDGE. SEE SHEET 12 FOR DETAIL

(OVER CAMP CREEK)

BRIDGE OMISSION

S.N.: 034-0060
STA. 06+28.89 TO
STA. 08+44.89

LEGEND

- ① EXISTING BITUMINOUS BASE COURSE 9"
- ② EXISTING P.C.C. PAVEMENT 6"
- ③ EXISTING P.C.C. PAVEMENT 9"-6"-9"
- ④ EXISTING P.C.C. PAVEMENT 9"
- ⑤ EXISTING BITUMINOUS OVERLAY 6"
- ⑥ EXISTING BITUMINOUS OVERLAY 6 3/4"
- ⑦ EXISTING BITUMINOUS OVERLAY 3 3/4"
- ⑧ EXISTING BITUMINOUS OVERLAY 4 1/2"
- ⑨ EXISTING BITUMINOUS CONCRETE BASE COURSE WIDENING 9"
- ⑩ EXISTING BITUMINOUS CONCRETE BASE COURSE WIDENING 10"
- ⑪ EXISTING BITUMINOUS SHOULDERS 8"
- ⑫ EXISTING AGGREGATE SHOULDERS, TYPE B
- ⑫A EXISTING STEEL PLATE BEAM GUARDRAIL (TBR)
- ⑬ PROPOSED HOT-MIX ASPHALT SURFACE REMOVAL, 1 1/2"
- ⑭ PROPOSED HOT-MIX ASPHALT SURFACE REMOVAL, (VARIABLE DEPTH) *
- ⑮ PROPOSED STRIP REFLECTIVE CRACK CONTROL TREATMENT
- ⑯ PROPOSED LEVELING BINDER (MACHINE METHOD), N50 3/4"
- ⑰ PROPOSED HOT-MIX ASPHALT SURFACE COURSE, MIX "C", N50 1-1/2"
- ⑱ PROPOSED AGGREGATE SHOULDERS, TYPE B
- ⑲ PROPOSED PAINT PAVEMENT MARKING - LINE 5"
- ⑳ PROPOSED HOT-MIX ASPHALT SHOULDERS, 6 1/2"
- ㉑ PROPOSED STEEL PLATE BEAM GUARDRAIL, 6' POSTS
- ㉒ PROPOSED FURNISHED EXCAVATION

* NOMINAL MILLING DEPTH 3/4" @ ☉

FILE NAME =	USER NAME = sparksgw	DESIGNED - JWC	REVISED -
ei:\pwork\pwork\sparksgw\0221152\0672\c92-sh-typical.dgn		DRAWN - JWC	REVISED -
		CHECKED - MSD	REVISED -
		DATE -	REVISED -

STATE OF ILLINOIS
DEPARTMENT OF TRANSPORTATION

TYPICAL SECTIONS

SCALE: NTS SHEET NO. 1 OF 4 SHEETS STA. 5+25.16 TO STA. 9+70.00

F.A.P. RTE.	SECTION	COUNTY	TOTAL SHEETS	SHEET NO.
514	106RS-6	HANCOCK	26	11
CONTRACT NO. 72C92			ILLINOIS FED. AID PROJECT	

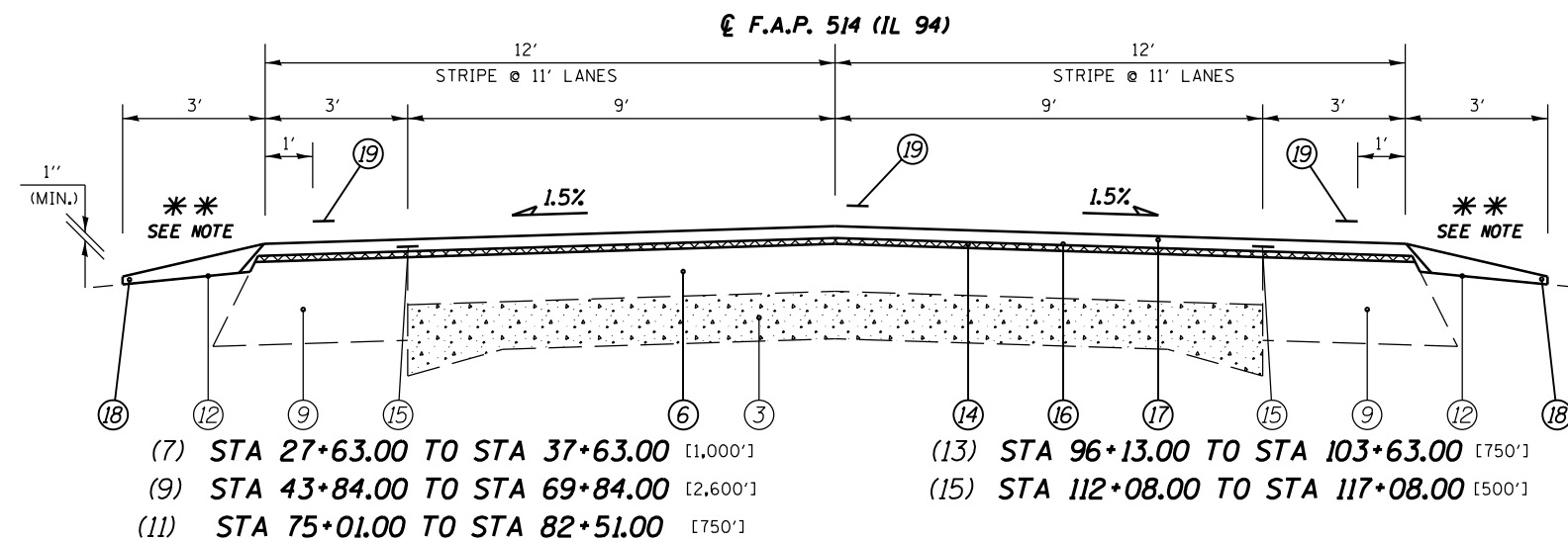

**** NOTE:**
 PROP. SAFETY EDGE. SEE SHEET 12 FOR DETAIL

- ### LEGEND
- ① EXISTING BITUMINOUS BASE COURSE 9"
 - ② EXISTING P.C.C. PAVEMENT 6"
 - ③ EXISTING P.C.C. PAVEMENT 9"-6"-9"
 - ④ EXISTING P.C.C. PAVEMENT 9"
 - ⑤ EXISTING BITUMINOUS OVERLAY 6"
 - ⑥ EXISTING BITUMINOUS OVERLAY 6 3/4"
 - ⑦ EXISTING BITUMINOUS OVERLAY 3 3/4"
 - ⑧ EXISTING BITUMINOUS OVERLAY 4 1/2"
 - ⑨ EXISTING BITUMINOUS CONCRETE BASE COURSE WIDENING 9"
 - ⑩ EXISTING BITUMINOUS CONCRETE BASE COURSE WIDENING 10"
 - ⑪ EXISTING BITUMINOUS SHOULDERS 8"
 - ⑫ EXISTING AGGREGATE SHOULDERS, TYPE B
 - ⑬ EXISTING STEEL PLATE BEAM GUARDRAIL (TBR)
 - ⑭ PROPOSED HOT-MIX ASPHALT SURFACE REMOVAL, 1 1/2"
 - ⑮ PROPOSED STRIP REFLECTIVE CRACK CONTROL TREATMENT
 - ⑯ PROPOSED LEVELING BINDER (MACHINE METHOD), N50 3/4"
 - ⑰ PROPOSED HOT-MIX ASPHALT SURFACE COURSE, MIX "C", N50 1-1/2"
 - ⑱ PROPOSED AGGREGATE SHOULDERS, TYPE B
 - ⑲ PROPOSED PAINT PAVEMENT MARKING - LINE 5"
 - ⑳ PROPOSED HOT-MIX ASPHALT SHOULDERS, 6 1/2"
 - ㉑ PROPOSED STEEL PLATE BEAM GUARDRAIL, 6' POSTS
 - ㉒ PROPOSED FURNISHED EXCAVATION

* NOMINAL MILLING DEPTH 3/4" @ ☉

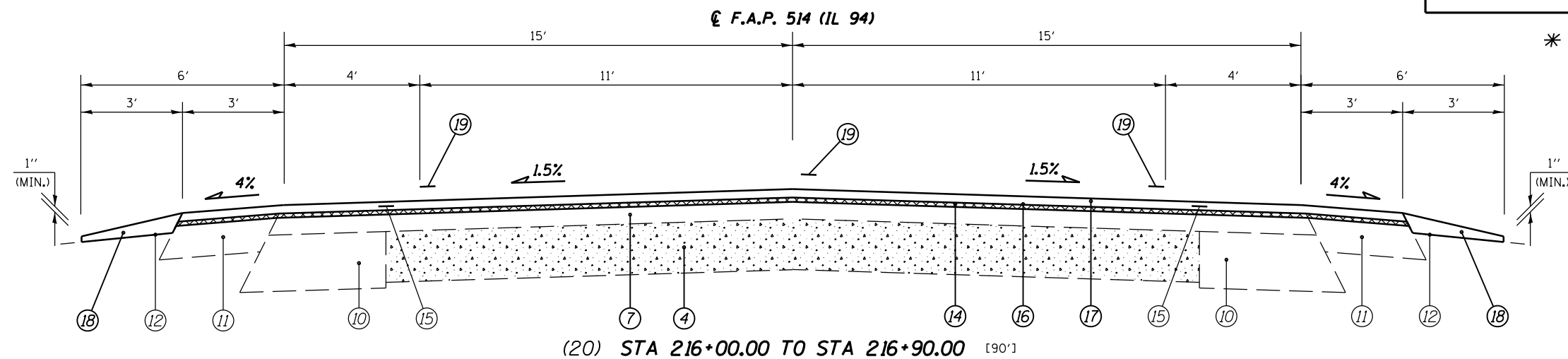

FILE NAME =	USER NAME = sparksgw	DESIGNED - JWC	REVISED -	STATE OF ILLINOIS DEPARTMENT OF TRANSPORTATION	TYPICAL SECTIONS	F.A.P. RTE. = 514	SECTION = 106RS-6	COUNTY = HANCOCK	TOTAL SHEETS = 26	SHEET NO. = 13	
et:\pwork\pwork\sparksgw\0221152\0672\092-sh-typical.dgn	DRAWN - JWC	REVIS	REVIS			SCALE: NTS SHEET NO. 3 OF 4 SHEETS STA. 27+63.00 TO STA. 216+90.00					
PLOT SCALE = 100.0000' / 1"	CHECKED - MSD	REVIS	REVIS			ILLINOIS FED. AID PROJECT					
PLOT DATE = Feb-07-2012 01:51:49PM	DATE -	REVIS	REVIS			CONTRACT NO. 72C92					

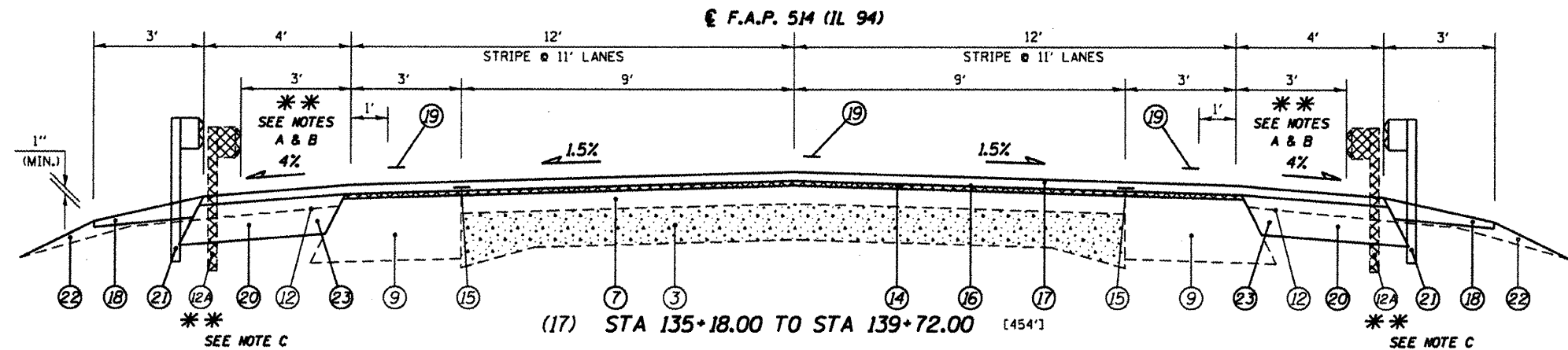
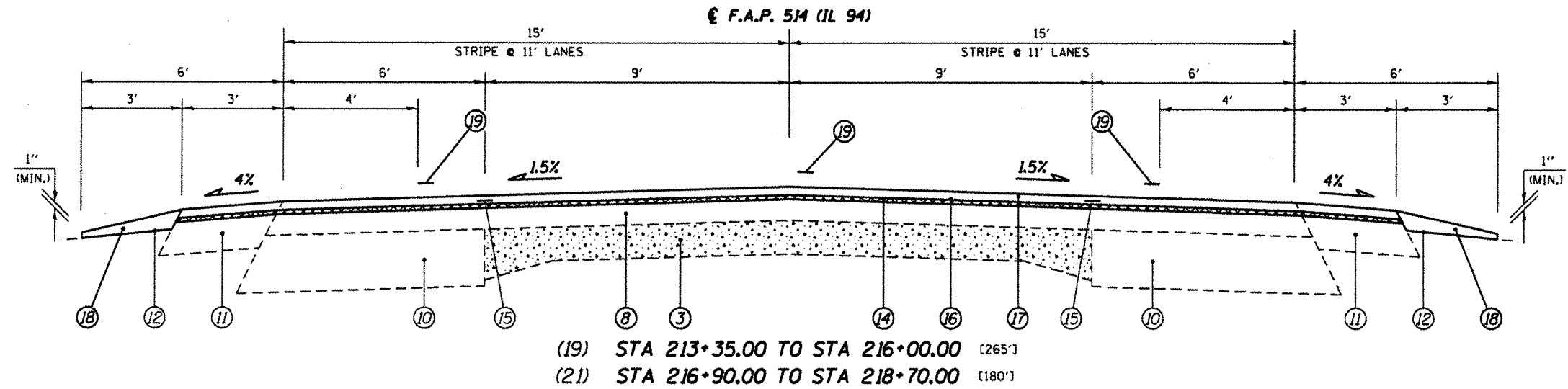

LEGEND

- | | |
|---|--|
| ① EXISTING BITUMINOUS BASE COURSE 9" | ⑬ PROPOSED HOT-MIX ASPHALT SURFACE REMOVAL. 1 1/2" |
| ② EXISTING P.C.C. PAVEMENT 6" | ⑭ PROPOSED HOT-MIX ASPHALT SURFACE REMOVAL. (VARIABLE DEPTH) * |
| ③ EXISTING P.C.C. PAVEMENT 9"-6"-9" | ⑮ PROPOSED STRIP REFLECTIVE CRACK CONTROL TREATMENT |
| ④ EXISTING P.C.C. PAVEMENT 9" | ⑯ PROPOSED LEVELING BINDER (MACHINE METHOD), N50 3/4" |
| ⑤ EXISTING BITUMINOUS OVERLAY 6" | ⑰ PROPOSED HOT-MIX ASPHALT SURFACE COURSE. MIX "C", N50 1-1/2" |
| ⑥ EXISTING BITUMINOUS OVERLAY 6 3/4" | ⑱ PROPOSED AGGREGATE SHOULDERS, TYPE B |
| ⑦ EXISTING BITUMINOUS OVERLAY 3 3/4" | ⑲ PROPOSED PAINT PAVEMENT MARKING - LINE 5" |
| ⑧ EXISTING BITUMINOUS OVERLAY 4 1/2" | ⑳ PROPOSED HOT-MIX ASPHALT SHOULDERS, 6 1/2" |
| ⑨ EXISTING BITUMINOUS CONCRETE BASE COURSE WIDENING 9" | ㉑ PROPOSED STEEL PLATE BEAM GUARDRAIL, 6' POSTS |
| ⑩ EXISTING BITUMINOUS CONCRETE BASE COURSE WIDENING 10" | ㉒ PROPOSED FURNISHED EXCAVATION |
| ⑪ EXISTING BITUMINOUS SHOULDERS 8" | ㉓ PROPOSED EXCAVATING AND GRADING EXISTING SHOULDERS |
| ⑫ EXISTING AGGREGATE SHOULDERS, TYPE B | |
| ⑫A EXISTING STEEL PLATE BEAM GUARDRAIL (TBR) | |

**** NOTES:**

- (A) PROPOSED H.M.A. SHOULDERS & 3' AGG. SHOULDERS BEGIN AT STA. 136+56.00 LT.
 (B) PROPOSED H.M.A. SHOULDERS & 3' AGG. SHOULDERS END AT STA. 138+67.00 RT.
 (C) EXISTING GUARDRAIL REMOVAL FROM STA. 136+41.00 RT. TO STA. 137+91.00 RT. & STA. 136+90.00 LT. TO STA. 138+40.00 LT.

FILE NAME *	USER NAME * oax_jw	DESIGNED - JWC	REVISED -	STATE OF ILLINOIS DEPARTMENT OF TRANSPORTATION	TYPICAL SECTIONS		F.A.P. RTE. 514	SECTION 106RS-6	COUNTY HANCOCK	TOTAL SHEETS 26	SHEET NO. 14	
ca:\pw-work\p1\dot\oax_jw\2221152\0672C92.sht	sh:typical.dgn	DRAWN - JWC	REVISED -		SCALE: NTS	SHEET 4 OF 4 SHEETS	STA. 213+35.00 TO STA. 218+65.00	CONTRACT NO. 72C92				
PLOT SCALE * 1/8" = 1' / in.		CHECKED - MSD	REVISED -		ILLINOIS FED. AID PROJECT							
PLOT DATE * Feb-15-2012 09:07:55AM		DATE -	REVISED -									

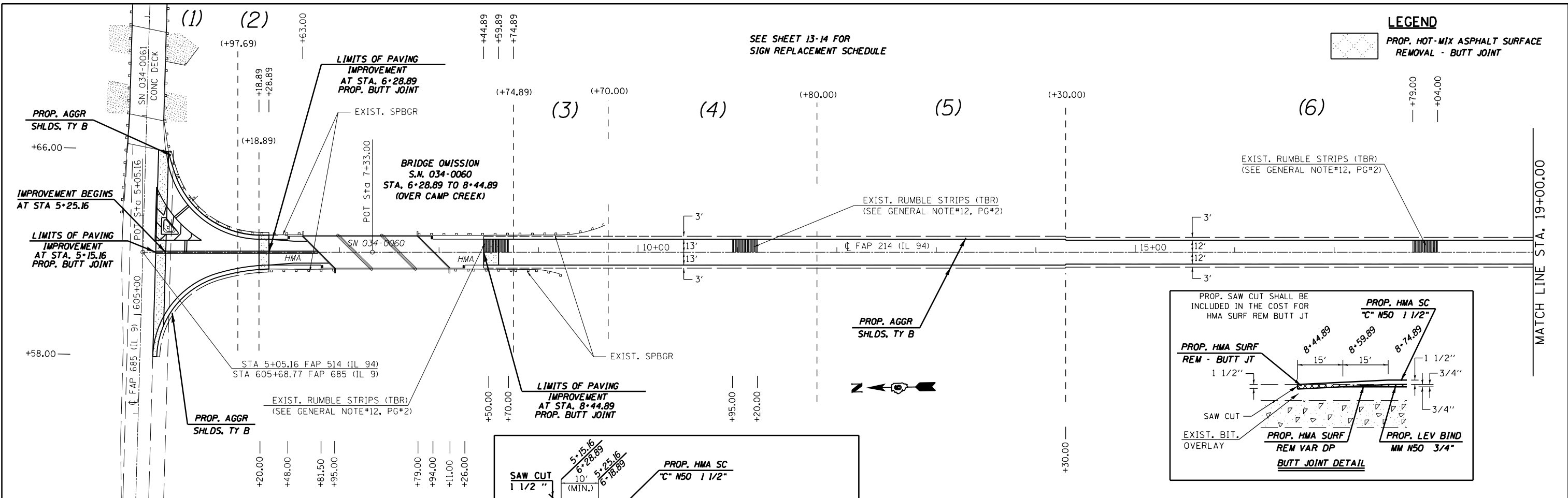

LEGEND

 PROP. HOT-MIX ASPHALT SURFACE REMOVAL - BUTT JOINT

SEE SHEET 13-14 FOR SIGN REPLACEMENT SCHEDULE

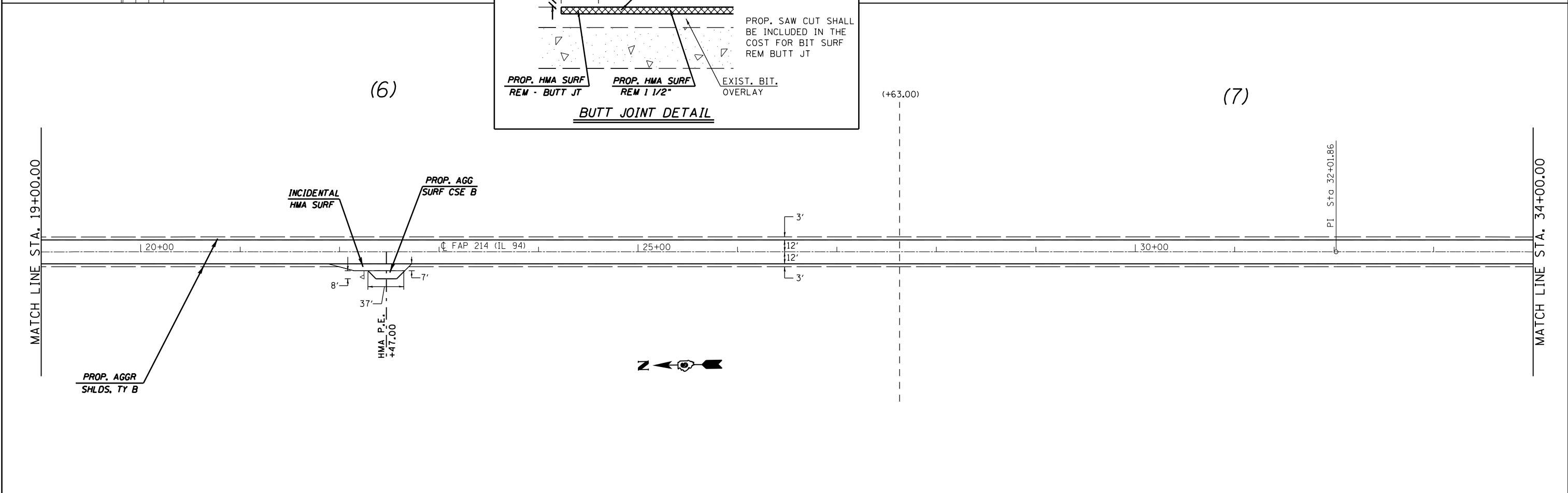
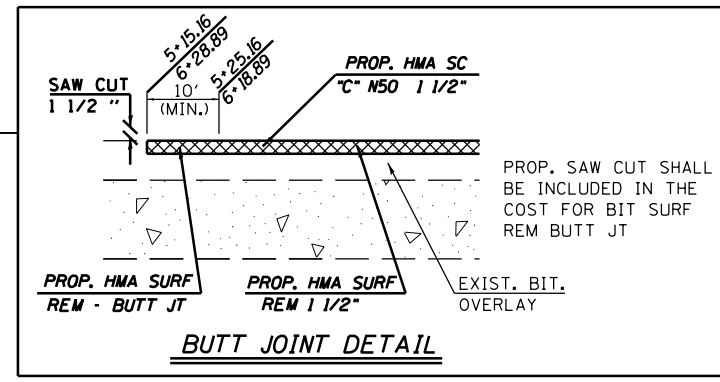
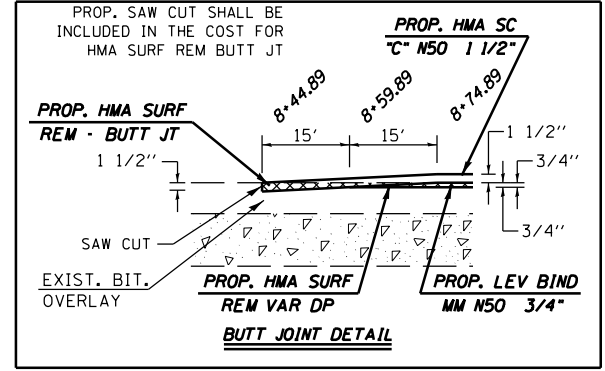

FILE NAME =	USER NAME = sparksgw	DESIGNED - JWC	REVISED -	STATE OF ILLINOIS DEPARTMENT OF TRANSPORTATION	PLAN SHEETS			F.A.P. RTE.	SECTION	COUNTY	TOTAL SHEETS	SHEET NO.
ei:\pw\work\p1d0t\sparksgw\10221152\0672\c92-shr-plan.dgn		DRAWN - JWC	REVISED -		SCALE: 50	SHEET NO. 1 OF 8 SHEETS	STA. 5+15.16 TO STA. 34+00.00	514	106RS-6	HANCOCK	26	15
PLOT SCALE = 100.0000' / 1"		CHECKED - MSD	REVISED -		CONTRACT NO. 72C92							
PLOT DATE = Feb-07-2012 01:52:00PM		DATE -	REVISED -		ILLINOIS FED. AID PROJECT							

SEE SHEET 13-14 FOR
SIGN REPLACEMENT SCHEDULE

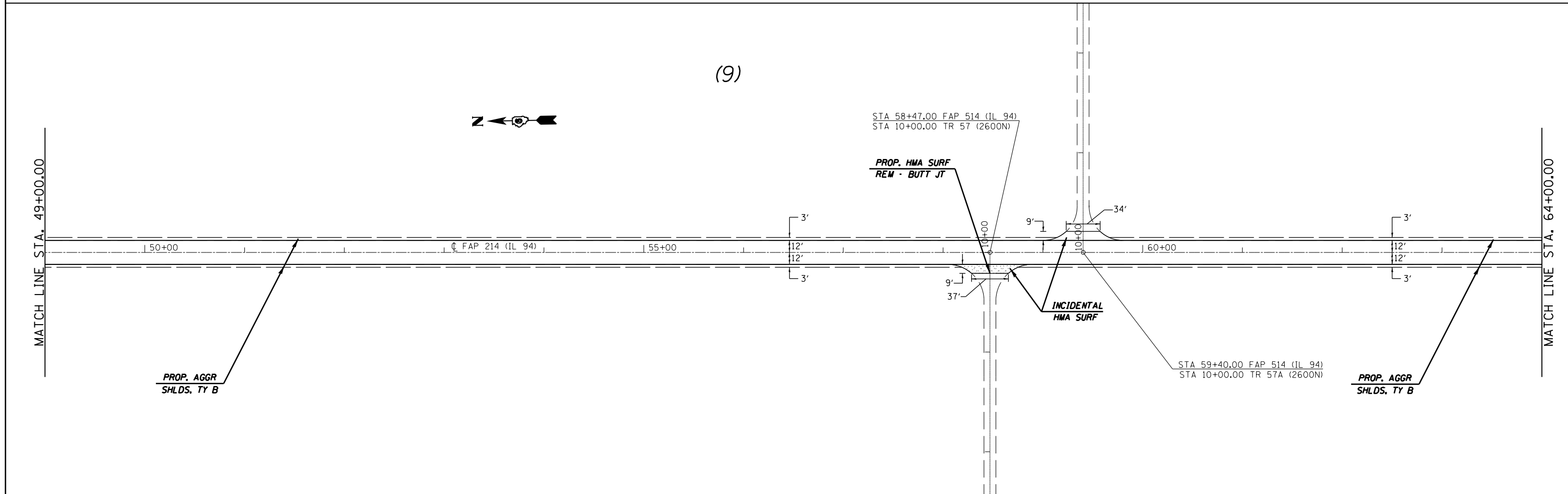
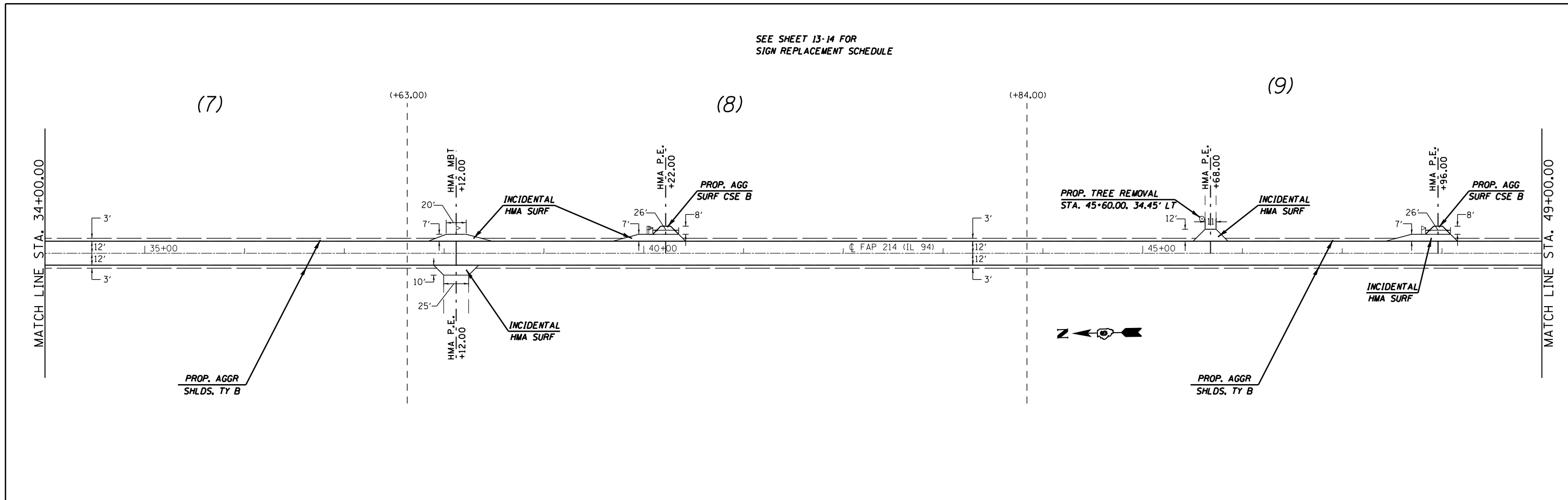

FILE NAME =	USER NAME = sparksgw	DESIGNED - JWC	REVISED -	STATE OF ILLINOIS DEPARTMENT OF TRANSPORTATION	PLAN SHEETS			F.A.P. RTE.	SECTION	COUNTY	TOTAL SHEETS	SHEET NO.	
c:\pwwork\pwwork\sparksgw\0221152\0672\c92-sht-plan.dgn		DRAWN - JWC	REVISED -		SCALE: 50	SHEET NO. 2 OF 8 SHEETS	STA. 34+00.00 TO STA. 64+00.00	514	106RS-6	HANCOCK	26	16	
		CHECKED - MSD	REVISED -										
		DATE -	REVISED -										

ILLINOIS FED. AID PROJECT

SEE SHEET 13-14 FOR
SIGN REPLACEMENT SCHEDULE

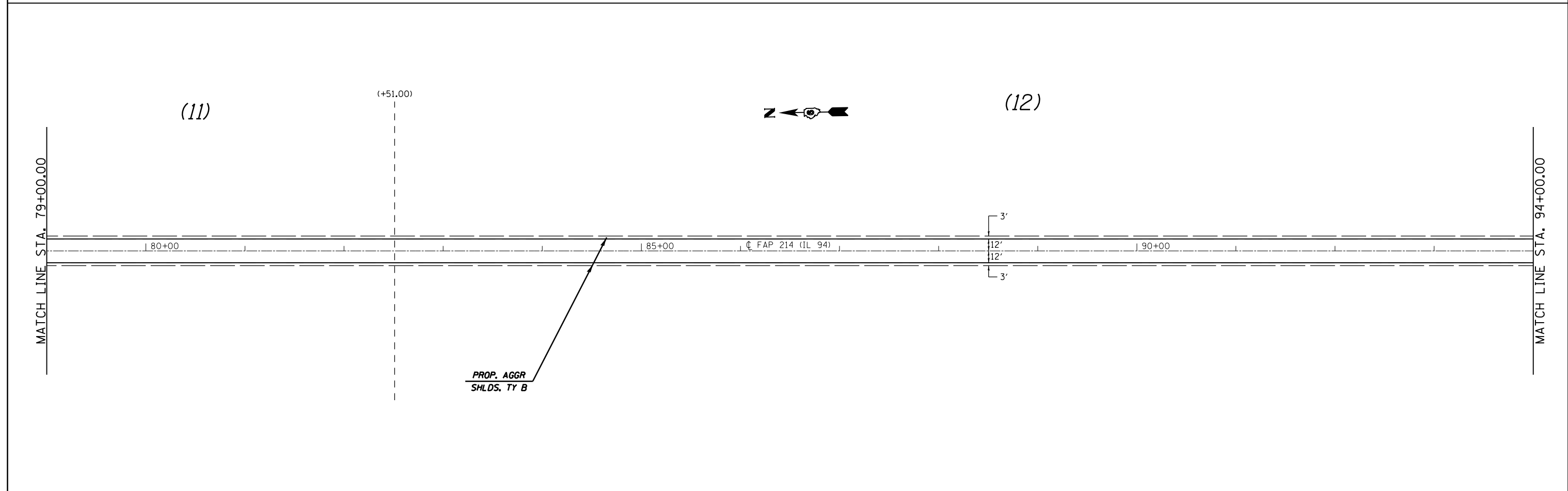
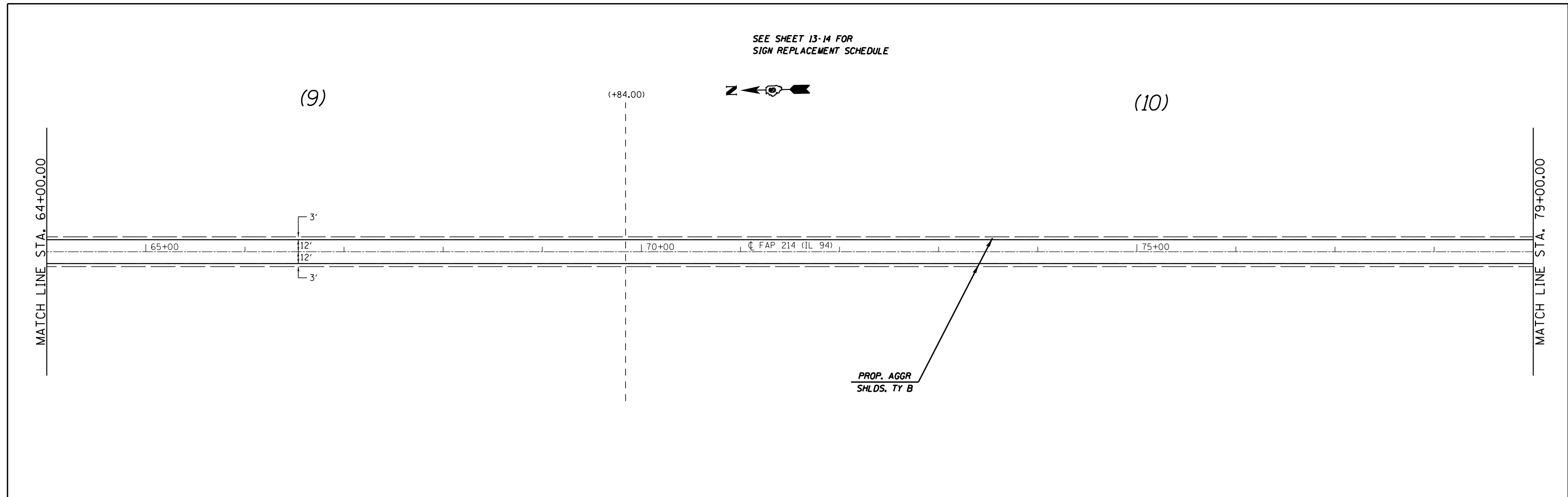

FILE NAME = c:\pwwork\pwwork\sparksgw\0221152\0672C92-sht-plan.dgn	USER NAME = sparksgw	DESIGNED - JWC	REVISED -	STATE OF ILLINOIS DEPARTMENT OF TRANSPORTATION	PLAN SHEETS			F.A.P. RTE.	SECTION	COUNTY	TOTAL SHEETS	SHEET NO.
	PLOT SCALE = 100.0000' / in.	CHECKED - MSD	REVISED -		514	106RS-6	HANCOCK	26	17			
PLOT DATE = Feb-07-2012 01:52:01PM	DATE -	REVISED -	SCALE: 50			SHEET NO. 3 OF 8 SHEETS			STA. 64+00.00 TO STA. 94+00.00			
						CONTRACT NO. 72C92			ILLINOIS FED. AID PROJECT			

SEE SHEET 13-14 FOR
SIGN REPLACEMENT SCHEDULE

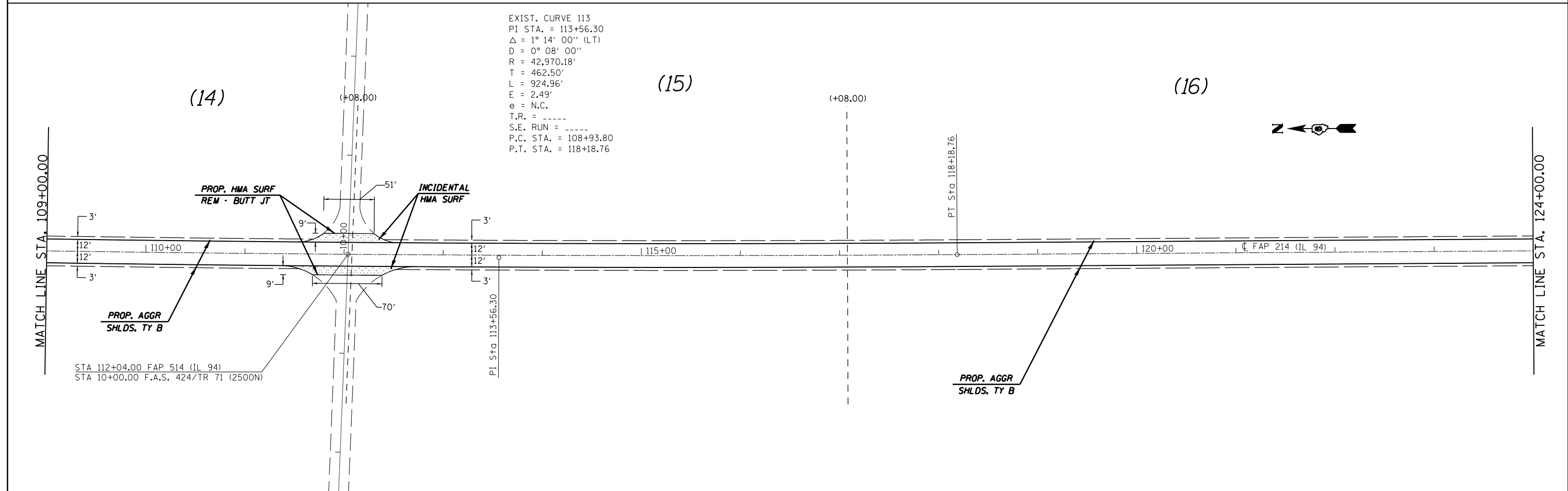
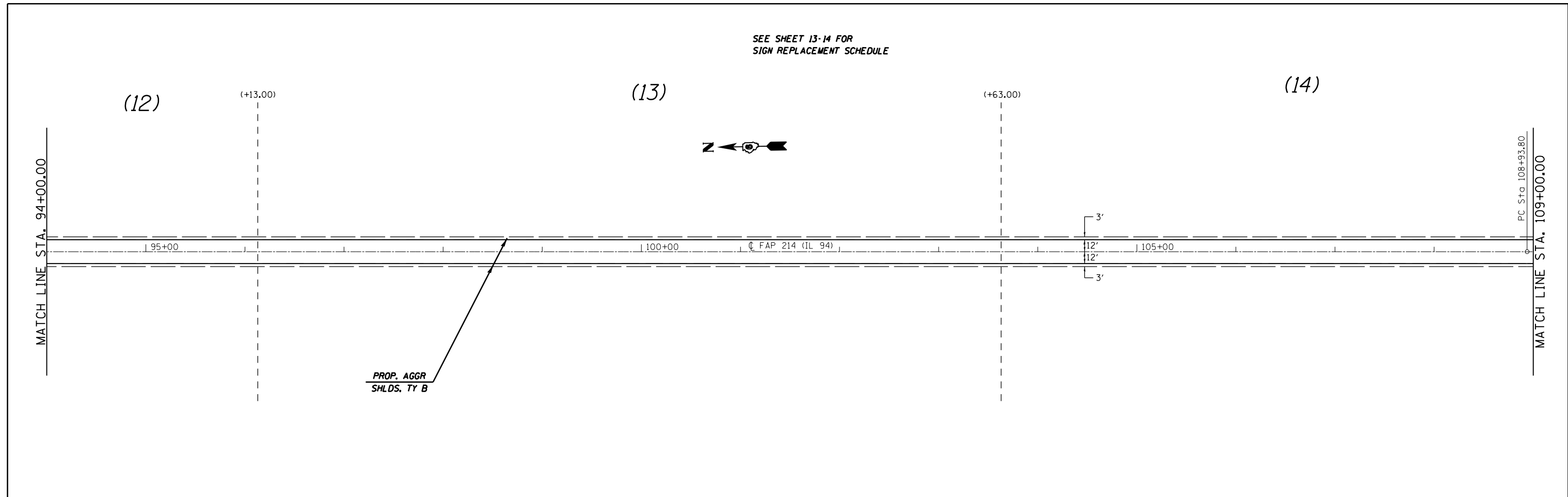

FILE NAME =	USER NAME = sparksgw	DESIGNED - JWC	REVISED -	STATE OF ILLINOIS DEPARTMENT OF TRANSPORTATION	PLAN SHEETS			F.A.P. RTE.	SECTION	COUNTY	TOTAL SHEETS	SHEET NO.
c:\pwwork\pwwork\sparksgw\10221152\0672	C92-sht-plan.dgn	DRAWN - JWC	REVISED -		SCALE: 50	SHEET NO. 4 OF 8 SHEETS	STA. 94+00.00 TO STA. 124+00.00	514	106RS-6	HANCOCK	26	18
	PLOT SCALE = 100.0000' / 1" =	CHECKED - MSD	REVISED -					CONTRACT NO. 72C92				
	PLOT DATE = Feb-07-2012 01:52:02PM	DATE -	REVISED -					ILLINOIS FED. AID PROJECT				

SEE SHEET 13-M FOR
SIGN REPLACEMENT SCHEDULE

(16) NOTE: EX. AGG SHOULDER TO BE REMOVED FROM STA. 136+51.24 TO STA. 139+75.77 (NORTH BOUND)
FROM STA. 135+14.23 TO STA. 138+70.77 (SOUTH BOUND)
NOTE: EX. GUARDRAIL TO BE REMOVED FROM STA. 136+90.00 TO STA. 138+40.00 (NORTH BOUND)
FROM STA. 136+41.00 TO STA. 139+01.00 (SOUTH BOUND)

(17) +56.00
+81.00
+15.00

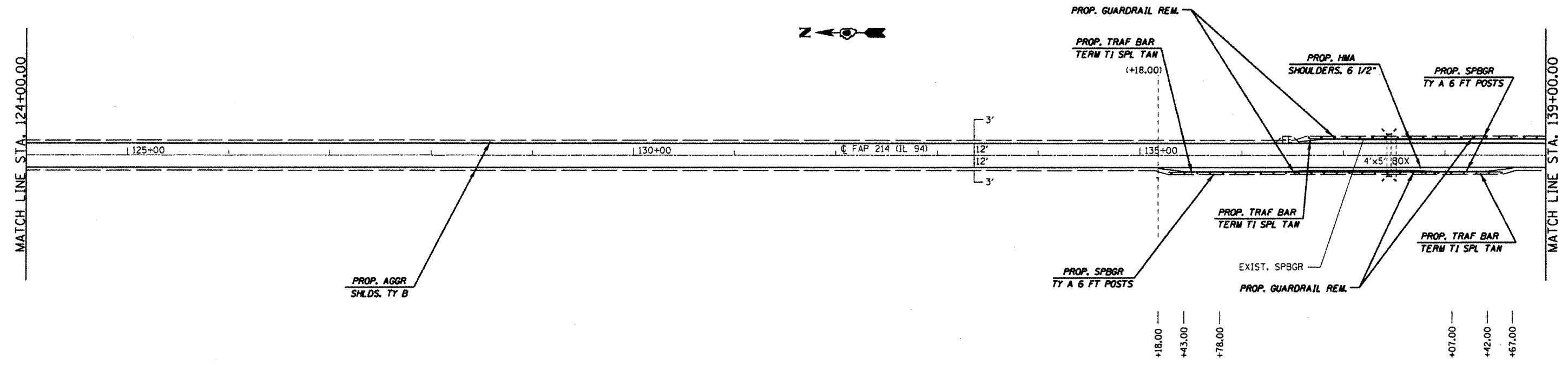

(17) +12.00
+47.00
+72.00

(18)

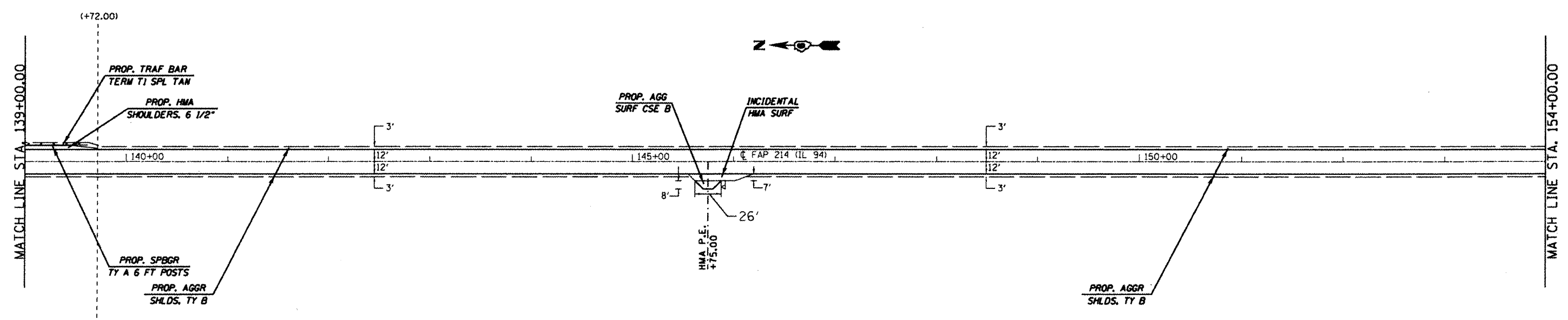

FILE NAME =	USER NAME = coxje	DESIGNED - JWC	REVISED -
ca:\pwwork\periodot\coxje\18221152\067205	http:plan.dgn	DRAWN - JWC	REVISED -
PLOT SCALE = 1/8\"/>			

STATE OF ILLINOIS
DEPARTMENT OF TRANSPORTATION

PLAN SHEETS
SCALE: 50 SHEET NO. 5 OF 8 SHEETS STA. 124+00.00 TO STA. 154+00.00

F.A.P. RTE.	SECTION	COUNTY	TOTAL SHEETS	SHEET NO.
514	106RS-6	HANCOCK	26	19
CONTRACT NO. T2C92			ILLINOIS FED. AID PROJECT	

SEE SHEET 13-14 FOR
SIGN REPLACEMENT SCHEDULE

(18)

STA 165+70.00 FAP 514 (IL 94)
STA 10+00.00 TR 83 (2400N)

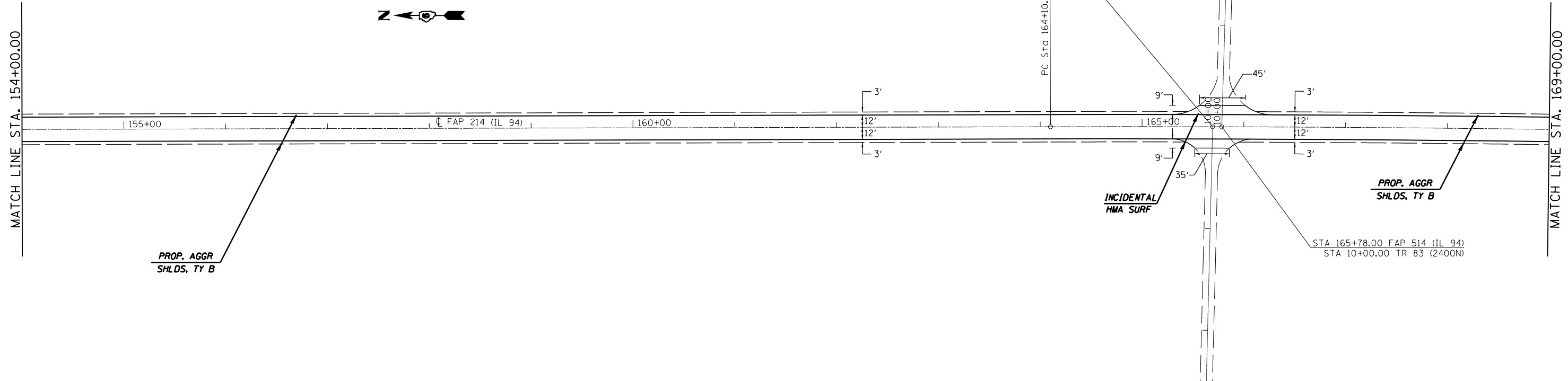

EXIST. CURVE 169
PI STA. = 169+28.26
 $\Delta = 1^\circ 54' 00''$ (RT)
D = $0^\circ 11' 00''$
R = 31,248.06'
T = 518.16'
L = 1,036.23'
E = 4.30'
e = N.C.
T.R. = -----
S.E. RUN = -----
P.C. STA. = 164+10.10
P.T. STA. = 174+46.33

(18)

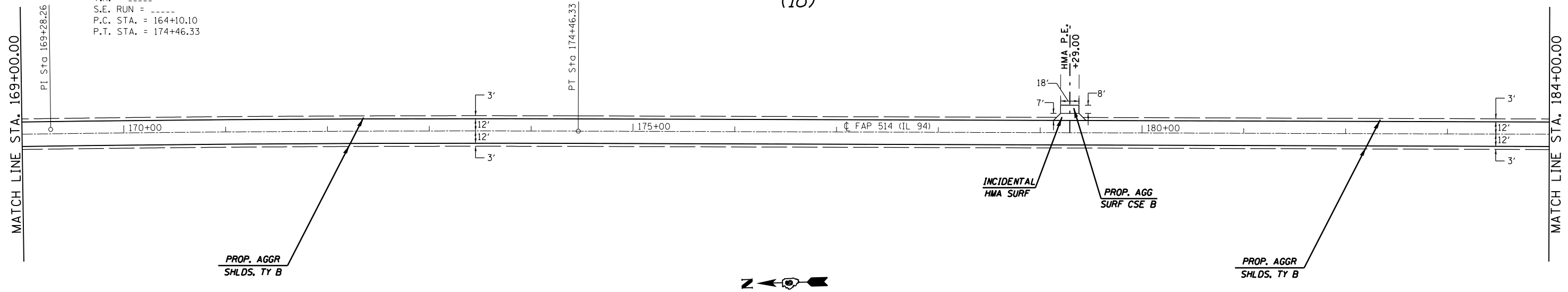

FILE NAME =	USER NAME = sparksgw	DESIGNED - JWC	REVISED -
ei:\pwwork\pwwidot\sparksgw\10221152\0672\C92-shr-plan.dgn		DRAWN - JWC	REVISED -
		CHECKED - MSD	REVISED -
		DATE -	REVISED -

STATE OF ILLINOIS
DEPARTMENT OF TRANSPORTATION

PLAN SHEETS

SCALE: 50 SHEET NO. 6 OF 8 SHEETS STA. 154+00.00 TO STA. 184+00.00

F.A.P. RTE.	SECTION	COUNTY	TOTAL SHEETS	SHEET NO.
514	106RS-6	HANCOCK	26	20
CONTRACT NO. 72C92			ILLINOIS FED. AID PROJECT	

SEE SHEET 13-14 FOR
SIGN REPLACEMENT SCHEDULE

(18)

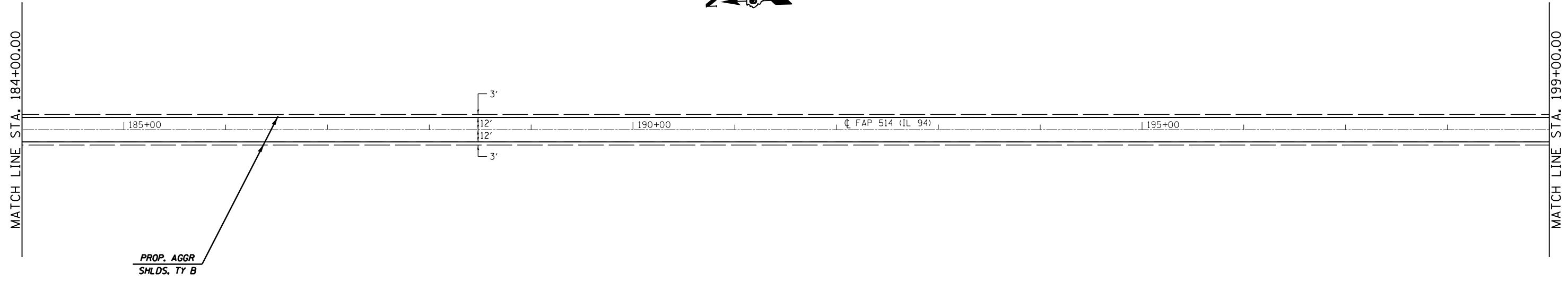

(18)

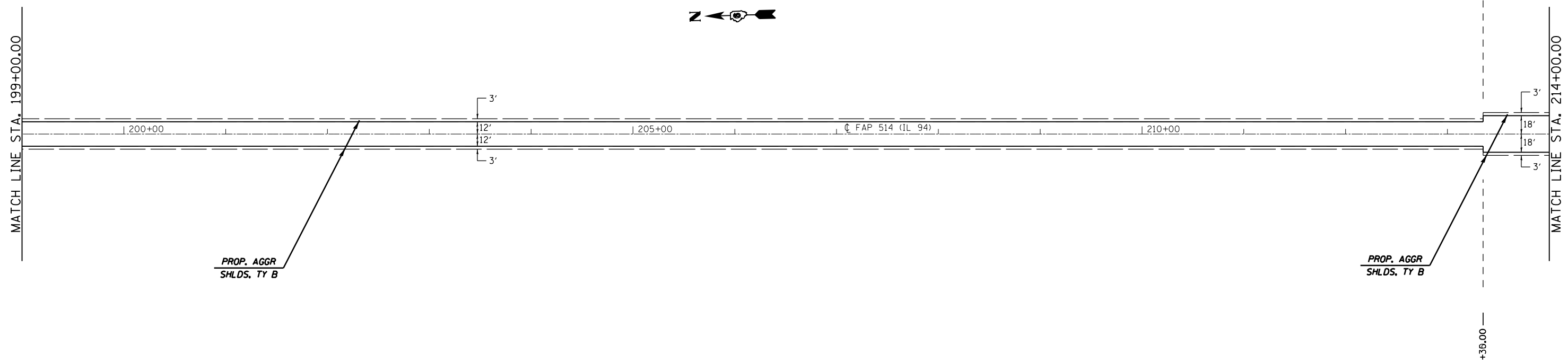

FILE NAME =	USER NAME = sparksgw	DESIGNED - JWC	REVISED -
c:\pwwork\pwwork\sparksgw\0221152\0672\c92-sht-plan.dgn		DRAWN - JWC	REVISED -
	PLOT SCALE = 100.0000' / 1" =	CHECKED - MSD	REVISED -
	PLOT DATE = Feb-07-2012 01:52:03PM	DATE -	REVISED -

STATE OF ILLINOIS
DEPARTMENT OF TRANSPORTATION

PLAN SHEETS

SCALE: 50 SHEET NO. 7 OF 8 SHEETS STA. 184+00.00 TO STA. 214+00.00

F.A.P. RTE.	SECTION	COUNTY	TOTAL SHEETS	SHEET NO.
514	106RS-6	HANCOCK	26	21
CONTRACT NO. 72C92			ILLINOIS FED. AID PROJECT	

(19)

(21)

+70.00
+85.00
+00.00

SEE SHEET 13-14 FOR
SIGN REPLACEMENT SCHEDULE

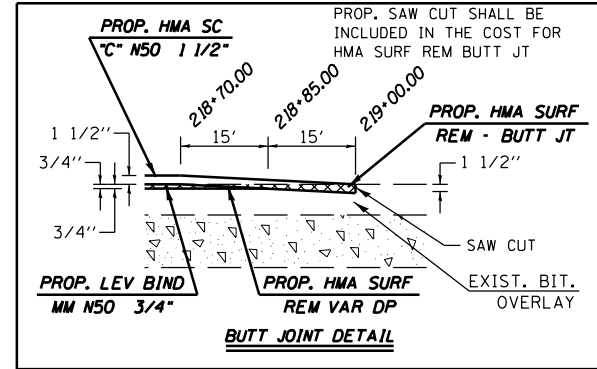

MATCH LINE STA. 214+00.00

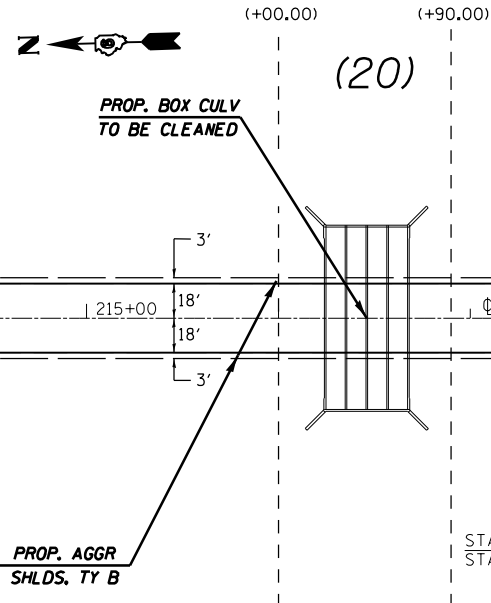

LIMITS OF PAVING
IMPROVEMENT
AT STA. 219+00.00
PROP. BUTT JOINT

STA 219+29.00 FAP 514 (IL 94)
STA 10+00.00 (POWELLTON RD.)

SIGN REPLACEMENT CONTINUES
TO STA. 320+55.00

STA 219+37.00 FAP 514 (IL 94)
STA 10+00.00 (POWELLTON RD.)

(OVER GROVE CREEK)
S.N. 034-2009
@ STA. 216+46.00
4-10'X10' LENGTH 44'

FILE NAME =	USER NAME = sparksgw	DESIGNED - JWC	REVISED -
c:\pw\work\p1dot\sparksgw\0221152\0672	C92-shr-plan.dgn	DRAWN - JWC	REVISED -
	PLOT SCALE = 100.0000' / in.	CHECKED - MSD	REVISED -
	PLOT DATE = Feb-07-2012 01:52:04PM	DATE -	REVISED -

STATE OF ILLINOIS
DEPARTMENT OF TRANSPORTATION

PLAN SHEETS

SCALE: 50 SHEET NO. 8 OF 8 SHEETS STA. 214+00.00 TO STA. 220+00.00

F.A.P. RTE.	SECTION	COUNTY	TOTAL SHEETS	SHEET NO.
514	106RS-6	HANCOCK	26	22
CONTRACT NO. 72C92			ILLINOIS FED. AID PROJECT	

PAVEMENT MARKING LEGEND

(PAINT)

- (A) PAVEMENT MARKING - LINE - 5" WHITE (SOLID)
- (B) PAVEMENT MARKING - LINE - 5" DOUBLE YELLOW (SOLID)

(PREFORMED PLASTIC, TYPE B - INLAID -)

- (C) PAVEMENT MARKING - LINE - 8" WHITE (SOLID)
- (D) PAVEMENT MARKING - LINE - 12" WHITE (SOLID)
- (E) PAVEMENT MARKING - LINE - 24" WHITE (SOLID)

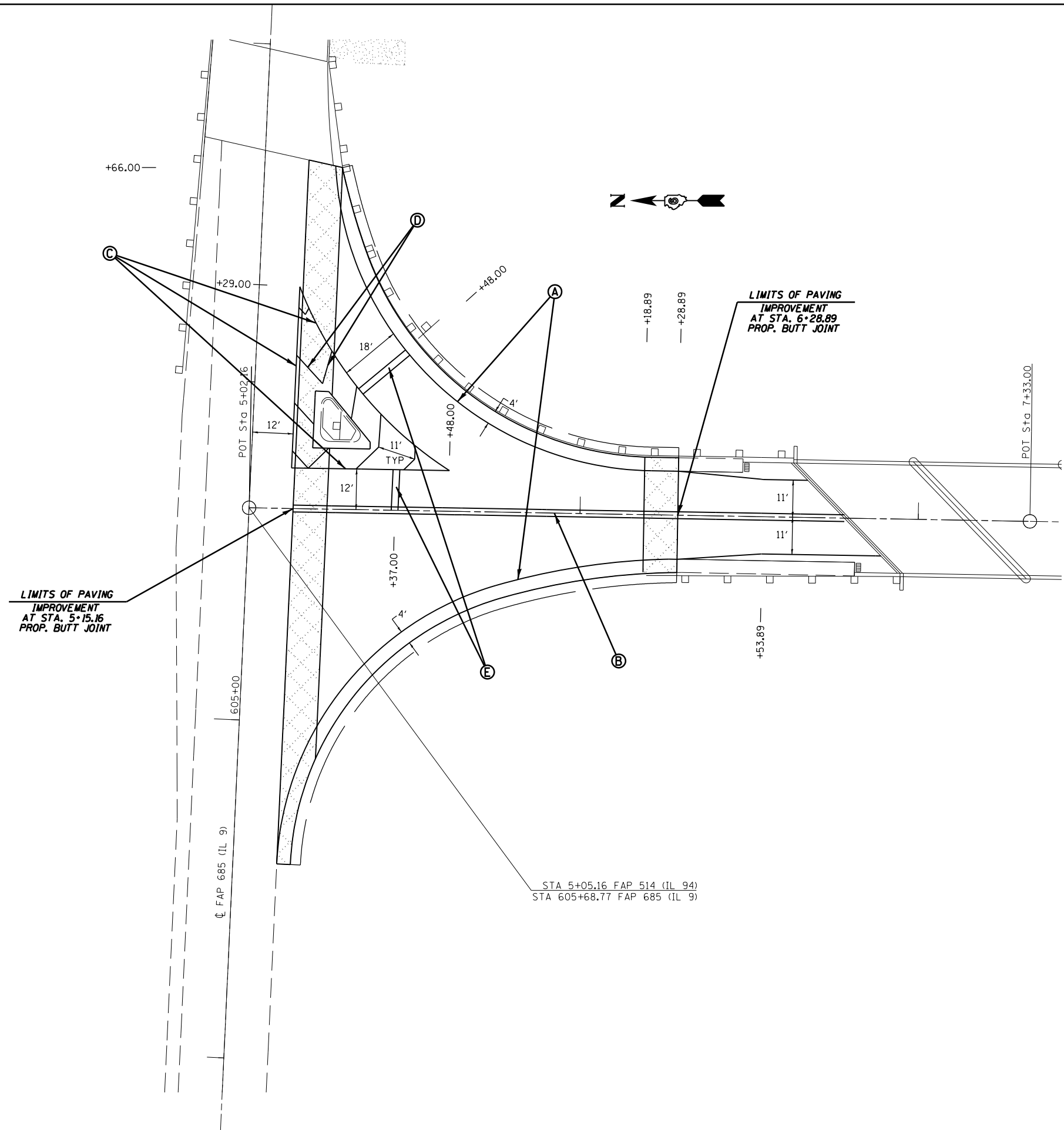

FILE NAME =	USER NAME = sparksgw	DESIGNED - JWC	REVISED -
c:\pwork\work\pwork\sparksgw\0221152\d672	C92-sht-pmk.dgn	DRAWN - JWC	REVISED -
	PLOT SCALE = 100.0000' / in.	CHECKED - MSD	REVISED -
	PLOT DATE = Feb-07-2012 01:52:10PM	DATE -	REVISED -

**STATE OF ILLINOIS
DEPARTMENT OF TRANSPORTATION**

PAVEMENT MARKING SHEET

SCALE: 50 SHEET 1 OF 1 SHEETS STA. TO STA.

F.A.P. RTE.	SECTION	COUNTY	TOTAL SHEETS	SHEET NO.
514	106R5-6	HANCOCK	26	23
CONTRACT NO.			72C92	
ILLINOIS FED. AID PROJECT				

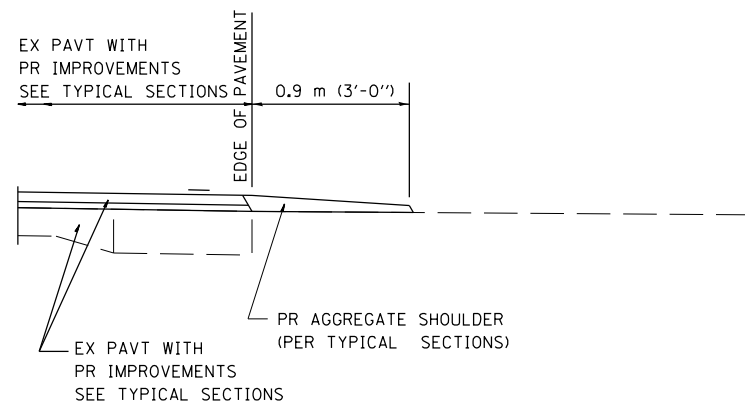

SECTION A-A FOR EX EARTH/ AGGREGATE FE

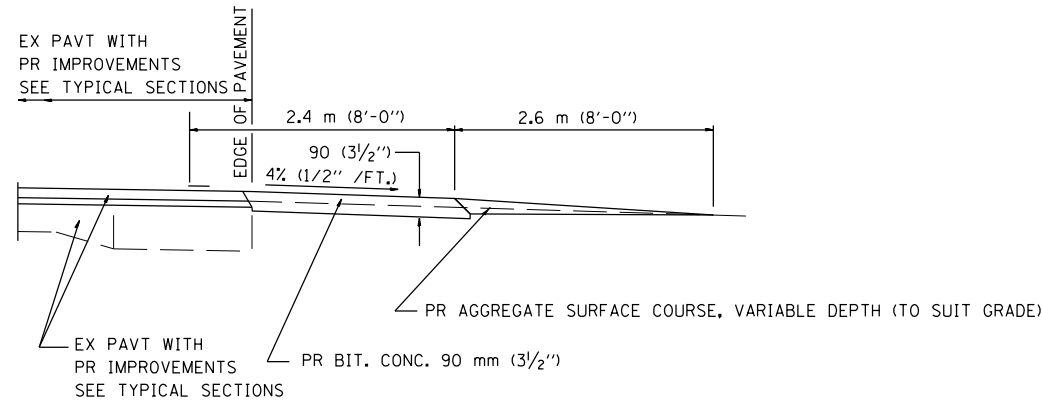

SECTION A-A FOR EX EARTH/AGGREGATE PE

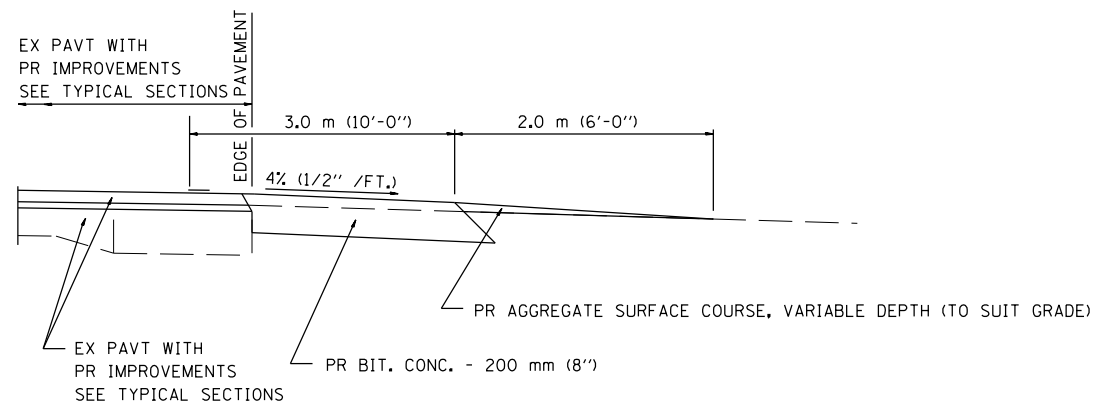

SECTION A-A FOR EX EARTH/AGGREGATE CE & SIDE ROAD

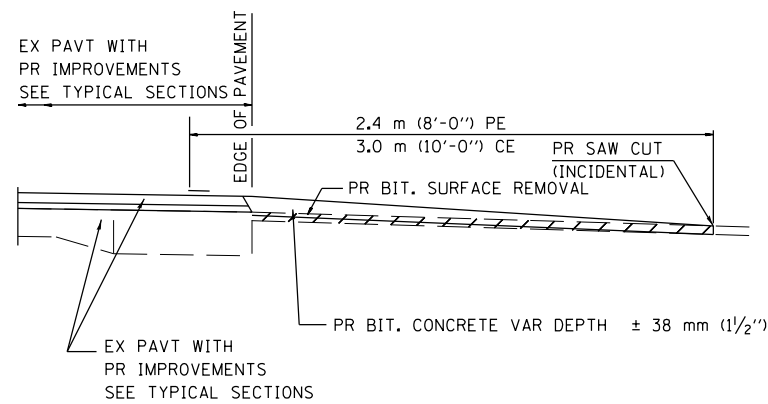

SECTION A-A FOR EX BITUMINOUS/ PC CONCRETE PE, CE & SIDE ROAD

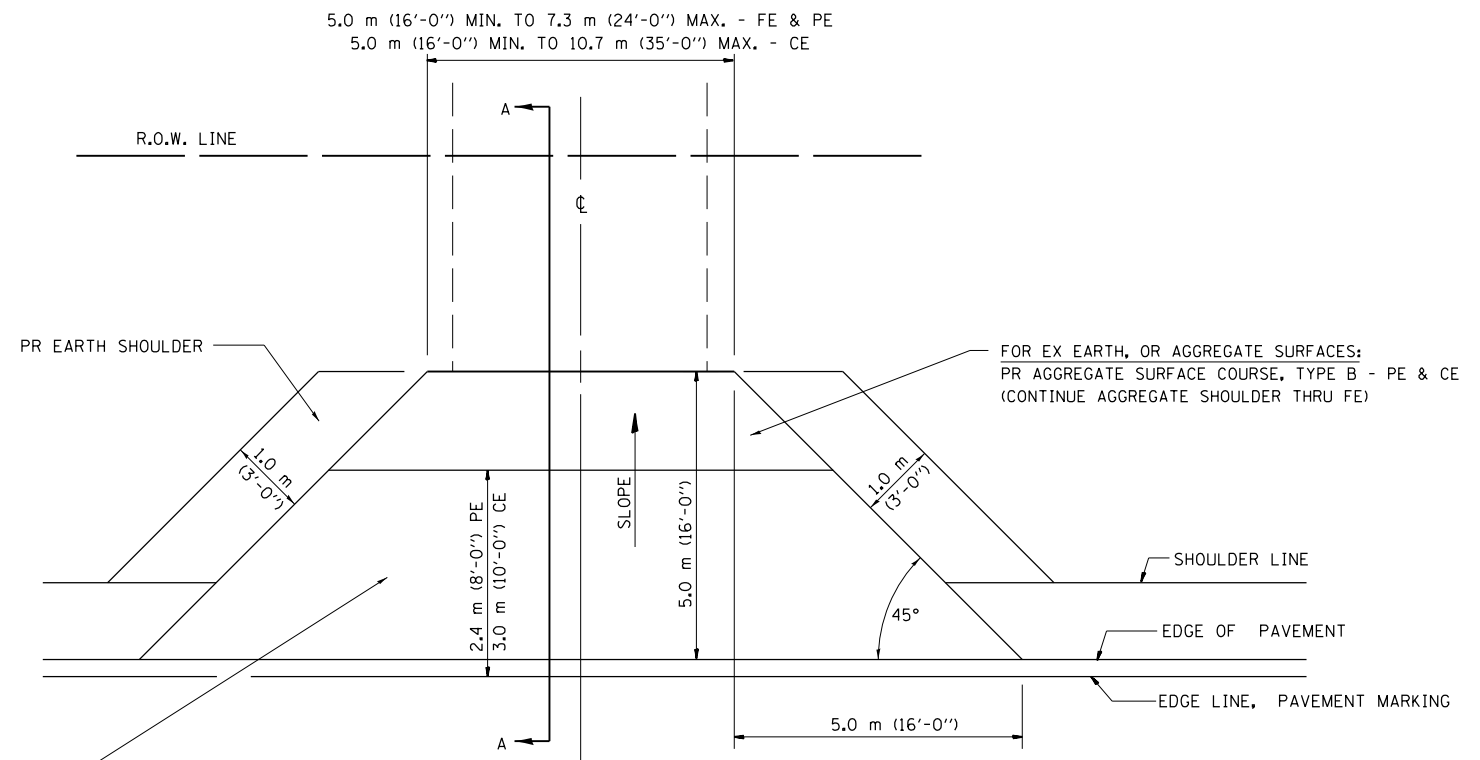

FOR EX EARTH OR AGGREGATE SURFACES:
 PR BIT SURFACE REMOVAL (IF APPLICABLE)
 PR AGGREGATE SHOULDER THRU - FE
 PR BITUMINOUS CONCRETE 90 mm (3 1/2") - PE
 PR BITUMINOUS CONCRETE 200mm (8") - CE

FOR BITUMINOUS OR P.C. CONCRETE SURFACES:
 PR BITUMINOUS SURFACE REMOVAL, VARIABLE DEPTH

GENERAL NOTES:

THE RESIDENT ENGINEER WILL DETERMINE THE EXACT TYPE OF IMPROVEMENT TO BE COMPLETED FOR ALL ENTRANCES, SIDEROADS AND MAILBOX TURNOUTS ON THIS PROJECT.

THE PLAN DETAILS AND SCHEDULES SHOULD BE USED AS A GUIDE FOR THE ENGINEER TO IMPLEMENT THE FINAL DESIGN. THE ENGINEER MAY DECIDE TO SALVAGE PORTIONS OF THE EXISTING ENTRANCE PAVEMENT STRUCTURE; THEREFORE, REDUCING PAY ITEM QUANTITIES. NO ADDITIONAL PAYMENT WILL BE ALLOWED FOR THIS REDUCTION IN QUANTITIES.

ANY WORK THE ENGINEER REQUIRES WHICH IS NOT COVERED BY A PAY ITEM CONTAINED IN THE PLANS WILL BE PAID FOR IN ACCORDANCE WITH ARTICLE 109.04 OF THE STANDARD SPECIFICATIONS.

BITUMINOUS CONCRETE REQUIRED TO CONSTRUCT THE ENTRANCES SHALL BE IN ACCORDANCE WITH THE APPLICABLE PORTIONS OF SECTION 406 AND 408 OF THE STANDARD SPECIFICATIONS AND AS DIRECTED BY THE ENGINEER.

WHEN THE BITUMINOUS CONCRETE PROPOSED FOR THE IMPROVEMENT IS THICKER THAN 75 mm (3 INCHES) AND REQUIRE PLACEMENT IN MORE THAN ONE LIFT. THE BOTTOM LIFT(S) SHALL MEET THE REQUIREMENTS OF BITUMINOUS BASE COURSE IN SECTION 406 OF THE STANDARD SPECIFICATIONS AND THE TOP LIFT OF 50 mm (2 INCHES) SHALL MEET THE REQUIREMENTS OF BITUMINOUS CONCRETE SURFACE COURSE, MIXTURE C, CLASS I, TYPE 2 OF SECTION 406 OF THE STANDARD SPECIFICATIONS.

THIS WORK WILL BE PAID FOR AT THE CONTRACT UNIT PRICE PER METRIC TON (TON) FOR "INCIDENTAL BITUMINOUS SURFACING" WHICH SHALL INCLUDE ALL MATERIALS, EQUIPMENT, AND LABOR INVOLVED.

ALL DIMENSIONS ARE IN MILLIMETERS (INCHES) UNLESS OTHERWISE SHOWN.

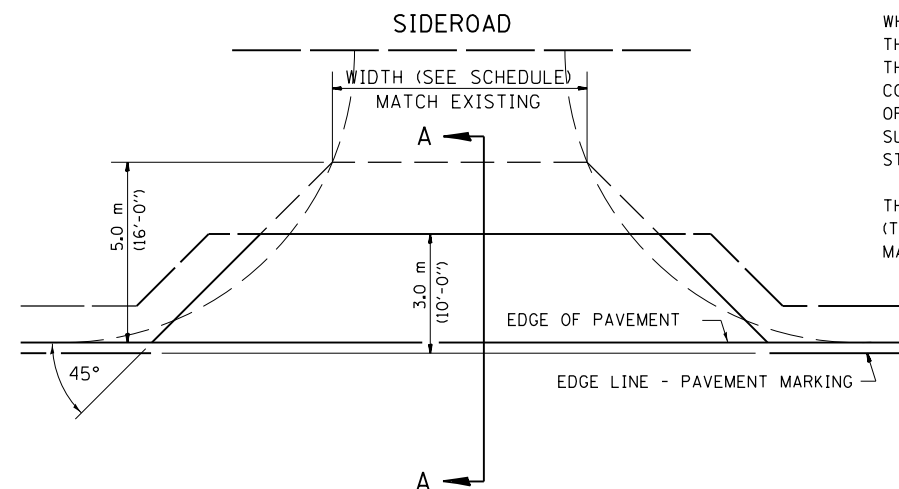

FILE NAME =	USER NAME = sparksgw	DESIGNED -	REVISED -
c:\pwork\pwork\sparksgw\0221152\0672\092-sht-details.dgn		DRAWN -	REVISED -
		CHECKED -	REVISED -
		DATE -	REVISED -

STATE OF ILLINOIS
 DEPARTMENT OF TRANSPORTATION

PPP RURAL/URBAN ENTRANCE &
 MAILBOX DETAIL W/O CONC. GUTTER

SCALE: 20 SHEET NO. 1 OF 3 SHEETS STA. TO STA.

F.A.P. RTE.	SECTION	COUNTY	TOTAL SHEETS	SHEET NO.
514	106RS-6	HANCOCK	26	24
CONTRACT NO. 72C92			ILLINOIS FED. AID PROJECT	

DETAILS OF MAILBOX TURNOUTS

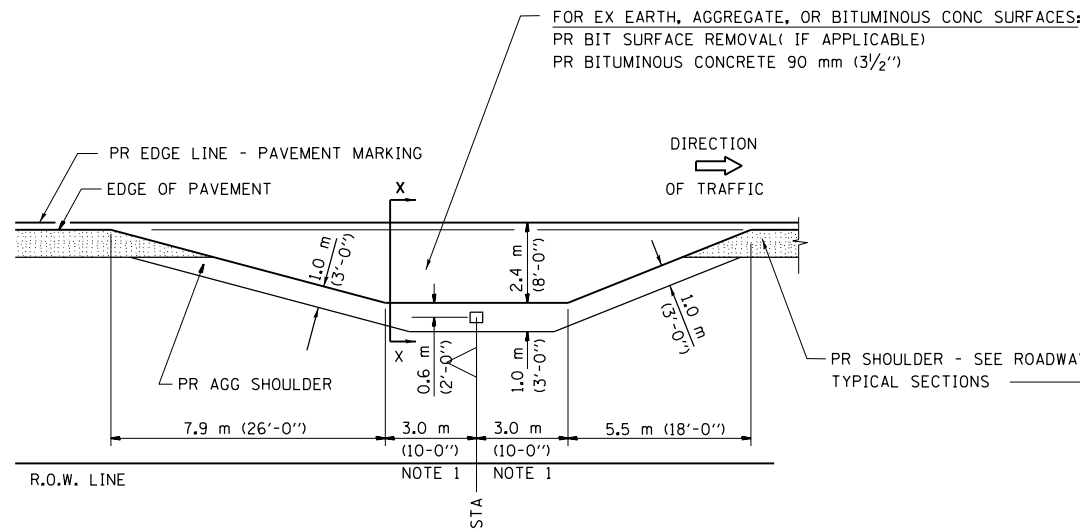

PLAN - MAILBOX TURNOUTS

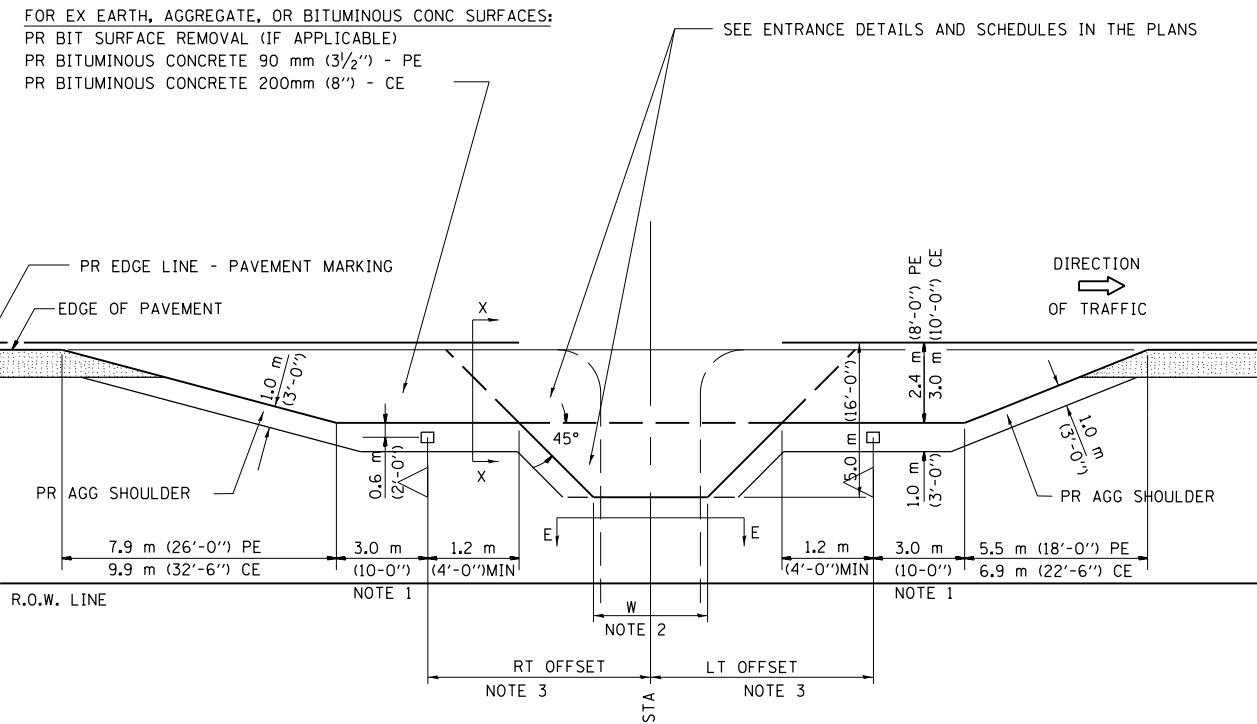

PLAN - COMBINED MAILBOX TURNOUT WITH TRAILING OR LEADING ENTRANCE

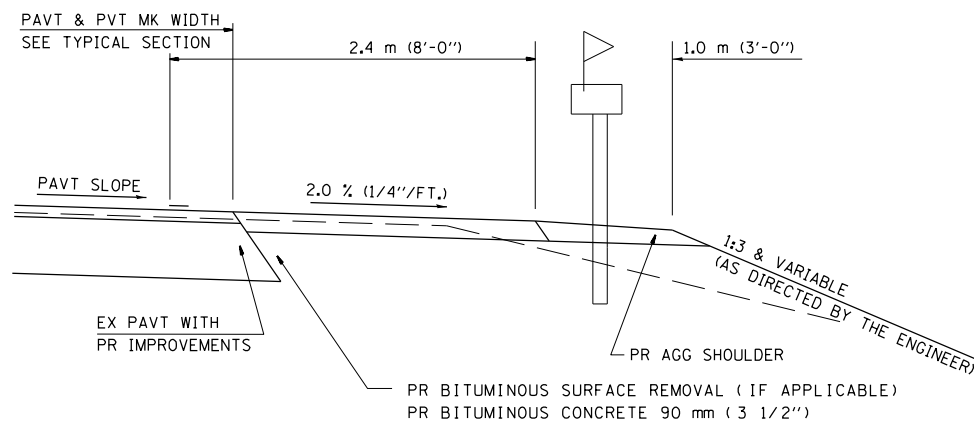

SECTION X-X THRU MAILBOX TURNOUT
 ALSO APPLIES TO MAILBOX TURNOUTS COMBINED WITH
 EX EARTH, AGGREGATE, OR BITUMINOUS PE & FE

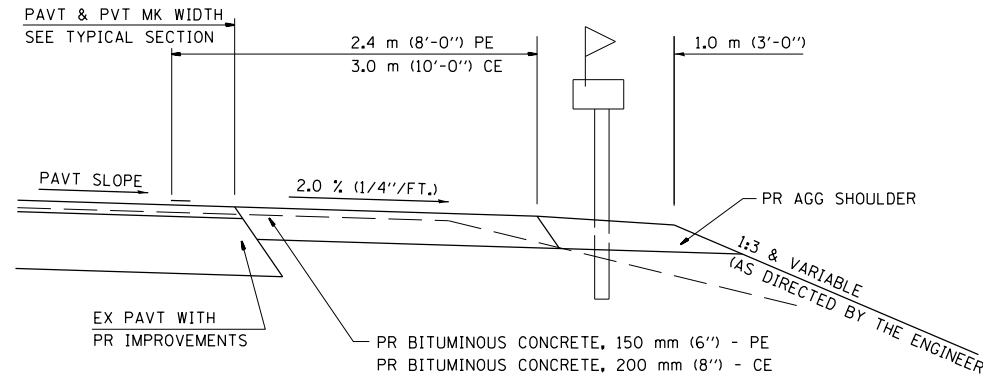

SECTION X-X THRU MAILBOX TURNOUT
 COMBINED WITH EX BITUMINOUS CONC & PC CONC PE & CE

- NOTE 1 IF MORE THAN ONE MAILBOX IS PRESENT, DIMENSION FROM CENTER OF END MAILBOX.
- NOTE 2 FOR ENTRANCE LAYOUT DIMENSIONS AND SECTIONS A-A & E-E REFER TO THE SCHEDULES IN THE PLANS.
- NOTE 3 BOTH LT OR RT OFFSETS FOR MAILBOX SHOWN USE OFFSET DIMENSION PER SCHEDULE AND REFER TO LAYOUT SHOWN ON THE PLAN.

ALL DIMENSIONS ARE IN MILLIMETERS (INCHES)
 UNLESS OTHERWISE SHOWN.

FILE NAME =	USER NAME = sparksgw	DESIGNED -	REVISED -	STATE OF ILLINOIS DEPARTMENT OF TRANSPORTATION	PPP RURAL/URBAN ENTRANCE & MAILBOX DETAIL W/O CONC. GUTTER	F.A.P. RTE.	SECTION	COUNTY	TOTAL SHEETS	SHEET NO.
c:\pwork\pwork\sparksgw\0221152\0672\c92-sht-details.dgn		DRAWN -	REVISED -			514	106RS-6	HANCOCK	26	25
PLOT SCALE = 40.0000 ' / in.		CHECKED -	REVISED -			CONTRACT NO. 72C92				
PLOT DATE = Feb-07-2012 01:52:24PM		DATE -	REVISED -			ILLINOIS FED. AID PROJECT				
					SCALE: 20	SHEET NO. 2 OF 3 SHEETS		STA.	TO STA.	

INCIDENTAL HMA SURFACING

ENTRANCE & SIDE ROAD SCHEDULE

TYP SEC #	DESCRIPTION	STATION	EXIST. ENTR.	FROM E. O. P. (FOOT)	WIDTH (FOOT)	THICKNESS (INCH)	PREP. OF BASE (SQ YD)	HMA / (EX. AGGR.)		HMA / (EXIST HMA)				TOTAL (TON)	Aggr. Shldr TB AREA (SQ FT)	AGG SURF CSE TB (TON)
								ENTR & SIDE RD.		ENTR.		SIDE RD.				
								AREA (SQ FT)	TOTAL (TON)	AREA (SQ FT)	TOTAL (TON)	AREA (SQ FT)	TOTAL (TON)			
	[F. A. P. 514 (IL 94)]															
1	LIMITS OF IMPROVEMENT	5+15.16														
1	SECTION BEGINS	5+25.16														
	BRIDGE OMISSION	C. L. OF BRIDGE														
	S. N. 034-0060	7+59.00														
6	HMA PE w/MBT (RT)	22+47.00 RT	AGG	7	37	8	38.22	308.00	15.33					15.33	144.00	2.47
8	HMA PE (RT)	38+12.00 RT	BIT	10	25	1.875				350.00	4.08			4.08	126.00	0.91
8	HMA MBT (no entr) (LT)	38+12.00 LT	BIT	7	20	1.875				294.00	3.43			3.43	163.71	
8	HMA PE w/MBT (LT)	40+22.00 LT	AGG	7	49	8	55.56	500.00	10.89					10.89	180.00	
9	HMA PE (LT)	45+68.00 LT	BIT	12	11	1.875				276.00	3.22			3.22	96.00	1.91
9	HMA PE w/MBT (LT)	47+96.00 LT	BIT	7	27	1.875	8.92	487.50	4.30					4.30	114.00	0.77
9	TR 57 (2600 N) RT	58+47.00 RT	BIT	21.5	17	1.875						693.38	6.77	6.77	171.00	0.95
9	TR 57 A (2600 N.) LT	59+40.00 LT	BIT	9	34	1.875						375.75	4.87	4.87	147.00	
15	FAS 424 (2500 N.) RT	112+04.00 RT	BIT	9	71	1.875						724.50	11.41	11.41	258.00	
15	TR 71 (2500 N.) LT	112+04.00 LT	BIT	9	47	1.875						495.00	7.84	7.84	186.00	
16	HMA PE w/MBT (RT)	145+75.00 RT	AGG	7	26	8	25.67	231.00	11.50					11.50	111.00	1.63
16	TR 83 (2400 N.) RT	165+70.00 RT	BIT	17.5	18	1.875						630.00	6.39	6.39	150.00	0.64
16	TR 83 (2400 N.) LT	165+78.00 LT	BIT	24	27	1.875						1,164.00	11.55	11.55	216.00	1.00
16	HMA PE (LT)	179+29.00 LT	BIT	9	13	1.875				198.00	2.31			2.31	84.00	0.65
19	SECTION ENDS	218+65.00														
19	LIMITS OF IMPROVEMENT	219+00.00														
	POWELLTON RD. RT	219+29.00 RT	BIT													
	POWELLTON RD. LT	219+37.00 LT	BIT													
Total =							128.37	1,526.50	42.02	1,118.00	13.04	4,082.63	48.83	103.89	2,146.71	10.92