

SEE SHEET 13-14 FOR
SIGN REPLACEMENT SCHEDULE

(18)

STA 165+70.00 FAP 514 (IL 94)
STA 10+00.00 TR 83 (2400N)

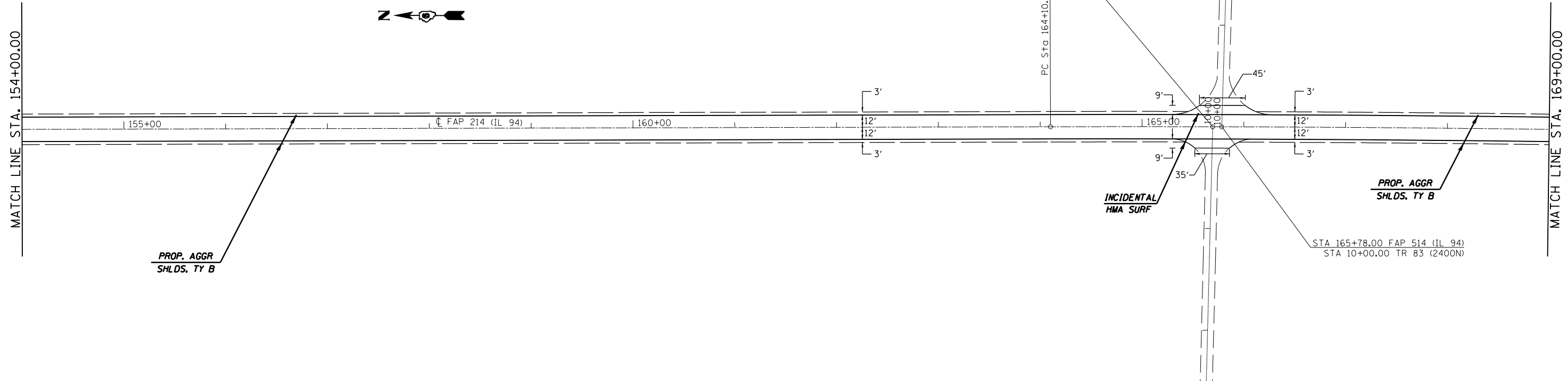

EXIST. CURVE 169
PI STA. = 169+28.26
 $\Delta = 1^\circ 54' 00''$ (RT)
D = $0^\circ 11' 00''$
R = 31,248.06'
T = 518.16'
L = 1,036.23'
E = 4.30'
e = N.C.
T.R. = -----
S.E. RUN = -----
P.C. STA. = 164+10.10
P.T. STA. = 174+46.33

(18)

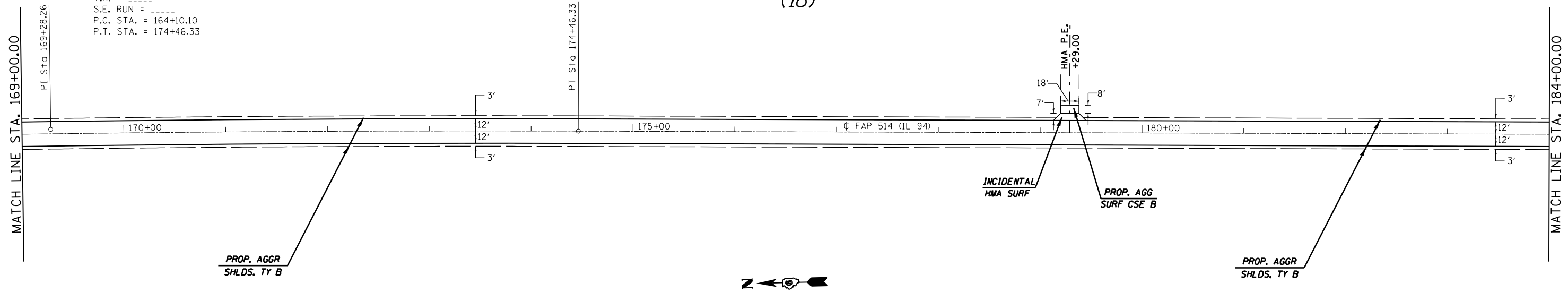

FILE NAME =	USER NAME = sparksgw	DESIGNED - JWC	REVISED -
ei:\pw\work\pwidot\sparksgw\10221152\0672\c92-shr-plan.dgn		DRAWN - JWC	REVISED -
		CHECKED - MSD	REVISED -
		DATE -	REVISED -
	PLOT DATE = Feb-07-2012 01:52:03PM		

STATE OF ILLINOIS
DEPARTMENT OF TRANSPORTATION

PLAN SHEETS

SCALE: 50 SHEET NO. 6 OF 8 SHEETS STA. 154+00.00 TO STA. 184+00.00

F.A.P. RTE.	SECTION	COUNTY	TOTAL SHEETS	SHEET NO.
514	106RS-6	HANCOCK	26	20
CONTRACT NO. 72C92			ILLINOIS FED. AID PROJECT	