

\* REDUCE TO 40 FEET (12.2 METERS) ON CENTER ON CURVES WHERE ADVISORY SPEEDS ARE 10 MPH (15 km/h) LOWER THAN POSTED SPEEDS.

\*\* DOUBLE LANE LINE MARKERS SHALL BE SPECIFIED AND SPACED AS SHOWN IN HIGHWAY STANDARD 781001 FOR MULTI-LANE DIVIDED AND UNDIVIDED HIGHWAYS.

**GENERAL NOTES:**

- ⓑ TURN ARROW PAIRS SHALL BE PLACED AT 250' (75 m) INTERVALS AND SHALL BE EVENLY SPACED BETWEEN BOTH ENDS OF THE BIDIRECTIONAL LEFT TURN LANE.
- ⓒ THE SOLID YELLOW PAVEMENT MARKINGS [2] SHOULD GENERALLY START OR END NEAR THE RADIUS POINT OF EACH STREET RETURN EXCEPT WHERE ONE OR BOTH ENDS WOULD INCLUDE STOP BARS.
- ⓓ THE SKIP-DASH PAVEMENT MARKINGS [1] OR [7] SHOULD BE CENTERED BETWEEN BOTH ENDS OF EACH CITY BLOCK AND SHALL BE PLACED SO THEY LINE UP ACROSS FROM EACH OTHER. SEE EXAMPLE ON SHEET 2 OF 3.
- ⓔ USE LARGE ARROW SIZE FOR BOTH RURAL AND URBAN LOCATIONS. (SEE LAST PAGE OF SECTION 780x FOR SYMBOLS TABLE)

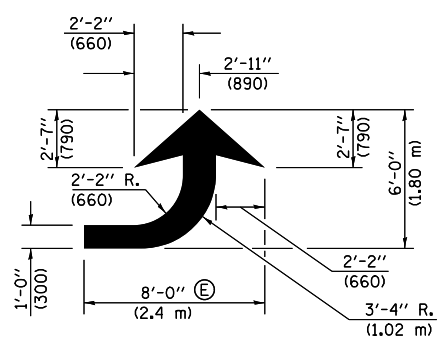

**LEFT ARROW**

REVERSE FOR RIGHT ARROW  
AREA = 15.6 SQ. FT. (1.47 m<sup>2</sup>)  
(WHITE)

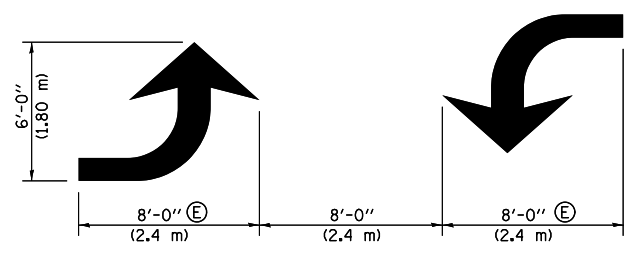

**TYPICAL DOUBLE TURN ARROWS (WHITE)**

**BLOOMINGTON-NORMAL CITY LIMITS ONLY**

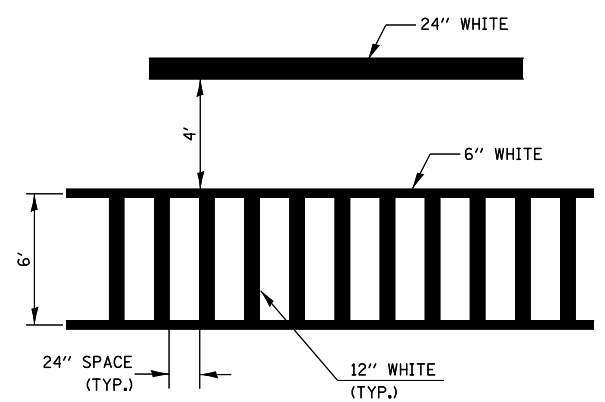

**TYPICAL SPACING FOR CROSSWALKS & STOP BARS**

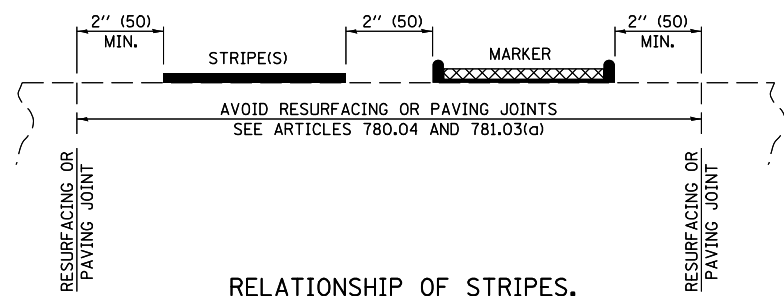

**RELATIONSHIP OF STRIPES, MARKERS AND JOINTS**

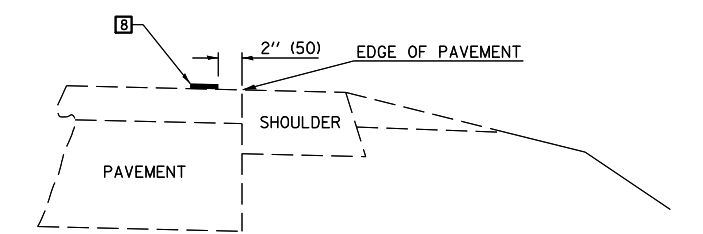

**RELATIONSHIP OF EDGE LINE TO EDGE OF PAVEMENT (SAFETY SHOULDER OR PAVED SURFACE) SEE ARTICLE 780.04**

Note: All dimensions are in INCHES (millimeters) unless otherwise shown.

FILE NAME =		USER NAME = dawsonkb		DESIGNED -		REVISED - 11/06		STATE OF ILLINOIS DEPARTMENT OF TRANSPORTATION		PAVEMENT MARKING AND MARKERS (RURAL & URBAN APPLICATIONS)		F.A.S. RTE.		SECTION		COUNTY		TOTAL SHEETS		SHEET NO.	
c:\pw\work\p\idot\dawsonkb\02288686\0570930-shd-detail.dgn		DRAWN -		REVISED - 09/2009 - KJI		522						(41)RS		Champaign		23		20			
PLOT SCALE = 40.0000' / in.		CHECKED -		REVISED -		CONTRACT NO. 70930						FED. ROAD DIST. NO. -		ILLINOIS		FED. AID PROJECT					
PLOT DATE = 1/31/2012		DATE -		REVISED -		SCALE: _____						SHEET NO. 2_ OF 4_ SHEETS		STA. _____ TO STA. _____							

**DISTRICT 5 DETAIL NO. 7800AAA**