

STATE OF ILLINOIS
DEPARTMENT OF TRANSPORTATION
DIVISION OF HIGHWAYS

**PROPOSED
HIGHWAY PLANS**

FAS ROUTE 522 (SIDNEY-LONGVIEW RD.)
SECTION (41)RS

RESURFACING
CHAMPAIGN COUNTY

C-95-039-11

BLOCK RD. TO FAS 526 (BONGARD RD.)

F.A.S. RTE.	SECTION	COUNTY	TOTAL SHEETS	SHEET NO.
522	(41)RS	Champaign	23	1
		ILLINOIS	CONTRACT NO. 70930	

D-95-039-11

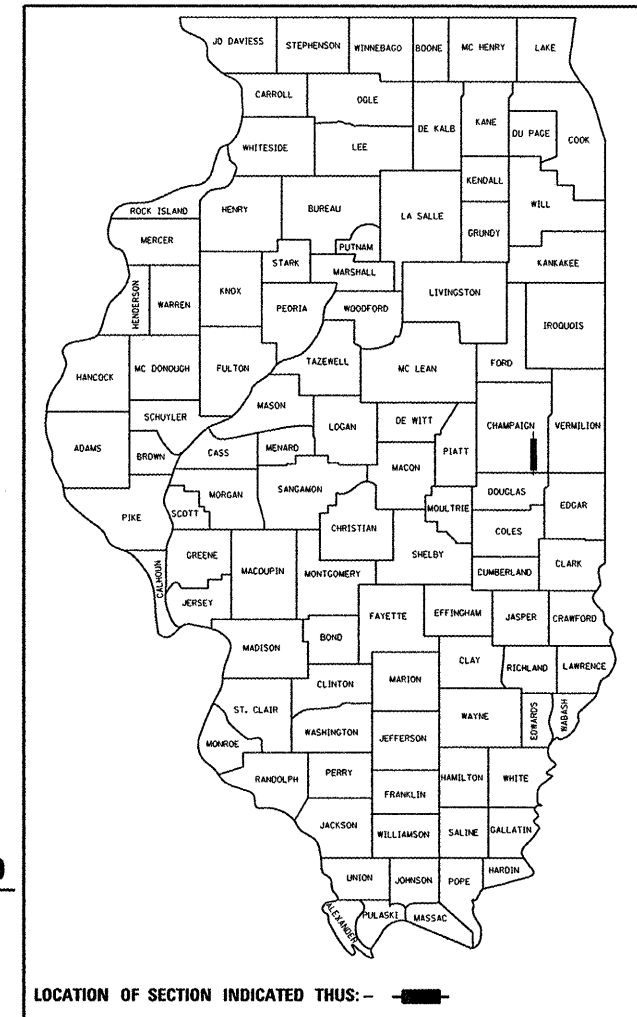

LOCATION OF SECTION INDICATED THUS: —

FOR INDEX OF SHEETS, SEE SHEET NO. 2
FOR SUMMARY OF QUANTITIES, SEE SHEET NO. 4

DESIGN DESIGNATION:
MAJOR COLLECTOR

CURRENT ADT: (2011)
550

BRIDGE OMISSION S.N. 010-0244
STA. 332 + 91 TO STA. 333 + 63

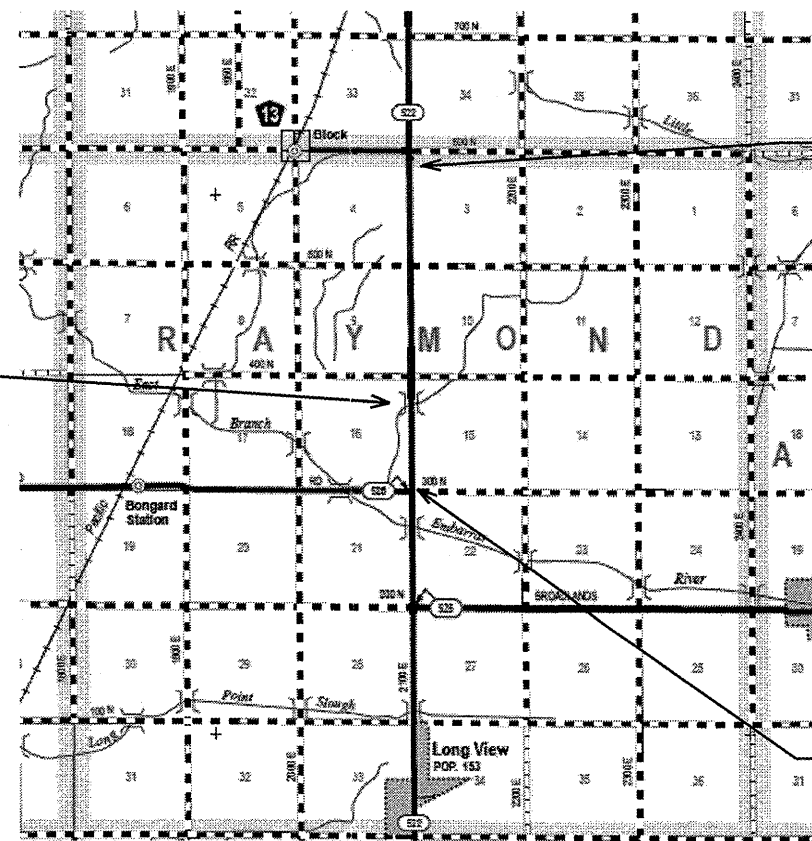

PROJECT BEGINS, STA. 217 + 49

PROJECT ENDS, STA. 372 + 12.5

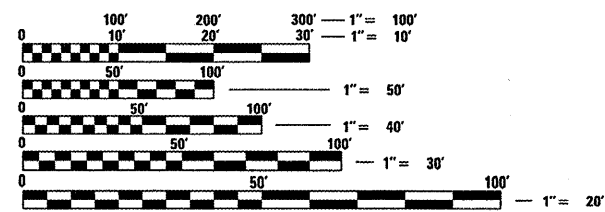

FULL SIZE PLANS HAVE BEEN PREPARED USING STANDARD ENGINEERING SCALES. REDUCED SIZED PLANS WILL NOT CONFORM TO STANDARD SCALES. IN MAKING MEASUREMENTS ON REDUCED PLANS, THE ABOVE SCALES MAY BE USED.

J.U.L.I.E.
JOINT UTILITY LOCATION INFORMATION FOR EXCAVATION
1-800-892-0123
OR 811 RAYMOND TOWNSHIP

PROJECT ENGINEER: JASON STULTS (217-465-4181)
PROJECT MANAGER: RUSTIN KEYS
DESIGNER : KARY DAWSON
CONTRACT NO. 70930

GROSS LENGTH = 15,463.50 FT. = 2.929 MILE
NET LENGTH = 15,391.50 FT. = 2.915 MILE

STATE OF ILLINOIS
DEPARTMENT OF TRANSPORTATION
DIVISION OF HIGHWAYS
SUBMITTED 0130 20 12
Joseph E. Lewis (HAW)
DEPUTY DIRECTOR OF HIGHWAYS, REGION ENGINEER
March 23 20 12
John D. Baranzelli, P.E. I&E
Acting ENGINEER OF DESIGN AND ENVIRONMENT
March 23 20 12
William R. Frey I&E
Acting DIRECTOR OF HIGHWAYS, CHIEF ENGINEER

PRINTED BY THE AUTHORITY
OF THE STATE OF ILLINOIS