

F. A. U. NO.	SECTION	COUNTY	TOTAL SHEETS	SHEET NO.
3787	11-00151-00-RS	COOK	27	1
STA. 13+15		TO STA. 101+79.6		
FED. ROAD DIST. NO.		ILLINOIS	FED. AID PROJECT M-9003 (907)	

CONTRACT #63693

STATE OF ILLINOIS
DEPARTMENT OF TRANSPORTATION
DIVISION OF HIGHWAYS

PLANS FOR PROPOSED
FEDERAL AID HIGHWAY

SIBLEY BOULEVARD (FAU 3787)
TORRENCE AVENUE (FAP 358) TO STATE-LINE ROAD (FAU 2947)
RESURFACING
SECTION NO.: 11-00151-00-RS
PROJECT NO.: M-9003(907)
CITY OF CALUMET CITY
JOB NO. C-91-169-12

INDEX OF SHEETS

- COVER SHEET, INDEX OF SHEETS & STATE STANDARDS
- SUMMARY OF QUANTITIES & GENERAL NOTES
- 5. TYPICAL CROSS SECTIONS
- 14. PAVEMENT IMPROVEMENT PLANS
- 19. PAVEMENT MARKING PLANS
- 21. CONSTRUCTION DETAILS
- 27. IDOT DISTRICT 1 STANDARD DETAILS

HIGHWAY STANDARDS

- | | |
|-----------|--|
| 000001-06 | STANDARD SYMBOLS, ABBREVIATIONS, AND PATTERNS |
| 420001-07 | PAVEMENT JOINTS |
| 424001-06 | PERPENDICULAR CURB RAMPS FOR SIDEWALKS |
| 424006-00 | DIAGONAL CURB RAMPS FOR SIDEWALKS |
| 424011-00 | CORNER PARALLEL CURB RAMPS FOR SIDEWALKS |
| 424016-00 | MID-BLOCK CURB RAMPS FOR SIDEWALKS |
| 424021-00 | DEPRESSED CORNER FOR SIDEWALKS |
| 424026-00 | ENTRANCE / ALLY PEDESTRIAN CROSSINGS |
| 442201-03 | CLASS C AND D PATCHES |
| 602011-02 | CATCH BASIN, TYPE C |
| 604001-03 | FRAME AND LIDS, TYPE 1 |
| 606001-04 | CONCRETE CURB TYPE AND COMBINATION CURB AND GUTTER |
| 701301-04 | LANE CLOSURE, 2L,2W SHORT TIME OPERATIONS |
| 701311-03 | LANE CLOSURE, 2L,2W MOVING OPERATIONS - DAY ONLY |
| 701501-06 | URBAN LANE CLOSURE, 2L, 2W, UNDIVIDED |
| 701606-08 | URBAN LANE CLOSURE, 2W WITH MOUNTABLE MEDIUM |
| 701701-08 | URBAN LANE CLOSURE, MULTILANE INTERSECTION |
| 701801-05 | SIDEWALK, CORNER OR CROSSWALK CLOSURE |
| 701901-02 | TRAFFIC CONTROL DEVICES |
| 886001-01 | DETECTOR LOOP INSTALLATIONS |
| 886006-01 | TYPICAL LAYOUT FOR DETECTOR LOOPS |

SIBLEY STREET

2011 ADT - 11,500
2030 ADT - 11,500

POSTED SPEED LIMIT - 30 mph (BURNHAM TO STATELINE);
35 mph (BURNHAM TO TORRENCE);

DESIGN PERIOD - 20 YEARS
DESIGN SPEED LIMIT - 35 mph
STREET CLASSIFICATION - MINOR ARTERIAL

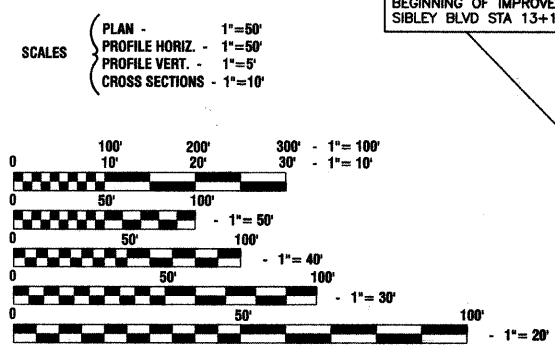

FULL SIZE PLANS HAVE BEEN PREPARED USING STANDARD ENGINEERING SCALES, REDUCED SIZED PLANS WILL NOT CONFORM TO STANDARD SCALES, IN MAKING MEASUREMENTS ON REDUCED PLANS, THE ABOVE SCALES MAY BE USED.

J. U. L. I. E.
JOINT UTILITY LOCATION INFORMATION FOR EXCAVATION
1-800-892-0123 or 811

CONTRACT NO. 63693

PROGRAM AND OFFICE ENGINEER: CHARLES F. RIDDLER, PE 847-705-4406 SCHAUMBURG, IL
CONSULTANTS: ROBISON ENGINEERING, LTD. 708-331-6700

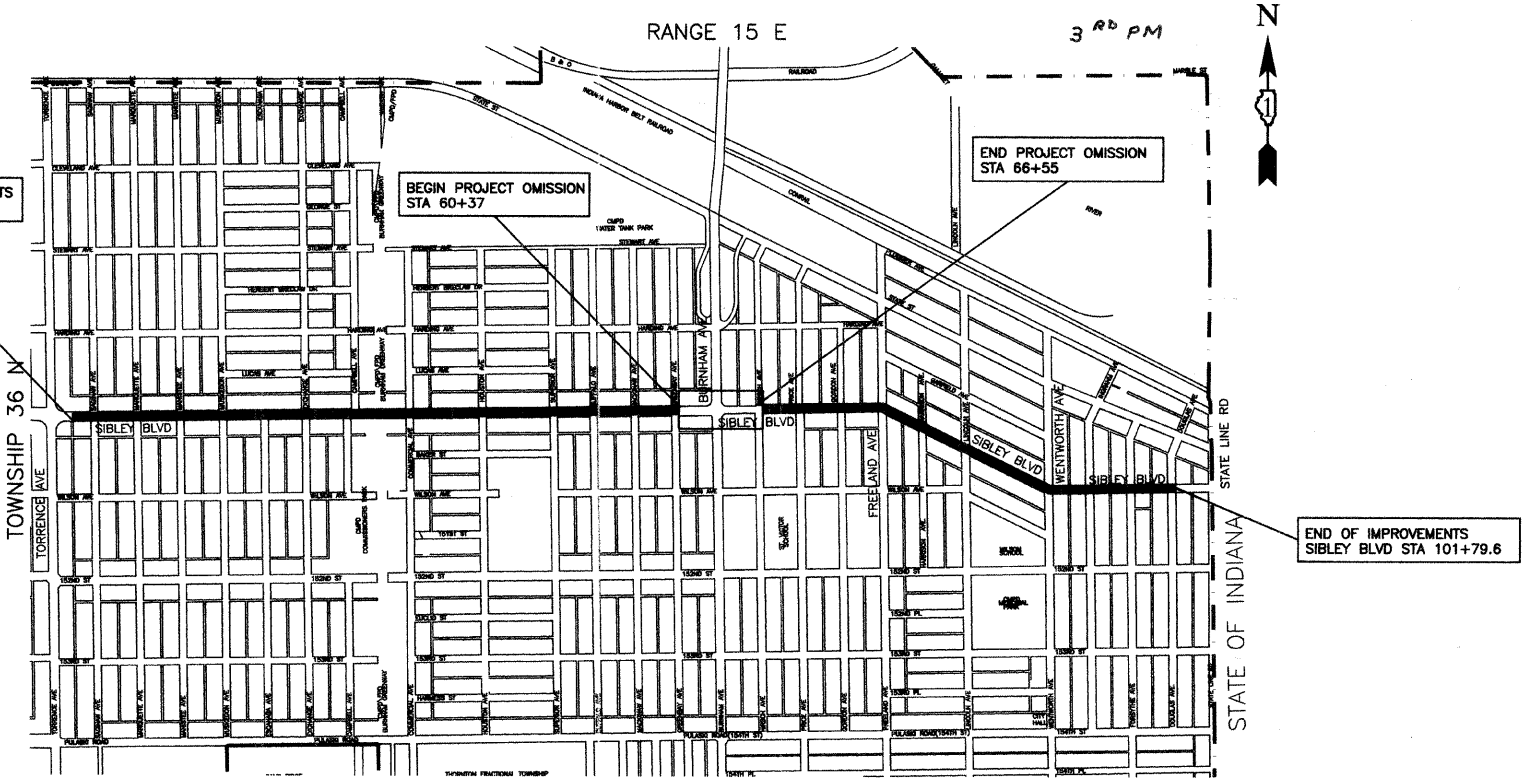
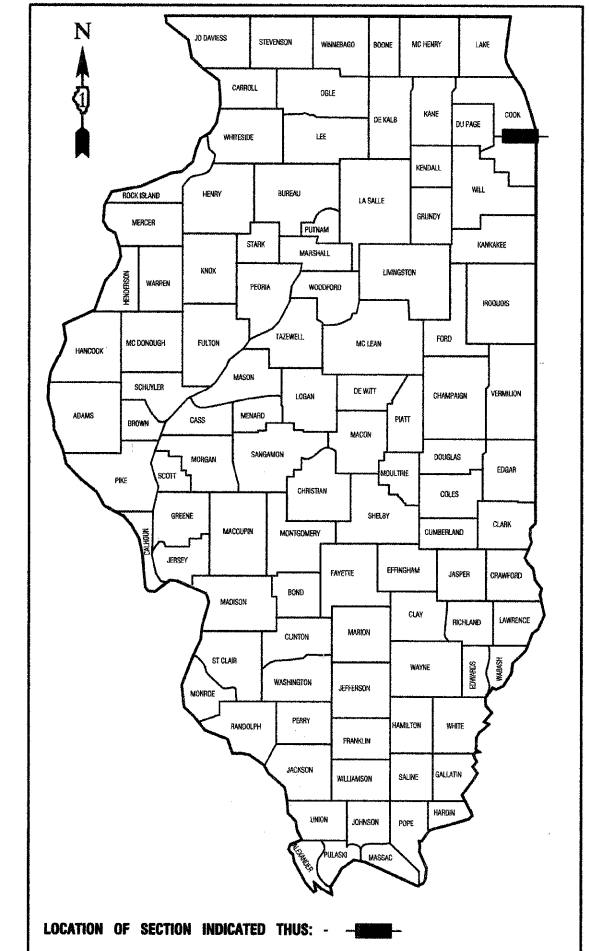

LOCATION MAP

GROSS LENGTH=8,864.6 FEET=1.67 MILES
NET LENGTH=8,246.2 FEET=1.6 MILES

STATE OF ILLINOIS DEPARTMENT OF TRANSPORTATION
DIVISION OF HIGHWAYS

Approved: January 20, 2012
Rachel M. O'Keefe
Mayor, City of Calumet City

Passed: FEBRUARY 14, 2012
Chell
District 1 Engineer of Local Roads & Streets

Released for Bid Based on Limited Review: FEBRUARY 14, 2012
Diane M. O'Keefe
Deputy Director of Highways, Region 1 Engineer

PRINTED BY THE AUTHORITY OF THE STATE OF ILLINOIS

PREPARED BY OR UNDER THE DIRECT SUPERVISION OF:

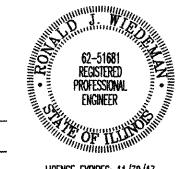

02/03/12

LICENSE EXPIRES: 11/30/13