

100 90 80 70 60 50 40 30 20 10 0 10 20 30 40 50 60 70 80 90 100 110 120 130 140 150 160 170 180

F.A.P. RTE.	SECTION	COUNTY	TOTAL SHEETS	SHEET NO.
336	112R-N	McHENRY	266	262
STA.		TO STA.		
FED. ROAD DIST. NO.		ILLINOIS FED. AID PROJECT		
CONTRACT NO. 62537				

DATE	BY
DATE	BY
DATE	BY
DATE	BY
DATE	BY

DATE	BY
DATE	BY
DATE	BY
DATE	BY
DATE	BY

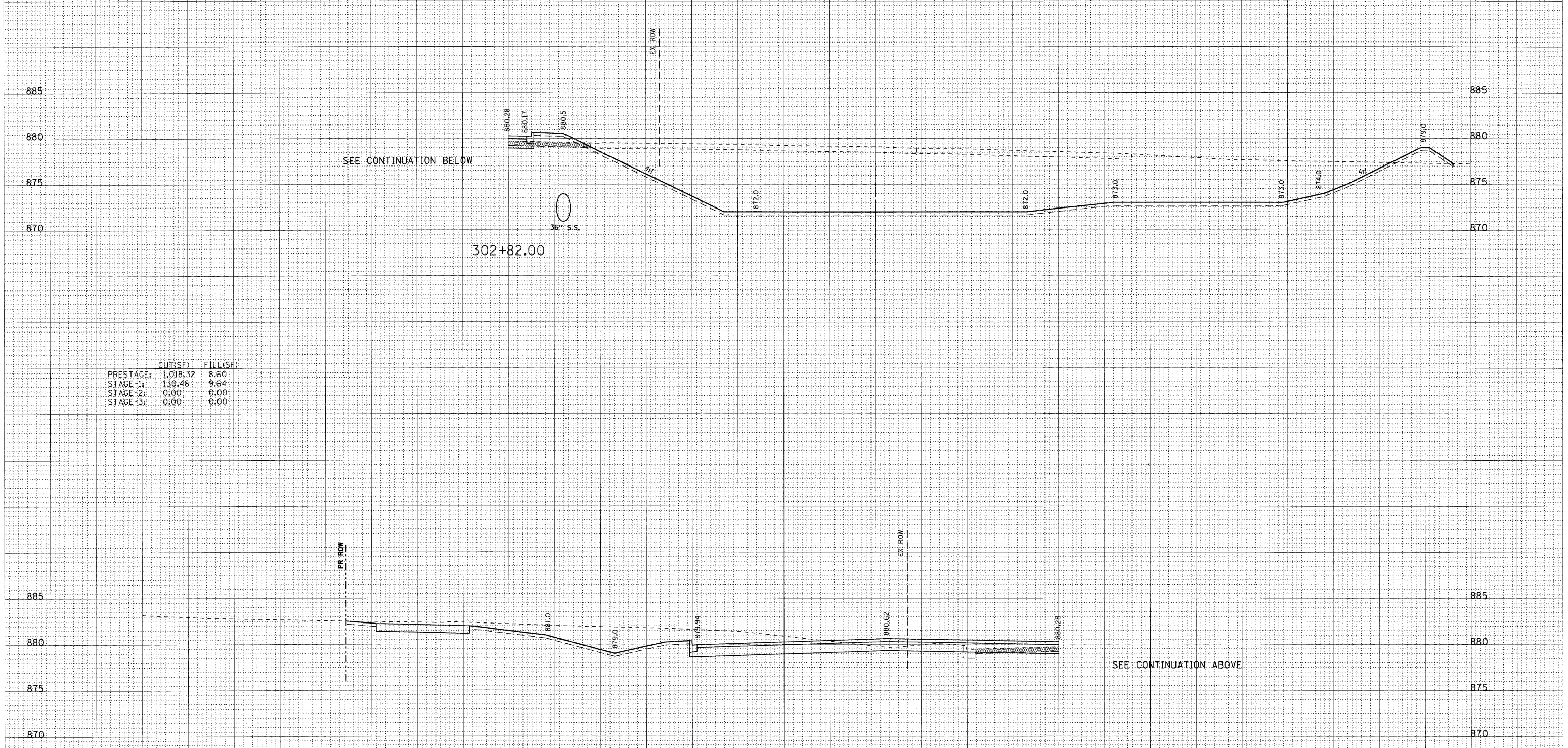

	CUT(SF)	FILL(SF)
PRESTAGE:	1,018.32	8.60
STAGE-1:	130.46	9.64
STAGE-2:	0.00	0.00
STAGE-3:	0.00	0.00

SEE CONTINUATION ABOVE

SEE CONTINUATION BELOW

LEGEND

	TEMPORARY PAVEMENT
	TEMPORARY AGGREGATE SHOULDER
	EXCAVATION OF UNSUITABLE SOIL AND REPLACEMENT WITH POROUS GRANULAR EMBANKMENT, SUBGRADE
	PAVEMENT REMOVAL

220 210 200 190 180 170 160 150 140 130 120 110 100 90 80 70 60 50 40 30 20 10 0 10 20 30 40 50 60 70 80 90

TERRA COTTA AVENUE