

F.A.P. RTE.	SECTION	COUNTY	TOTAL SHEETS	SHEET NO.
336	112R-N	McHENRY	266	257
STA.		TO STA.		
FED. ROAD DIST. NO.		ILLINOIS FED. AID PROJECT		
CONTRACT NO. 62537				

DATE	
BY	
ORIGINAL SURVEY	
PLOTTED	
TEMPLATE	
NOTE BOOK	
NO.	
AREAS CHECKED	

DATE	
BY	
ORIGINAL SURVEY	
PLOTTED	
TEMPLATE	
NOTE BOOK	
NO.	
AREAS CHECKED	

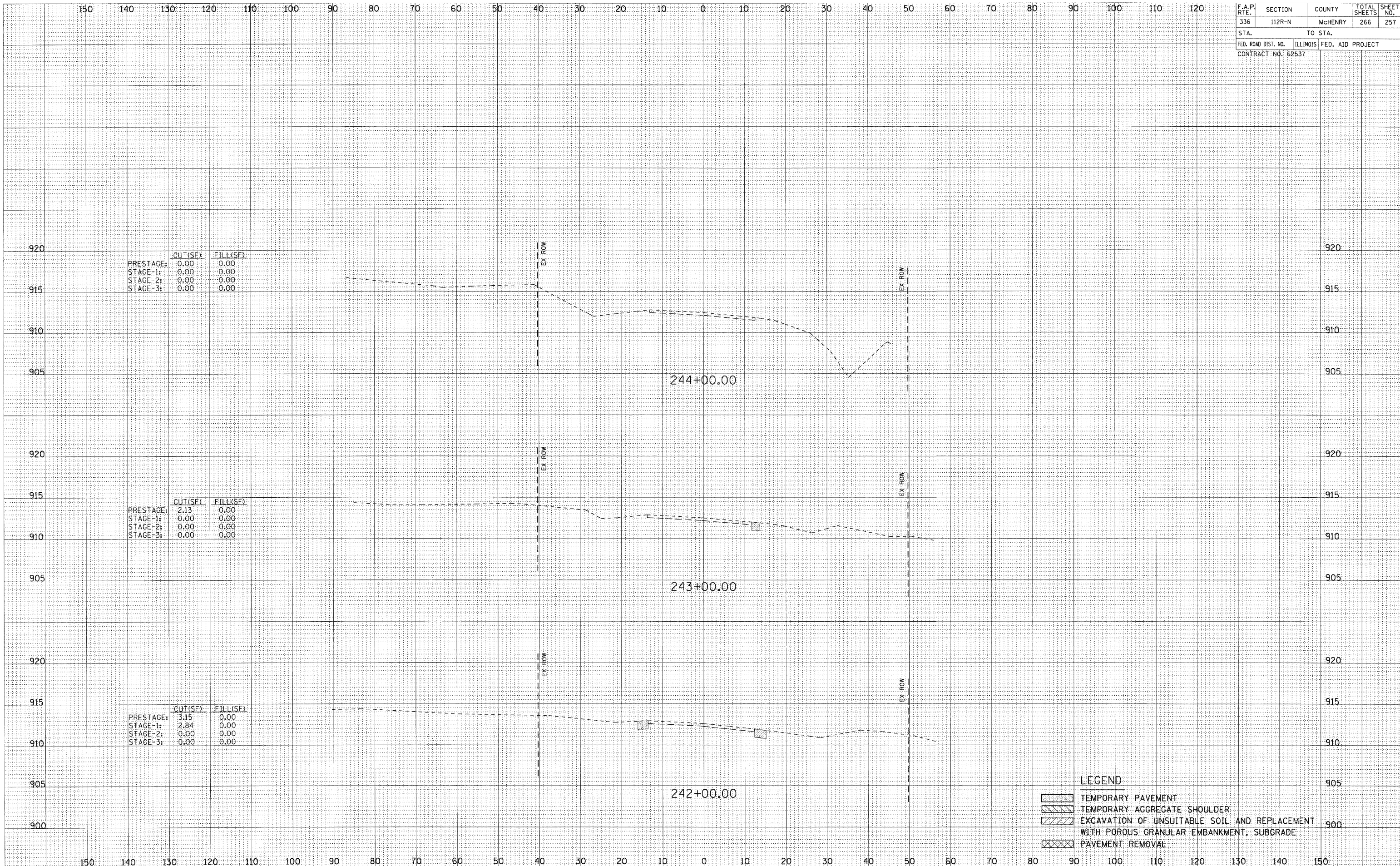

LEGEND

- TEMPORARY PAVEMENT
- TEMPORARY AGGREGATE SHOULDER
- EXCAVATION OF UNSUITABLE SOIL AND REPLACEMENT WITH POROUS GRANULAR EMBANKMENT, SUBGRADE
- PAVEMENT REMOVAL