

F.A.P. RTE.	SECTION	COUNTY	TOTAL SHEETS	SHEET NO.
336	112R-N	MCHEMRY	266	173
STA.	TO STA.			
FED. ROAD DIST. NO.	ILLINOIS	FED. AID PROJECT:		

CONTRACT NO. - 62537

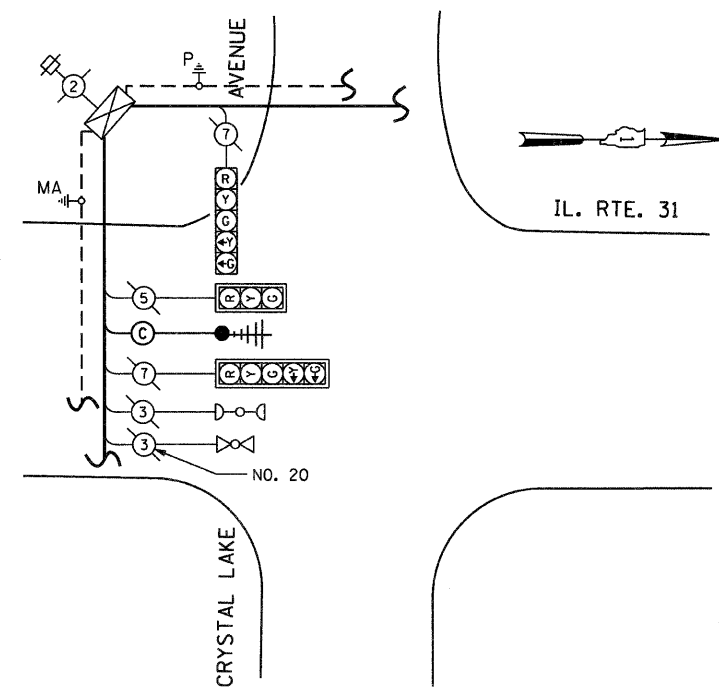
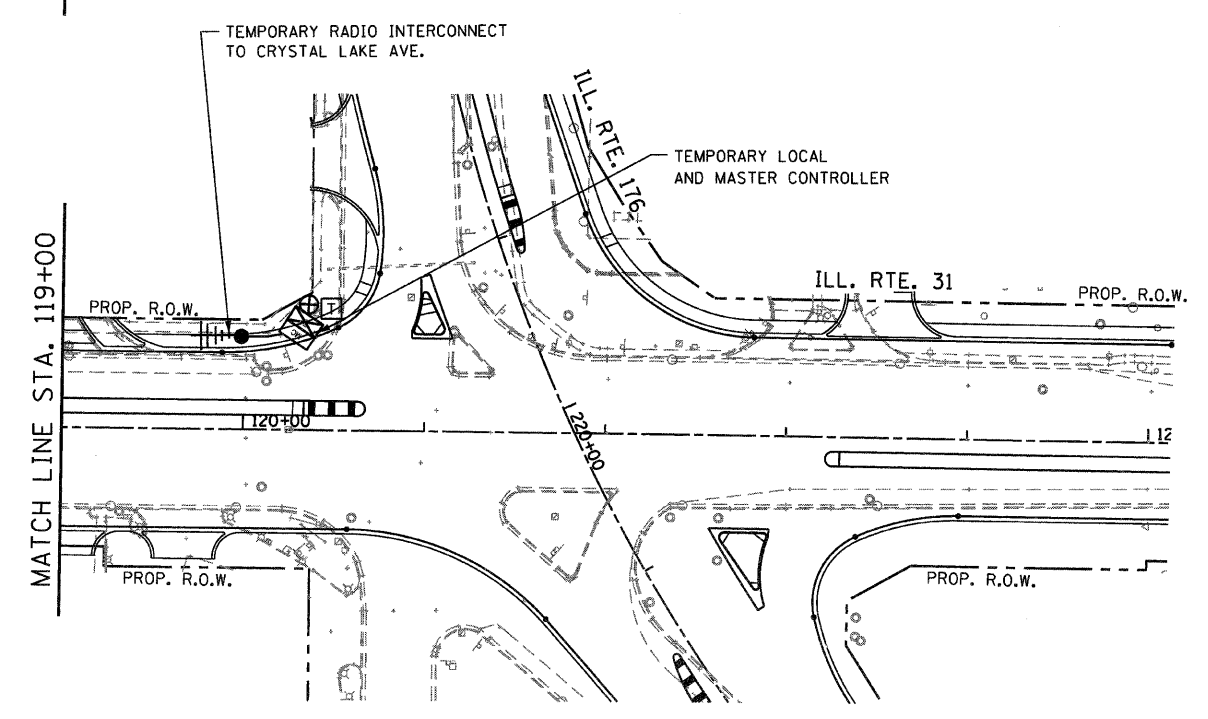
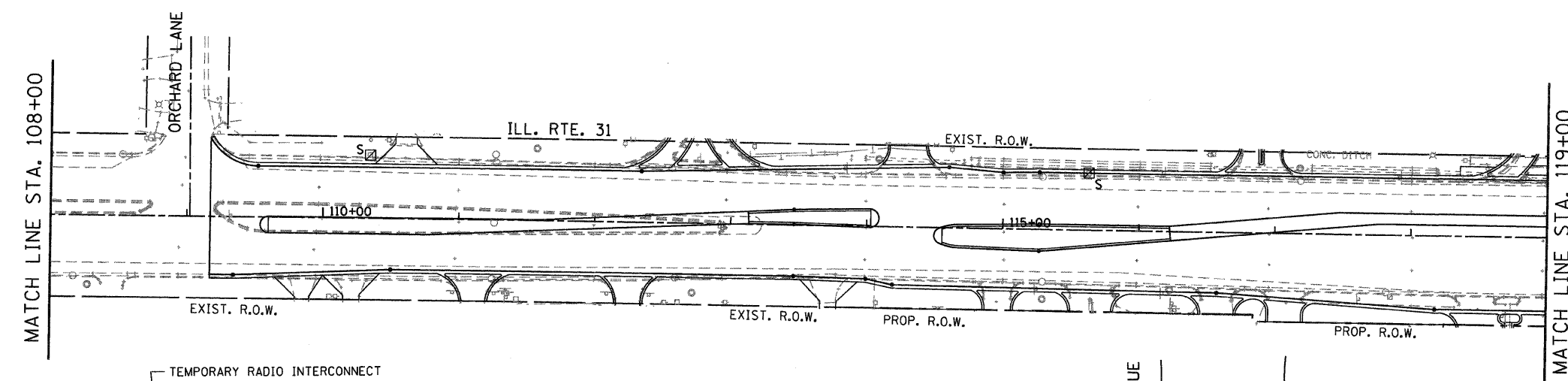
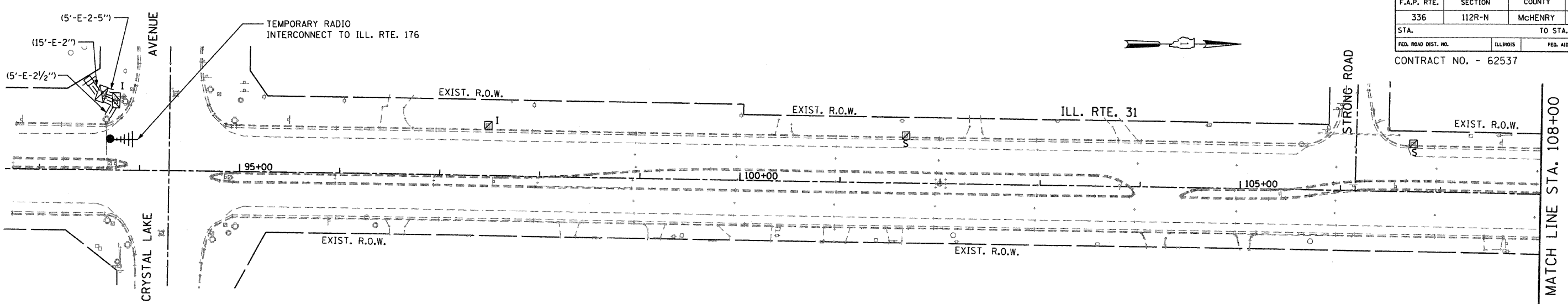

THE TRAFFIC SIGNAL CONTROL EQUIPMENT FOR THIS PROJECT SHALL BE "ECONOLITE" TO MATCH THE EXISTING ADJACENT SYSTEM.

ILLINOIS DEPARTMENT OF TRANSPORTATION
 TEMPORARY INTERCONNECT PLAN
 ILLINOIS ROUTE 31 FROM ILLINOIS ROUTE 176 TO CRYSTAL LAKE AVENUE

REVISIONS	
NAME	DATE
EA	11/21/2011

SCALE: 1"=50'
 DATE: 02/10/2012
 DRAWN BY: KGP
 DESIGNED BY: PKG
 CHECKED BY: PKG

go GANDHI AND ASSOCIATES, INC.
 ENGINEERS AND PLANNERS
 6035 N. NORTHWEST HIGHWAY
 SUITE 306
 CHICAGO, ILLINOIS 60631 TEL. (773) 774-5910